

DATE	
BY	
PROJECT	
NOTES	
NO.	
DATE	
BY	
PROJECT	
NOTES	
NO.	

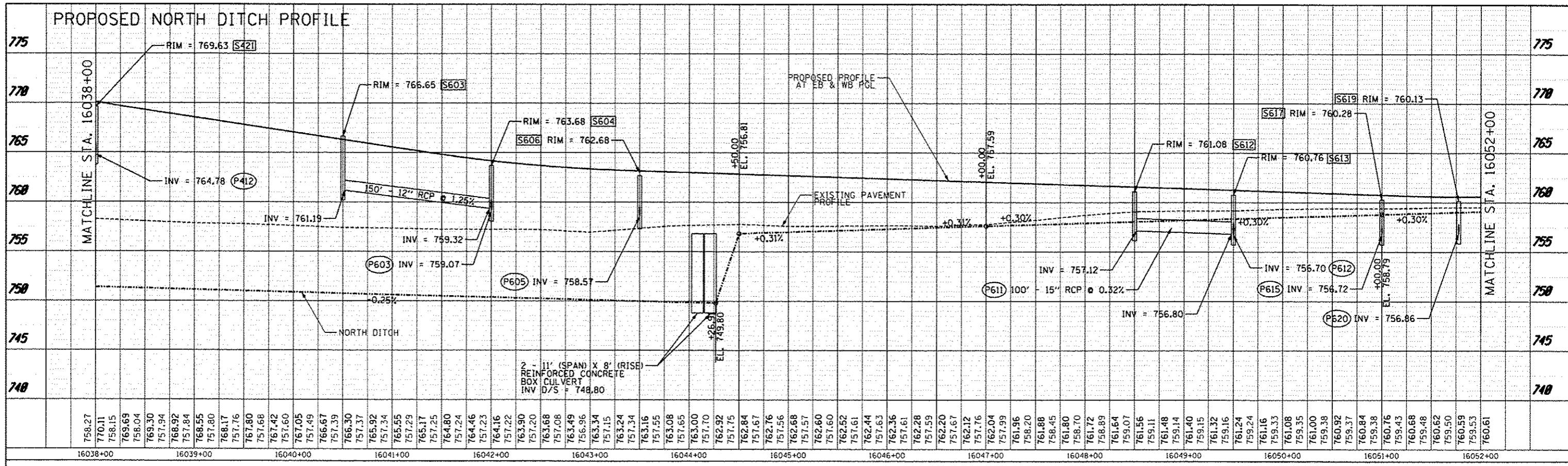

DATE	
BY	
PROJECT	
NOTES	
NO.	
DATE	
BY	
PROJECT	
NOTES	
NO.	

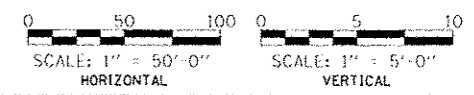
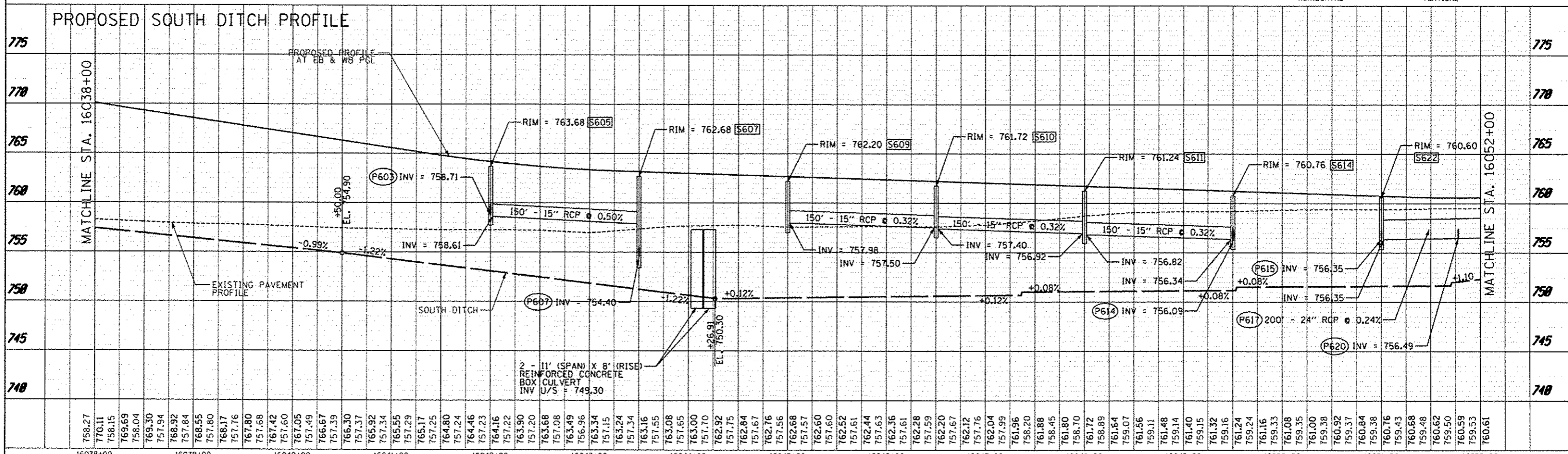

TYLIN INTERNATIONAL	USER NAME	DESIGNED	PP	REVISED	10/18/2013	STATE OF ILLINOIS DEPARTMENT OF TRANSPORTATION	STUENKEL ROAD AT I-57 RIDGELAND AVENUE TO CENTRAL AVENUE PROPOSED DRAINAGE PLAN AND PROFILE - STUENKEL ROAD	F.A.I. R.T.E.	SECTION	COUNTY	TOTAL SHEETS	SHEET NO.
	PLOT SCALE	CHECKED	JPM	REVISED				57	99-IHB-RI	WILL	679	191
	PLOT DATE	DATE	05/10/2013	REVISED				SCALE: 1" = 50' SHEET 7 OF 29 SHEETS STA. 16038+00 TO STA. 16052+00		CONTRACT NO. 60L69		ILLINOIS FED. AID PROJECT