

DATE	
BY	
PROJECT	
NOTES	
PLAN	
NO.	

DATE	
BY	
PROJECT	
NOTES	
PROFILE	
NO.	

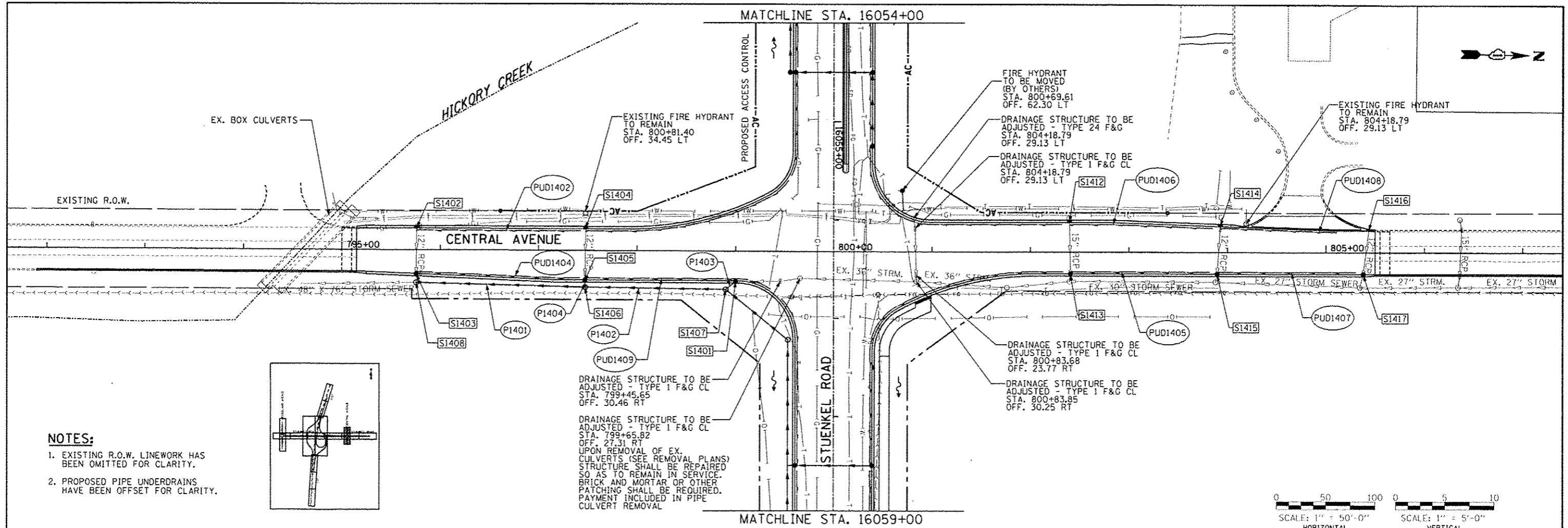

- NOTES:**
- EXISTING R.O.W. LINEWORK HAS BEEN OMITTED FOR CLARITY.
 - PROPOSED PIPE UNDERDRAINS HAVE BEEN OFFSET FOR CLARITY.

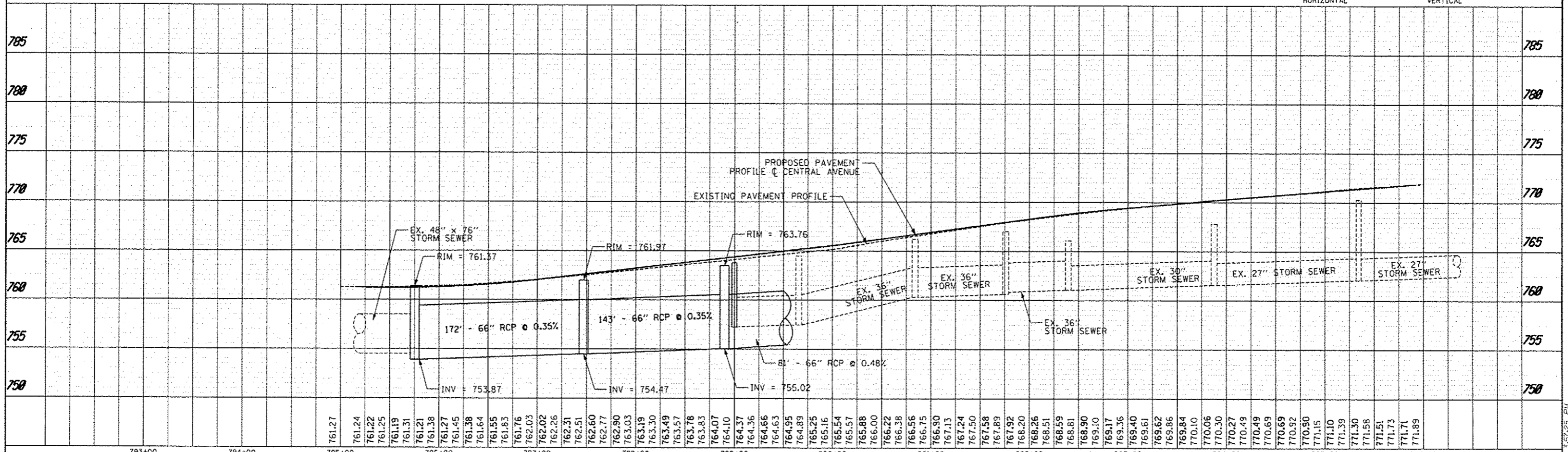
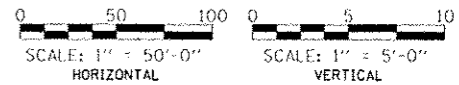
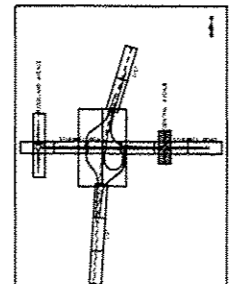

TYLIN INTERNATIONAL	USER NAME	DESIGNED - PP	REVISED - 06/21/2013	STATE OF ILLINOIS DEPARTMENT OF TRANSPORTATION	STUENKEL ROAD AT I-57 RIDGELAND AVENUE TO CENTRAL AVENUE PROPOSED DRAINAGE PLAN AND PROFILE - CENTRAL AVENUE	SECTION 99-IHB-RI	COUNTY WILL	TOTAL SHEETS	CONTRACT NO. 60L69
	PROJ. SCALE	DRAWN - PP	REVISED - 10/18/2013					NO.	
	PLT. DATE	CHECKED - JPM	REVISED - 12/04/2013					679	
	DATE	DATE	REVISED - 05/10/2013					198	

SCALE: 1" = 50' SHEET 14 OF 29 SHEETS STA. 795+00 TO STA. 805+00