

NOTE:
 1. REMOVE THE TEMPORARY PROTECTION INSTALLED ON EXISTING TRANSFORMER BASE. REINSTALL EXISTING LIGHT POLE WITH NEW HARDWARE, NEW FUSE AND FUSE HOLDERS, NEW 310W HPS LAMP COMPLYING WITH THE ARTICLE 1067.06(1) OF STANDARD SPECIFICATION, AND NEW POLE DECAL. THIS WORK SHALL BE INCLUDED AS PART OF THE PAY ITEM "RELOCATE LIGHTING UNITS".

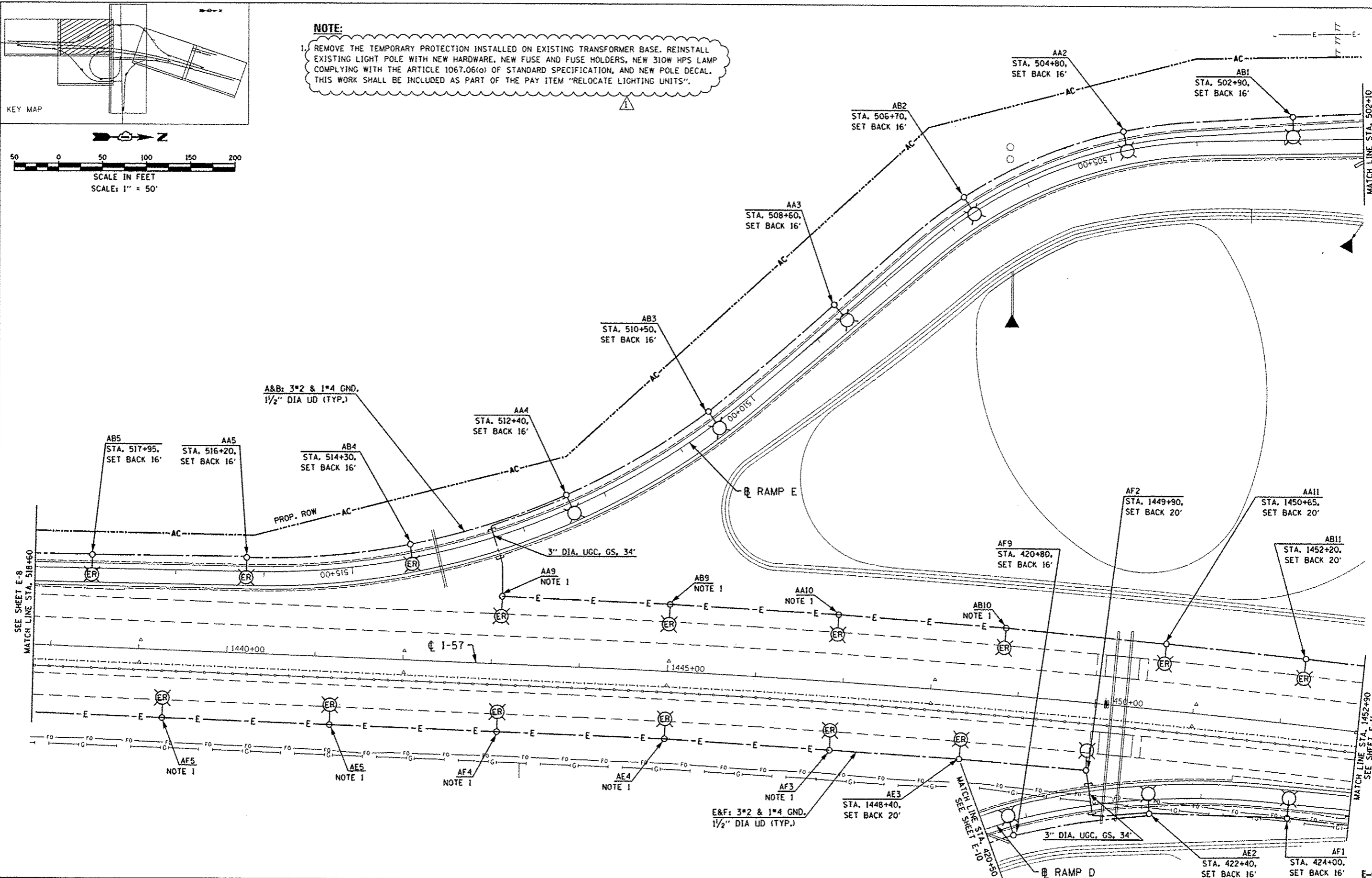

S:\377\000\CADD_Sheets\06\06\09-shr-light-09.dgn 26-DEC-2013 15:03:15

SINGH SINGH & ASSOCIATES INC. CONSULTING ENGINEERS	USER NAME * hproje001	DESIGNED - RDP	REVISED 6/18/2013	STATE OF ILLINOIS DEPARTMENT OF TRANSPORTATION	STUENKEL ROAD OVER I-57 PROPOSED LIGHTING PLANS (SHEET 2 OF 7)			F.A.I. RTE. 57	SECTION 99-1H8-R	COUNTY WILL	TOTAL SHEETS 679	SHEET NO. 332	
	PLOT SCALE * 100.000000/1.000000	CHECKED - KGP	REVISED 10/18/2013		SCALE: AS NOTED	SHEET NO. 14	OF 24 SHEETS	STA. ----- TO STA. -----	CONTRACT NO. 60L69		ILLINOIS FED. AID PROJECT		
	PLOT DATE * 26-DEC-2013 15:01	DATE - 8/22/2013	REVISED 12/04/2013		ADDENDUM 1 1/03/14								