

HALF LONG SECTION

Dimensions are at right angles to \varnothing Roadway, unless noted otherwise

MINIMUM BAR LAP	
#5	2'-2"
#7	3'-5"

DETAIL A

DETAIL B

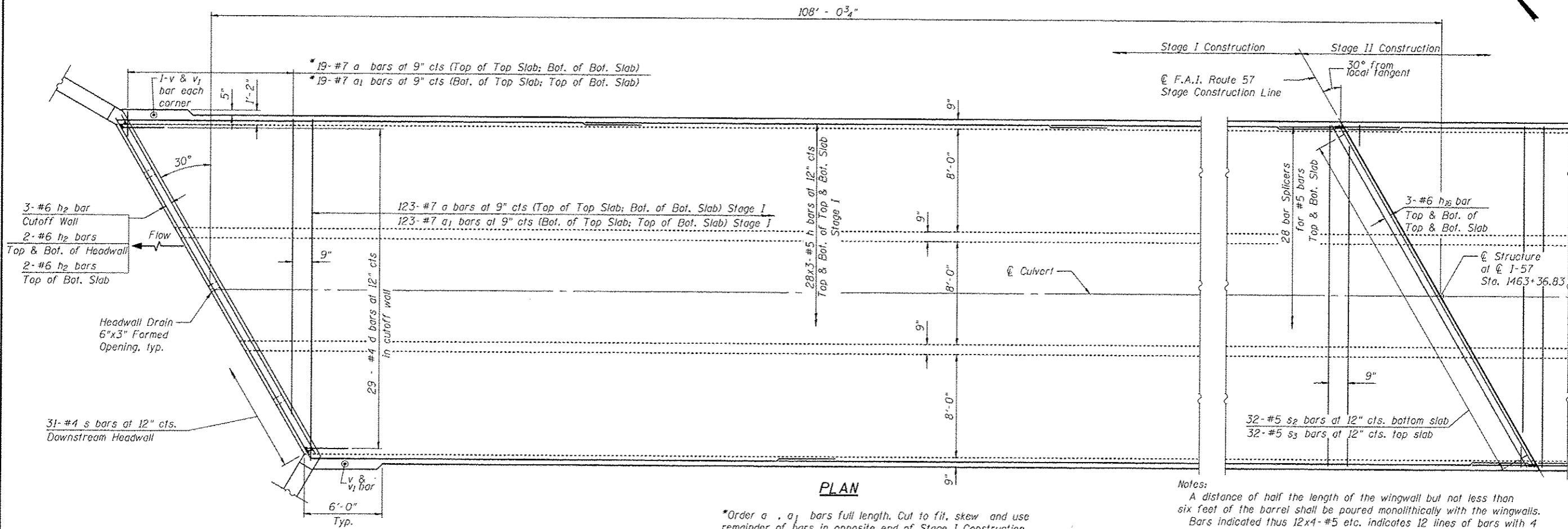

PLAN

*Order a, a₁ bars full length. Cut to fit, skew and use remainder of bars in opposite end of Stage I Construction.

Notes:
 A distance of half the length of the wingwall but not less than six feet of the barrel shall be poured monolithically with the wingwalls.
 Bars indicated thus 12x4-#5 etc. indicates 12 lines of bars with 4 lengths per line.
 For wingwall reinforcement, see sheet SC-5 of SC-10

FILE NAME: TYLIN INTERNATIONAL

USER NAME	DESIGNED	RL	REVISED	1/6/2014 S.P.
	CHECKED	AMD	REVISED	
PLOT SCALE	DRAWN	TB/PK	REVISED	
PLOT DATE	CHECKED	AMD	REVISED	

STATE OF ILLINOIS
 DEPARTMENT OF TRANSPORTATION

CULVERT PLAN AND DETAILS - 1
 STRUCTURE NO. 099-0608

SHEET NO. SC-3 OF SC-10 SHEETS

F.A.I. RTE.	SECTION	COUNTY	TOTAL SHEETS	SHEET NO.
57	99-1MB-R1	WILL	679	375
			CONTRACT NO. 60L69	
ILLINOIS FED. AID PROJECT				

Entire Sheet Revised

P:\602621\157_11_n_11\stuehler\Structural\311interchange\culverts\311current drawings\057_P&E\Sheet 2 of 5.dgn
 1/3/2014 4:34:43 PM