

DATE	
BY	
REVISED	
DATE	
BY	
REVISED	
DATE	
BY	
REVISED	
DATE	
BY	
REVISED	
DATE	
BY	
REVISED	
DATE	
BY	
REVISED	
DATE	
BY	
REVISED	
DATE	
BY	
REVISED	
DATE	
BY	
REVISED	
DATE	
BY	
REVISED	

DATE	
BY	
REVISED	
DATE	
BY	
REVISED	
DATE	
BY	
REVISED	
DATE	
BY	
REVISED	
DATE	
BY	
REVISED	
DATE	
BY	
REVISED	
DATE	
BY	
REVISED	
DATE	
BY	
REVISED	

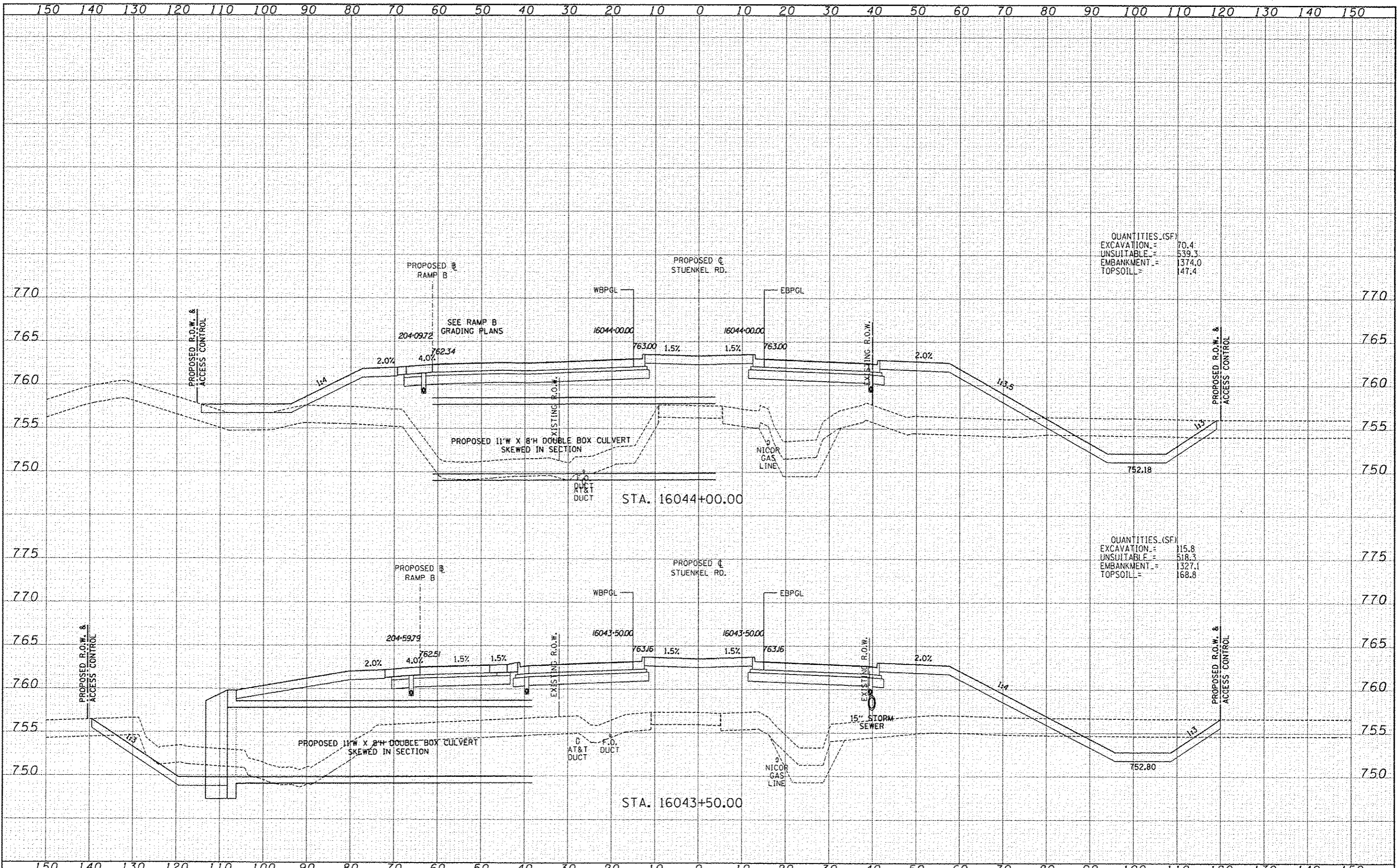

QUANTITIES (SF)

EXCAVATION	=	70.4
UNSUITABLE	=	539.3
EMBANKMENT	=	1374.0
TOPSOIL	=	147.4

QUANTITIES (SF)

EXCAVATION	=	115.8
UNSUITABLE	=	518.3
EMBANKMENT	=	1327.1
TOPSOIL	=	168.8

TYLIN INTERNATIONAL USER NAME: _____ PL. OF SCALE: _____ PLOT DATE: _____	DESIGNED: JDF DRAWN: JDF CHECKED: JPM DATE: 5/10/2013	REVISED: _____ REVISED: _____ REVISED: _____ REVISED: _____	STATE OF ILLINOIS DEPARTMENT OF TRANSPORTATION	I-57 AT STUENKEL ROAD (NEW INTERCHANGE) PROPOSED STUENKEL ROAD CROSS SECTIONS				F.A.I. R.T.E.: 57 SECTION: 99-1HB-RI COUNTY: WILL CONTRACT NO. 60L69	TOTAL SHEETS: 465 SHEET NO.: _____
	SCALE: 1" = 20'			SHEET NO. _____ OF _____ SHEETS STA. 16043+50.00 TO STA. 16044+00.00	FED. ROAD DIST. NO. _____ ILLINOIS FED. AID PROJECT				