

DATE	
BY	
DESIGNED	JDF
DRAWN	JDF
CHECKED	JPM
DATE	5/10/2013

DATE	
BY	
DESIGNED	JDF
DRAWN	JDF
CHECKED	JPM
DATE	5/10/2013

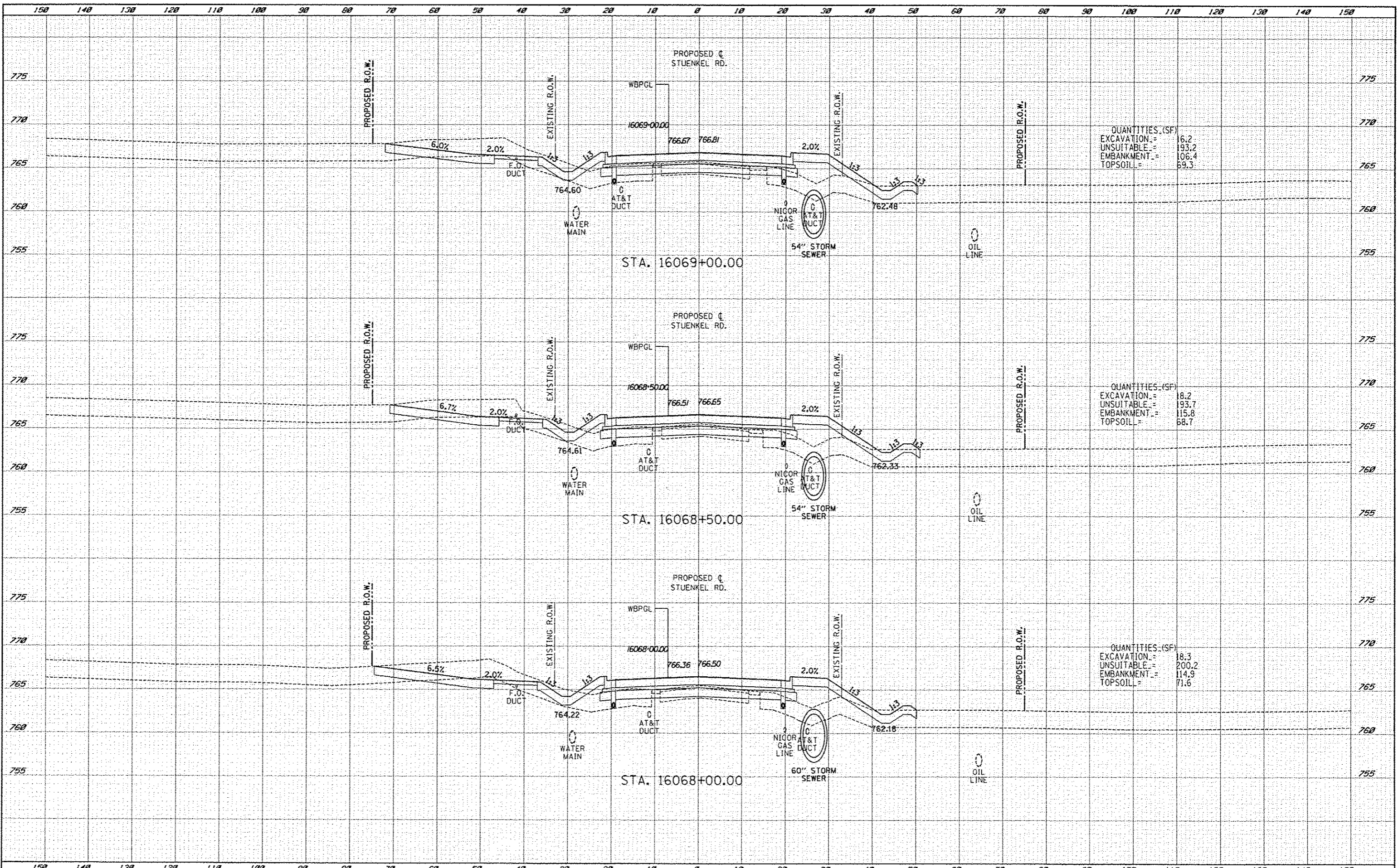

QUANTITIES (SF)

EXCAVATION	16.2
UNSUITABLE	193.2
EMBANKMENT	106.4
TOPSOIL	69.3

QUANTITIES (SF)

EXCAVATION	18.2
UNSUITABLE	193.7
EMBANKMENT	115.8
TOPSOIL	68.7

QUANTITIES (SF)

EXCAVATION	18.3
UNSUITABLE	200.2
EMBANKMENT	114.9
TOPSOIL	71.6

<b>TYLIN INTERNATIONAL</b> USER NAME: _____ PROJECT SCALE: _____ PROJECT DATE: _____	DESIGNED JDF DRAWN JDF CHECKED JPM DATE 5/10/2013	REVISED 10/18/13 REVISED REVISED REVISED	<b>STATE OF ILLINOIS DEPARTMENT OF TRANSPORTATION</b>		<b>I-57 AT STUENKEL ROAD (NEW INTERCHANGE) PROPOSED STUENKEL ROAD CROSS SECTIONS</b>		F.A.I. R.T.E. 57 SECTION 99-IHB-RI COUNTY WILL CONTRACT NO. 60L69	TOTAL SHEETS 679 SHEET NO. 486
	SCALE: 1" = 10' H SHEET NO. OF SHEETS STA. 16068+00.00 TO STA. 16069+00.00			FED. ROAD DIST. NO. ILLINOIS FED. AID PROJECT				

P:\626120-57 @ Stuenkel\Road\NC Interchange\NC3 Stuenkel 50X5 5011.dgn