

DESIGNED	DATE
DRAWN	DATE
CHECKED	DATE
APPROVED	DATE

FINAL	DATE
REVISED	DATE
REVISION	DATE
REVISION	DATE

TYL INTERNATIONAL
 157 AT STURDEL ROAD NEW INTERCHANGE
 PROPOSED RAMP D CROSS SECTIONS
 SCALE: 1" = 4' SHEET NO. 01 OF 02
 DATE: 5/10/2011

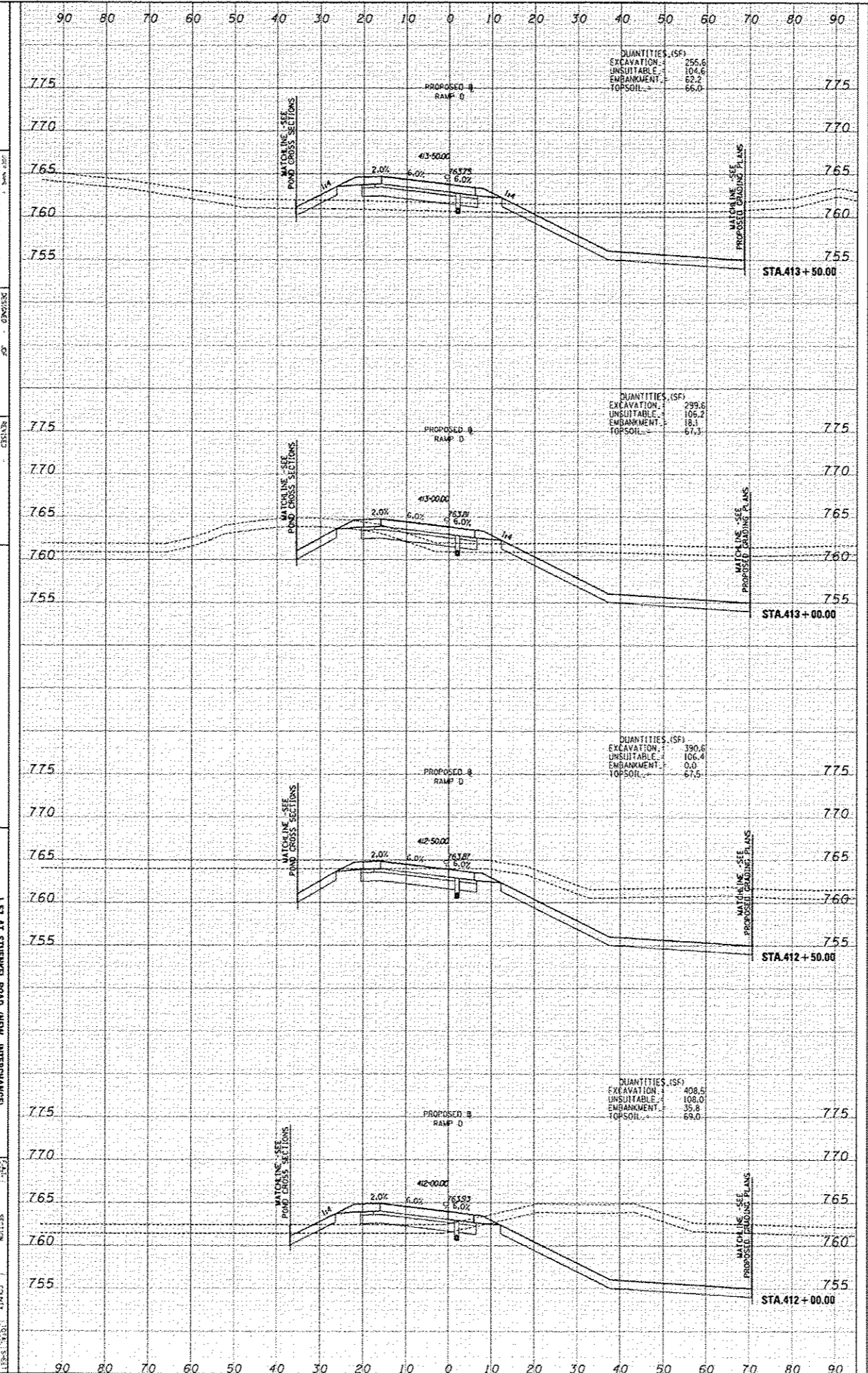

STATE OF ILLINOIS
 DEPARTMENT OF TRANSPORTATION

DESIGNED: [] DATE: []
 DRAWN: [] DATE: []
 CHECKED: [] DATE: []
 APPROVED: [] DATE: []