

NORTH EDGE OF PRECAST APPROACH SLAB

Location	Station	Offset	Theoretical Grade Elevations
W. End West Appr. Pav't	060+23.48	36.00 Lt	666.71
A1	060+33.48	36.00 Lt	666.92
A2	060+43.48	36.00 Lt	667.11
E. End West Appr. Pav't	060+53.48	36.00 Lt	667.29

NORTH GUTTER LINE

Location	Station	Offset	Theoretical Grade Elevations
W. End West Appr. Pav't	60+27.52	29.00 Lt	666.90
A1	60+37.52	29.00 Lt	667.11
A2	60+47.52	29.00 Lt	667.30
E. End West Appr. Pav't	60+57.52	29.00 Lt	667.47

CENTERLINE RDWY. & PROFILE GRADE

Location	Station	Offset	Theoretical Grade Elevations
W. End West Appr. Pav't	60+44.26	0.00	667.69
A1	60+54.26	0.00	667.87
A2	60+64.26	0.00	668.03
E. End West Appr. Pav't	60+74.26	0.00	668.17

STAGE CONSTR. LINE FOR WEARING SURFACE

Location	Station	Offset	Theoretical Grade Elevations
W. End West Appr. Pav't	060+44.84	1.00 Rt	667.69
A1	060+54.84	1.00 Rt	667.86
A2	060+64.84	1.00 Rt	668.02
E. End West Appr. Pav't	060+74.84	1.00 Rt	668.17

SOUTH GUTTER LINE

Location	Station	Offset	Theoretical Grade Elevations
W. End West Appr. Pav't	060+61.00	29.00 Rt	667.53
A1	060+71.00	29.00 Rt	667.68
A2	060+81.00	29.00 Rt	667.81
E. End West Appr. Pav't	060+91.00	29.00 Rt	667.93

SOUTH EDGE OF PRECAST APPROACH SLAB

Location	Station	Offset	Theoretical Grade Elevations
W. End West Appr. Pav't	060+65.04	36.00 Rt	667.48
A1	060+75.04	36.00 Rt	667.62
A2	060+85.04	36.00 Rt	667.75
E. End West Appr. Pav't	060+95.04	36.00 Rt	667.86

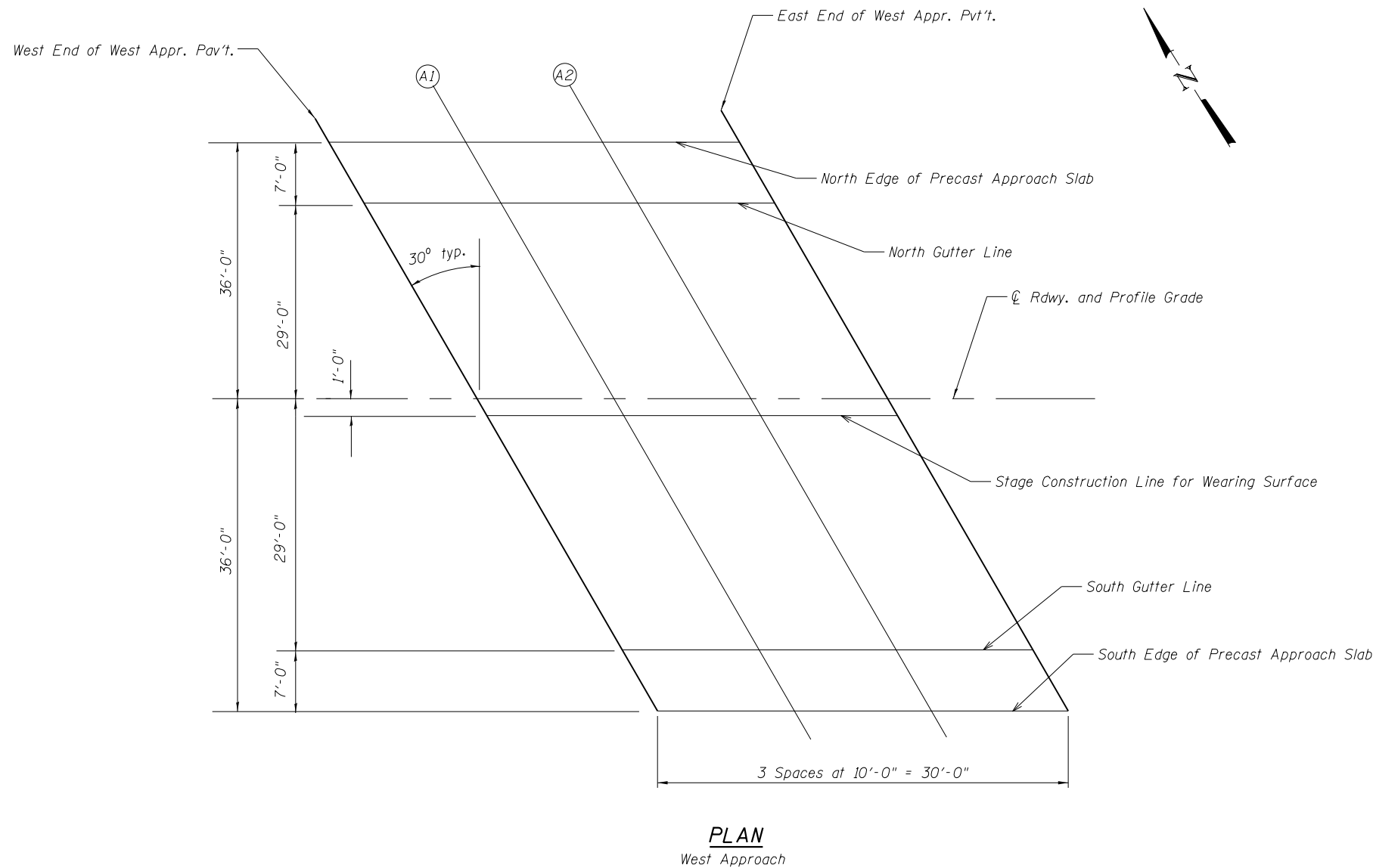

M:\JL 132 over Des\James River\12-15-001\DRAWINGS\Structural\Final Plans\CADD Sheets\049-0062_05_tos_west_appr.dgn



USER NAME = JPS
FILE NAME = 049-0062_05_tos_west_appr.dgn
PLOT DATE = 9/3/2013

DESIGNED - OY
CHECKED - DB
DRAWN - CM
CHECKED - OY

REVISED
REVISED
REVISED
REVISED

STATE OF ILLINOIS
DEPARTMENT OF TRANSPORTATION

TOP OF WEST APPROACH SLAB ELEVATIONS
STRUCTURE NO. 049-0062

SHEET NO. S5 OF S23 SHEETS

F.A.P. RTE.	SECTION	COUNTY	TOTAL SHEETS	SHEET NO.
541	X-6B-R	LAKE	93	46
ILLINOIS FED. AID PROJECT				CONTRACT NO. 60N22