

NORTH EDGE OF PRECAST APPROACH SLAB

Location	Station	Offset	Theoretical Grade Elevations
W. End East Appr. Pav't	061+85.04	36.00 Lt	668.12
A3	061+95.04	36.00 Lt	668.07
A4	062+05.04	36.00 Lt	668.00
E. End East Appr. Pav't	062+15.04	36.00 Lt	667.91

NORTH GUTTER LINE

Location	Station	Offset	Theoretical Grade Elevations
W. End East Appr. Pav't	61+89.08	29.00 Lt	668.21
A3	61+99.08	29.00 Lt	668.15
A4	62+09.08	29.00 Lt	668.08
E. End East Appr. Pav't	62+19.08	29.00 Lt	667.98

CENTERLINE RDWY. & PROFILE GRADE

Location	Station	Offset	Theoretical Grade Elevations
W. End East Appr. Pav't	62+05.82	0.00	668.56
A3	62+15.82	0.00	668.47
A4	62+25.82	0.00	668.36
E. End East Appr. Pav't	62+35.82	0.00	668.24

STAGE CONSTR. LINE FOR WEARING SURFACE

Location	Station	Offset	Theoretical Grade Elevations
W. End East Appr. Pav't	062+06.40	1.00 Rt	668.53
A3	062+16.40	1.00 Rt	668.45
A4	062+26.40	1.00 Rt	668.34
E. End East Appr. Pav't	062+36.40	1.00 Rt	668.22

SOUTH GUTTER LINE

Location	Station	Offset	Theoretical Grade Elevations
W. End East Appr. Pav't	062+22.56	29.00 Rt	667.95
A3	062+32.56	29.00 Rt	667.83
A4	062+42.56	29.00 Rt	667.70
E. End East Appr. Pav't	062+52.56	29.00 Rt	667.57

SOUTH EDGE OF PRECAST APPROACH SLAB

Location	Station	Offset	Theoretical Grade Elevations
W. End East Appr. Pav't	062+26.60	36.00 Rt	667.79
A3	062+36.60	36.00 Rt	667.67
A4	062+46.60	36.00 Rt	667.54
E. End East Appr. Pav't	062+56.60	36.00 Rt	667.40

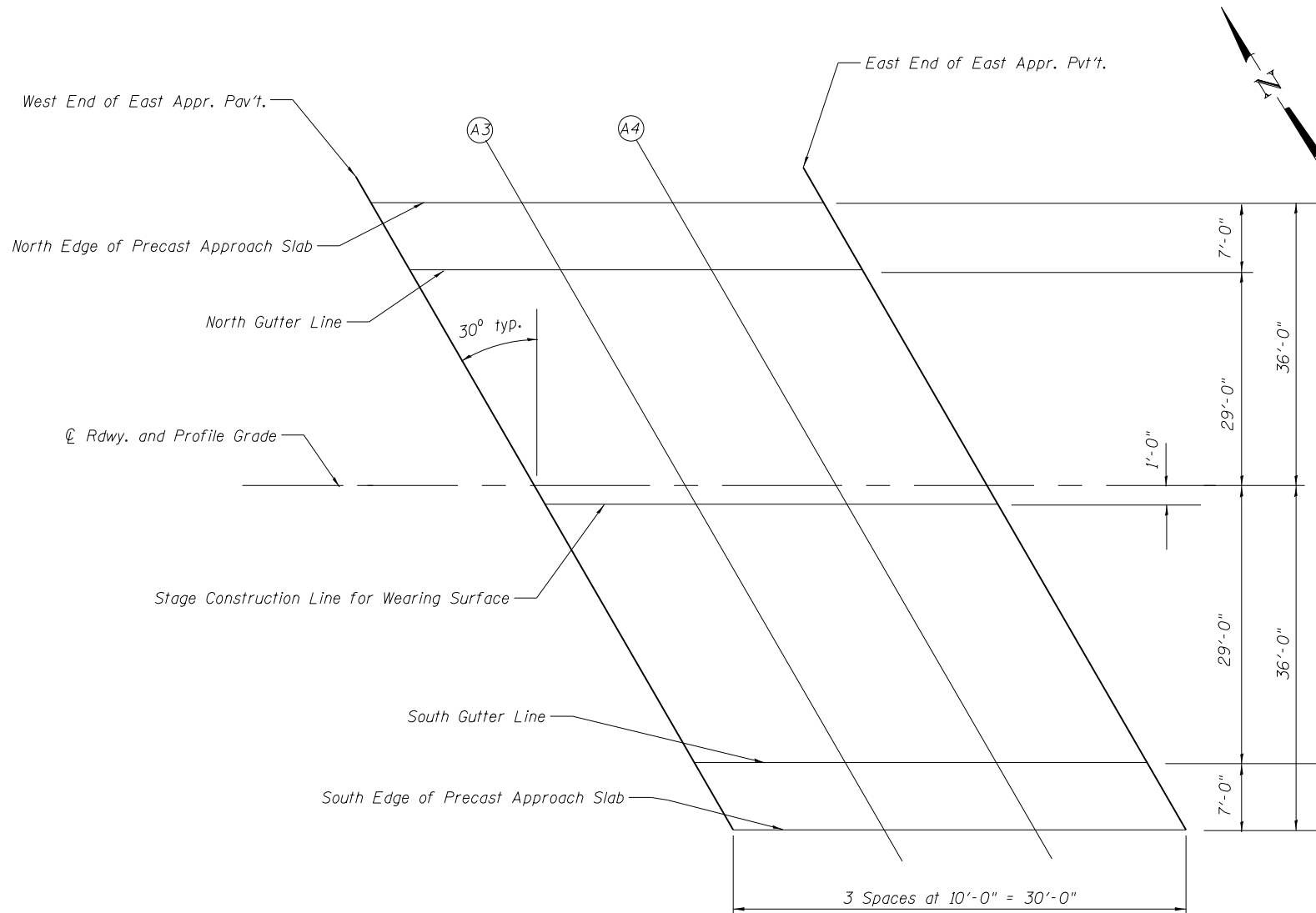

PLAN
East Approach

M:\JL 132 over- Des\James River\12-15-001\DRAWINGS\Structural\Final Plans\CADD Sheets\049-0062_06_tos_east_appr.dgn



USER NAME = JPS
 FILE NAME = 049-0062_06_tos_east_appr.dgn
 PLOT DATE = 9/3/2013

DESIGNED - OY
 CHECKED - DB
 DRAWN - CM
 CHECKED - OY

REVISED
 REVISED
 REVISED
 REVISED

STATE OF ILLINOIS
 DEPARTMENT OF TRANSPORTATION

TOP OF EAST APPROACH SLAB ELEVATIONS
 STRUCTURE NO. 049-0062

SHEET NO. 56 OF 523 SHEETS

F.A.P. RTE.	SECTION	COUNTY	TOTAL SHEETS	SHEET NO.
541	X-6B-R	LAKE	93	47
ILLINOIS FED. AID PROJECT			CONTRACT NO. 60N22	