





-  SEEDING, CLASS 2A
TOPSOIL FURNISH AND PLACE, 4 INCH
-  SEEDING, CLASS 2A
TOPSOIL FURNISH AND PLACE, 24 INCH
(PLACE IN LANDSCAPED MEDIANS)
-  SEEDING, CLASS 4
TOPSOIL FURNISH AND PLACE, 4 INCH
-  SODDING, SALT TOLERANT
TOPSOIL FURNISH AND PLACE, 4 INCH

NOTE:
1. PERMANENT SEEDING SHALL BE COVERED WITH EROSION CONTROL BLANKET

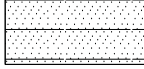

ILLINOIS ROUTE 31

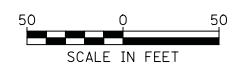
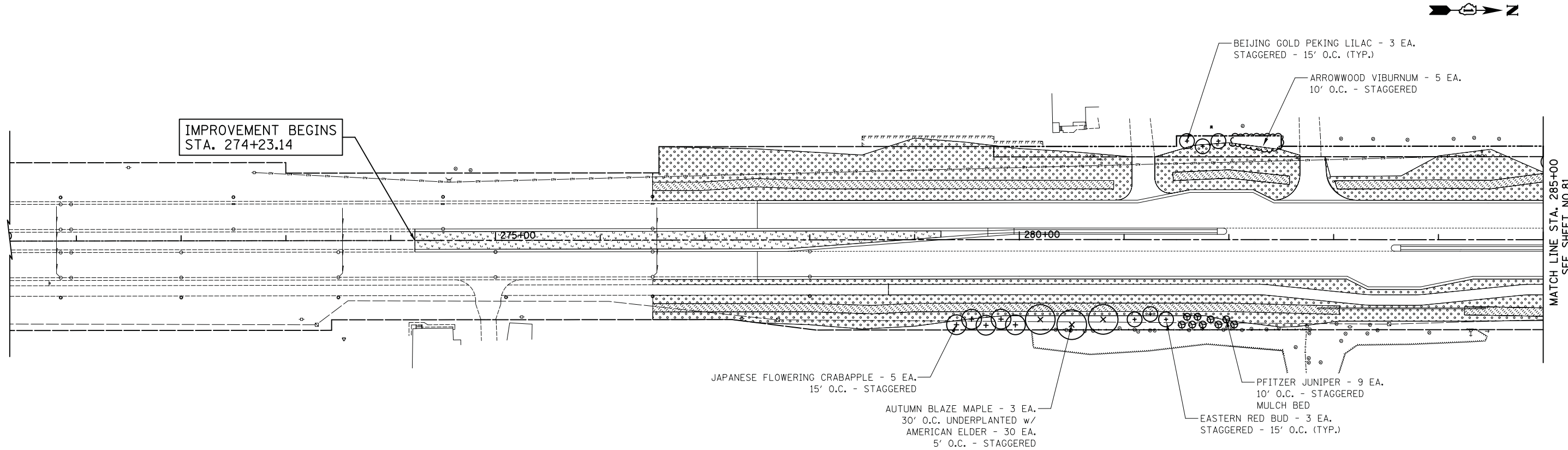
| | | | | | | | | | | | | |
|---------------------------------------|-----------------------------|-------------------|-----------|---|---|-------------------------|-------------------------------|------------------------|--------------------------|-------------------|------------------------|--------------------|
| FILE NAME = ... \2278NG.LSC_01.dgn | USER NAME = kwh | DESIGNED - KWH | REVISED - | STATE OF ILLINOIS DEPARTMENT OF TRANSPORTATION | LANDSCAPING PLAN | | | F.A.P. RTE. 3887 | SECTION 18W&RS-5 (12) | COUNTY MCHENRY | TOTAL SHEETS 151 | SHEET NO. 80 |
| | PLOT SCALE = 50.0000' / in. | CHECKED - GAB | REVISED - | | SCALE: 1" = 50' | SHEET NO. 1 OF 3 SHEETS | STA. 274+23.14 TO STA. 285+00 | CONTRACT NO. 60V72 | | | | |
| | PLOT DATE = 12/19/2013 | DATE - 12/17/2013 | REVISED - | | FED. ROAD DIST. NO. 1 ILLINOIS FED. AID PROJECT | | | | | | | |
| | | | | | | | | | | | | |