

PLAN	SURVEYED	DATE
	PLOTTED	BY
	CHECKED	
	ALIGNED	
	CAD FILE NAME	
	NO.	

PROFILE	SURVEYED	DATE
	PLOTTED	BY
	CHECKED	
	GRADES	
	STRUCTURE	
	NOTATIONS	
	CHPKD	
	NO.	

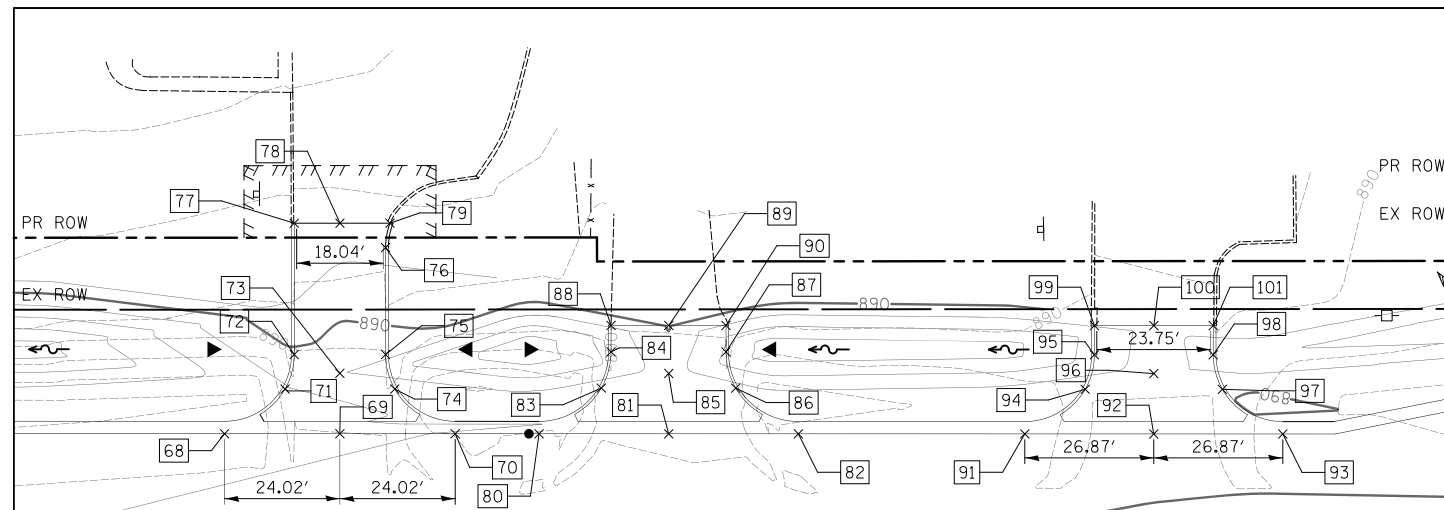

DETAIL "E"
 COMMERCIAL ENTRANCE
 STA. 303+60.61, LT
 STA. 304+29.09, LT
 STA. 305+30.20, LT

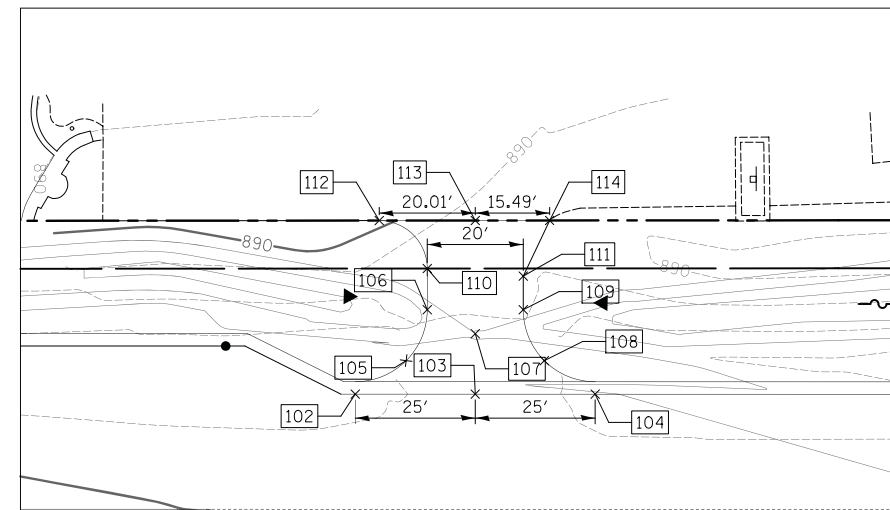

DETAIL "F"
 COMMERCIAL ENTRANCE
 STA. 307+15.99, LT

LEGEND
 (XXX.XX) EXISTING PAVEMENT ELEVATION
 XXX.XX PROPOSED PAVEMENT ELEVATION

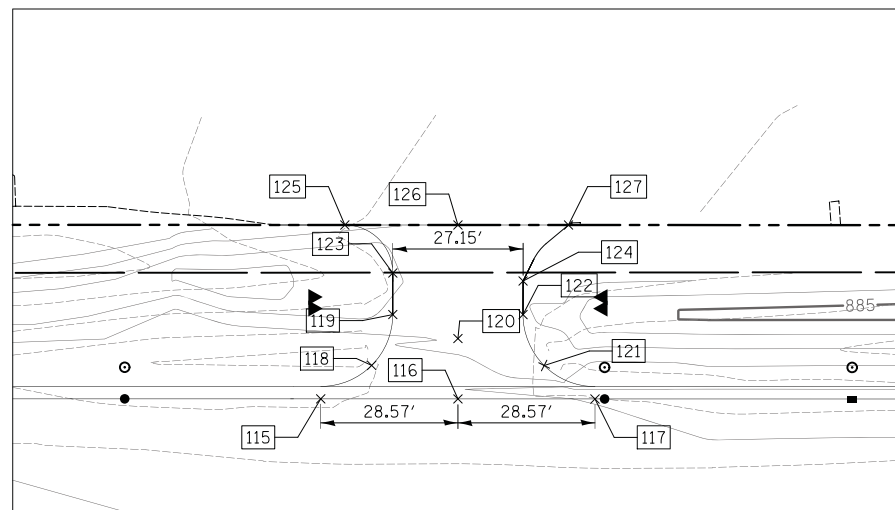

DETAIL "G"
 COMMERCIAL ENTRANCE
 STA. 308+97.85, LT

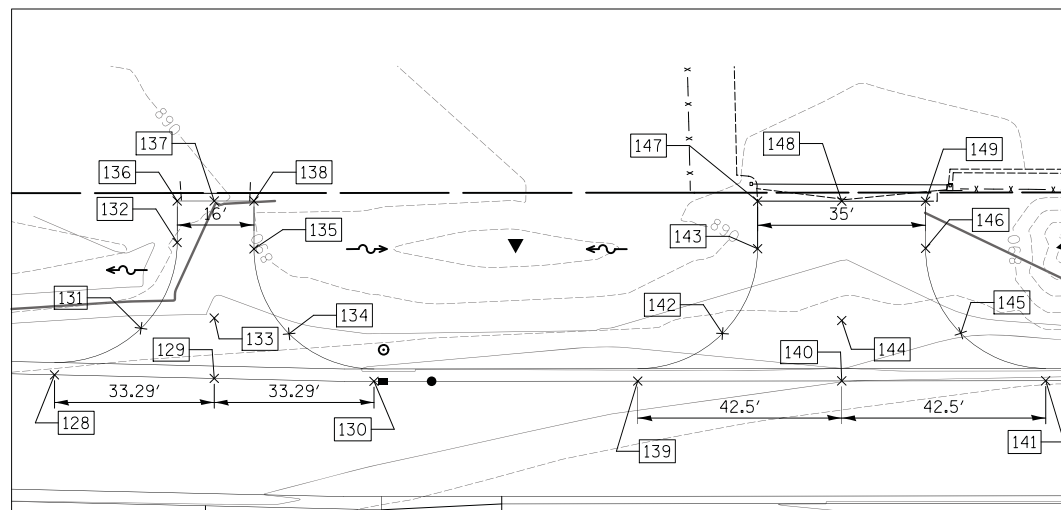

DETAIL "H"
 COMMERCIAL ENTRANCE
 STA. 318+48.92, LT

POINT	STATION	OFFSET	ELEVATION
68	303+36.59	35.00' LT	888.79
69	303+60.61	35.00' LT	888.91
70	303+84.63	35.00' LT	889.03
71	303+49.19	44.31' LT	888.93
72	303+51.09	51.50' LT	889.33
73	303+60.61	47.58' LT	889.11
74	303+72.04	44.31' LT	889.15
75	303+70.13	51.50' LT	889.51
76	303+70.13	73.79' LT	891.30
77	303+51.09	78.86' LT	(891.63)
78	303+60.61	78.86' LT	(891.62)
79	303+71.05	78.87' LT	(891.63)
80	304+02.11	35.00' LT	889.12
81	304+29.13	35.00' LT	889.25
82	304+56.16	35.00' LT	889.39
83	304+15.08	44.53' LT	889.25
84	304+17.12	52.08' LT	889.71
85	304+29.13	47.58' LT	889.46
86	304+43.09	44.53' LT	889.53
87	304+41.05	52.08' LT	889.88
88	304+17.12	57.58' LT	(890.02)
89	304+29.13	57.58' LT	(890.09)
90	304+41.05	57.58' LT	(890.12)
91	305+03.33	35.00' LT	889.62
92	305+30.20	35.00' LT	889.71
93	305+57.08	35.00' LT	889.75
94	305+15.92	44.31' LT	889.50
95	305+17.83	51.50' LT	889.45
96	305+30.20	47.58' LT	889.52
97	305+44.49	44.31' LT	889.89
98	305+42.58	51.50' LT	889.42
99	305+17.83	57.58' LT	(889.40)
100	305+30.20	57.58' LT	(889.40)
101	305+42.58	57.58' LT	(889.48)
102	306+90.99	35.00' LT	889.32
103	307+15.99	35.00' LT	889.17
104	307+40.99	35.00' LT	889.03
105	307+01.59	41.97' LT	889.21
106	307+05.99	52.58' LT	889.09
107	307+15.99	47.58' LT	888.98
108	307+30.38	41.97' LT	888.95

POINT	STATION	OFFSET	ELEVATION
109	307+25.99	52.58' LT	888.87
110	307+05.98	61.16' LT	889.53
111	307+25.99	59.58' LT	889.22
112	306+95.98	71.16' LT	(890.21)
113	307+15.99	71.17' LT	(889.88)
114	307+31.48	71.19' LT	(889.69)
115	308+69.28	35.00' LT	888.29
116	308+97.85	35.00' LT	888.13
117	309+26.43	35.00' LT	887.98
118	308+79.89	41.97' LT	888.17
119	308+84.28	52.58' LT	888.05
120	308+97.85	47.58' LT	887.93
121	309+15.82	41.97' LT	887.89
122	309+11.43	52.58' LT	887.80
123	308+84.28	61.24' LT	887.95
124	309+11.43	59.58' LT	887.72
125	308+74.28	71.24' LT	(887.98)
126	308+97.85	71.24' LT	(887.72)
127	309+20.89	71.24' LT	(887.48)
128	316+84.92	33.77' LT	891.28
129	317+18.21	33.03' LT	891.47
130	317+51.50	32.44' LT	891.65
131	317+02.95	43.47' LT	890.82
132	317+10.47	61.35' LT	890.36
133	317+18.21	45.62' LT	891.27
134	317+33.81	42.33' LT	891.11
135	317+26.47	60.02' LT	890.56
136	317+10.47	70.00' LT	(889.88)
137	317+18.21	70.00' LT	(889.98)
138	317+26.47	70.00' LT	(890.05)
139	318+06.45	32.50' LT	891.88
140	318+48.95	32.55' LT	892.00
141	318+91.45	32.61' LT	892.04
142	318+24.11	42.42' LT	891.82
143	318+31.42	60.08' LT	890.76
144	318+48.95	45.13' LT	891.80
145	318+73.75	42.50' LT	891.73
146	318+66.42	60.19' LT	890.80
147	318+31.42	70.00' LT	(890.11)
148	318+48.95	70.00' LT	(890.21)
149	318+66.42	70.00' LT	(890.14)

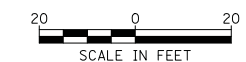

FILE NAME = ... \2278NG-sht-details.02.dgn	USER NAME = kwh	DESIGNED - KWH	REVISED -
	PLOT SCALE = 20.0000' / in.	DRAWN - KWH	REVISED -
	PLOT DATE = 8/5/2013	CHECKED - GAB	REVISED -
		DATE - 06/24/2013	REVISED -

STATE OF ILLINOIS
 DEPARTMENT OF TRANSPORTATION

GRADING DETAILS

SCALE: 1" = 20' SHEET NO. 2 OF 2 SHEETS STA. -- TO STA. --

F.A.U. RTE.	SECTION	COUNTY	TOTAL SHEETS	SHEET NO.
3887	18W&RS-5 (12)	MCHENRY	151	101
CONTRACT NO. 60V72			FED. ROAD DIST. NO. 1 ILLINOIS FED. AID PROJECT	