

Bench Mark: Chisel "X" on south flange bolt of first fire hydrant south of Van Buren Street on west side of Peoria Street. Elev. 594.37
 The road will be closed and traffic detoured during construction.

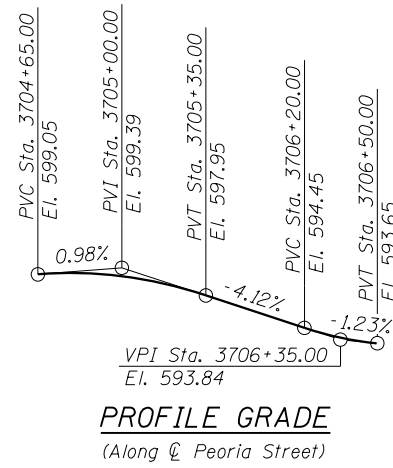
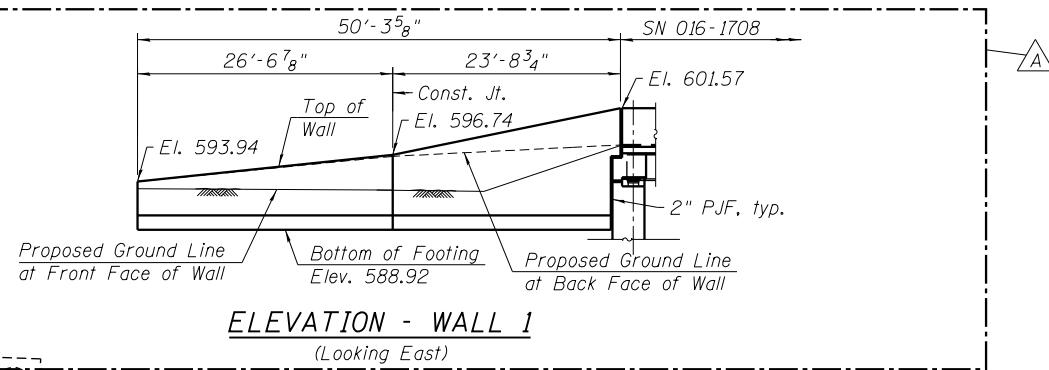

GENERAL NOTES

1. Reinforcement bars designated (E) shall be epoxy coated.
2. All construction joints shall be bonded.
3. Minimum bar laps shall be:

Bar	Min. Lap
#4	2'-7"
#5	3'-3"
4. Station and offsets are measured from the centerline of Peoria Street to the front face of the wall.
5. Exposed concrete edges shall have a standard $\frac{3}{4}$ " chamfer unless otherwise noted. Chamfer on vertical edges shall be continued a minimum of 1 foot below the finished ground line.

INDEX OF SHEETS

- 1 General Plan and Elevation
- 2 Retaining Wall 1 Details

DESIGN SPECIFICATIONS

2012 AASHTO LRFD Bridge Design Specifications
 6th Edition, with 2013 Interim Revisions

DESIGN STRESSES

FIELD UNITS
 f'c = 3,500 psi
 fy = 60,000 psi (Reinforcement)

TOTAL BILL OF MATERIAL

Item	Unit	Quantity
Structural Excavation	Cu. Yd.	75
Concrete Structures	Cu. Yd.	28.9
Reinforcement Bars, Epoxy Coated	Pound	2,130
Concrete Sealer	Sq. Ft.	337
Geocomposite Wall Drain	Sq. Yd.	37
Granular Backfill for Structures	Cu. Yd.	36
Pipe Underdrains for Structures 4"	Foot	51

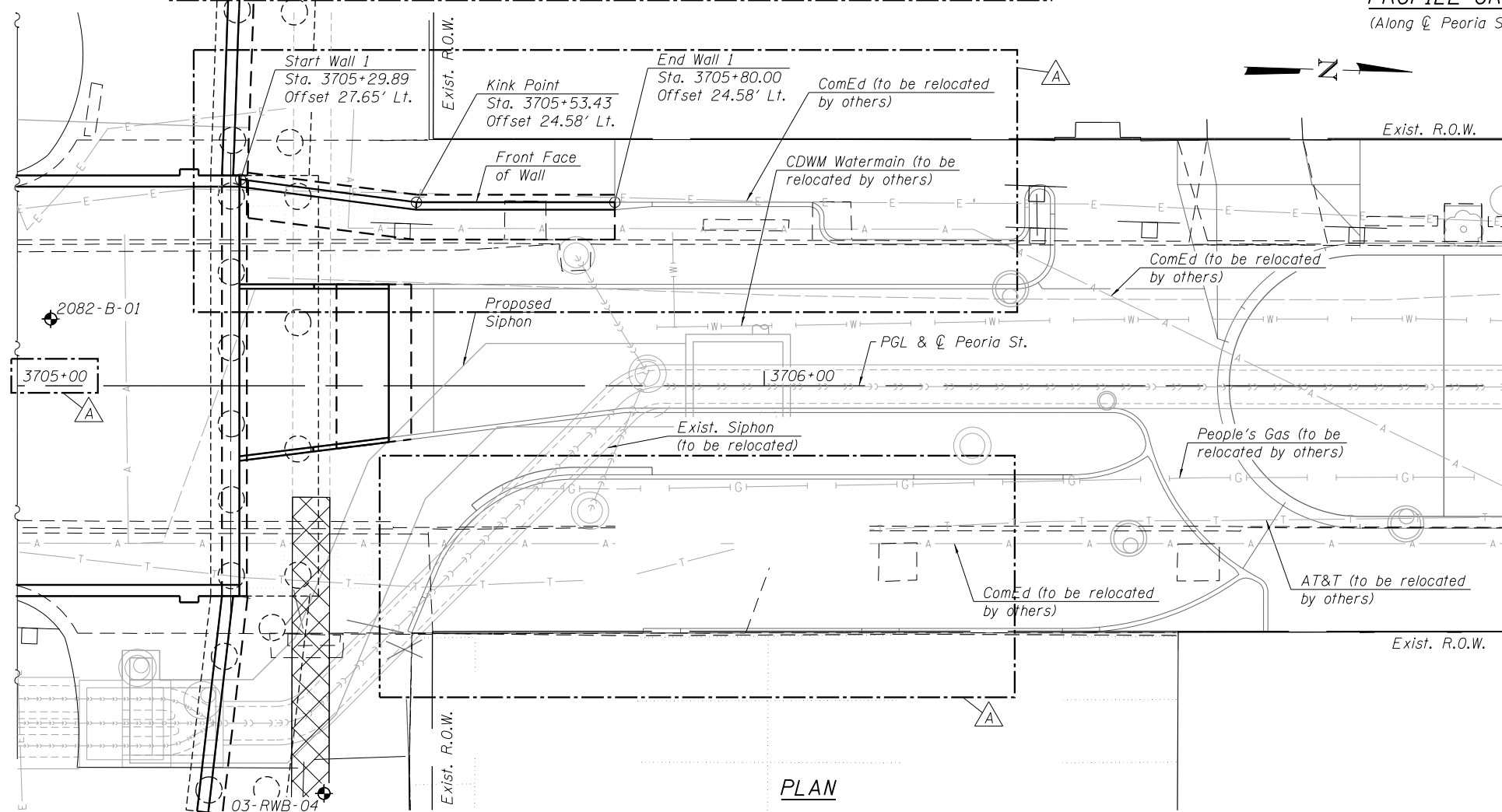

LEGEND

◆ Soil Boring Location

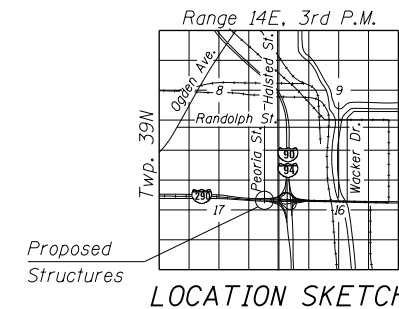

GENERAL PLAN AND ELEVATION
RETAINING WALL ALONG PEORIA STREET
MUN 2090 SECTION 2013-011R
COOK COUNTY

WALL 1-STATION 3705+29.89 TO 3705+80.00

10:34:29 AM
 0161708-GOW29-5164-RetWall_GP.dgn



USER NAME = BAWitorf	DESIGNED MDS	REVISED A 12/18/2013 WJC/MDS
PLOT SCALE = 20.0002' / in.	CHECKED KAH	REVISED
PLOT DATE = 12/19/2013	DRAWN WJC	REVISED
	CHECKED MDS	REVISED

STATE OF ILLINOIS
DEPARTMENT OF TRANSPORTATION

SHEET NO. 1 OF 2 SHEETS

MUN	SECTION	COUNTY	TOTAL SHEETS	SHEET NO.
2090	2013-011R	COOK	356	188
CONTRACT NO.			60W29	

ILLINOIS FED. AID PROJECT