

Bench Mark: Chisel "X" on south flange bolt of first fire hydrant south of Van Buren Street on west side of Peoria Street. Elev. 594.37
 The road will be closed and traffic detoured during construction.

A

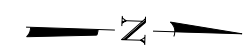

GENERAL NOTES

1. Station and offsets are measured from the centerline of Peoria Street to the front face of the wall.

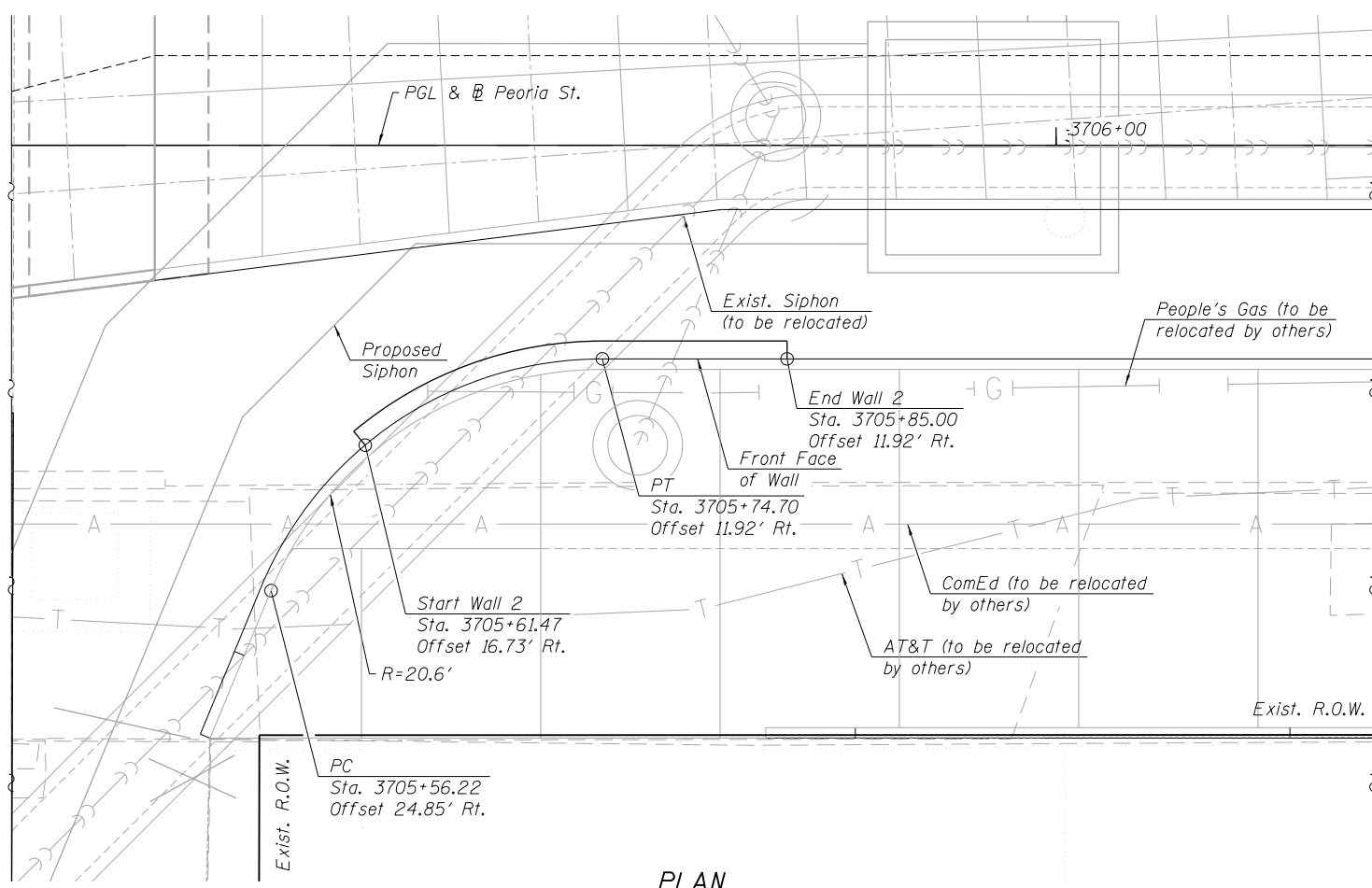

PLAN

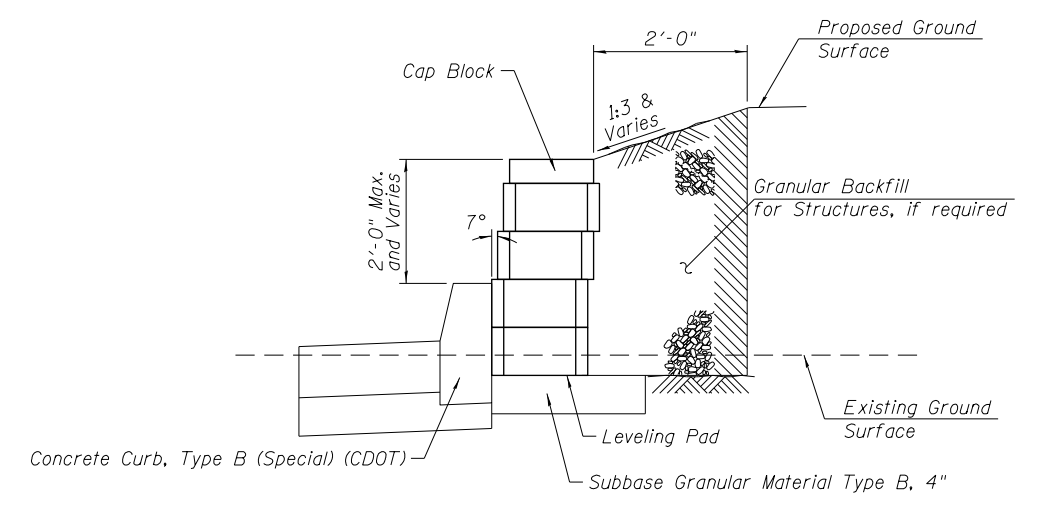

SECTION A-A

TOTAL BILL OF MATERIAL

Item	Unit	Quantity
Segmental Concrete Block Wall	Sq. Ft.	50

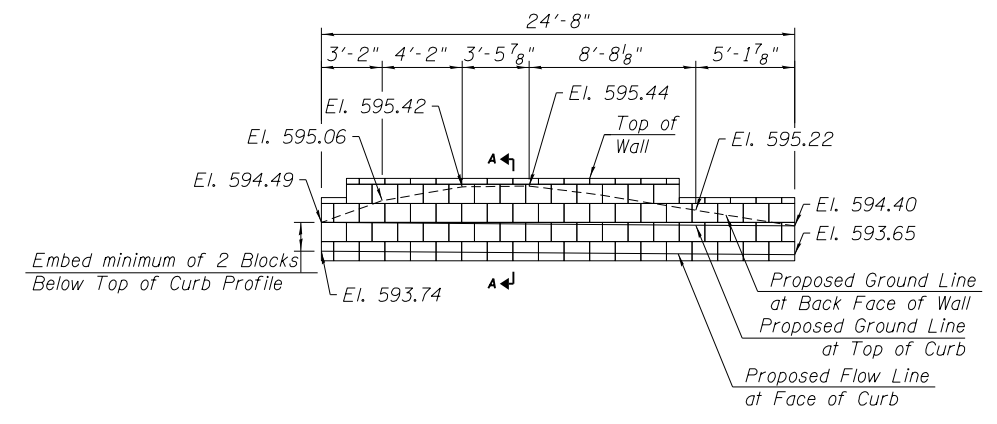

ELEVATION - WALL 2
(Looking West)

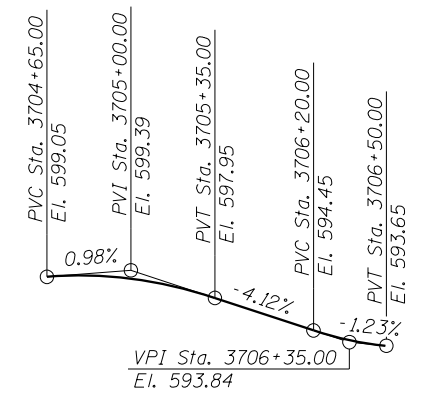

PROFILE GRADE
(Along Peoria Street)

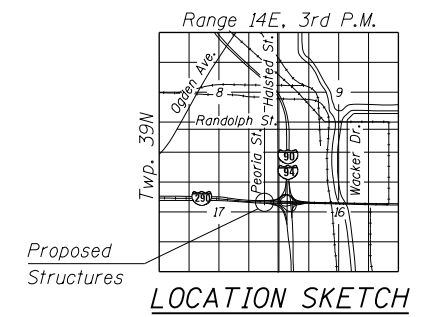

LOCATION SKETCH

**GENERAL PLAN AND ELEVATION
 RETAINING WALL ALONG PEORIA STREET
 MUN 2090 SECTION 2013-011R
 COOK COUNTY
 WALL 2-STATION 3705+61.47 TO 3705+85.00**

10:34:33 AM 0161708-60W29-5165A-Res+Wall2.dgn



USER NAME = BAWItoft	DESIGNED MDS	REVISION 12/18/2013 KAL/JMG
PLOT SCALE = 10.0001' / in.	CHECKED KAH	REVISION
PLOT DATE = 12/19/2013	DRAWN WJC	REVISION
	CHECKED MDS	REVISION

**STATE OF ILLINOIS
 DEPARTMENT OF TRANSPORTATION**

SHEET NO. 1 OF 1 SHEETS

MUN 2090	SECTION 2013-011R	COUNTY COOK	TOTAL SHEETS 356	SHEET NO. 190
CONTRACT NO. 60W29			ILLINOIS FED. AID PROJECT	