

02-28-14 LETTING ITEM 065

STATE OF ILLINOIS
DEPARTMENT OF TRANSPORTATION
DIVISION OF HIGHWAYS

**PLANS FOR PROPOSED
FEDERAL AID HIGHWAY
BUTTERFIELD ROAD, BANBURY ROAD,
LAUREL DRIVE**

**VOLKS COURT TO LAUREL DRIVE, DORAL LANE TO OBERWEIS DRIVE,
AND CHESTNUT STREET TO EXISTING SIDEWALK,
AND BUTTERFIELD ROAD TO SPRUCE STREET PROPOSED SIDEWALKS**

**SECTION 12-00053-00-SW
PROJECT SRTS-4009 (117)
VILLAGE OF NORTH AURORA
KANE COUNTY
C-91-361-12**

F.A. RTE.	SECTION	COUNTY	TOTAL SHEETS	SHEET NO.
	12-00053-00-SW	KANE	27	1
		ILLINOIS	CONTRACT NO. 63897	



LOCATION OF SECTION INDICATED THIS: - [Symbol] -

PROGRAM AND OFFICE ENGINEER: CHARLES F. RIDDLE, P.E. (847) 705-4406 SCHAUMBURG, IL

STREET	DESIGN DESIGNATION	POSTED SPEED	TRAFFIC VOLUME
BUTTERFIELD ROAD	OTHER ARTERIAL	45 MPH	11,800 ADT
BANBURY ROAD	LOCAL ROAD	25 MPH	< 500 ADT
LAUREL DRIVE	LOCAL ROAD	25 MPH	< 500 ADT

REMPE-SHARPE
CONSULTING ENGINEERS
IL P.D.F. LICENSE NO. 164-000895
324 WEST STATE STREET - GENEVA, ILLINOIS 60134
Telephone (630) 232-0827 - Fax (630) 232-1629

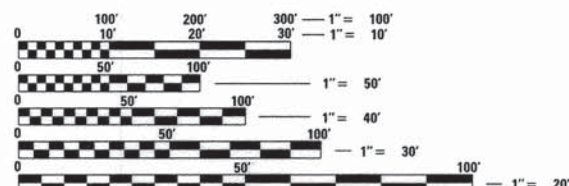

FULL SIZE PLANS HAVE BEEN PREPARED USING STANDARD ENGINEERING SCALES. REDUCED SIZED PLANS WILL NOT CONFORM TO STANDARD SCALES. IN MAKING MEASUREMENTS ON REDUCED PLANS, THE ABOVE SCALES MAY BE USED.

J.U.L.I.E.
JOINT UTILITY LOCATION INFORMATION FOR EXCAVATION
1-800-892-0123
OR 811

PROJECT ENGINEER: DOUGLAS W. RANNEY II, P.E.
PROJECT MANAGER: JAMES J. BIBBY, S.E., P.E.

CONTRACT NO. 63897

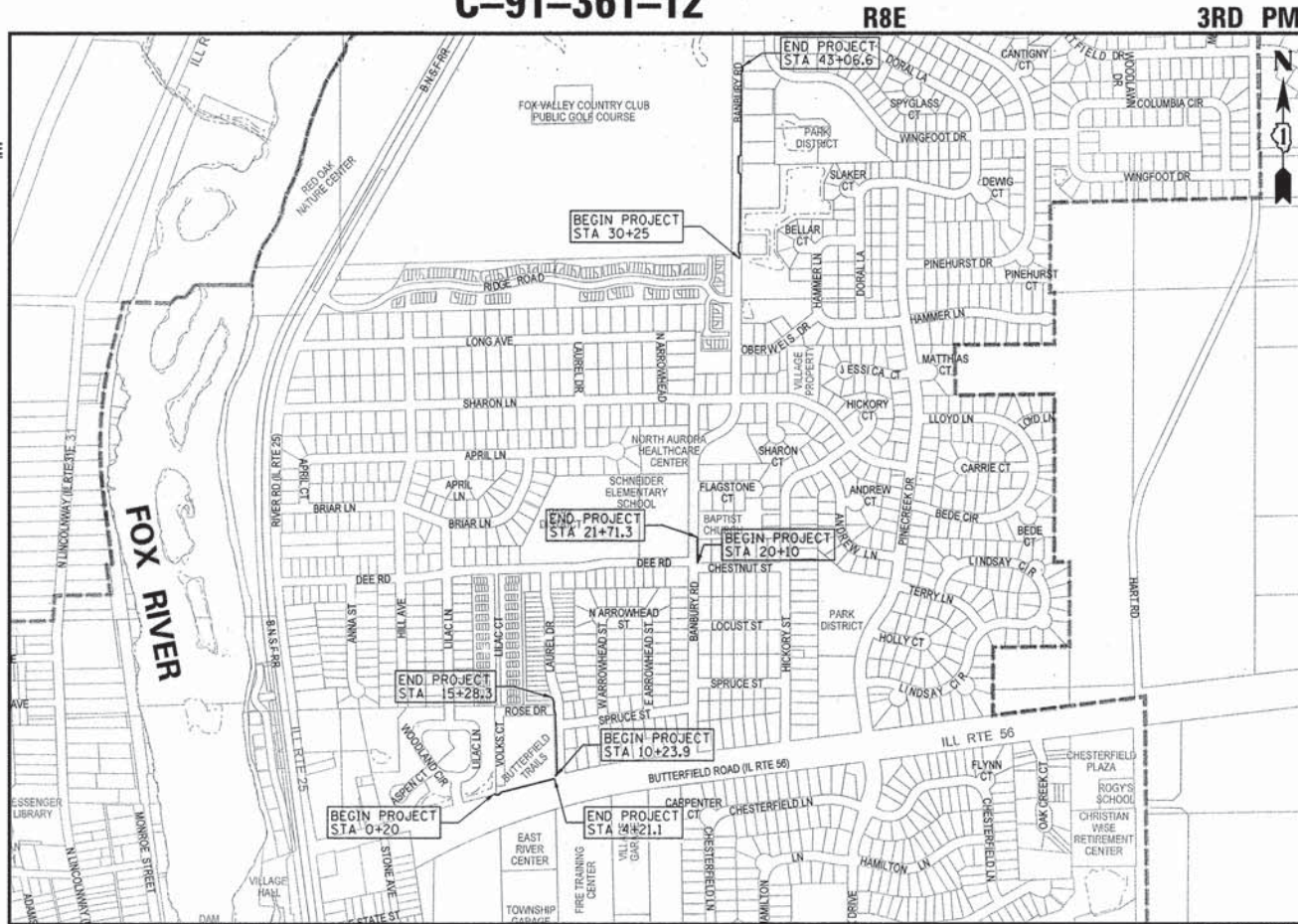

BATAVIA TOWNSHIP

IL RTE 56 (BUTTERFIELD ROAD)	=	401.1 LF	=	0.075 MILES
LAUREL DRIVE	=	505.4 LF	=	0.095 MILES
BANBURY ROAD	=	1,442.9 LF	=	0.27 MILES
GROSS AND NET LENGTH	=	2,349.4 LF	=	0.44 MILES

SCALE: 1"=600'

STATE OF ILLINOIS
DEPARTMENT OF TRANSPORTATION
DIVISION OF HIGHWAYS

APPROVED Nov. 18 2013
Dale Bema
VILLAGE OF NORTH AURORA

PASSED DECEMBER 17 2013
C. Holt
DISTRICT ONE ENGINEER OF LOCAL ROADS AND STREETS

RELEASING FOR BID BASED ON LIMITED REVIEW December 17 2013
John Peterson
DEPUTY DIRECTOR OF HIGHWAYS, REGION ONE ENGINEER

Douglas W. Ranney
DOUGLAS W. RANNEY
ILLINOIS REGISTERED PROFESSIONAL ENGINEER
NO. 062-061276 EXPIRES 11-30-15

**PRINTED BY THE AUTHORITY
OF THE STATE OF ILLINOIS**

INDEX OF SHEETS

- 1 COVER SHEET
- 2 INDEX OF SHEETS, LISTING OF APPLICABLE HIGHWAY STANDARDS, GENERAL NOTES, COMMITMENTS
- 3 SUMMARY OF QUANTITIES
- 4 TYPICAL SECTIONS
- 5 SCHEDULE OF QUANTITIES
- 6 IL RTE 56 (BUTTERFIELD ROAD), LAUREL DR AND BANBURY ROAD - ALIGNMENT TIES
- 7 BANBURY ROAD - ALIGNMENT TIES
- 8 IL RTE 56 (BUTTERFIELD ROAD) SIDEWALK PLAN AND PROFILE
- 9 LAUREL DRIVE SIDEWALK PLAN AND PROFILE
- 10 - 13 BANBURY ROAD SIDEWALK PLAN AND PROFILE
- 14 IL RTE 56 (BUTTERFIELD ROAD) AND LAUREL DRIVE EROSION AND SEDIMENTATION CONTROL PLAN
- 15 - 16 BANBURY ROAD EROSION AND SEDIMENTATION CONTROL PLAN
- 17 EROSION AND SEDIMENTATION CONTROL PLAN AND DETAILS
- 18 RAILING DETAILS
- 19 TRAFFIC CONTROL AND PROTECTION FOR SIDE ROADS, INTERSECTIONS AND DRIVEWAYS
- 20 DISTRICT ONE TYPICAL PAVEMENT MARKINGS
- 21 ARTERIAL ROAD INFORMATION SIGN
- 22 IL RTE 56(BUTTERFIELD ROAD) CROSS SECTIONS
- 23 LAUREL DRIVE CROSS SECTIONS
- 24-27 BANBURY ROAD CROSS SECTIONS

GENERAL NOTES

1. SPECIFICATIONS, STANDARDS AND SPECIAL PROVISIONS:
 ALL CONSTRUCTION SHALL BE PERFORMED IN ACCORDANCE WITH THE ILLINOIS DEPARTMENT OF TRANSPORTATION "STANDARD SPECIFICATIONS FOR ROAD AND BRIDGE CONSTRUCTION", ADOPTED JAN. 1, 2012 (HEREINAFTER REFERRED TO AS THE STANDARD SPECIFICATIONS); THE "SUPPLEMENTAL SPECIFICATIONS AND RECURRING SPECIAL PROVISIONS", ADOPTED JANUARY 1, 2014; THE LATEST EDITION OF THE "ILLINOIS MANUAL ON UNIFORM TRAFFIC CONTROL DEVICES FOR STREETS AND HIGHWAYS"; THE "DETAILS" ON THE PLANS AND THE "SPECIAL PROVISIONS" INCLUDED IN THE CONTRACT DOCUMENTS.

 ANY REFERENCE TO STANDARDS THROUGHOUT THE PLANS OR SPECIAL PROVISIONS SHALL BE INTERPRETED AS THE LATEST STANDARD OF THE DEPARTMENT.
2. PROTECTION OF PUBLIC/PRIVATE PROPERTY:
 THE CONTRACTOR SHALL PROTECT ALL EXISTING TREES TO REMAIN; SHRUBS, FENCES, DRAIN LINES, POWER LINES, AND OTHER PUBLIC/PRIVATE PROPERTY. ANY ITEM THAT IS DAMAGED SHALL BE REPLACED OR REPAIRED BY THE CONTRACTOR AS DIRECTED BY THE ENGINEER AT NO COST.
3. EXISTING STREET CLEANLINESS:
 THE CONTRACTOR SHALL KEEP EXISTING AND ADJACENT STREETS CLEAN OF DIRT, MUD, AND OTHER DEBRIS AND, WHEN NECESSARY, CLEAN SAID PAVEMENTS ON A DAILY BASIS.
4. REMOVAL, MAINTENANCE AND RESETTING EXISTING MAILBOXES, STREET SIGNS AND STOP SIGNS:
 EXISTING MAILBOXES, STREET SIGNS, AND STOP SIGNS WHICH INTERFERE WITH CONSTRUCTION SHALL BE REMOVED AND TEMPORARILY RELOCATED DURING CONSTRUCTION BY THE CONTRACTOR. AFTER THE WORK HAS BEEN SUBSTANTIALLY COMPLETED, SAID MAILBOXES AND SIGNS SHALL BE RESET AT A LOCATION SPECIFIED BY THE ENGINEER. THE COST OF THIS WORK SHALL BE CONSIDERED AS INCLUDED IN THE COST OF THE CONTRACT WITH NO ADDITIONAL COMPENSATION ALLOWED. ANY SIGN DAMAGED OR LOST SHALL BE REPLACED AT THE CONTRACTOR'S EXPENSE. TEMPORARY STOP SIGNS SHALL BE PLACED AS REQUIRED BY THE VILLAGE AS PART OF THE TRAFFIC CONTROL AND PROTECTION PAY ITEM.
5. CONSTRUCTION LIMITS:
 THE CONTRACTOR SHALL CONFINE HIS OPERATIONS WITHIN THE DEDICATED ROADWAY RIGHT-OF-WAY OR EASEMENTS OBTAINED BY THE VILLAGE OF NORTH AURORA. ANY DAMAGE OUTSIDE OF SAID RIGHT-OF-WAY OR EASEMENTS SHALL BE REPAIRED AT THE CONTRACTOR'S EXPENSE.
6. BARRICADES:
 THE CONTRACTOR SHALL PROVIDE AND INSTALL TWO(2) WEIGHTED SANDBAGS ON EACH TYPE I OR TYPE III BARRICADE USED. ONE (1) WEIGHTED SANDBAG ACROSS EACH RAIL.

APPLICABLE IDOT HIGHWAY STANDARDS

IDOT NO.	STANDARD DRAWINGS
000001-06	Standard Symbols, Abbreviations and Patterns
280001-07	Temporary Erosion Control Systems
424001-07	Perpendicular Curb Ramps for Sidewalks
424011-01	Corner Parallel Curb Ramps for Sidewalks
542301-03	Precast Reinforced Concrete Flared End Section
602306-03	Inlet, Type B
604001-03	Frame and Lids, Type 1
604036-02	Grate, Type 8
701001-02	Off-Rd Operations 2L, 2W, More than 15' Away
701006-05	Off-Rd Operations, 2L, 2W, 15' to 24" From Pavement Edge
701011-04	Off-Road Moving Operations, 2L, 2W, Day Only
701101-04	Off-Rd Operations Multilane, 15' to 24" From Pavement Edge
701106-02	Off-Rd Operations, Multilane, More than 15' Away
701801-05	Sidewalk Corner or Crosswalk Closure
701901-03	Traffic Control Devices
BLR23-4	Traffic Barrier Terminal Type 1

PLAN	DESIGNED BY	DATE
NOTE BOOK NO.	CHECKED BY	
	IN CHARGE	
	FILED	

PROFILE	DESIGNED BY	DATE
NOTE BOOK NO.	CHECKED BY	
	IN CHARGE	
	FILED	

FILE NAME #	USER NAME # USER.	DESIGNED - DWR	REVISED -
N:\dgn\NA\NA498_ssd\elk\FinalDrawings\NA498NotesSumQuantitiesIndex.dgn		DRAWN - GR	REVISED -
PLOT SCALE = 1.00 ft / IN.		CHECKED - JJB	REVISED -
PLOT DATE = 12/10/2013		DATE - DEC 2013	REVISED -

**STATE OF ILLINOIS
DEPARTMENT OF TRANSPORTATION**

INDEX OF SHEETS, LISTING OF APPLICABLE HIGHWAY STANDARDS, GENERAL NOTES, COMMITMENTS			
SCALE:	SHEET 2 OF 27 SHEETS	STA.	TO STA.

F.A.U. RTE.	SECTION	COUNTY	TOTAL SHEETS	SHEET NO.
	12-00053-00-SW	KANE	27	2
			CONTRACT NO. 63897	
[ILLINOIS] FED. AID PROJECT				

SUMMARY OF QUANTITIES

ITEM NO.	ITEM DESCRIPTION	UNIT	TOTAL QUANTITY	CONSTRUCTION
				TYPE CODE OO21
20101200	TREE ROOT PRUNING	EACH	6	6
20101300	TREE PRUNING (1 TO 10 INCH DIAMETER)	EACH	5	5
20101350	TREE PRUNING (OVER 10 INCH DIAMETER)	EACH	6	6
20101400	NITROGEN FERTILIZER NUTRIENT	POUND	27	27
20101500	PHOSPHOROUS FERTILIZER NUTRIENT	POUND	27	27
20101600	POTASSIUM FERTILIZER NUTRIENT	POUND	27	27
20200100	EARTH EXCAVATION	CU YD	498	498
20800150	TRENCH BACKFILL	CU YD	5	5
21101625	TOPSOIL FURNISH AND PLACE, 6"	SQ YD	1450	1450
21400100	GRADING AND SHAPING DITCHES	FOOT	200	200
25000100	SEEDING, CLASS 1	ACRE	0.32	0.32
25100630	EROSION CONTROL BLANKET	SQ YD	1450	1450
28000400	PERIMETER EROSION BARRIER	FOOT	260	260
28000500	INLET AND PIPE PROTECTION	EACH	7	7
35101600	AGGREGATE BASE COURSE, TYPE B 4"	SQ YD	11795	11795
40200500	AGGREGATE SURFACE COURSE, TYPE A 6"	SQ YD	11	11
40300100	BITUMINOUS MATERIALS (PRIME COAT)	GALLON	16	16

40603080	HOT-MIX ASPHALT BINDER COURSE, IL-19.0, N50	TON	8	8
40603335	HOT-MIX ASPHALT SURFACE COURSE, MIX "D", N50	TON	8	8
42400200	PORTLAND CEMENT CONCRETE SIDEWALK 5 INCH	SQ FT	11795	11795
42400800	DETECTABLE WARNINGS	SQ FT	8	8
44000200	DRIVEWAY PAVEMENT REMOVAL	SQ YD	53	53
44000500	COMBINATION CURB AND GUTTER REMOVAL	FOOT	7	7
44000600	SIDEWALK REMOVAL	SQ FT	105	105
* 50901720	BICYCLE RAILING	FOOT	30	30
54213657	PRECAST REINFORCED CONCRETE FLARED END SECTIONS 12"	EACH	4	4
550A0050	STORM SEWERS, CLASS A, TYPE 1 12"	FOOT	56	56
60218300	MANHOLES, TYPE A, 4'-DIAMETER, TYPE 1 FRAME, OPEN LID	EACH	1	1
60265700	VALVE VAULTS TO BE ADJUSTED	EACH	1	1
60266600	VALVE BOXES TO BE ADJUSTED	EACH	1	1
60603800	COMBINATION CONCRETE CURB AND GUTTER, TYPE B-6.12	FOOT	7	7
* 63000001	STEEL PLATE BEAM GUARDRAIL, TYPE A, 6 FOOT POSTS	FOOT	110	110
63200310	GUARDRAIL REMOVAL	FOOT	54	54
67100100	MOBILIZATION	L SUM	1	1
70102640	TRAFFIC CONTROL AND PROTECTION, STANDARD 701801	L SUM	1	1
* 78000600	THERMOPLASTIC PAVEMENT MARKING - LINE 12"	FOOT	70	70
* LR631020	TRAFFIC BARRIER TERMINAL, TYPE 1	EACH	2	2
Z0018700	DRAINAGE STRUCTURE TO BE REMOVED	EACH	2	2
Z0030850	TEMPORARY INFORMATION SIGNING	SQ FT	205.6	205.6

* SPECIALTY ITEMS

PLAN	REVISIONS	DATE
NOTE BOOK	PLOTTED	
NO.	ALIGNMENT CHECKED	
	CAD FILE NAME	

PROFILE	REVISIONS	DATE
NOTE BOOK	PLOTTED	
NO.	STRUCTURE NOTATIONS CHECKED	

FILE NAME =	USER NAME = USER..	DESIGNED - DWR	REVISED -
N:\dgn\NA\NA498.ssd\dwg\k\FinalDrawings\NA498SummaryofQuantities.dgn		DRAWN - GR	REVISED -
#MODELNAME#	PLOT SCALE = 1.00' ft / IN.	CHECKED - JJB	REVISED -
	PLOT DATE = 12/18/2013	DATE - DEC 2013	REVISED -

**STATE OF ILLINOIS
DEPARTMENT OF TRANSPORTATION**

SUMMARY OF QUANTITIES

SCALE: SHEET 3 OF 27 SHEETS STA. TO STA.

F.A.U. RTE.	SECTION	COUNTY	TOTAL SHEETS	SHEET NO.
	12-00053-00-SW	KANE	27	3
CONTRACT NO. 63897			ILLINOIS FED. AID PROJECT	

PLAN	DATE
BY	
REVISIONS	
NO.	
DATE	
BY	
REVISIONS	
NO.	
DATE	
BY	
REVISIONS	
NO.	
DATE	

PROFILE	DATE
BY	
REVISIONS	
NO.	
DATE	
BY	
REVISIONS	
NO.	
DATE	
BY	
REVISIONS	
NO.	
DATE	

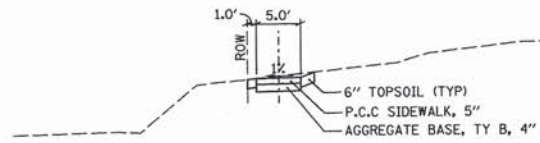

**IL RTE 56 (BUTTERFIELD ROAD)
TYPICAL SECTION**

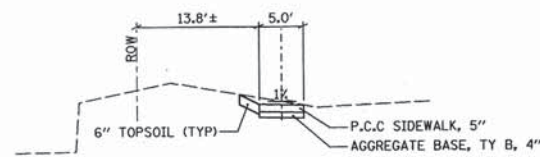

**LAUREL ROAD
TYPICAL SECTION**

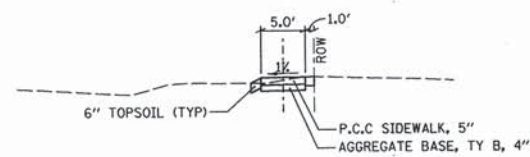

**BANBURY ROAD
TYPICAL SECTION
STA 20+10 - 21+76.28**

HOT MIX ASPHALT MIXTURE REQUIREMENT

ITEM	AIR VOIDS @ Ndes
DRIVEWAYS	
HOT-MIX ASPHALT SURFACE COURSE, MIX D, N50 (IL 9.5MM), 2"	4% @ 50 GYR
HOT-MIX ASPHALT BINDER COURSE, IL 19.0, N50, 2"	4% @ 50 GYR

NOTE:
THE UNIT WEIGHT USED TO CALCULATE ALL HMA SURFACE MIXTURE QUANTITIES IS 112#/SY² IN.
THE "AC TYPE" FOR POLYMERIZED HMA MIXES SHALL BE "SBS/SBR PG 76-22"
AND FOR NON-POLYMERIZED HMA THE "AC TYPE" SHALL BE "PG 64-22"
UNLESS MODIFIED BY DISTRICT ONE SPECIAL PROVISIONS.
FOR "PERCENT OF RAP" SEE SPECIAL PROVISIONS.

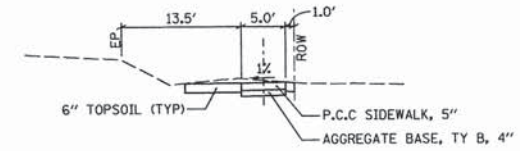

**BANBURY ROAD
TYPICAL SECTION
STA 30+25 - 30+35.59
STA 31+20.46 - 35+71.11
STA 37+14.27 - 41+71.28
STA 42+77.40 - 42+82.86**

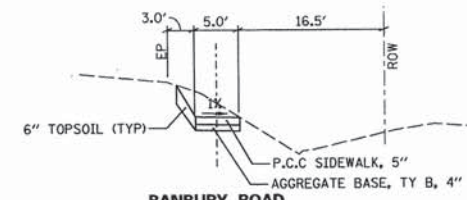

**BANBURY ROAD
TYPICAL SECTION
STA 35+71.11 - 37+14.27**

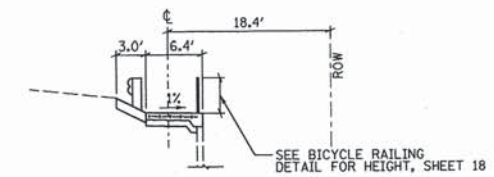

**BANBURY ROAD TYPICAL SECTION
AT EXISTING HEADWALL
STA 26+30**

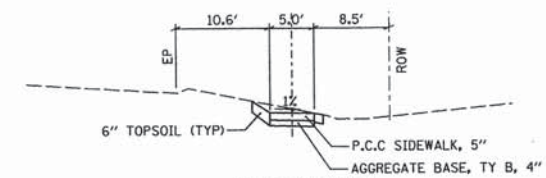

**BANBURY ROAD
TYPICAL SECTION
STA 41+71.28 - 42+77.40**

FILE NAME =	USER NAME = #USER#	DESIGNED - DWR	REVISED -
#FILE#		DRAWN - GR	REVISED -
#MODELNAME#	PLOT SCALE = #SCALE#	CHECKED - JJB	REVISED -
	PLOT DATE = #DATE#	DATE - DEC 2013	REVISED -

**STATE OF ILLINOIS
DEPARTMENT OF TRANSPORTATION**

TYPICAL SECTIONS			
SCALE: NONE	SHEET 4 OF 27 SHEETS	STA.	TO STA.

F.A.I.L. RTE.	SECTION	COUNTY	TOTAL SHEETS	SHEET NO.
	12-00053-00-SW	KANE	27	4
			CONTRACT NO. 63897	
ILLINOIS FED. AID PROJECT				

DATE	
BY	
REVISED	
PLANNED	
DESIGNED	
CHECKED	
ALIGNED	
APPROVED	
FILE NAME	
PLAN	
NO.	

DATE	
BY	
REVISED	
PLANNED	
DESIGNED	
CHECKED	
ALIGNED	
APPROVED	
FILE NAME	
PROFILE	
NO.	

Earth Excavation			Cut & Fill Breakdowns by Location							
Location	Lt/Rt	20200100	Butterfield Road		Laurel Drive		Banbury Road at Dee Road		Banbury Road	
		Earth Excavation	Cut	Fill	Cut	Fill	Cut	Fill	Cut	Fill
		CU YD	CU YD	CU YD	CU YD	CU YD	CU YD	CU YD	CU YD	CU YD
STA 0+20.00 to STA 4+21.10	Lt/Rt	86.83	86.83	7.07						
STA 10+22.99 to STA 15+28.30	Lt/Rt	120.89			120.89	5.9				
STA 20+10.00 to STA 21+71.30	Lt/Rt	25.49					25.49	2.7		
STA 30+25.00 to STA 43+01+60	Lt/Rt	264.41							264.41	56.24
Total		497.62								

Guardrail					
Location	Lt/Rt	63000001	LR631020	50901720	63200310
		Steel Plate Beam Guardrail, Type A, 6' Posts	Traffic Barrier Terminal, Type 1	Bicycle Railing	Guardrail Removal
		FOOT	FOOT	FOOT	FOOT
STA 35+ 50 to STA 36+60	Lt/Rt	110	2	30	54
Total		110	2	30	54

Landscaping/Erosion Control								
Location	Lt/Rt	21101625	25000110	X2511630	28000400	20101400	20101500	20101600
		Topsoil Furnish and Place, 6"	Seeding, Class 1A	Erosion Control Blanket (Special)	Perimeter Erosion Barrier	Nitrogen Fertilizer Nutrient	Phosphorous Fertilizer Nutrient	Potassium Fertilizer Nutrient
		SQ YD	ACRE	SQ YD	FOOT	POUND	POUND	POUND
STA 0+20.00 to STA 4+21.10	Lt/Rt	250	0.05	250	220	4.5	4.5	4.5
STA 10+22.99 to STA 15+28.30	Lt/Rt	240	0.05	240		5	5	5
STA 20+10.00 to STA 21+71.30	Lt/Rt	60	0.02	60		0.2	0.2	0.2
STA 30+25.00 to STA 43+01+60	Lt/Rt	900	0.2	900	40	17		17
Total		1450	0.32	1450	260	26.7	9.7	26.7

Striping		
Location	Lt/Rt	78000600
		Thermoplastic Pavement Marking - Line, 12" White
		FOOT
STA 20+50	Lt	70
Total		70

Storm Sewer					
Location	Lt/Rt	550A0050	54213657	Z0018700	60218300
		Storm Sewers, Class A, Type 1, 12"	Precast Reinforced Concrete Flared End Sections, 12"	Drainage Structure to be Removed	Manholes, Type A, 4'-Diameter, Type 1 Frame, Open Lid
		FOOT	EACH	EACH	FOOT
STA 35+65 to STA 36+00	Lt/Rt	25	2		
STA 36+60	Rt	15	1	1	1
STA 37+50	Lt/Rt	16	1	1	
Total		56	4	2	1

FILE NAME =	USER NAME = #USER#	DESIGNED - DWR	REVISED -
#FILE#		DRAWN - GR	REVISED -
#MODELNAME#		CHECKED - JJB	REVISED -
		DATE - DEC 2013	REVISED -

**STATE OF ILLINOIS
DEPARTMENT OF TRANSPORTATION**

SCHEDULE OF QUANTITIES

SCALE: SHEET 5 OF 27 SHEETS STA. TO STA.

F.A.U. RTE.	SECTION	COUNTY	TOTAL SHEETS	SHEET NO.
	12-00053-00-SW	KANE	27	5
CONTRACT NO. 63897				
[ILLINOIS] FED. AID PROJECT				

PLAN	SURVEYED	DATE
	PLOTTED	BY
	DESIGNED	
	CHECKED	
	DATE	
	NO.	

PROFILE	REVISIONS	DATE
	PLOTTED	BY
	DESIGNED	
	CHECKED	
	DATE	
	NO.	

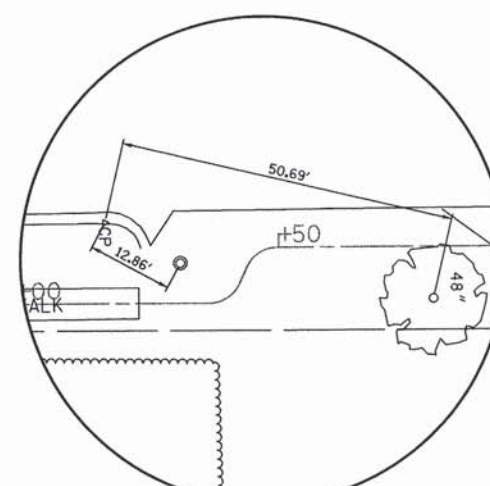
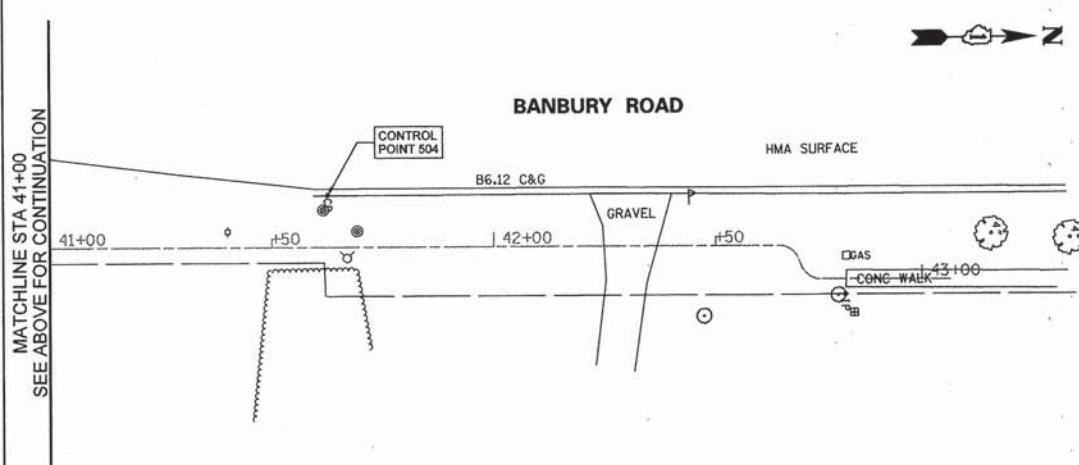
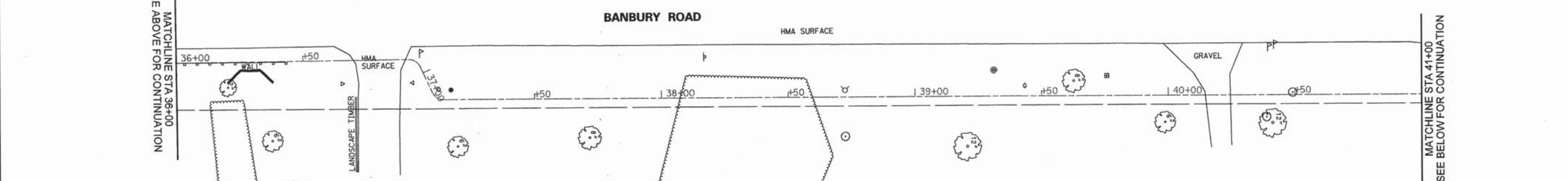
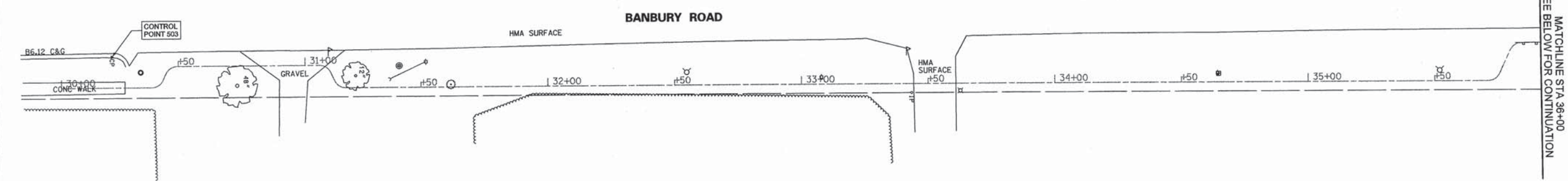

CONTROL POINT 503
SCALE: NONE

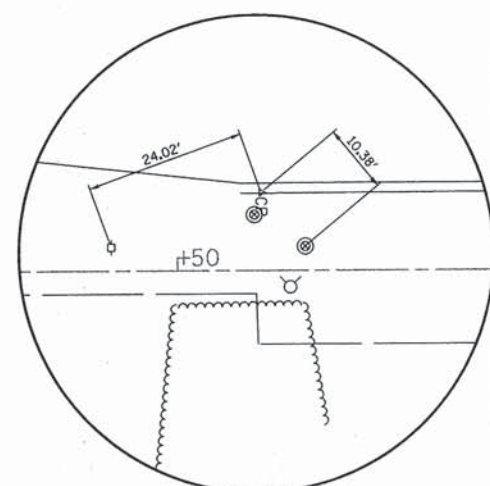

CONTROL POINT 504
SCALE: NONE

FILE NAME =	USER NAME = #USER#	DESIGNED - DWR	REVISED -
#FILE#		DRAWN - GR	REVISED -
#MODELNAME#	PLOT SCALE = #SCALE#	CHECKED - JJB	REVISED -
	PLOT DATE = #DATE#	DATE - DEC 2013	REVISED -

STATE OF ILLINOIS
DEPARTMENT OF TRANSPORTATION

ALIGNMENT AND CONTROL PLAN
BANBURY ROAD
SCALE: 1"=20' SHEET 7 OF 27 SHEETS STA. TO STA.

F.A.U. RTE.	SECTION	COUNTY	TOTAL SHEETS	SHEET NO.
	12-00053-00-SW	KANE	27	7
				CONTRACT NO. 63897
ILLINOIS FED. AID PROJECT				

DATE	
BY	
PLAN	SURVEYED
	PLOTTED
	GRADES CHECKED
	NOTE BOOK
	NO.
	CADD FILE NAME

DATE	
BY	
PROFILE	SURVEYED
	PLOTTED
	GRADES CHECKED
	NOTE BOOK
	NO.
	CADD FILE NAME

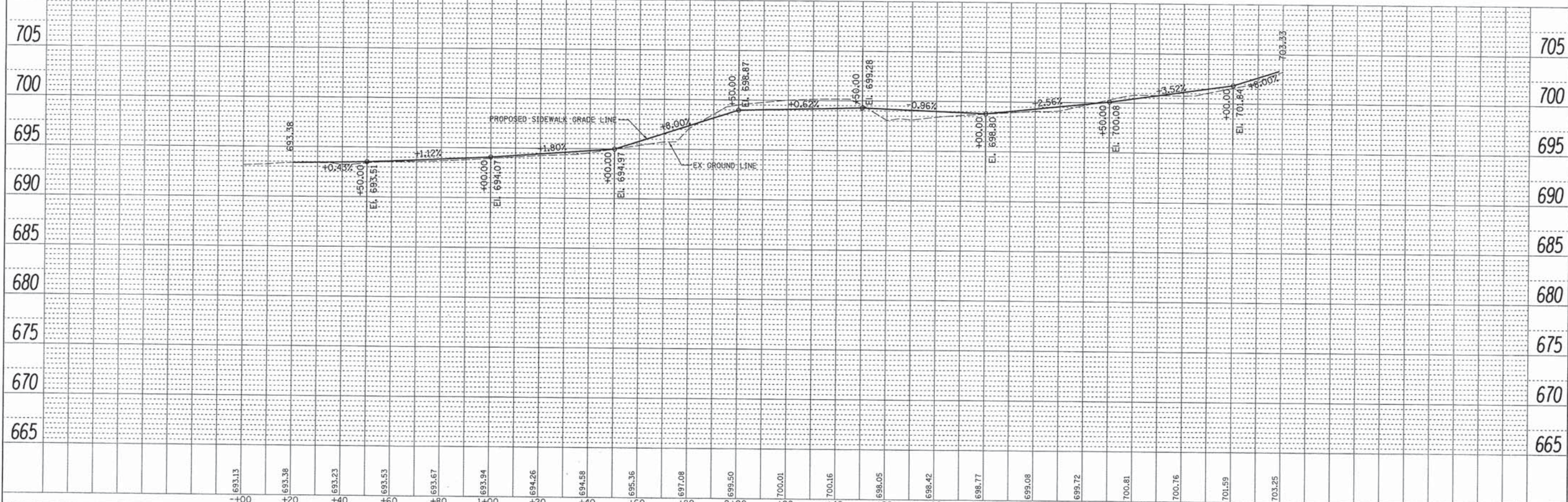
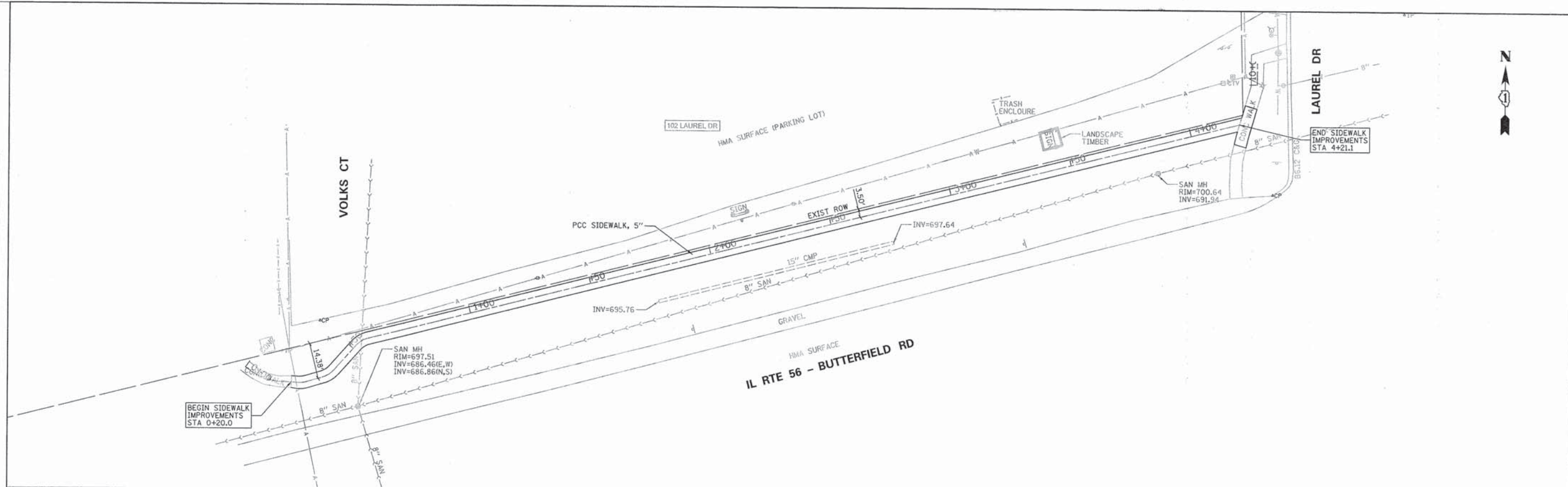

FILE NAME	USER NAME	DESIGNED	REVISED	STATE OF ILLINOIS DEPARTMENT OF TRANSPORTATION	IL RTE 56 - BUTTERFIELD ROAD SIDEWALK PLAN AND PROFILE	F.A.U. RTE.	SECTION	COUNTY	TOTAL SHEETS	SHEET NO.	
#FILE#		DRAWN	REVISED			12-00053-00-SW	KANE	27	8		
#MODELNAME#		CHECKED	REVISED			CONTRACT NO. 63897					
		DATE	REVISED			ILLINOIS FED. AID PROJECT					

SCALE: H₁"=20'
V₁"=5'
SHEET 7 OF 27 SHEETS STA. 0+20.0 TO STA. 4+21.1



IL RTE 56 - BUTTERFIELD RD

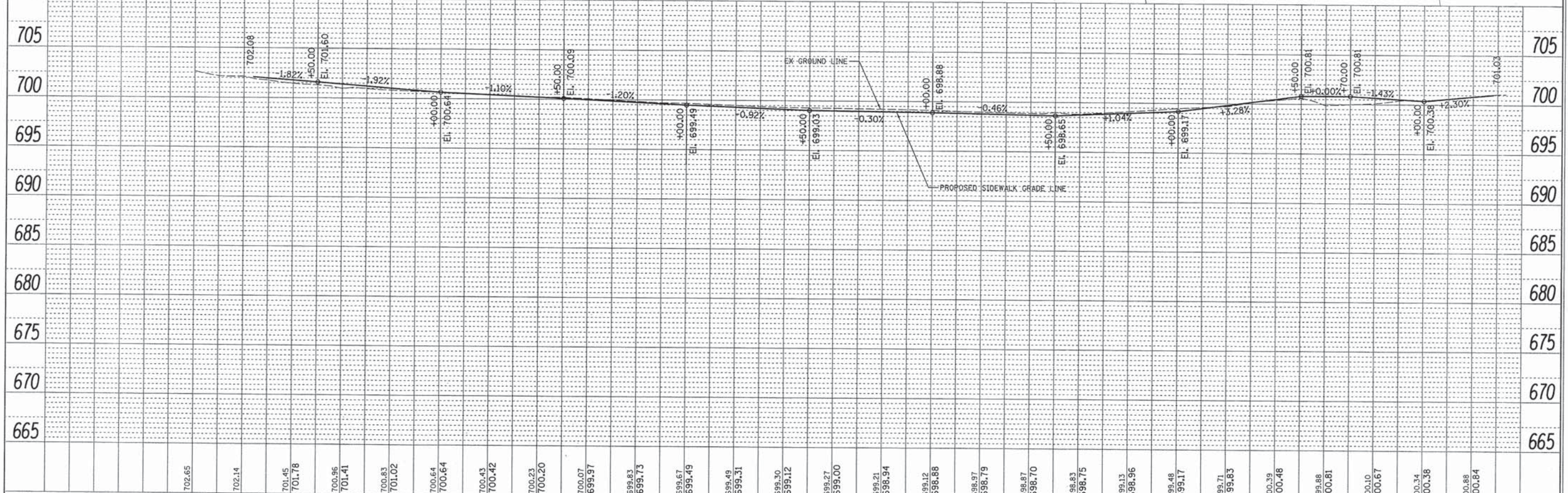
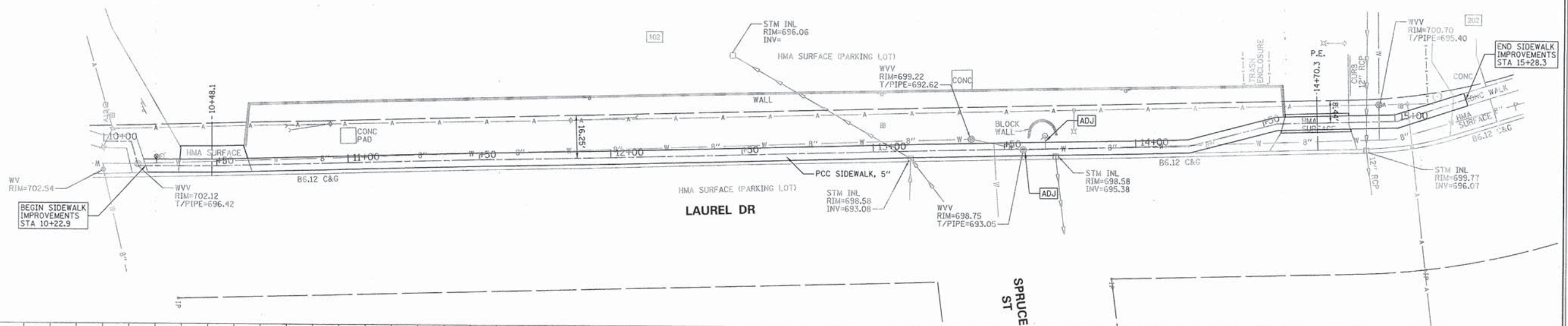

PLAN	SURVEYED	BY	DATE
	NOTED		
	CHECKED		
	BY		
	NO.		

PROFILE	SURVEYED	BY	DATE
	NOTED		
	CHECKED		
	BY		
	NO.		

FILE NAME =	USER NAME = #USER#	DESIGNED - DWR	REVISED -	STATE OF ILLINOIS DEPARTMENT OF TRANSPORTATION	LAUREL DRIVE SIDEWALK PLAN AND PROFILE	F.A.U. RTE.	SECTION	COUNTY	TOTAL SHEETS	SHEET NO.
#FILE#	DRAWN - GR	CHECKED - JJB	REVISED -			12-00053-00-SW	KANE	27	9	
#MODELNAME#	PLOT SCALE = #SCALE#	DATE - DEC 2013	REVISED -			CONTRACT NO. 63897				
	PLOT DATE = #DATE#					ILLINOIS FED. AID PROJECT				

SCALE: HORIZ. 1"=20' VERT. 1"=5' SHEET 9 OF 27 SHEETS STA. 10+22.9 TO STA. 15+28.3

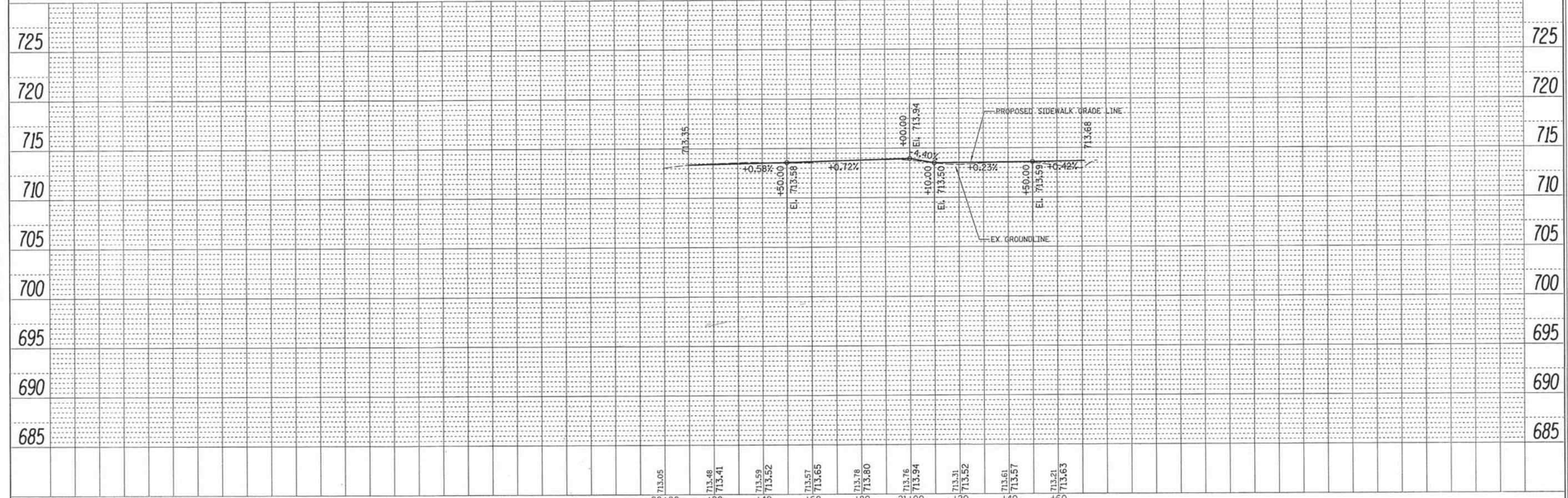
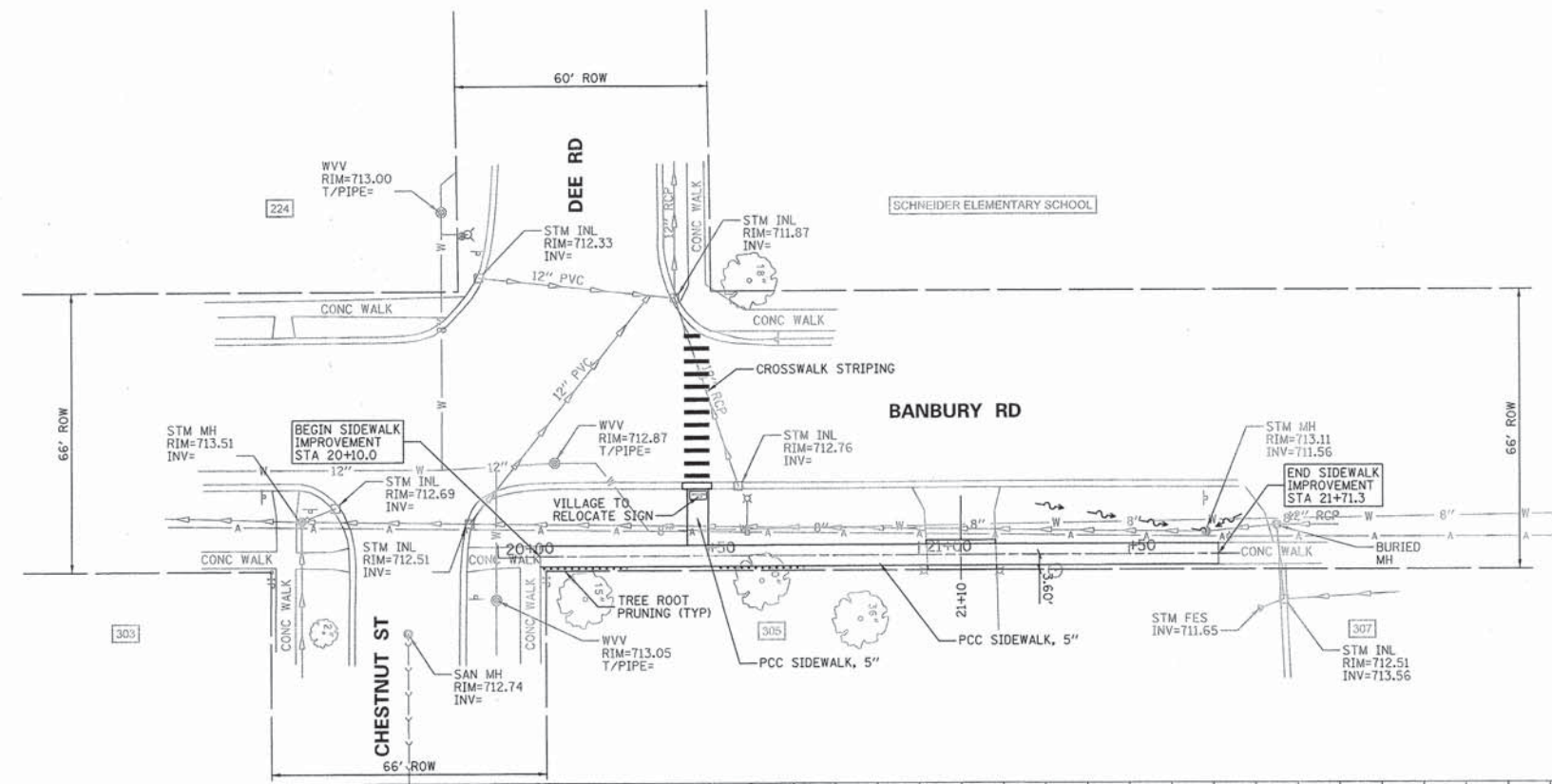

DATE	BY
DATE	BY
DATE	BY
DATE	BY
DATE	BY

DATE	BY
DATE	BY
DATE	BY
DATE	BY
DATE	BY

FILE NAME *	USER NAME * #USER#	DESIGNED - DWR	REVISED -
#FILE#		DRAWN - GR	REVISED -
#MODELNAME#		CHECKED - JJB	REVISED -
		DATE - DEC 2013	REVISED -

**STATE OF ILLINOIS
DEPARTMENT OF TRANSPORTATION**

**BANBURY ROAD
SIDEWALK PLAN AND PROFILE**

SCALE: H¹/_V = 20' / 1" = 5' SHEET 10 OF 27 SHEETS STA. 20+10.0 TO STA. 21+71.3

F.A.U. RTE.	SECTION	COUNTY	TOTAL SHEETS	SHEET NO.
	12-0053-00-SW	KANE	27	10
CONTRACT NO. 63897				
ILLINOIS FED. AID PROJECT				



PL AN	DESIGNED	BY	DATE
	CHECKED		
	ALIGNED		
	PLOTTED		
	NOTE BOOK		
	NO.		
	FILED		
	CHECKED		
	FILED		
	FILE NAME		

PROF ILE	DESIGNED	BY	DATE
	CHECKED		
	GRADES		
	PLOTTED		
	NOTE BOOK		
	NO.		
	FILED		
	CHECKED		
	FILED		
	FILE NAME		

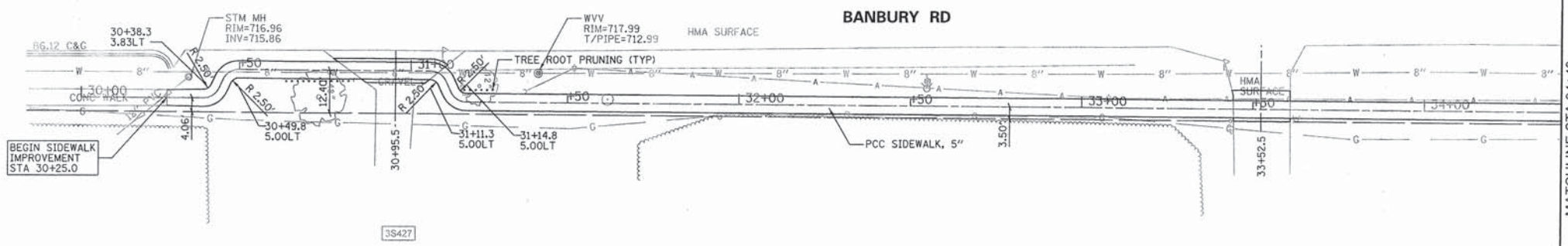

MATCHLINE STA 34+40
SEE SHEET 12 FOR CONTINUATION

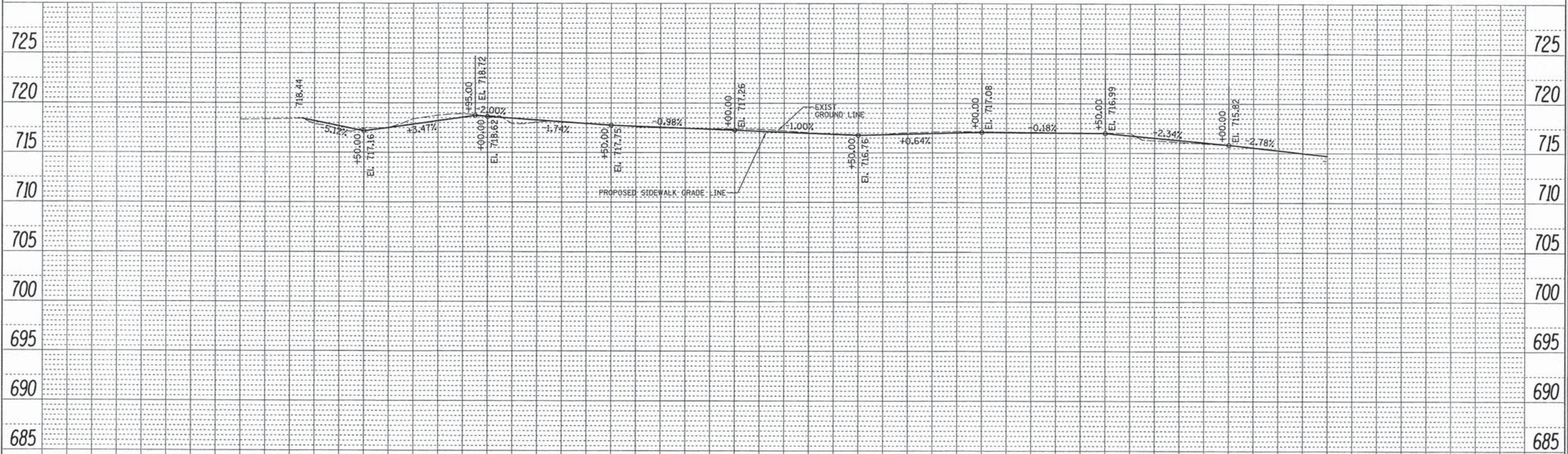

718.32	718.41	717.29	717.49	718.75	718.68	718.07	717.96	717.59	717.45	717.38	717.21	716.92	716.81	717.10	717.14	717.09	717.04	717.03	716.11	715.80	715.32	714.71
30+00	+20	+40	+60	+80	31+00	+20	+40	+60	+80	32+00	+20	+40	+60	+80	33+00	+20	+40	+60	+80	34+00	+20	+40

FILE NAME	USER NAME = #USER#	DESIGNED - DWR	REVISED -	STATE OF ILLINOIS DEPARTMENT OF TRANSPORTATION	BANBURY ROAD SIDEWALK PLAN AND PROFILE				F.A.U. RTE.	SECTION	COUNTY	TOTAL SHEETS	SHEET NO.
#FILE#		DRAWN - GR	REVISED -		12-00053-00-SW	KANE	27	11					
#MODELNAME#	PLDT SCALE = #SCALE#	CHECKED - JJB	REVISED -		SCALE: H1"=20' V1"=5'				SHEET 11 OF 27 SHEETS STA. 30+25 TO STA. 34+40				
	PLDT DATE = #DATE#	DATE - DEC 2013	REVISED -		CONTRACT NO. 63897				[ILLINOIS] FED. AID PROJECT				



PLAN	SURVEYED	BY	DATE
	DESIGNED		
	CHECKED		
	DATE		
	NO.		
	FILE NAME		

PROFILE	SURVEYED	BY	DATE
	DESIGNED		
	CHECKED		
	DATE		
	NO.		
	FILE NAME		

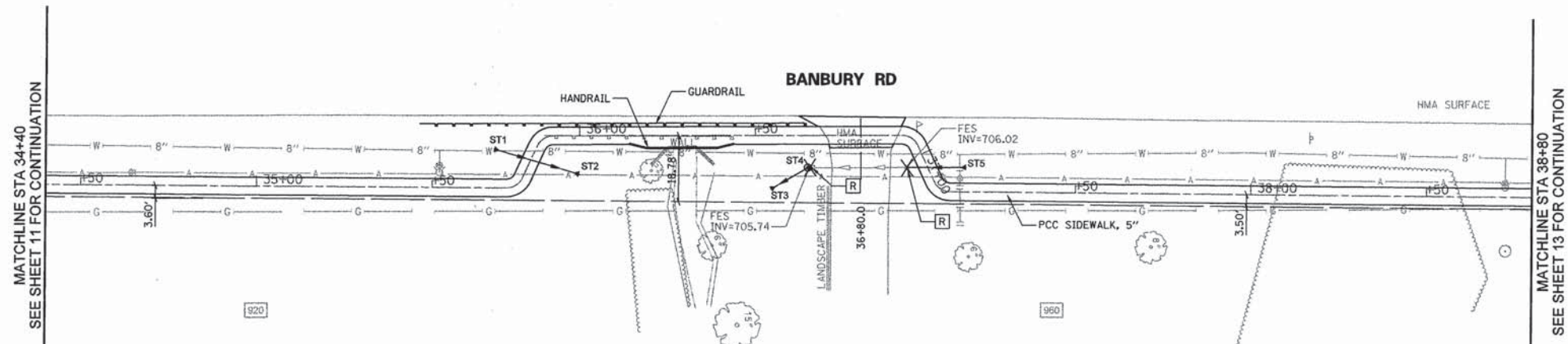

ST1	12" FES	ST2	12" FES	ST3	12" FES	ST4	MH, 4' DIA	ST5	12" FES
	W/ GRATE		W/ GRATE		W/ GRATE		W/ TY 1 F&CL		W/ GRATE
	INV= 710.00		INV= 708.40		INV= 705.50		RM= 708.16		INV= 706.50
							INV= 705.74		

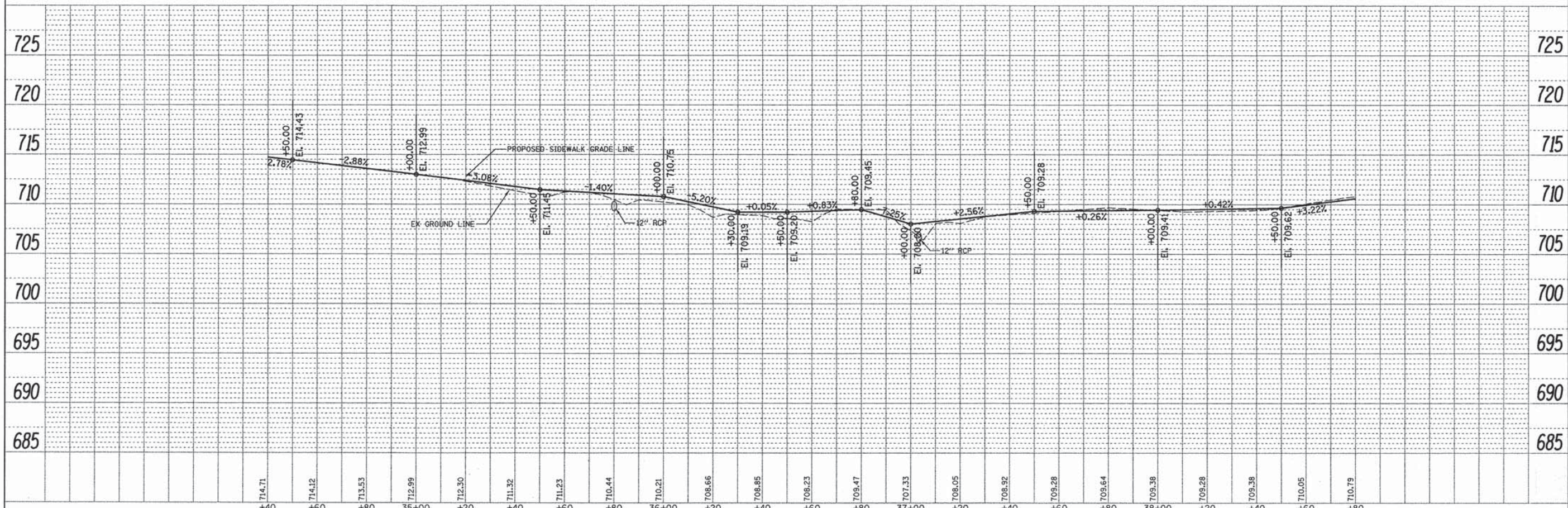

FILE NAME = #FILE#	USER NAME = #USER#	DESIGNED - DWR	REVISED -	STATE OF ILLINOIS DEPARTMENT OF TRANSPORTATION	BANBURY ROAD SIDEWALK PLAN AND PROFILE				F.A.U. RTE.	SECTION	COUNTY	TOTAL SHEETS	SHEET NO.
		DRAWN - GR	REVISED -		SCALE: H1"=20'	SHEET 12 OF 27 SHEETS	STA. 34+40 TO STA. 38+80	12-00053-00-SW	KANE	27	12		
		CHECKED - JJB	REVISED -					CONTRACT NO. 63897					
		DATE - DEC 2013	REVISED -					ILLINOIS FED. AID PROJECT					



PLAN	DESIGNED	DATE
NOTED	BY	
CHECKED	DATE	
DATE		

PROFILE	DESIGNED	DATE
NOTED	BY	
CHECKED	DATE	
DATE		

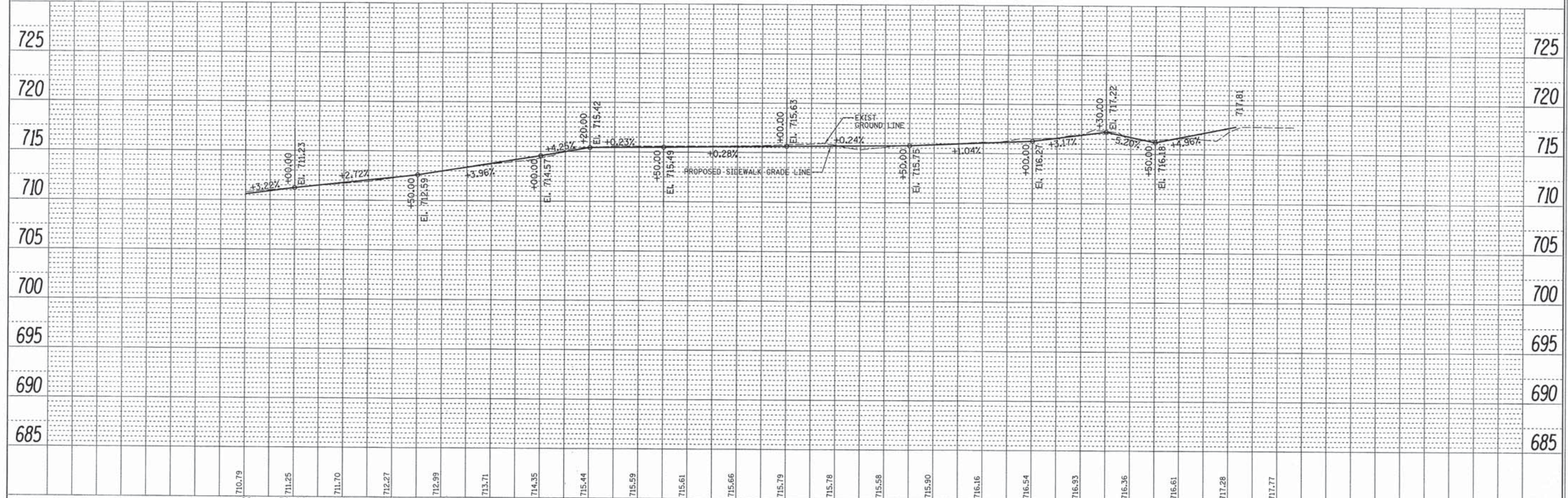
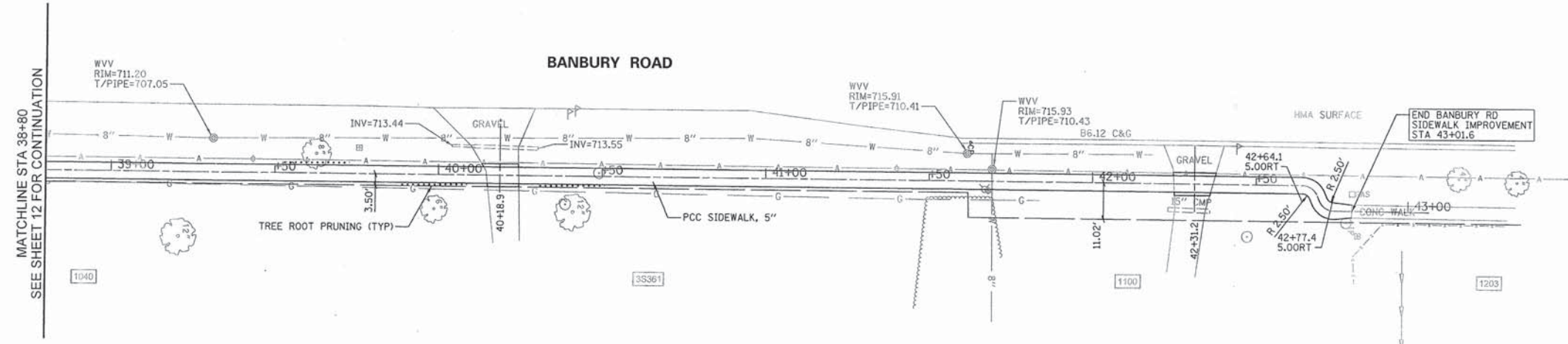

FILE NAME =	USER NAME = *USER*	DESIGNED = DWR	REVISED =	STATE OF ILLINOIS DEPARTMENT OF TRANSPORTATION	BANBURY ROAD SIDEWALK PLAN AND PROFILE	F.A.U. RTE.	SECTION	COUNTY	TOTAL SHEETS	SHEET NO.
#FILE#		DRAWN = GR	REVISED =			12-00053-00-SW	KANE	27	13	
#MODELNAME#		CHECKED = JJB	REVISED =			CONTRACT NO. 63897				
		DATE = DEC 2013	REVISED =			ILLINOIS FED. AID PROJECT				

SCALE: H₁₁"=20'
V₁"=5'
SHEET 13 OF 27 SHEETS STA. 38+80 TO STA. 43+01.6

PLAN	SURVEYED	DATE
	PLOTTED	
	BY	
	NOTE BOOK	
	NO.	
	ADD FILE NAME	

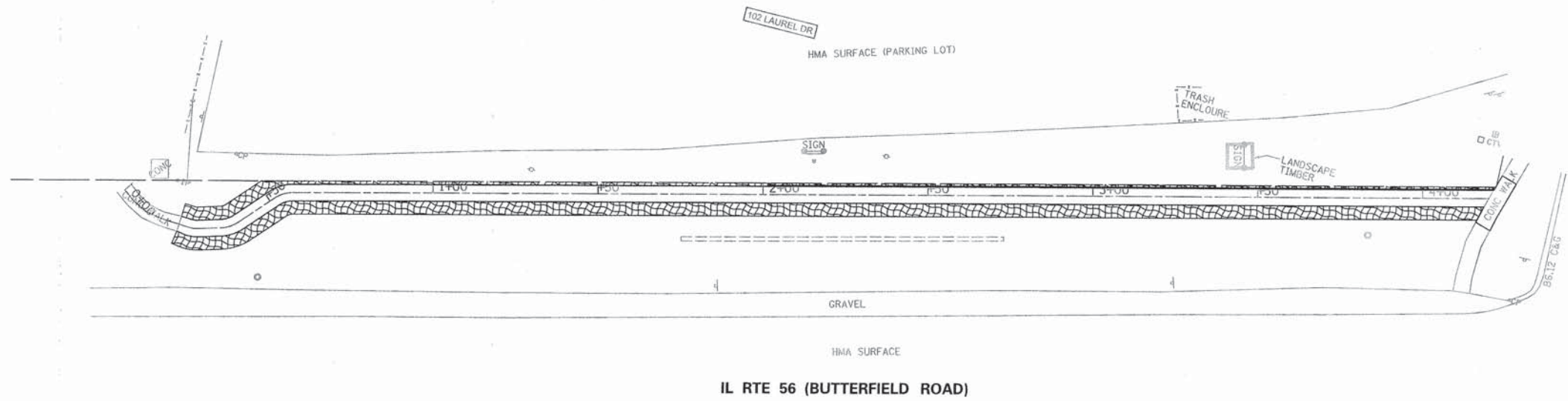

PROFILE	SURVEYED	DATE
	PLOTTED	
	BY	
	NOTE BOOK	
	NO.	
	ADD FILE NAME	

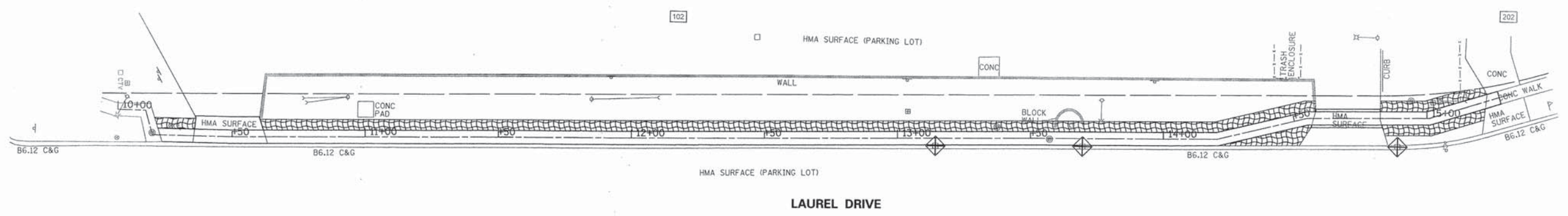

FILE NAME =	USER NAME = #USER#	DESIGNED - DWR	REVISED -	STATE OF ILLINOIS DEPARTMENT OF TRANSPORTATION	IL RTE 56 (BUTTERFIELD ROAD) AND LAUREL DRIVE EROSION AND SEDIMENTATION CONTROL PLAN	F.A.U. RTE.	SECTION	COUNTY	TOTAL SHEETS	SHEET NO.	
#FILE#	PLOT SCALE = #SCALE#	DRAWN - GR	REVISED -				12-00053-00-SW	KANE	27	14	
#MODELNAME#	PLOT DATE = #DATE#	CHECKED - JJB	REVISED -			CONTRACT NO. 63897					
		DATE - DEC 2013	REVISED -			ILLINOIS FED. AID PROJECT					
SCALE: 1"=20'						SHEET 14 OF 27 SHEETS STA. TO STA.					

PLAN	DESIGNED	BY	DATE
	PLOTTED		
	ALIGNED		
	CHECKED		
	FILED		
	NO. _____		
	FILE NAME _____		

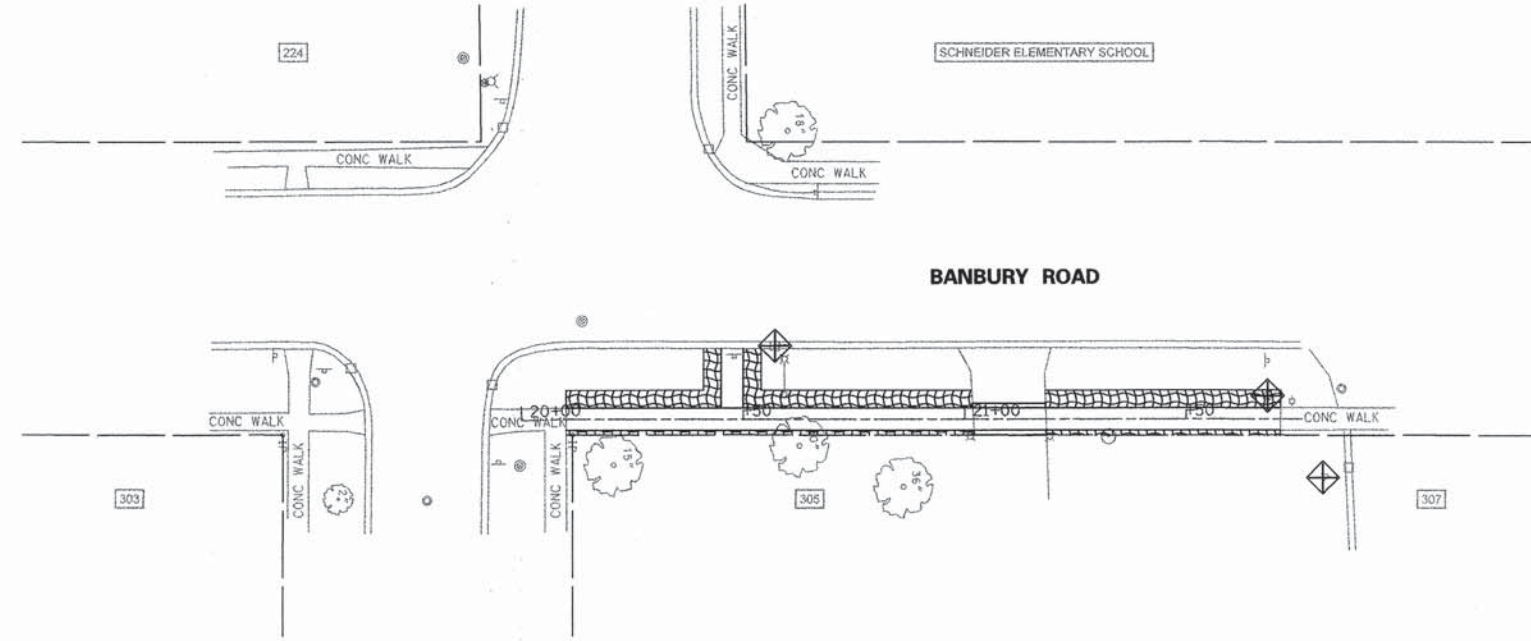

PROFILE	DESIGNED	BY	DATE
	PLOTTED		
	UPGRADES		
	CHECKED		
	FILED		
	NO. _____		
	FILE NAME _____		

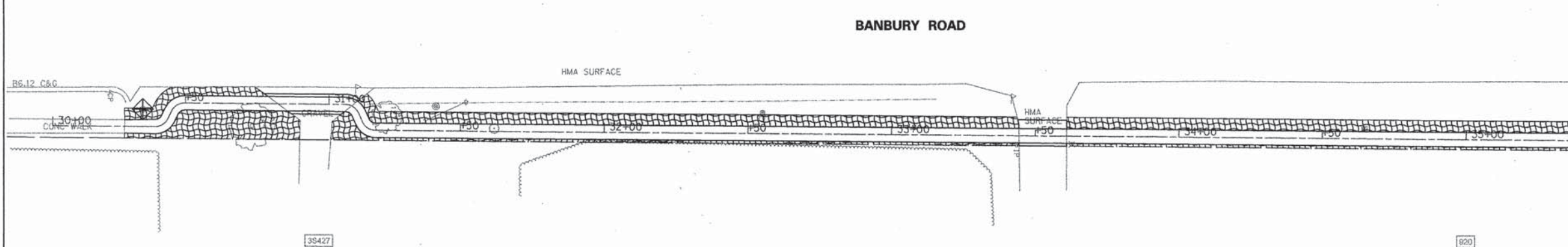

FILE NAME =	USER NAME = #USER#	DESIGNED - DWR	REVISED -
#FILE#		DRAWN - GR	REVISED -
#MODELNAME#	PLOT SCALE = #SCALE#	CHECKED - JJB	REVISED -
	PLOT DATE = #DATE#	DATE - DEC 2013	REVISED -

STATE OF ILLINOIS
DEPARTMENT OF TRANSPORTATION

EROSION AND SEDIMENTATION CONTROL PLAN
BANBURY ROAD

SCALE: 1"=20' SHEET 15 OF 27 SHEETS STA. TO STA.

F.A.U. RTE.	SECTION	COUNTY	TOTAL SHEETS	SHEET NO.
	12-00053-00-SW	KANE	27	15
				CONTRACT NO. 63897
ILLINOIS FED. AID PROJECT				

PLAN	DESIGNED	BY	DATE
NO.	CHECKED		
	ALIGNED		
	NOTED		
	FILE NAME		

PROFILE	DESIGNED	BY	DATE
NO.	CHECKED		
	GRADES		
	STRUCTURE		
	NOTATIONS		

MATCHLINE STA 35+40
SEE SHEET 15 FOR CONTINUATION

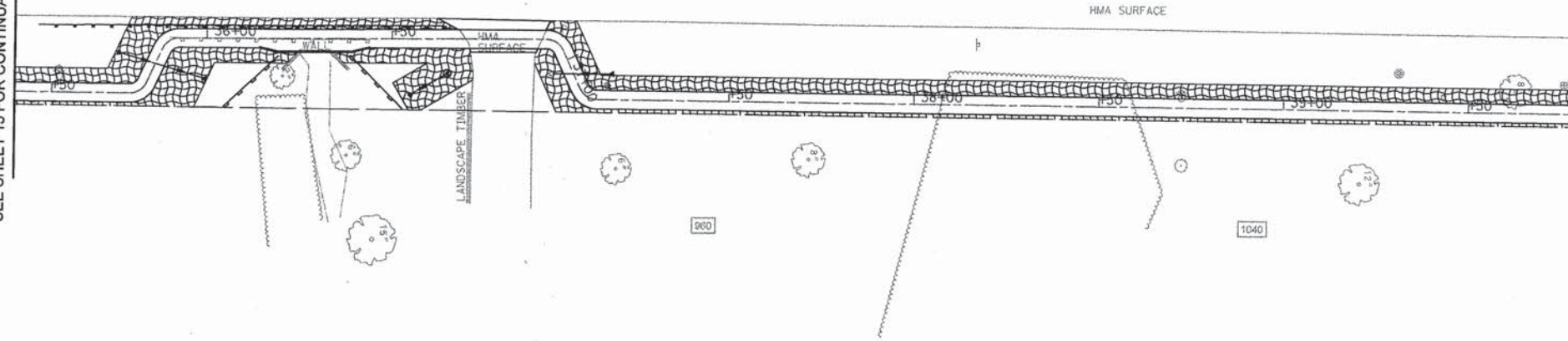

MATCHLINE STA 39+80
SEE BELOW FOR CONTINUATION

MATCHLINE STA 39+80
SEE BELOW FOR CONTINUATION

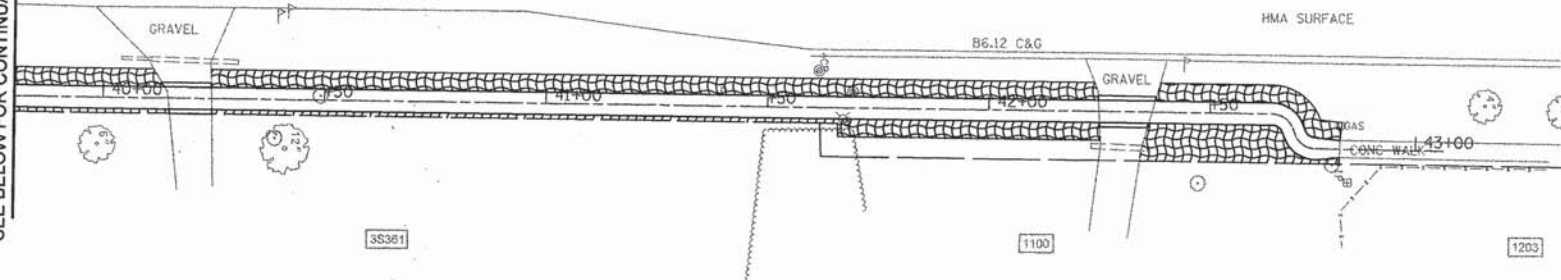

FILE NAME =	USER NAME = #USER#	DESIGNED - DWR	REVISED -
#FILE#		DRAWN - GR	REVISED -
#MODELNAME#		CHECKED - JJB	REVISED -
		DATE - DEC 2013	REVISED -

STATE OF ILLINOIS
DEPARTMENT OF TRANSPORTATION

BANBURY ROAD
EROSION AND SEDIMENTATION CONTROL PLAN

SCALE: 1"=20' SHEET 16 OF 27 SHEETS STA. TO STA.

F.A.U. RTE.	SECTION	COUNTY	TOTAL SHEETS	SHEET NO.
	12-00053-00-SW	KANE	27	16
			CONTRACT NO. 63897	
ILLINOIS FED. AID PROJECT				

STORM WATER POLLUTION PREVENTION PLAN

THE FOLLOWING PLAN IS ESTABLISHED AND INCORPORATED IN THE PROJECT TO DIRECT THE CONTRACTOR IN THE PLACEMENT OF TEMPORARY AND PERMANENT EROSION CONTROL SYSTEMS AND TO PROVIDE A STORM WATER POLLUTION PREVENTION PLAN FOR COMPLIANCE UNDER N.P.D.E.S.

THE PURPOSE OF THIS PLAN IS TO MINIMIZE EROSION WITHIN THE CONSTRUCTION SITE AND TO LIMIT SEDIMENTS AND POLLUTANTS FROM LEAVING THE CONSTRUCTION SITE BY UTILIZING PROPER TEMPORARY EROSION CONTROL SYSTEMS AND PROVIDING GROUND COVER WITHIN A REASONABLE AMOUNT OF TIME.

CERTAIN EROSION CONTROL FACILITIES SHALL BE INSTALLED BY THE CONTRACTOR AT THE BEGINNING OF CONSTRUCTION. OTHER ITEMS SHALL BE INSTALLED BY THE CONTRACTOR AS REQUIRED OR AS DIRECTED BY THE ENGINEER OR ON A CASE BY CASE SITUATION DEPENDING ON THE CONTRACTOR'S SEQUENCE OF ACTIVITIES, TIME OF YEAR, AND EXPECTED WEATHER CONDITIONS.

THE CONTRACTOR SHALL INSTALL PERMANENT EROSION CONTROL SYSTEMS AND SEEDING WITHIN A TIME FRAME SPECIFIED HEREIN AND AS DIRECTED BY THE ENGINEER AND AS SHOWN IN THE ENGINEERING PLANS. THEREFORE MINIMIZING THE AMOUNT OF AREA SUSCEPTIBLE TO EROSION AND REDUCING THE AMOUNT OF TEMPORARY SEEDING, THE ENGINEER WILL DETERMINE IF ANY TEMPORARY EROSION CONTROL SYSTEMS SHOWN IN THE PLAN CAN BE DELETED AND IF ANY ADDITIONAL TEMPORARY EROSION CONTROL SYSTEMS, WHICH ARE NOT INCLUDED IN THIS PLAN, SHALL BE ADDED. THE CONTRACTOR SHALL PERFORM ALL WORK AS DIRECTED BY THE ENGINEER AND AS SHOWN IN THE PLANS.

THIS PLAN SHALL BE FOLLOWED FOR ALL SITE IMPROVEMENTS. AN EROSION CONTROL PLAN HAS BEEN PREPARED FOR THIS PROJECT AND IS PART OF THE APPROVED ENGINEERING PLANS. THE CONTRACTOR SHALL HAVE A COPY OF THE APPROVED PLANS INCLUDING THE EROSION CONTROL PLAN AND A COPY OF THE STORM WATER POLLUTION PREVENTION PLAN AT ALL TIMES. THE DETAILS INCLUDED IN THIS STORM WATER POLLUTION PREVENTION PLAN ARE INTENDED TO SUPPLEMENT THE DETAILS PROVIDED IN THE APPROVED PLANS AND PROVIDE RECOMMENDATION ALTERNATIVES THAT MAY BE USED TO PROVIDE EROSION AND SEDIMENTATION CONTROL AS NEEDED.

SITE DESCRIPTION OF CONSTRUCTION ACTIVITIES:

1. THE PROJECT CONSISTS OF IMPROVEMENTS TO EXISTING ROADWAYS, PAVED DRIVEWAYS, SIDEWALKS AND STORM SEWER IMPROVEMENTS.
2. THE SITE CONSTRUCTION ACTIVITIES WILL CONSIST OF THE FOLLOWING: PAVEMENT REMOVAL, MASS GRADING, PAVEMENT CONSTRUCTION, INSTALLATION OF STORM SEWER, PARKWAY RESTORATION ALONG WITH SOIL EROSION AND SEDIMENTATION MEASURES.

DESCRIPTION OF INTENDED SEQUENCE FOR MAJOR CONSTRUCTION ACTIVITIES WHICH WILL DISTURB SOILS FOR MAJOR PORTIONS OF THE CONSTRUCTION SITE:

INSTALL SILT FENCE AT LOCATIONS INDICATED ON THE PLANS.
STRIP TOPSOIL FROM PROPOSED SITE.
CUT & FILL SITE TO PROPOSED SUB-GRADE.

PLACE AND MAINTAIN ALL TEMPORARY EROSION CONTROL MEASURES INCLUDING DITCH CHECKS, INLET AND PIPE PROTECTION, TEMPORARY SEEDING, ETC.
CONSTRUCT UNDERGROUND IMPROVEMENTS, STORM SEWER, ETC.
COMPLETE TOPSOIL PLACEMENT AND PERMANENT EROSION CONTROL MEASURES INCLUDING TOPSOIL/SEEDING.

AREA OF CONSTRUCTION SITE:

THE TOTAL AREA OF THE CONSTRUCTION SITE IS ESTIMATED TO BE 1.67 ACRES OF WHICH 1.67 ACRES WILL BE DISTURBED BY EXCAVATION, GRADING, AND OTHER ACTIVITIES.

OTHER REPORTS, STUDIES AND PLANS WHICH AID IN THE DEVELOPMENT OF THE STORM WATER POLLUTION PREVENTION PLAN AS REFERENCED DOCUMENTS

1. INFORMATION OF THE SOILS AND TERRAIN WITHIN THE SITE WAS OBTAINED FROM TOPOGRAPHIC SURVEYS AND SOIL BORINGS THAT WERE UTILIZED FOR THE DEVELOPMENT OF THE PROPOSED TEMPORARY EROSION CONTROL SYSTEMS.
2. PROJECT PLAN DOCUMENTS, SPECIFICATIONS AND SPECIAL PROVISIONS, AND PLAN DRAWINGS INDICATING DRAINAGE PATTERNS AND APPROXIMATE SLOPES ANTICIPATED AFTER GRADING ACTIVITIES WERE UTILIZED FOR THE PROPOSED PLACEMENT OF THE TEMPORARY EROSION CONTROL SYSTEM.

CONTROLS - EROSION CONTROL AND SEDIMENT CONTROL

DESCRIPTION OF STABILIZATION PRACTICES AT THE BEGINNING OF CONSTRUCTION:

1. THE DRAWINGS, SPECIFICATIONS AND SPECIAL PROVISIONS WILL ENSURE THAT EXISTING VEGETATION IS PRESERVED WHERE ATTAINABLE AND DISTURBED PORTIONS OF THE SITE WILL BE STABILIZED. STABILIZATION PRACTICES INCLUDE: TEMPORARY SEEDING, PERMANENT SEEDING, MULCHING, PRESERVATION OF MATURE VEGETATION AND OTHER APPROPRIATE MEASURES AS DIRECTED BY THE ENGINEER OR STABILIZATION MEASURES SHALL BE INITIATED AS SOON AS PRACTICABLE IN PORTIONS OF THE SITE WHERE CONSTRUCTION ACTIVITIES HAVE TEMPORARILY OR PERMANENTLY CEASED, BUT IN NO CASE MORE THAN 7 DAYS AFTER THE CONSTRUCTION ACTIVITY IN THAT PORTION OF THE SITE HAS TEMPORARILY OR PERMANENTLY CEASED. SEE SOIL PROTECTION SCHEDULE FOR RECOMMENDATIONS.

- A. AREAS OF EXISTING VEGETATION (WOOD AND GRASSLANDS) OUTSIDE THE PROPOSED CONSTRUCTION LIMITS SHALL BE IDENTIFIED BY THE ENGINEER FOR PRESERVING AND SHALL BE PROTECTED FROM CONSTRUCTION ACTIVITIES.
- B. AS SOON AS REASONABLE ACCESS IS AVAILABLE TO ALL LOCATIONS WHERE WATER DRAINS AWAY FROM THE PROJECT, TEMPORARY DITCH CHECKS, INLET AND PIPE PROTECTION, AND PERIMETER EROSION BARRIER SHALL BE INSTALLED AS CALLED OUT IN THIS PLAN AND DIRECTED BY THE ENGINEER.
- C. BARE AND SPARSELY VEGETATED GROUND IN HIGH ERODABLE AREAS AS DETERMINED BY THE ENGINEER SHALL BE TEMPORARILY SEEDED AT THE BEGINNING OF CONSTRUCTION WHERE NO CONSTRUCTION ACTIVITIES ARE EXPECTED WITHIN SEVEN DAYS.
- D. AT LOCATIONS WHERE A SIGNIFICANT AMOUNT OF WATER DRAINS INTO THE CONSTRUCTION ZONE FROM OUTSIDE AREAS (ADJACENT LANDOWNERS), TEMPORARY DITCH CHECKS WILL BE UTILIZED TO LOCALLY DIVERT WATER, REDUCE FLOW RATES, AND COLLECT OUTSIDE SILTATION INSIDE THE PROPERTY.

2. ESTABLISHMENT OF THESE TEMPORARY EROSION CONTROL MEASURES WILL HAVE ADDITIONAL BENEFITS TO THE PROJECT. DESIRABLE GRASS SEED WILL BECOME ESTABLISHED IN THESE AREAS AND WILL SPREAD SEEDS ONTO THE CONSTRUCTION SITE UNTIL PERMANENT SEEDING/MOWING AND OVERSEEDING CAN BE COMPLETED.

DESCRIPTION OF STABILIZATION PRACTICES DURING CONSTRUCTION:

DURING CONSTRUCTION, AREAS OUTSIDE THE CONSTRUCTION LIMITS AS OUTLINED PREVIOUSLY HEREIN SHALL BE PROTECTED. THE CONTRACTOR SHALL NOT USE THIS AREA FOR STAGING (EXCEPT AS DESCRIBED ON THE PLANS AND DIRECTED BY THE ENGINEER), PARKING OF VEHICLES, OR CONSTRUCTION EQUIPMENT STORAGE OF MATERIALS, OR OTHER CONSTRUCTION RELATED ACTIVITIES.

WITHIN THE CONSTRUCTION LIMITS, AREAS WHICH MAY BE SUSCEPTIBLE TO EROSION AS DETERMINED BY THE ENGINEER SHALL REMAIN UNDISTURBED UNTIL FULL SCALE CONSTRUCTION IS UNDERWAY TO PREVENT UNNECESSARY SOIL EROSION.

EARTH STOCKPILES SHALL BE TEMPORARILY SEEDED IF THEY ARE TO REMAIN UNUSED FOR MORE THAN SEVEN DAYS.

AS CONSTRUCTION PROCEEDS, THE CONTRACTOR SHALL INSTITUTE THE FOLLOWING AS DIRECTED BY THE ENGINEER.

PLACE TEMPORARY EROSION CONTROL FACILITIES AT LOCATIONS SHOWN ON THE PLANS.

TEMPORARILY SEED ERODABLE BARE EARTH ON A WEEKLY BASIS TO MINIMIZE THE AMOUNT OF ERODABLE SURFACE AREA WITHIN THE CONTRACT LIMITS.

CONSTRUCT ROADSIDE DITCHES AND PROVIDE TEMPORARY EROSION CONTROL SYSTEMS.

TEMPORARILY DIVERT WATER AROUND PROPOSED CULVERT LOCATIONS.

EXCAVATED AREAS AND EMBANKMENT SHALL BE PERMANENTLY SEEDED IMMEDIATELY AFTER FINAL GRADING. IF NOT, THEY SHALL BE TEMPORARILY SEEDED IF NO CONSTRUCTION ACTIVITY IN THE AREA IS PLANNED FOR 7 DAYS.

CONSTRUCTION EQUIPMENT SHALL BE STORED AND FUELED ONLY AT DESIGNATED LOCATIONS. ALL NECESSARY MEASURES SHALL BE TAKEN TO CONTAIN ANY FUEL OR OTHER POLLUTANT IN ACCORDANCE WITH EPA WATER QUALITY REGULATIONS. LEAKING EQUIPMENT OR SUPPLIES SHALL BE IMMEDIATELY REPAIRED OR REMOVED FROM THIS SITE.

THE CONSTRUCTION MANAGER IS RESPONSIBLE FOR INSPECTING THE PROJECT DAILY DURING CONSTRUCTION ACTIVITIES. INSPECTION SHALL ALSO BE DONE WEEKLY AND AFTER RAINS OF 1/2 INCH OR GREATER OR EQUIVALENT SNOWFALL AND DURING THE WINTER SHUTDOWN PERIOD. THE PROJECT SHALL ADDITIONALLY BE INSPECTED BY THE CONSTRUCTION FIELD ENGINEER ON A WEEKLY BASIS TO DETERMINE THAT EROSION CONTROL EFFORTS ARE IN PLACE AND EFFECTIVE AND IF OTHER EROSION CONTROL WORK IS NECESSARY.

SEDIMENT COLLECTED DURING CONSTRUCTION OF THE VARIOUS TEMPORARY EROSION CONTROL SYSTEMS SHALL BE DISPOSED OF ON THE SITE ON A REGULAR BASIS OR AS DIRECTED BY THE ENGINEER. THE COST OF THIS MAINTENANCE SHALL BE INCIDENTAL TO THE UNIT BID PRICE FOR EROSION CONTROL.

THE TEMPORARY EROSION CONTROL SYSTEMS SHALL BE REMOVED AS DIRECTED BY THE ENGINEER AFTER USE IS NO LONGER NEEDED OR NO LONGER FUNCTIONING. THE COST OF THIS REMOVAL SHALL BE INCIDENTAL TO THE UNIT BID PRICE FOR VARIOUS TEMPORARY EROSION CONTROL PAY ITEMS.

DESCRIPTION OF STRUCTURAL PRACTICES AFTER FINAL GRADING:

TEMPORARY EROSION CONTROL SYSTEMS SHALL BE LEFT IN PLACE WITH PROPER MAINTENANCE UNTIL PERMANENT EROSION CONTROL IS IN PLACE AND WORKING PROPERLY AND ALL PROPOSED TURF AREAS SEEDED AND ESTABLISHED.

ONCE PERMANENT EROSION CONTROL SYSTEMS AS PROPOSED IN THE PLANS ARE FUNCTIONAL AND ESTABLISHED, TEMPORARY ITEMS SHALL BE REMOVED, CLEANED UP AND DISTURBED TURF RESEEDED.

MAINTENANCE AFTER CONSTRUCTION

CONSTRUCTION IS COMPLETE AFTER ACCEPTANCE BY THE OWNER. MAINTENANCE UP TO THIS DATE WILL BE BY THE CONTRACTOR.

MISCELLANEOUS:

TEMPORARY DITCH CHECKS SHALL BE LOCATED AT EVERY 1.5 FT. FALL/RISE IN DITCH GRADE.
TEMPORARY EROSION CONTROL SEEDING SHALL BE APPLIED AT A RATE OF 100 LBS/ACRE.

SEDIMENT COLLECTED DURING CONSTRUCTION BY THE VARIOUS TEMPORARY EROSION CONTROL SYSTEMS SHALL BE DISPOSED OF ON THE SITE ON A REGULAR BASIS AND IN GENERAL BE PLACED BACK TO THE LOCATION FROM WHERE IT WAS REMOVED.

EROSION CONTROL NOTES:

EROSION CONTROL MEASURES SHALL MEET ALL REQUIREMENTS OF THE VILLAGE OF WINFIELD AND THE ENVIRONMENTAL PROTECTION AGENCY, N.P.D.E.S. PERMIT CONSTRUCTION SITE ACTIVITIES.

UNLESS OTHERWISE INDICATED, ALL VEGETATIVE AND STRUCTURAL EROSION AND SEDIMENTATION CONTROL PRACTICES WILL BE CONSTRUCTED ACCORDING TO MINIMUM STANDARDS AND SPECIFICATIONS IN THE ILLINOIS URBAN MANUAL LATEST EDITION.

A COPY OF THE APPROVED EROSION AND SEDIMENTATION CONTROL PLAN SHALL BE MAINTAINED ON THE SITE AT ALL TIMES.

IN AREAS WHERE WORK IS COMPLETE, PERMANENT STABILIZATION SHALL OCCUR WITHIN 7 DAYS OF COMPLETION, AND IN AREAS WHERE WORK HAS TEMPORARILY CEASED FOR 14 DAYS OR MORE, TEMPORARY STABILIZATION SHALL OCCUR BY THE 7TH DAY AFTER WORK HAS CEASED.

FOR PERMANENT SEEDING AND VEGETATION, REFER TO THE LANDSCAPE PLANS.

SOIL STOCKPILES TO REMAIN IN PLACE FOR 30 DAYS SHALL RECEIVE TEMPORARY SEEDING.

EROSION CONTROL MEASURES MUST BE CONSTRUCTED AS A FIRST STEP IN GRADING AND BE MADE FUNCTIONAL BEFORE UPSLOPE LAND DISTURBANCE TAKES PLACE.

THE CONTRACTOR IS RESPONSIBLE FOR INSTALLATION OF ANY ADDITIONAL EROSION CONTROL MEASURES NECESSARY TO PREVENT EROSION AND SEDIMENTATION.

DURING DEWATERING OPERATIONS, WATER WILL BE PUMPED INTO SEDIMENT BASINS OR SILT TRAPS. DEWATERING DIRECTLY INTO FIELD TILES OR STORM WATER STRUCTURES IS PROHIBITED.

ALL EXISTING STORM SEWER INLETS OR PROPOSED STORM SEWER INLETS WHICH ARE MADE OPERABLE DURING CONSTRUCTION SHALL BE PROTECTED BY INLET PROTECTION IN PAVEMENT AREAS AND DIKES OR SILT SAVER SEDIMENT TRAPS IN GRADED AREAS.

PRIOR TO COMMENCING LAND-DISTURBING ACTIVITIES IN AREAS OTHER THAN INDICATED ON THE PLANS (INCLUDING BUT NOT LIMITED TO ADDITIONAL PHASES OF DEVELOPMENT AND OFF-SITE BORROW OR WASTE AREAS) A SUPPLEMENTARY EROSION CONTROL PLAN SHALL BE SUBMITTED TO THE OWNER FOR REVIEW.

ALL ADJACENT STREETS MUST BE KEPT CLEAR OF DEBRIS, INSPECTED DAILY AND CLEANED WHEN NECESSARY.

WINTER SHUT DOWN SHALL BE ADDRESSED EARLY IN THE FALL GROWING SEASON SO THAT SLOPES AND OTHER BARE EARTH AREAS MAY BE STABILIZED WITH TEMPORARY AND/OR PERMANENT VEGETATIVE COVER FOR PROPER EROSION AND SEDIMENT CONTROL.

ALL TEMPORARY AND PERMANENT EROSION AND SEDIMENT CONTROL MEASURES SHALL BE MAINTAINED AND REPAIRED AS NEEDED TO ASSURE CONTINUED PERFORMANCE OF THEIR INTENDED FUNCTION.
ALL TEMPORARY EROSION AND SEDIMENT CONTROL MEASURES SHALL BE DISPOSED OF WITHIN 30 DAYS AFTER FINAL SITE STABILIZATION IS ACHIEVED OR AFTER THE TEMPORARY MEASURES ARE NO LONGER NEEDED, TRAPPED SEDIMENT AND OTHER DISTURBED SOIL AREAS RESULTING FROM THE DISPOSITION OF TEMPORARY MEASURES SHOULD BE PERMANENTLY STABILIZED TO PREVENT FURTHER EROSION AND SEDIMENTATION.

IT IS THE RESPONSIBILITY OF THE GENERAL CONTRACTOR TO INFORM ANY SUBCONTRACTORS WHO PREFORM ON THIS PROJECT, OF THE REQUIREMENTS IN IMPLEMENTING AND MAINTAINING THESE EROSION CONTROL PLANS AND THE NATIONAL POLLUTANT DISCHARGE ELIMINATION SYSTEM (NPDES) PERMIT REQUIREMENTS SET FORTH BY THE ILLINOIS IEPA.

ALL EROSION CONTROL MEASURES SHALL BE INSPECTED WEEKLY AND AFTER 1/2" OR MORE OF RAIN EVENT.

EROSION CONTROL NOTES:

1. EROSION CONTROL MEASURES SHALL MEET ALL REQUIREMENTS OF THE VILLAGE AND THE ENVIRONMENTAL PROTECTION AGENCY, N.P.D.E.S. PERMIT CONSTRUCTION SITE ACTIVITIES.
2. UNLESS OTHERWISE INDICATED, ALL VEGETATIVE AND STRUCTURAL EROSION AND SEDIMENT CONTROL PRACTICES WILL BE CONSTRUCTED ACCORDING TO MINIMUM STANDARDS AND SPECIFICATIONS IN THE ILLINOIS URBAN MANUAL REVISED FEBRUARY 2002.
3. A COPY OF THE APPROVED EROSION AND SEDIMENT CONTROL PLAN SHALL BE MAINTAINED ON THE SITE AT ALL TIMES.
4. THE CONTRACTOR IS RESPONSIBLE FOR INSTALLATION OF ANY ADDITIONAL EROSION CONTROL MEASURES NECESSARY TO PREVENT EROSION AND SEDIMENTATION AS DETERMINED BY THE ENGINEER.
5. DURING DEWATERING OPERATIONS, WATER WILL BE PUMPED INTO SEDIMENT BASINS OR SILT TRAPS. DEWATERING DIRECTLY INTO FIELD TILES OR STORM WATER STRUCTURES IS PROHIBITED.
6. IN AREAS WHERE WORK IS COMPLETE, PERMANENT STABILIZATION SHALL OCCUR WITHIN 7 DAYS OF COMPLETION, AND IN AREAS WHERE WORK HAS TEMPORARILY CEASED FOR 21 DAYS OR MORE, TEMPORARY STABILIZATION SHALL OCCUR BY THE 14TH DAY AFTER WORK HAS CEASED. TEMPORARY SEEDING SHALL BE IDOT CLASS I & PERMANENT SEEDING SHALL BE IDOT CLASS I.
7. STOCKPILE OF SOIL & OTHER BUILDING MATERIALS TO REMAIN IN PLACE MORE THAN 3 DAYS SHALL BE FURNISHED WEROSION & SEDIMENT CONTROL MEASURES (I.E. PERIMETER SILT FENCE). STOCKPILES TO REMAIN IN PLACE FOR 30 DAYS OR MORE SHALL RECEIVE TEMPORARY SEEDING.
8. PROPERTIES ADJACENT TO SITE OF A LAND DISTURBANCE SHOULD BE PROTECTED FROM SEDIMENT DEPOSITION. THIS MAY BE ACCOMPLISHED BY PERIMETER CONTROLS SUCH AS FILTER FENCE OR DIKES, OR OTHER APPROVED MEASURES.
9. EROSION CONTROL MEASURES MUST BE CONSTRUCTED AS A FIRST STEP IN GRADING AND BE MADE FUNCTIONAL BEFORE UP SLOPE LAND DISTURBANCE TAKES PLACE.
10. WHEN EVER CONSTRUCTION VEHICLE ACCESS ROUTES INTERSECT PAVED PUBLIC ROADS, PROVISIONS SHOULD BE MADE TO MINIMIZE THE TRANSPORT OF SEDIMENT (MUD) BY RUNOFF OR VEHICLE TRACKING ONTO THE PAVED SURFACE.
11. ALL TEMPORARY EROSION AND SEDIMENT CONTROL MEASURES SHOULD BE DISPOSED OF WITHIN 30 DAYS AFTER FINAL SITE STABILIZATION IS ACHIEVED OR AFTER THE TEMPORARY MEASURES ARE NO LONGER NEEDED. TRAPPED SEDIMENT AND OTHER DISTURBED SOIL AREAS RESULTING FROM THE DISPOSITION OF TEMPORARY MEASURES SHOULD BE PERMANENTLY STABILIZED TO PREVENT FURTHER EROSION AND SEDIMENTATION.
12. ALL TEMPORARY AND PERMANENT EROSION AND SEDIMENT CONTROL MEASURES SHOULD BE MAINTAINED AND REPAIRED AS NEEDED TO ASSURE CONTINUED PERFORMANCE OF THEIR INTENDED FUNCTION.
13. THE CONTRACTOR SHALL BE RESPONSIBLE FOR THE REMOVAL AND RESPREADING OF ANY MATERIAL THAT IS DEPOSITED OFF-SITE.
14. ALL EROSION CONTROL MEASURES MUST BE INSPECTED WEEKLY & AFTER EACH 1/2" RAIN EVENT.
15. ALL ADJACENT STREETS MUST BE KEPT CLEAR OF DEBRIS, INSPECTED DAILY & CLEANED WHEN NECESSARY.
16. TOP SOIL, 6" MINIMUM, SEEDING TYPE I AND FERTILIZER AND EROSION CONTROL BLANKET ARE TO BE PLACED OVER ALL DISTURBED AREAS, FOR FINAL RESTORATION.
17. WINTER SHUT DOWN SHALL BE ADDRESSED EARLY IN THE FALL GROWING SEASON SO THAT SLOPES AND OTHER BARE EARTH AREAS MAY BE STABILIZED WITH TEMPORARY AND/OR PERMANENT VEGETATIVE COVER FOR PROPER EROSION AND SEDIMENT CONTROL.

SOIL PROTECTION CHART

STABILIZATION TYPE	JAN.	FEB.	MAR.	APR.	MAY	JUNE	JULY	AUG.	SEPT.	OCT.	NOV.	DEC.
PERMANENT SEEDING			A			* - *						
DORMANT SEEDING	B										B	
TEMPORARY SEEDING			C				D					
SODDING			E**									
MULCHING	F											

- A KENTUCKY BLUEGRASS 90 LBS/ACRE MIXED WITH PERENNIAL RYEGRASS 30 LBS/ACRE.
- B KENTUCKY BLUEGRASS 135 LBS/ACRE MIXED WITH PERENNIAL RYEGRASS 45 LBS/ACRE + STRAW MULCH 2 TONS/ACRE.
- C SPRING OATS 100 LBS/ACRE
- D WHEAT OR CEREAL RYE 150 LBS/ACRE
- E SOD
- F STRAW MULCH 2 TONS/ACRE

* IRRIGATION NEEDED DURING JUNE AND JULY.
** IRRIGATION NEEDED FOR 2 TO 3 WEEKS AFTER APPLYING SOD

PLAN	DATE	BY
SURVEYED		
DESIGNED		
CHECKED		
IN CHARGE		
NO. OF WAY CHECKED		
NOTE BOOK NO.		
FIELD FILE NAME		

PROFILE	DATE	BY
SURVEYED		
DESIGNED		
CHECKED		
IN CHARGE		
NO. OF WAY CHECKED		
NOTE BOOK NO.		
STRUCTURE NOTATIONS CHRD		

FILE NAME =	USER NAME = #USER#	DESIGNED - DWR	REVISED -
#FILE#		DRAWN - GR	REVISED -
#MODELNAME#	PLOT SCALE = #SCALE#	CHECKED - JJB	REVISED -
	PLOT DATE = #DATE#	DATE - DEC 2013	REVISED -

**STATE OF ILLINOIS
DEPARTMENT OF TRANSPORTATION**

**EROSION AND SEDIMENTATION CONTROL
NOTES AND DETAILS**

F.A.U. RTE.	SECTION	COUNTY	TOTAL SHEETS	SHEET NO.
	12-00053-00-SW	KANE	27	17
CONTRACT NO. 63897				
SCALE:	SHEET 17 OF 27 SHEETS	STA. TO STA.	ILLINOIS FED. AID PROJECT	

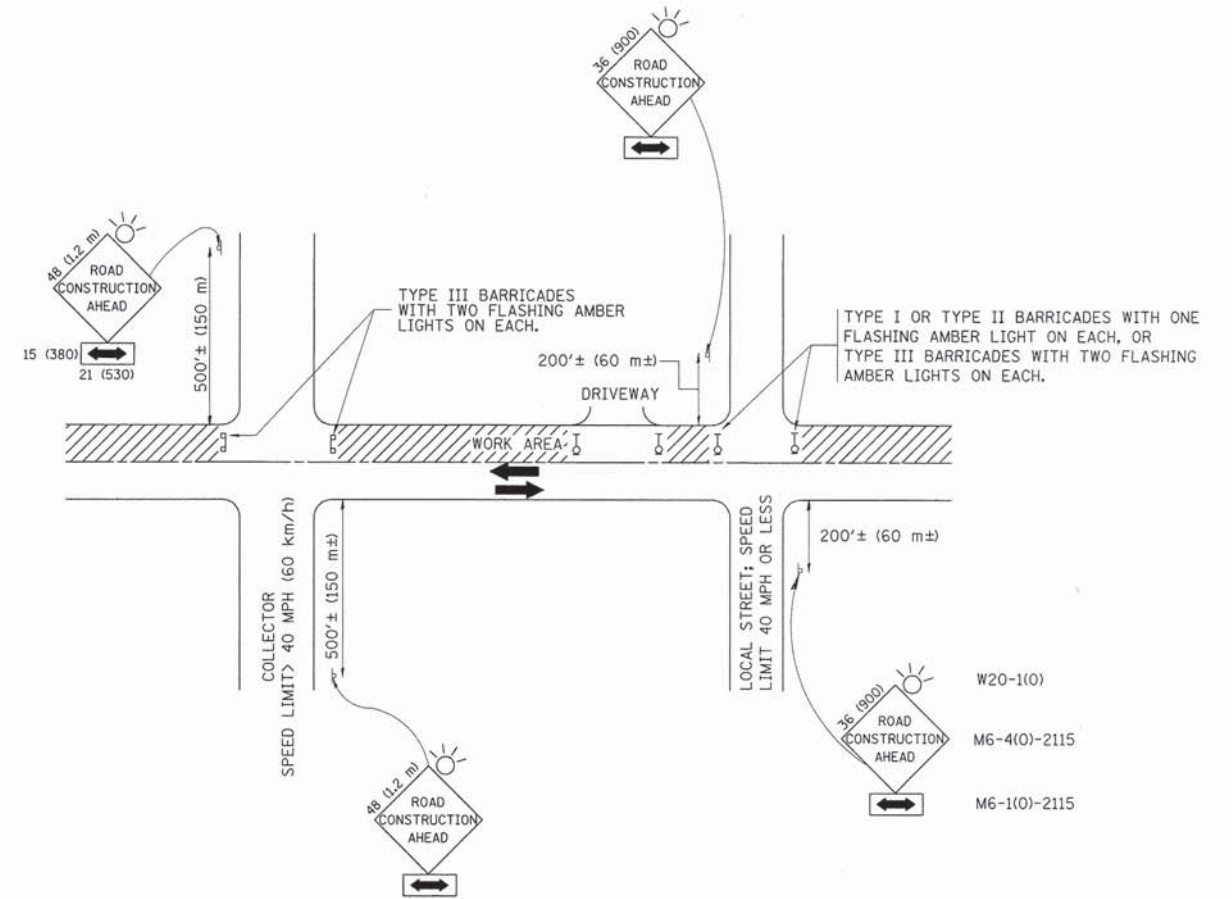

TRAFFIC CONTROL AND PROTECTION FOR SIDE ROADS, INTERSECTIONS, AND DRIVEWAYS

NOTES:

- A. FOR NO LANE RESTRICTION ON THE SIDE ROAD OR DRIVEWAYS
- SIDE ROAD WITH A SPEED LIMIT OF 40 MPH (60 km/h) OR LESS AS SHOWN ON THE DRAWING AND AS DIRECTED BY THE ENGINEER:
 - ONE ROAD CONSTRUCTION AHEAD SIGN 36 x 36 (900x900) WITH A FLASHER AND FLAG MOUNTED ON IT APPROXIMATELY 200' (60 m) IN ADVANCE OF THE MAIN ROUTE.
 - THE CLOSED PORTION OF THE MAIN ROUTE SHALL BE PROTECTED BY BLOCKING WITH TYPE I, TYPE II OR TYPE III BARRICADES, 1/3 OF THE CROSS SECTION OF THE CLOSED PORTION.
 - SIDE ROAD WITH A SPEED LIMIT GREATER THAN 40 MPH (60 km/h) AS SHOWN ON THE DRAWING AND AS DIRECTED BY THE ENGINEER:
 - ONE ROAD CONSTRUCTION AHEAD SIGN 48 x 48 (1.2 m x 1.2 m) WITH A FLASHER MOUNTED ON IT APPROXIMATELY 500' (150 m) IN ADVANCE OF THE MAIN ROUTE.
 - THE CLOSED PORTION OF THE MAIN ROUTE SHALL BE PROTECTED BY BLOCKING WITH TYPE III BARRICADES, 1/2 OF THE CROSS SECTION OF THE CLOSED PORTION.
3. WHEN THE SIDE ROAD LIES BETWEEN THE BEGINNING OF THE MAINLINE SIGNING AND THE WORK ZONE, A SINGLE HEADED ARROW (M6-1) SHALL BE USED IN LIEU OF THE DOUBLE HEADED ARROW (M6-4).
- B. FOR A LANE CLOSURE ON A SIDE ROAD OR DRIVEWAY:
- USE APPLICABLE PORTIONS OF THE TYPICAL APPLICATION OF TRAFFIC CONTROL DEVICES (STD. 701501, STD. 701606 OR THE APPROPRIATE STANDARD). THE SPACING OF SIGNS AND BARRICADES SHALL BE ADJUSTED FOR FIELD CONDITIONS AS DIRECTED BY THE ENGINEER. THE DIRECTIONAL ARROW SHALL BE COVERED OR REMOVED WHEN NO LONGER CONSISTENT WITH THE SIDE ROAD LANE CLOSURE.
- C. ADVANCE WARNING SIGNS ARE TO BE OMITTED ON DRIVEWAY UNLESS OTHERWISE NOTED.
- D. THE TRAFFIC CONTROL AND PROTECTION FOR SIDE ROADS, INTERSECTIONS, AND DRIVEWAYS SHALL BE INCIDENTAL TO THE COST OF SPECIFIED TRAFFIC CONTROL STANDARDS OR ITEMS.

All dimensions are in millimeters (inches) unless otherwise shown.

FILE NAME *	USER NAME * #USER#	DESIGNED - LHA	REVISED - J. OBERLE 10-18-95
#FILE#		DRAWN -	REVISED - A. HOUSEH 03-06-96
	PLOT SCALE * #SCALE#	CHECKED -	REVISED - A. HOUSEH 10-15-96
	PLOT DATE * #DATE#	DATE - 06-89	REVISED - T. RAMMACHER 01-06-00

STATE OF ILLINOIS
DEPARTMENT OF TRANSPORTATION

TRAFFIC CONTROL AND PROTECTION FOR
SIDE ROADS, INTERSECTIONS, AND DRIVEWAYS

SCALE: NONE SHEET 19 OF 27 SHEETS STA. TO STA.

F.A. RTE.	SECTION	COUNTY	TOTAL SHEETS	SHEET NO.
	12-00053-00-SW	KANE	27	19
TC-10			CONTRACT NO. 63897	
FED. ROAD DIST. NO. 1 [ILLINOIS] FED. AID PROJECT				

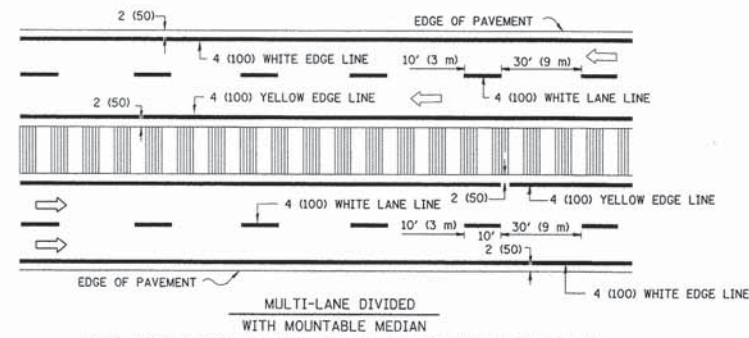
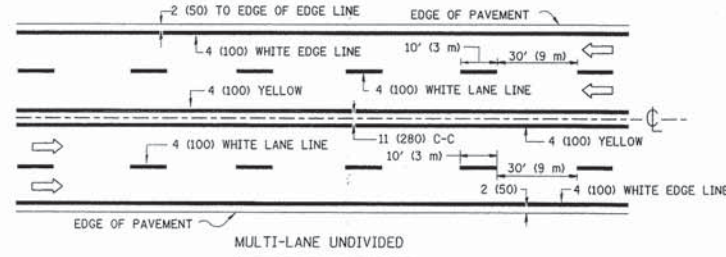
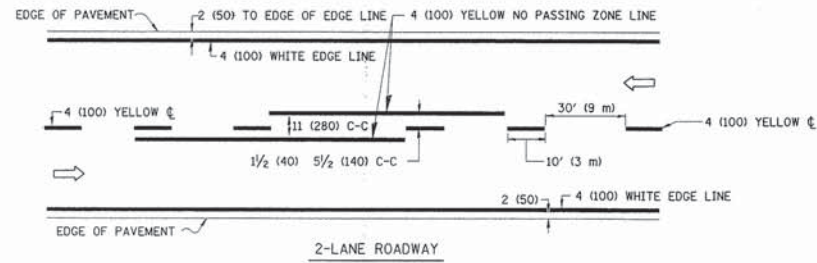

NOTE: MEDIANS WITH BARRIER CURB DO NOT REQUIRE AN EDGE LINE
TYPICAL LANE AND EDGE LINE MARKING

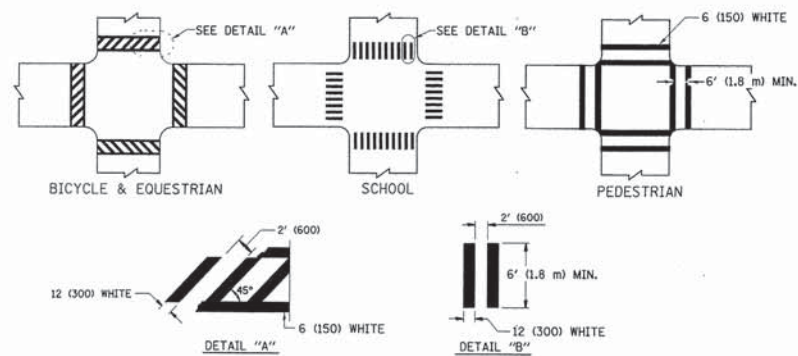

TYPICAL CROSSWALK MARKING

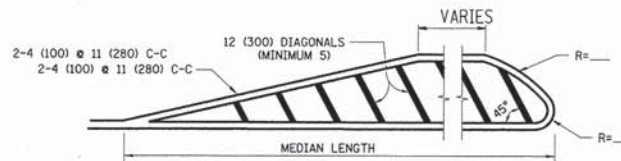
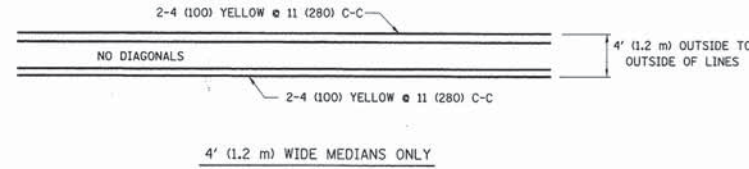

FOR MEDIAN LENGTHS WHERE DIAGONAL SPACING CANNOT BE ATTAINED, USE 5 (FIVE) EQUALLY SPACED DIAGONAL LINES.
 DIAGONAL LINE SPACING: 50' (15 m) C-C (LESS THAN 30MPH (50 km/h))
 75' (25 m) C-C 30MPH (50 km/h) TO 45MPH (70 km/h)
 150' (45 m) C-C (MORE THAN 45MPH (70 km/h))

MEDIANS OVER 4' (1.2 m) WIDE

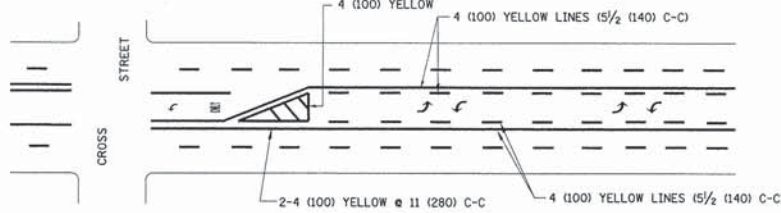

A MINIMUM OF TWO PAIRS OF TURN ARROWS SHALL BE USED, WHITE IN COLOR. ADDITIONAL PAIRS SHALL BE PLACED AT 200' (60 m) TO 300' (90 m) INTERVALS.

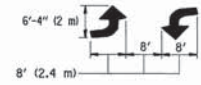

MEDIAN WITH TWO-WAY LEFT TURN LANE

TYPICAL PAINTED MEDIAN MARKING

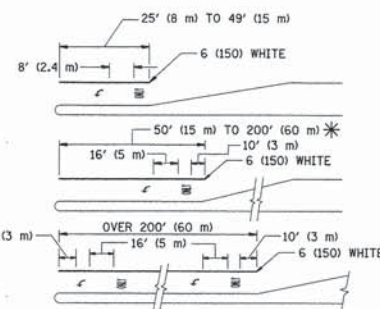

FULL SIZE LETTERS 8' (2.4 m) AND ARROWS SHALL BE USED.
 AREA = 15.6 SQ. FT. (1.5 m²) ONLY AREA = 20.8 SQ. FT. (1.9 m²)
 * TURN LANES IN EXCESS OF 400' (120 m) IN LENGTH MAY HAVE AN ADDITIONAL SET OF ARROW - "ONLY" INSTALLED MIDWAY BETWEEN THE OTHER TWO SETS OF ARROW - "ONLY".

TYPICAL LEFT (OR RIGHT) TURN LANE

TYPICAL TURN LANE MARKING

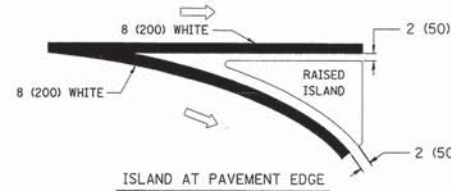
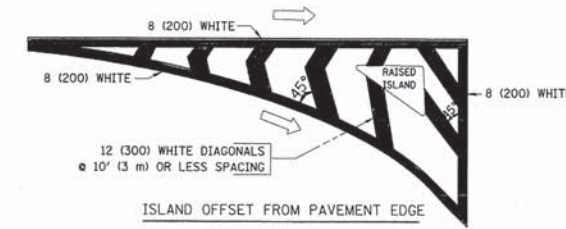

TYPICAL ISLAND MARKING

TYPE OF MARKING	WIDTH OF LINE	PATTERN	COLOR	SPACING / REMARKS
CENTERLINE ON 2 LANE PAVEMENT	4 (100)	SKIP-DASH	YELLOW	10' (3 m) LINE WITH 30' (9 m) SPACE
CENTERLINE ON MULTI-LANE UNDIVIDED PAVEMENT	2 @ 4 (100)	SOLID	YELLOW	11 (280) C-C
NO PASSING ZONE LINES: FOR ONE DIRECTION FOR BOTH DIRECTIONS	4 (100) 2 @ 4 (100)	SOLID SOLID	YELLOW YELLOW	5 1/2 (140) C-C FROM SKIP-DASH CENTERLINE 11 (280) C-C OMIT SKIP-DASH CENTERLINE BETWEEN
LANE LINES	4 (100) 5 (125) ON FREEWAYS	SKIP-DASH SKIP-DASH	WHITE WHITE	10' (3 m) LINE WITH 30' (9 m) SPACE
DOTTED LINES (EXTENSIONS OF CENTER, LANE OR TURN LANE MARKINGS)	SAME AS LINE BEING EXTENDED	SKIP-DASH	SAME AS LINE BEING EXTENDED	2' (600) LINE WITH 6' (1.8 m) SPACE
EDGE LINES	4 (100)	SOLID	YELLOW-LEFT WHITE-RIGHT	OUTLINE MOUNTABLE MEDIANS IN YELLOW; EDGE LINES ARE NOT USED NEXT TO BARRIER CURB
TURN LANE MARKINGS	6 (150) LINE; FULL SIZE LETTERS & SYMBOLS (8' (2.4m))	SOLID	WHITE	SEE TYPICAL TURN LANE MARKING DETAIL
TWO WAY LEFT TURN MARKING	2 @ 4 (100) EACH DIRECTION 8' (2.4m) LEFT ARROW	SKIP-DASH AND SOLID IN PAIRS	YELLOW WHITE	10' (3 m) LINE WITH 30' (9 m) SPACE FOR SKIP-DASH; 5 1/2 (140) C-C BETWEEN SOLID LINE AND SKIP-DASH LINE SEE TYPICAL TWO-WAY LEFT TURN MARKING DETAIL
CROSSWALK LINES (PEDESTRIAN) A. DIAGONALS (BIKE & EQUESTRIAN) B. LONGITUDINAL BARS (SCHOOL)	2 @ 6 (150) 12 (300) @ 45° 12 (300) @ 90°	SOLID SOLID SOLID	WHITE WHITE WHITE	NOT LESS THAN 6' (1.8 m) APART 2' (600) APART SEE TYPICAL CROSSWALK MARKING DETAILS.
STOP LINES	24 (600)	SOLID	WHITE	PLACE 4' (1.2 m) IN ADVANCE OF AND PARALLEL TO CROSSWALK, IF PRESENT. OTHERWISE, PLACE AT DESIRED STOPPING POINT. PARALLEL TO CROSSROAD CENTERLINE, WHERE POSSIBLE
PAINTED MEDIANS	2 @ 4 (100) WITH 12 (300) DIAGONALS @ 45° NO DIAGONALS USED FOR 4' (1.2 m) WIDE MEDIANS	SOLID	YELLOW; TWO WAY TRAFFIC WHITE; ONE WAY TRAFFIC	11 (280) C-C FOR THE DOUBLE LINE SEE TYPICAL PAINTED MEDIAN MARKING.
GORE MARKING AND CHANNELIZING LINES	8 (200) WITH 12 (300) DIAGONALS @ 45°	SOLID	WHITE	DIAGONALS: 15' (4.5 m) C-C (LESS THAN 30MPH (50 km/h)) 20' (6 m) C-C 30MPH (50 km/h) TO 45MPH (70 km/h) 30' (9 m) C-C (OVER 45MPH (70 km/h))
RAILROAD CROSSING	24 (600) TRANSVERSE LINES; "RR" 15' (4.5 m) LETTERS; 16 (400) LINE FOR "X"	SOLID	WHITE	SEE STATE STANDARD 780001 AREA OF "RR" = 3.6 SQ. FT. (0.33 m ²) EACH "X" = 54.0 SQ. FT. (5.0 m ²)
SHOULDER DIAGONALS	12 (300) @ 45°	SOLID	WHITE - RIGHT YELLOW - LEFT	50' (15 m) C-C (LESS THAN 30MPH (50 km/h)) 75' (25 m) C-C (30 MPH (50 km/h) TO 45MPH (70 km/h)) 150' (45 m) C-C (OVER 45MPH (70 km/h))

FOR FURTHER DETAILS ON PAVEMENT MARKING REFER TO STANDARD SPECIFICATIONS FOR ROAD AND BRIDGE CONSTRUCTION AND STATE STANDARD 780001.

All dimensions are in inches (millimeters) unless otherwise shown.

FILE NAME =	USER NAME = #USER#	DESIGNED - EVERS	REVISED - T. RAMMACHER 10-27-94
#FILE#		DRAWN -	REVISED - C. JUCIUS 09-09-09
	PLOT SCALE = #SCALE#	CHECKED -	REVISED -
	PLOT DATE = #DATE#	DATE - 03-19-90	REVISED -

**STATE OF ILLINOIS
 DEPARTMENT OF TRANSPORTATION**

**DISTRICT ONE
 TYPICAL PAVEMENT MARKINGS**

SCALE: NONE SHEET 20 OF 27 SHEETS STA. TO STA.

F.A. RTE.	SECTION	COUNTY	TOTAL SHEETS	SHEET NO.
	12-00053-00-SW	KANE	27	20
TC-13			CONTRACT NO. 63897	
FED. ROAD DIST. NO. 1 ILLINOIS FED. AID PROJECT				

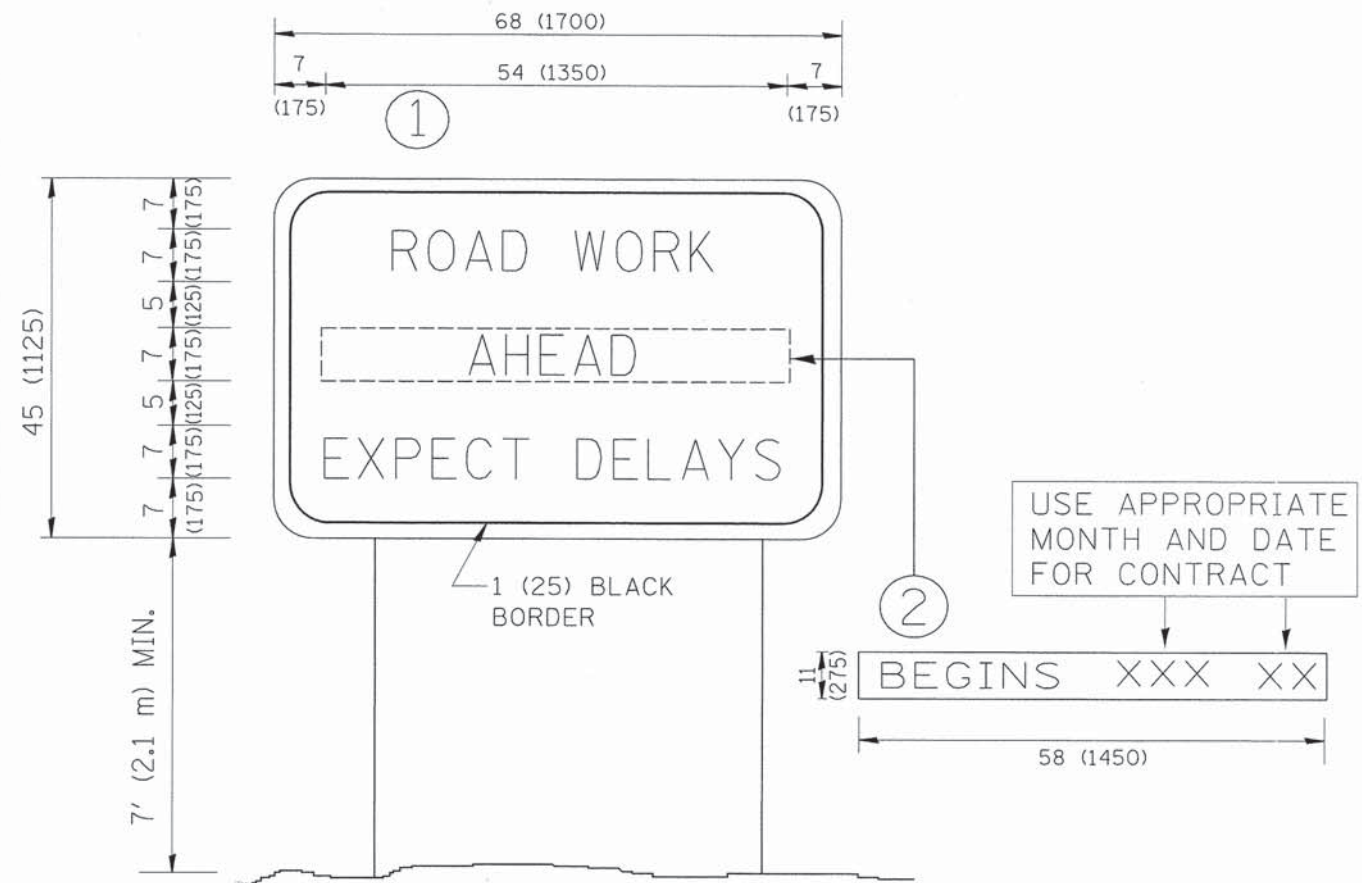

NOTES:

1. USE BLACK LETTERING ON ORANGE BACKGROUND.
2. ERECT SIGNS IN ADVANCE OF THE LOCATION FOR THE "ROAD CONSTRUCTION AHEAD" SIGN AT LOCATIONS AS DIRECTED BY THE ENGINEER.
3. ERECT SIGN ① WITH INSTALLED PANEL ② ONE WEEK PRIOR TO THE START OF CONSTRUCTION.
4. REMOVE PANEL ② SOON AFTER THE START OF CONSTRUCTION.
5. SEE SPECIAL PROVISION FOR "TEMPORARY INFORMATION SIGNING" FOR ADDITIONAL INFORMATION.
6. ONE SIGN ASSEMBLY EQUALS 25.70 SQ. FT. (2.3 SQ. M.)
7. SHALL BE PAID FOR AS TEMPORARY INFORMATION SIGNING.

ALL DIMENSIONS ARE IN INCHES (MILLIMETERS) UNLESS OTHERWISE SHOWN.

FILE NAME = #FILE#	USER NAME = #USER#	DESIGNED -	REVISED - R. MIRS 09-15-97
		DRAWN -	REVISED - R. MIRS 12-11-97
	PLOT SCALE = #SCALE#	CHECKED -	REVISED - T. RAMMACHER 02-02-99
	PLOT DATE = #DATE#	DATE -	REVISED - C. JUCIUS 01-31-07

STATE OF ILLINOIS
DEPARTMENT OF TRANSPORTATION

ARTERIAL ROAD INFORMATION SIGN		F.A. RTE.	SECTION	COUNTY	TOTAL SHEETS	SHEET NO.
SCALE: NONE			12-00053-00-SW	KANE	27	21
SHEET 21 OF 27 SHEETS		STA.	TC-22	CONTRACT NO. 63897		
		TO STA.	FED. ROAD DIST. NO. 1 [ILLINOIS] FED. AID PROJECT			

PLAN	DATE
NO.	
BY	
DATE	
DESIGNED	
CHECKED	
IN CHARGE	
PROJECT NAME	

PROFILE	DATE
NO.	
BY	
DATE	
DESIGNED	
CHECKED	
IN CHARGE	
PROJECT NAME	

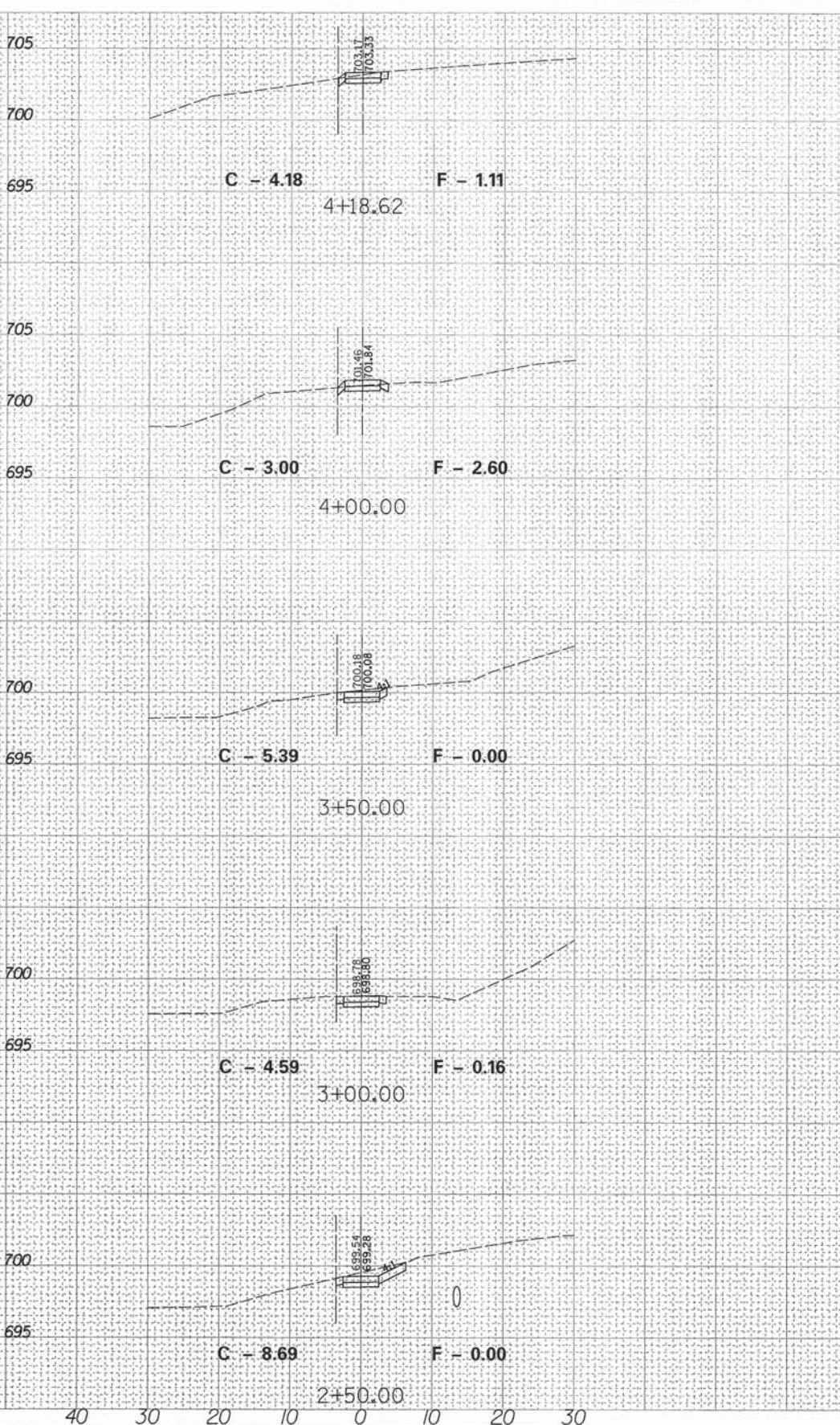
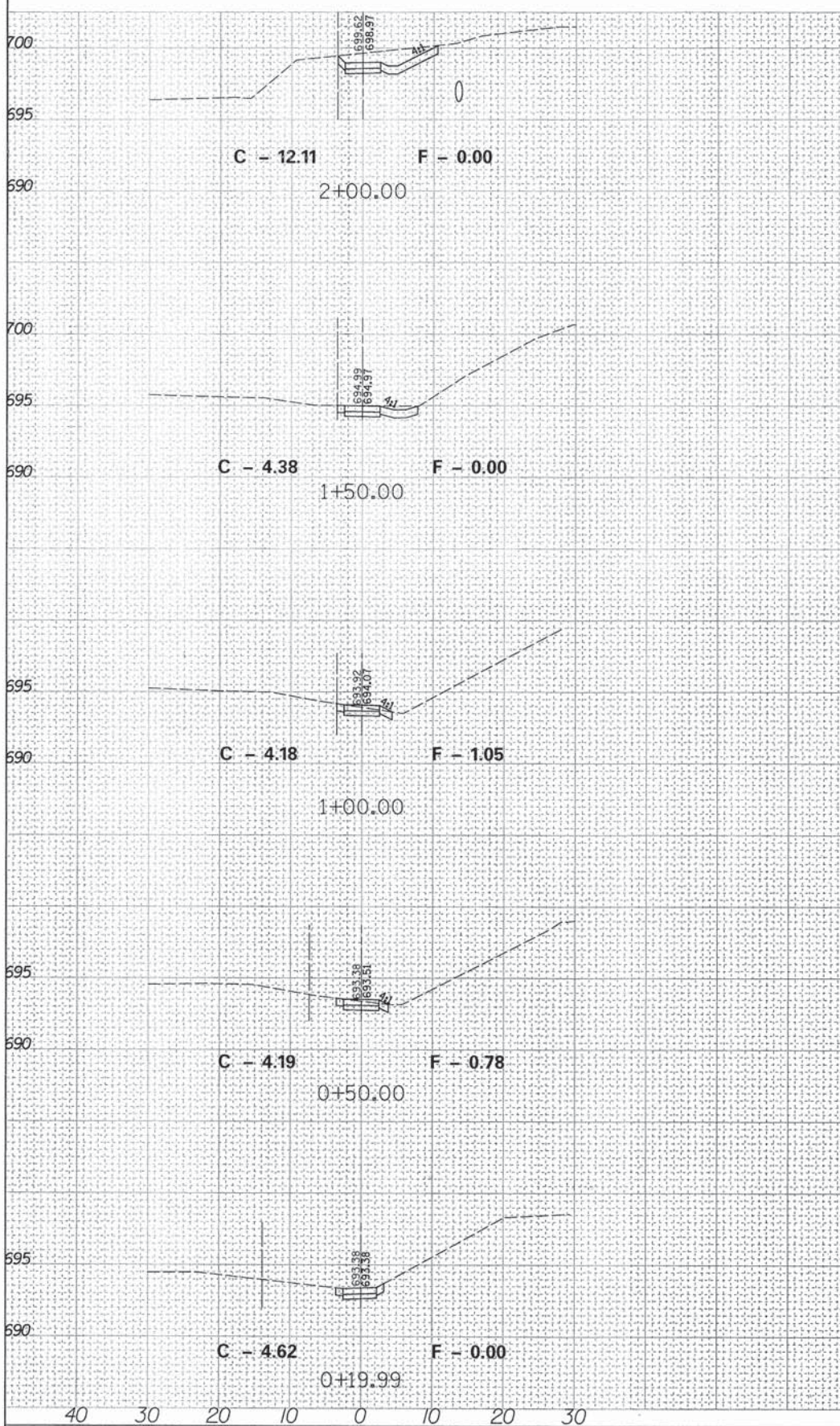

FILE NAME	USER NAME	DESIGNED	REVISED
#FILE#	#USER#	DWR	-
		DRAWN	GR
		CHECKED	JJB
		DATE	DEC 2013

STATE OF ILLINOIS
DEPARTMENT OF TRANSPORTATION

IL RTE 56 (BUTTERFIELD ROAD)
CROSS SECTIONS
SCALE: HORIZ. 1"=10'
VERT. 1"=5'
SHEET 22 OF 27 SHEETS STA. 0+19.99 TO STA. 4+18.62

F.A.U. RTE.	SECTION	COUNTY	TOTAL SHEETS	SHEET NO.
	12-00053-00-SW	KANE	27	22
CONTRACT NO. 63897				
ILLINOIS FED. AID PROJECT				

PLAN	REVISIONS	DATE
NO.	NO.	
NO.	NO.	
NO.	NO.	
NO.	NO.	
NO.	NO.	

PROFILE	REVISIONS	DATE
NO.	NO.	
NO.	NO.	
NO.	NO.	
NO.	NO.	
NO.	NO.	

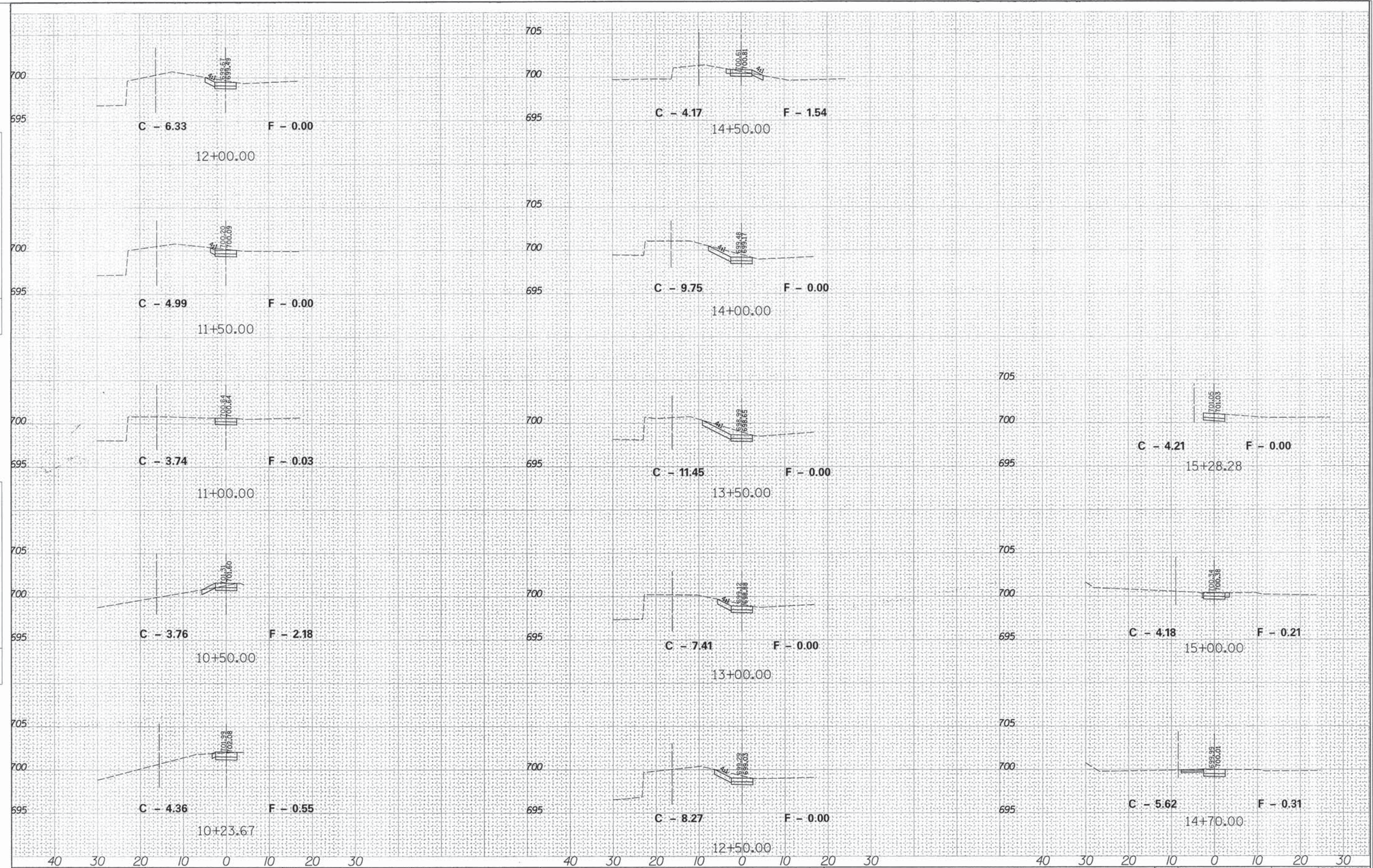

FILE NAME =	USER NAME = #USER#	DESIGNED - DWR	REVISED -
#FILE#		DRAWN - GR	REVISED -
	PLOT SCALE = #SCALE#	CHECKED - JJB	REVISED -
#MODELNAME#	PLOT DATE = #DATE#	DATE - DEC 2013	REVISED -

STATE OF ILLINOIS
DEPARTMENT OF TRANSPORTATION

SCALE: H_v 1"=10'
V_v 1"=5'
SHEET 23 OF 27 SHEETS STA. 10+23.67 TO STA. 15+28.28

LAUREL DRIVE
CROSS SECTIONS

F.A.U. RTE.	SECTION	COUNTY	TOTAL SHEETS	SHEET NO.
	12-00053-00-SW	KANE	27	23
				CONTRACT NO. 63897
ILLINOIS FED. AID PROJECT				

DATE	
BY	
DESIGNED	
PLANNED	
ALIGNED	
CHECKED	
NO. _____	FILE NAME

DATE	
BY	
DESIGNED	
PLANNED	
ALIGNED	
CHECKED	
NO. _____	FILE NAME

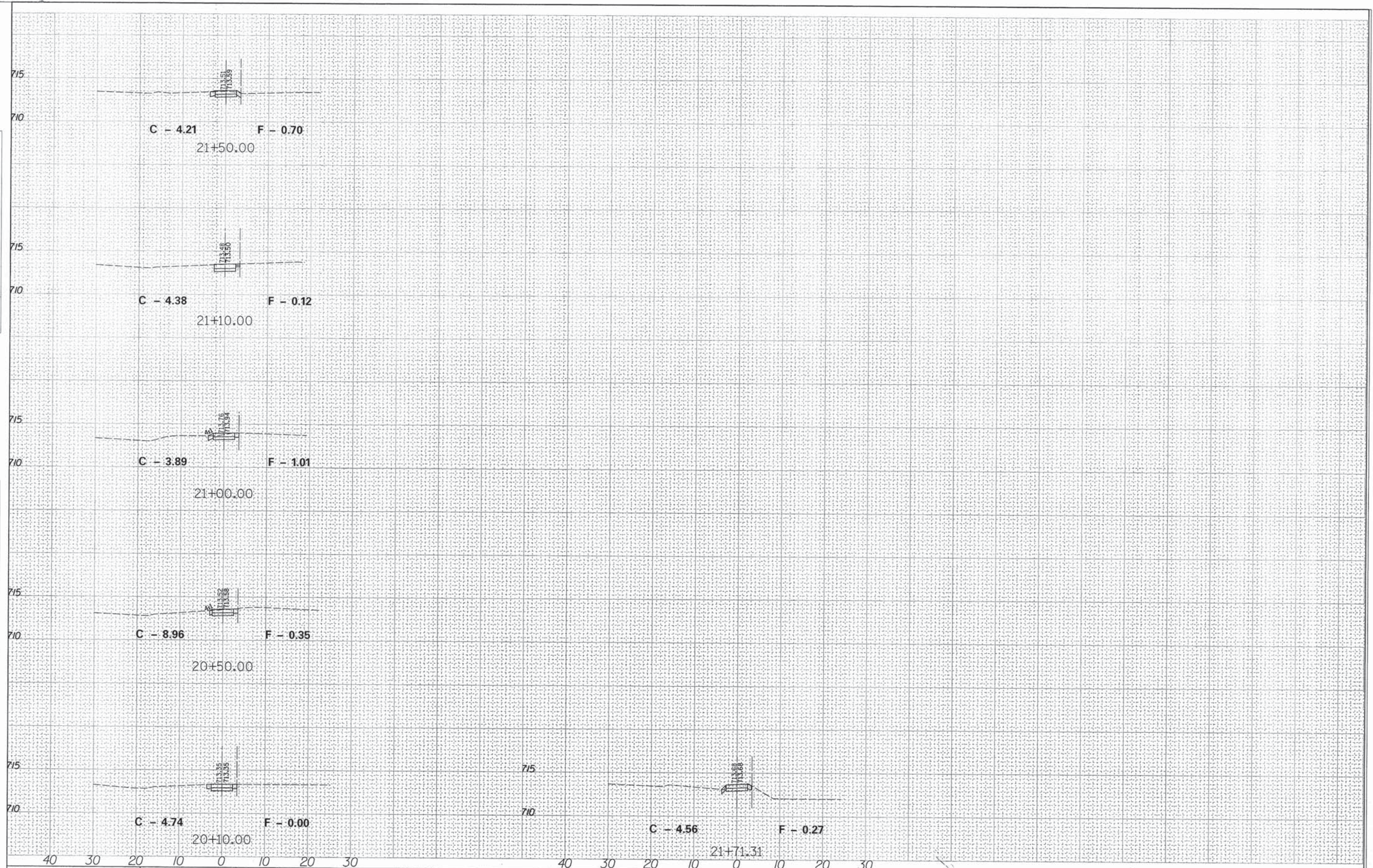

FILE NAME =	USER NAME = #USER#	DESIGNED - DWR	REVISED -
#FILE#		DRAWN - GR	REVISED -
#MODELNAME#		CHECKED - JJB	REVISED -
		DATE - DEC 2013	REVISED -

STATE OF ILLINOIS
DEPARTMENT OF TRANSPORTATION

BANBURY ROAD
CROSS SECTIONS

SCALE: H₁"=10'
V₁"=5'

SHEET 24 OF 27 SHEETS STA. 20+10 TO STA. 21+71.31

F.A.U. RTE.	SECTION	COUNTY	TOTAL SHEETS	SHEET NO.
	12-00053-00-SW	KANE	27	24
CONTRACT NO. 63897				
ILLINOIS FED. AID PROJECT				

PLAN	DATE
BY	
REVIEWED	
NOTED	
NO.	

PROFILE	DATE
BY	
REVIEWED	
NOTED	
NO.	

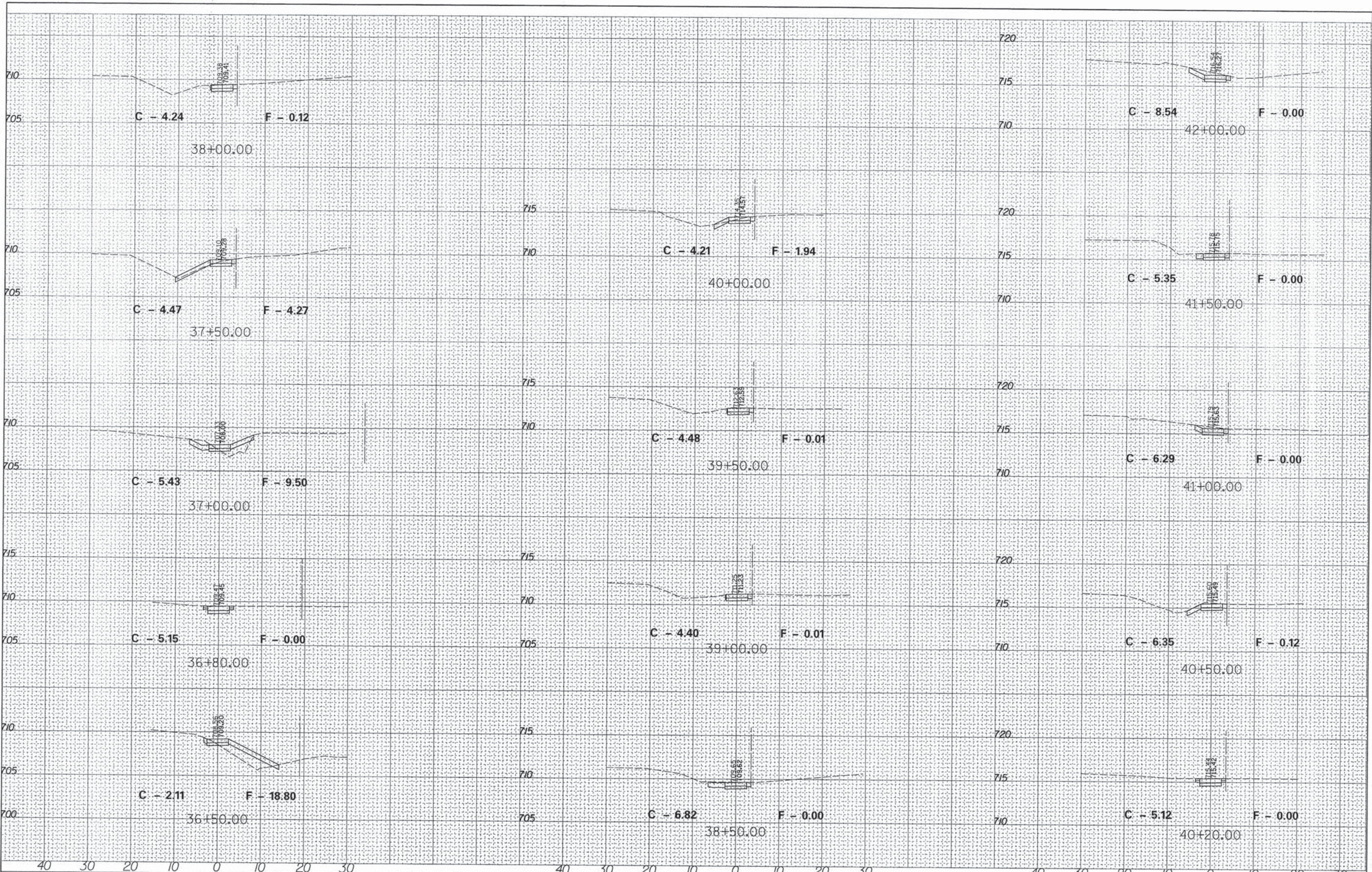

FILE NAME #	USER NAME #	DESIGNED - DWR	REVISED -	STATE OF ILLINOIS DEPARTMENT OF TRANSPORTATION	BANBURY ROAD CROSS SECTIONS	F.A.U. RTE.	SECTION	COUNTY	TOTAL SHEETS	SHEET NO.
#FILE#	#USER#	DRAWN - GR	REVISED -			12-00053-00-SW	KANE	27	26	
#MODELNAME#	PLOT SCALE #	CHECKED - JUB	REVISED -			CONTRACT NO. 63897				
	PLOT DATE #	DATE - DEC 2013	REVISED -			ILLINOIS FED. AID PROJECT				

SCALE: 1"=10' HORIZ. 1"=5' VERT. SHEET 26 OF 27 SHEETS STA. 36+50 TO STA. 42+00

PLAN	SURVEYED	DATE
	PLANNED	BY
NOTE BOOK NO.	CHECKED	
	BY	
	PAID FILE NAME	

PROFILE	DESIGNED	DATE
	DRAWN	BY
NOTE BOOK NO.	CHECKED	
	BY	
	STRUCTURE NOTATIONS (FWD)	



FILE NAME =	USER NAME = #USER#	DESIGNED - DWR	REVISED -
#FILE#		DRAWN - GR	REVISED -
#MODELNAME#	PLOT SCALE = #SCALE#	CHECKED - JJB	REVISED -
	PLOT DATE = #DATE#	DATE - DEC 2013	REVISED -

STATE OF ILLINOIS
DEPARTMENT OF TRANSPORTATION

BANBURY ROAD
CROSS SECTIONS

SCALE: $H=1"=10'$
 $V=1"=5'$ SHEET 27 OF 27 SHEETS STA. 42+30 TO STA. 42+82.86

F.A.U. RTE.	SECTION	COUNTY	TOTAL SHEETS	SHEET NO.
	12-00053-00-SW	KANE	27	27
CONTRACT NO. 63897				
ILLINOIS FED. AID PROJECT				