

EXIST. CURVE IL2.EX1-1
 PI STA. = 974+00.44
 $\Delta = 9^\circ 08' 54''$ (LT)
 $D = 1^\circ 35' 14''$
 $R = 3,610.00'$
 $T = 288.81'$
 $L = 576.40'$
 $E = 11.53'$
 $e = N/A$
 P.C. STA. = 971+11.63
 P.T. STA. = 976+88.03

EXIST. CURVE IL2.EX1-3
 PI STA. = 1000+95.26
 $\Delta = 9^\circ 00' 03''$ (RT)
 $D = 2^\circ 32' 47''$
 $R = 2,250.00'$
 $T = 177.10'$
 $L = 353.46'$
 $E = 6.96'$
 $e = N/A$
 P.C. STA. = 999+18.17
 P.T. STA. = 1002+71.63

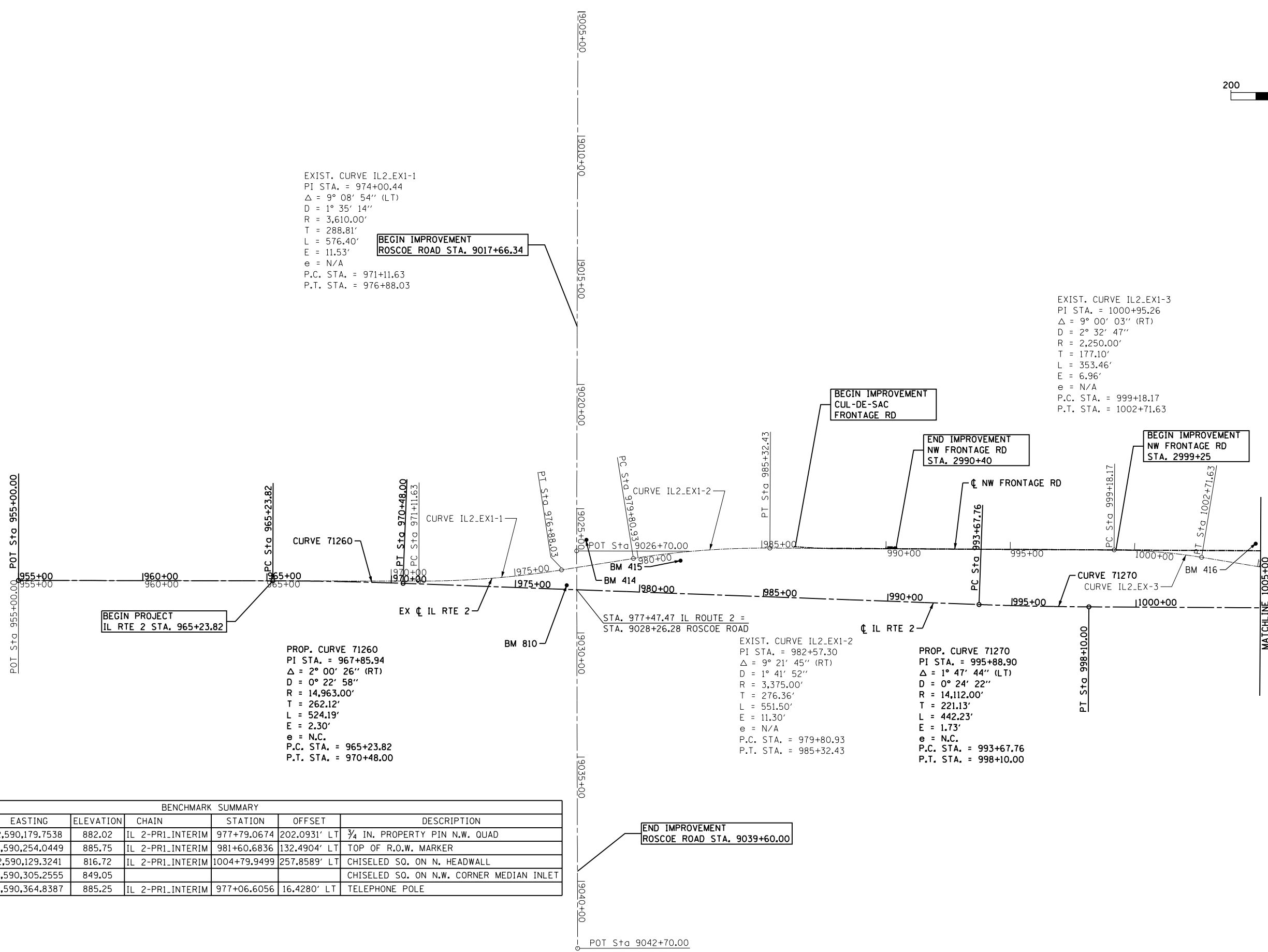

BEGIN PROJECT
 IL RTE 2 STA. 965+23.82

PROP. CURVE 71260
 PI STA. = 967+85.94
 $\Delta = 2^\circ 00' 26''$ (RT)
 $D = 0^\circ 22' 58''$
 $R = 14,963.00'$
 $T = 262.12'$
 $L = 524.19'$
 $E = 2.30'$
 $e = N.C.$
 P.C. STA. = 965+23.82
 P.T. STA. = 970+48.00

EXIST. CURVE IL2.EX1-2
 PI STA. = 982+57.30
 $\Delta = 9^\circ 21' 45''$ (RT)
 $D = 1^\circ 41' 52''$
 $R = 3,375.00'$
 $T = 276.36'$
 $L = 551.50'$
 $E = 11.30'$
 $e = N/A$
 P.C. STA. = 979+80.93
 P.T. STA. = 985+32.43

PROP. CURVE 71270
 PI STA. = 995+88.90
 $\Delta = 1^\circ 47' 44''$ (LT)
 $D = 0^\circ 24' 22''$
 $R = 14,112.00'$
 $T = 221.13'$
 $L = 442.23'$
 $E = 1.73'$
 $e = N.C.$
 P.C. STA. = 993+67.76
 P.T. STA. = 998+10.00

BENCHMARK SUMMARY

POINT	NORTHING	EASTING	ELEVATION	CHAIN	STATION	OFFSET	DESCRIPTION
414	2,094,525.6631	2,590,179.7538	882.02	IL 2-PRI_INTERIM	977+79.0674	202.0931' LT	3/4 IN. PROPERTY PIN N.W. QUAD
415	2,094,906.3940	2,590,254.0449	885.75	IL 2-PRI_INTERIM	981+60.6836	132.4904' LT	TOP OF R.O.W. MARKER
416	2,097,218.8893	2,590,129.3241	816.72	IL 2-PRI_INTERIM	1004+79.9499	257.8589' LT	CHISELED SQ. ON N. HEADWALL
417	2,099,084.9814	2,590,305.2555	849.05				CHISELED SQ. ON N.W. CORNER MEDIAN INLET
810	2,094,450.9224	2,590,364.8387	885.25	IL 2-PRI_INTERIM	977+06.6056	16.4280' LT	TELEPHONE POLE

END IMPROVEMENT
 ROSCOE ROAD STA. 9039+60.00

FILE NAME =	USER NAME =	DESIGNED - RDT	REVISED -
et:\pwork\pwork\undb\aderrr\d0331847	0264H70-shr-ATB-01.dgn	DRAWN - RDT	REVISED -
PLOT SCALE =	CHECKED - GC	REVISIED -	
PLOT DATE =	DATE - 10/05/2012	REVISED -	

STATE OF ILLINOIS
 DEPARTMENT OF TRANSPORTATION

ILLINOIS ROUTE 2
 ALIGNMENT, TIES & BENCHMARKS

SCALE: 1"=200' SHEET NO. 19 OF 179 SHEETS STA. 955+00 TO STA. 1005+00

F.A.P. RTE.	SECTION	COUNTY	TOTAL SHEETS	SHEET NO.
734	77R-1	WINNEBAGO	179	19
CONTRACT NO. 64H70				
ILLINOIS FED. AID PROJECT				