

NOTE:

REFER TO STANDARDS 701326, 701422
AND DISTRICT STANDARD 38.1 FOR
ADDITIONAL INFORMATION.

NO DROP-OFF GREATER THAN 12K SHALL BE WITHIN 3' OF TRAFFIC FOR GREATER THAN 48 HOURS. IF THE DROP-OFF
IS NOT CORRECTED IN THE TIME-FRAME, SAID AREA SHALL BE PROTECTED WITH BARRIER WALL AND IMPACT
ATTENUATORS, APPROVED BY IDOT AT NO ADDITIONAL COST TO IDOT.

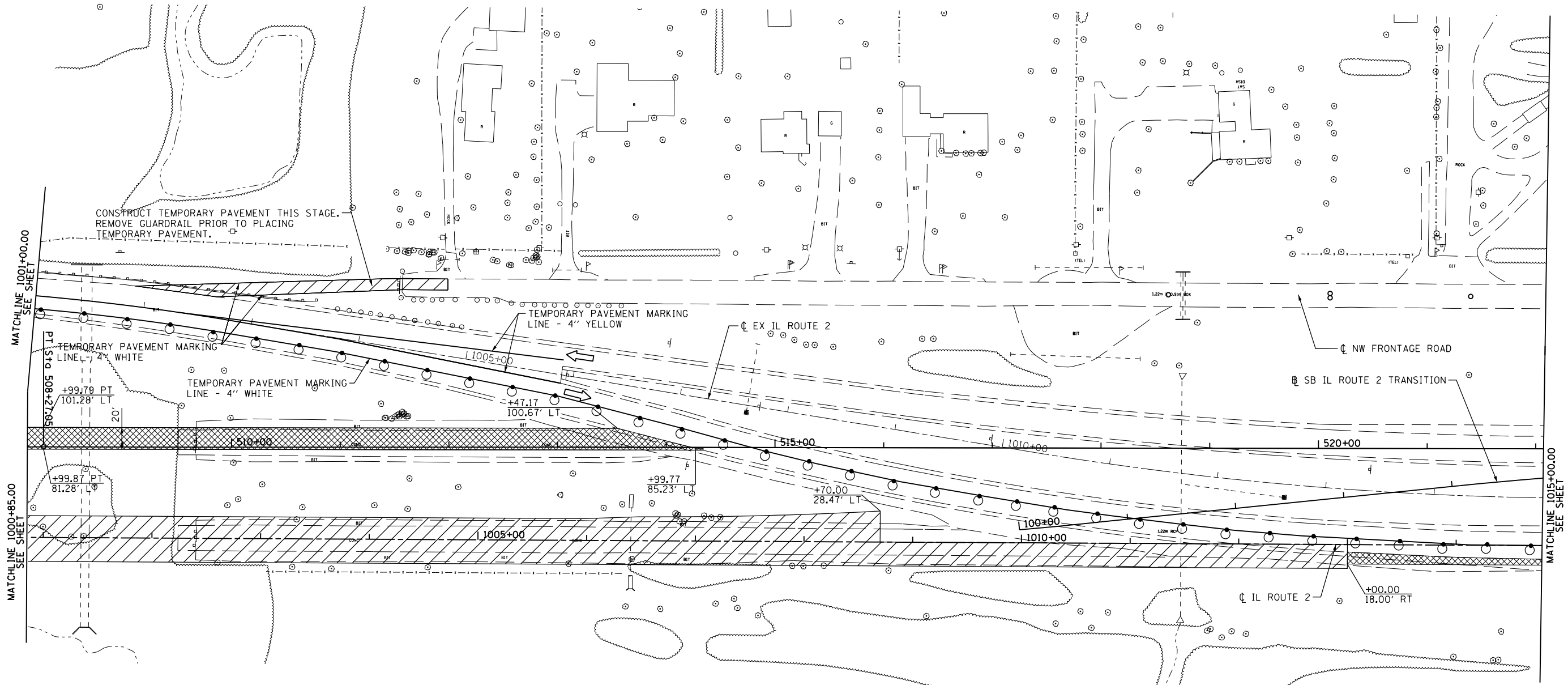

LEGEND

- CONSTRUCTION ZONE THIS STAGE
- DIRECTION OF TRAVEL
- TEMPORARY PAVEMENT (SEE TYPICAL SECTION FOR WIDENING)
- BARRICADE, TYPE III
- DRUM WITH STEADY BI-DIRECTIONAL BURNING LIGHT
- ARROW BOARD
- DIRECTION INDICATOR BARRICADE
- VERTICAL PANEL

FILE NAME = c:\pwork\pwork\idot\undb\aderr\0331856\0264h70-sht-staging01-04.dgn	USER NAME = 0264h70-sht-staging01-04.dgn	DESIGNED - RDT	REVISED -
	PLOT SCALE =	CHECKED - JAC	REVISED -
	PLOT DATE	DATE - 10/05/2012	REVISED -

STATE OF ILLINOIS
DEPARTMENT OF TRANSPORTATION

ILLINOIS ROUTE 2
STAGE 1

SCALE: 1"=50' SHEET NO. 51 OF 179 SHEETS STA. 1000+85 TO STA. 1015+00

F.A.P. RTE.	SECTION	COUNTY	TOTAL SHEETS	SHEET NO.
734	77R-1	WINNEBAGO	179	51
CONTRACT NO. 64H70				
ILLINOIS FED. AID PROJECT				