

INDEX OF SHEETS

1. COVER SHEET
2. GENERAL NOTES
3. SUMMARY OF QUANTITIES
4. TYPICAL SECTIONS
5. LANE CLOSURE DETAILS - FOR STRUCTURE NO. 078-0001
- 6-9. STRUCTURE PLANS FOR STRUCTURE NO. 078-0001

STANDARDS

- 701101-04 OFF-ROAD OPERATIONS MULTILANE, 15' (4.5 m) TO 24' (800 mm) FROM PAVEMENT EDGE
- 701400-07 APPROACH TO LANE CLOSURE, FREEWAY/EXPRESSWAY
- 701402-09 LANE CLOSURE, FREEWAY/EXPRESSWAY, WITH BARRIER
- 701428-06 LANE CLOSURE, MULTILANE INTERMITTENT OR MOVING OPERATION, FOR SPEEDS ≥ 45 MPH
- 701901-03 TRAFFIC CONTROL DEVICES

STATE OF ILLINOIS
DEPARTMENT OF TRANSPORTATION
DIVISION OF HIGHWAYS
PROPOSED
HIGHWAY PLANS

F.A.I. ROUTE 180 (I-180)
 SECTION (06-3,78-1)PM-1

CLEANING AND PAINTING STRUCTURAL STEEL
BEAM ENDS AT STRUCTURE NO. 078-0001
OVER THE ILLINOIS RIVER NEAR HENNEPIN
BUREAU COUNTY

C-93-020-14

F.A.I. RTE.	SECTION	COUNTY	TOTAL SHEETS	SHEET NO.
180	106-3,78-1)PM-1	BUREAU	9	1
		ILLINOIS	CONTRACT NO. 66D27	

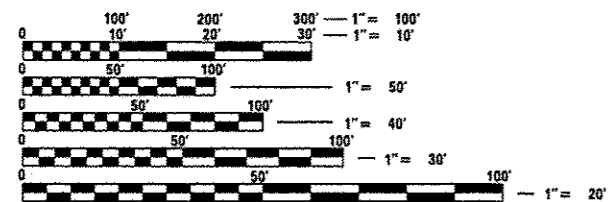
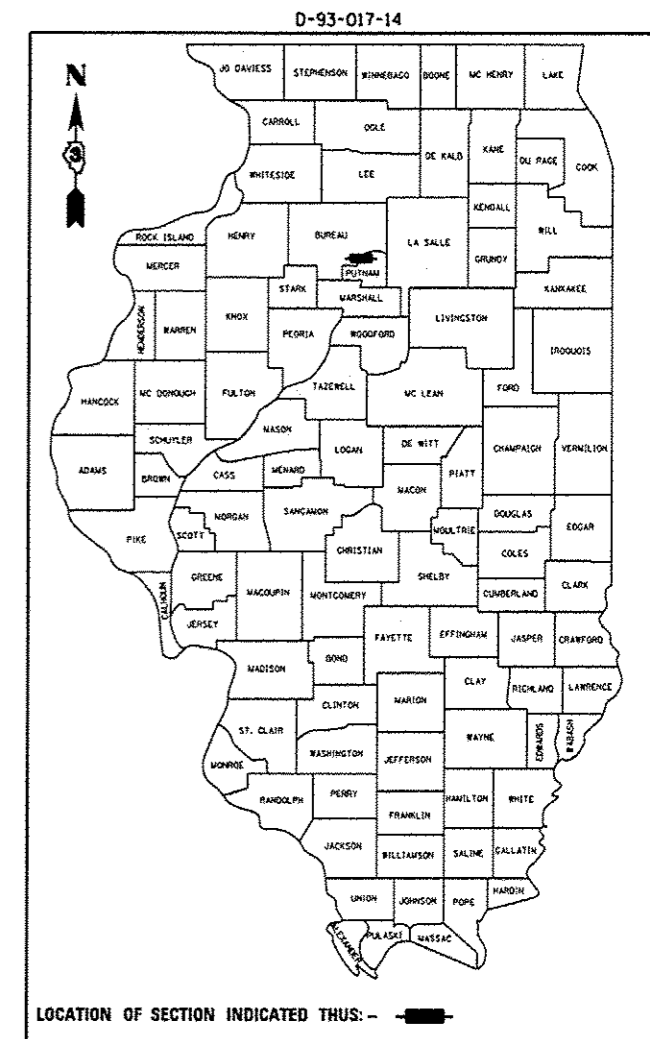

FULL SIZE PLANS HAVE BEEN PREPARED USING STANDARD ENGINEERING SCALES. REDUCED SIZED PLANS WILL NOT CONFORM TO STANDARD SCALES. IN MAKING MEASUREMENTS ON REDUCED PLANS, THE ABOVE SCALES MAY BE USED.

J.U.L.I.E.
 JOINT UTILITY LOCATION INFORMATION FOR EXCAVATION
 1-800-892-0123
 OR 811

DISTRICT NO. 3 (815) 434-6131

PROJECT ENGINEER: JOE KANNEL, P.E.
 PROJECT MANAGER: RON WOODSHANK
 TOWNSHIP: LEEPERTOWN

CONTRACT NO. 66D27

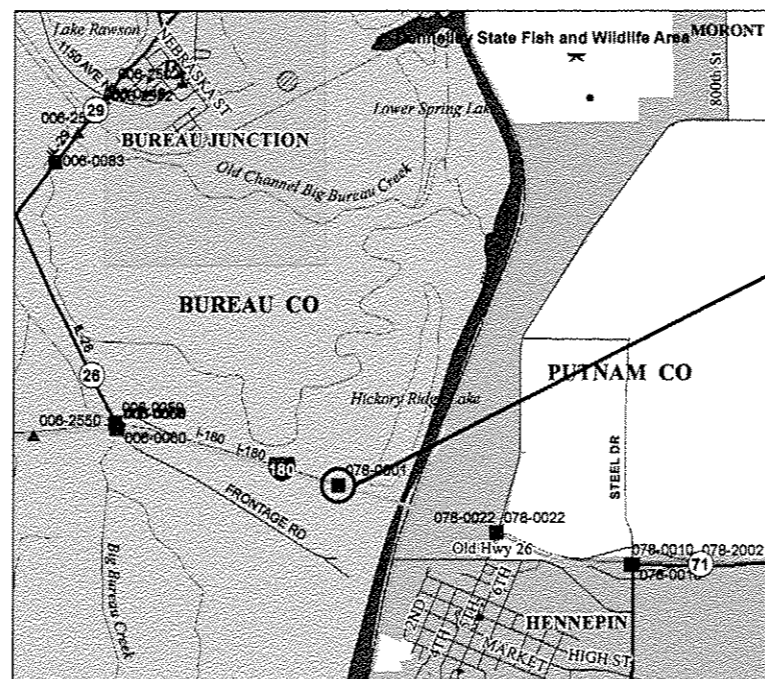

PROJECT LOCATION
 STRUCTURE NO. 078-0001
 STA. 69+29.50

GROSS LENGTH = 3083 FT. = 0.580 MILE
 NET LENGTH = 40 FT. = 0.008 MILE

RURAL	
INTERSTATE	
FAI 180 (I-180)	
2011	

ADT	2650
P.V.	81.14%
S.U.	9.43%
M.U.	9.43%

STATE OF ILLINOIS
 DEPARTMENT OF TRANSPORTATION
 DIVISION OF HIGHWAYS

SUBMITTED Paul A. Tarkenton 12-9 20 13
 DEPUTY DIRECTOR OF HIGHWAYS, REGION ENGINEER

John D. Baranzelli, PE, Inc. Jan 24 20 14
 ENGINEER OF DESIGN AND ENVIRONMENT

Omer Osman, PE, Inc. Jan 24 20 14
 DIRECTOR OF HIGHWAYS, CHIEF ENGINEER

PRINTED BY THE AUTHORITY
OF THE STATE OF ILLINOIS

GENERAL NOTES

COMMITMENTS

PLAN DIMENSIONS AND DETAILS HAVE BEEN TAKEN FROM EXISTING PLANS AND ARE SUBJECT TO ROUTINE VARIATIONS. THE CONTRACTOR SHALL FIELD VERIFY EXISTING DIMENSIONS AND DETAILS AFFECTING THE UNIT BID PRICE FOR THE WORK.

THE CONTRACTOR SHALL BE RESPONSIBLE FOR PROTECTING UTILITY PROPERTY FROM CONSTRUCTION OPERATIONS AS OUTLINED IN ARTICLE 107.31 OF THE STANDARD SPECIFICATIONS. THE "JULIE" NUMBER IS 1-800-892-0123 OR 811 A MINIMUM OF FORTY EIGHT (48) HOURS ADVANCE NOTICE IS REQUIRED.

THE CONTRACTOR'S ATTENTION IS DIRECTED TO THE PRESENCE OF DEPARTMENT-OWNED ELECTRICAL CABLE WITHIN THE LIMITS OF THE PROPOSED IMPROVEMENT. THE CONTRACTOR SHALL PROTECT THE ELECTRICAL CABLE FROM DAMAGE DUE TO HIS CONSTRUCTION OPERATIONS. ALL DAMAGE TO THE DEPARTMENT OWNED ELECTRICAL CABLE CAUSED BY THE CONTRACTOR'S OPERATIONS SHALL BE REPLACED OR REPAIRED TO THE SATISFACTION OF THE ENGINEER AT THE CONTRACTOR'S EXPENSE. THIS SHALL INCLUDE ALL TEMPORARY REPAIRS REQUIRED TO KEEP THE FACILITY OPERATIONAL WHILE MATERIAL IS OBTAINED TO MAKE PERMANENT REPAIRS. SPLICING OF ELECTRICAL CABLE SHALL NOT BE ALLOWED. ELECTRICAL CABLE SHALL BE REPLACED, FROM POLE TO POLE OR CONTROLLER.

FOR STABILIZATION, ALL TYPE III BARRICADES SHALL REQUIRE A MINIMUM OF FOUR SAND BAGS PER BARRICADE.

WHERE SECTION OR SUBSECTION MONUMENTS ARE ENCOUNTERED, THE ENGINEER SHALL BE NOTIFIED BEFORE THE CONTRACTOR BEGINS CLEANING AND PAINTING OPERATIONS. THE CONTRACTOR SHALL PROTECT AND CAREFULLY PRESERVE ALL MONUMENTS SO THAT DAMAGE FROM THE CONTRACTORS CLEANING AND PAINTING OPERATIONS DOES NOT OCCUR. THE CONTRACTOR SHALL BE RESPONSIBLE FOR HAVING AN AUTHORIZED SURVEYOR REESTABLISH AND SECTION OR SUBSECTION MONUMENTS DESTROYED BY HIS(HER) OPERATIONS.

ANY REFERENCE TO A STANDARD IN THESE PLANS SHALL BE INTERPRETED TO MEAN THE EDITION AS INDICATED BY THE SUBNUMBER SHOWN IN THE LIST OF STANDARDS OR THE COPY INCLUDED IN THESE PLANS.

THE CONTRACTOR SHALL BE REQUIRED TO SECURE WASTE CONTAINERS THAT REMAIN ON THE JOB SITE. THIS WILL ENTAIL THAT ALL WASTE CONTAINERS CANNOT BE MOVED OR OPENED DURING NON-WORKING HOURS.

WORKING DAYS SHALL BE CHARGED UNTIL THE CONTRACTOR/SUBCONTRACTOR LISCENSED TO DISPOSE OF LEAD PAINT RESIDUE HAS REMOVED THE WASTE MATERIAL FROM THE JOB SITE ACCORDING TO ALL FEDERAL, STATE AND LOCAL LAWS AND ORDINANCES.

THE EXISTING STRUCTURAL STEEL ON STRUCTURE NO. 078-0001 CONTAINS LEAD. THE CONTRACTOR SHOULD TAKE PERCAUTIONS TO DEAL WITH THE LEAD PAINT ON THIS PROJECT.

THE SSPC-QP1 AND SSPC-QP2 "PAINTING CONTRACTOR CERTIFICATIONS" WILL BE REQUIRED FOR THIS PROJECT.

LOCATION 1: PIER 6 & LOCATION 2: PIER 3

CLEANING AND PAINTING OF THE EXISTING STRUCTURAL STEEL SHALL BE AS SPECIFIED IN THE SPECIAL PROVISION FOR "CLEANING AND PAINTING EXISTING STEEL STRUCTURES". ALL EXTERIOR AND INTERIOR SURFACES OF ALL GIRDERS, DIAPHRAGMS, CROSS FRAMES, AND STIFFENERS WITHIN 12' (AS MEASURED FROM THE CENTERLINE OF PIER IN EACH DIRECTION ALONG THE CENTERLINE OF GIRDER) INCLUDING ALL STRUCTURAL STEEL ASSOCIATED WITH EXISTING BEARINGS AND ALL OTHER STEEL COMPONENTS SHALL BE CLEANED PER "NEAR WHITE BLAST CLEANING - SSPC10". ALL CLEANED STEEL SHALL BE PAINTED ACCORDING THE THE REQUIREMENTS OF "PAINT SYSTEM 1 - OZ/E/U". THE COLOR OF THE FINAL FINISH COAT FOR ALL INTERIOR SURFACES SHALL BE "GRAY, MUNSELL NO. 5B 7/1". THE COLOR OF THE FINAL FINISH COAT FOR ALL EXTERIOR SURFACES SHALL BE "BLUE, MUNSELL NO. 10B 3/6".

DATE: 12-9-13

PREPARED BY: [Signature]
DISTRICT STUDIES & PLANS ENGINEER

EXAMINED BY: [Signature]
DISTRICT CONSTRUCTION ENGINEER

[Signature]
DISTRICT MATERIALS ENGINEER

[Signature]
DISTRICT OPERATIONS ENGINEER

Rev.

FILE NAME *	USER NAME * Patelyj	DESIGNED - YOGESH PATEL	REVISED -	STATE OF ILLINOIS DEPARTMENT OF TRANSPORTATION	GENERAL NOTES	F.A.I. RTE.	SECTION	COUNTY	TOTAL SHEETS	SHEET NO.
cr:\pwork\psidot\patelyj\d0358638\036627-shr-details.dgn	DRAWN - YOGESH PATEL	REVISED -	180			(06-3,78-1)PM-1	BUREAU	9	2	
PLOT SCALE * 1/8"=1'-0"	CHECKED - RON WOODSHANK	REVISED -	CONTRACT NO. 66027							
MODELNAME	PLOT DATE = 12/9/2013	DATE -	SCALE:			SHEET 1 OF 1 SHEETS	STA. TO STA.	ILLINOIS FED. AID PROJECT		

CODE NO.	ITEM	UNIT	TOTAL QUANTITY	CONSTR. CODE
				STATE FUNDS 100% STATE STRUCTURE 0014 RURAL
50606701	CLEANING AND PAINTING STRUCTURAL STEEL, LOCATION 1	L SUM	1	1
67100100	MOBILIZATION	L SUM	1	1
70100207	TRAFFIC CONTROL AND PROTECTION, STANDARD 701402	EACH	2	2
70400100	TEMPORARY CONCRETE BARRIER	FOOT	500	500
70400200	RELOCATED TEMPORARY CONCRETE BARRIER	FOOT	500	500
70600250	IMPACT ATTENUATORS, TEMPORARY (NON-REDIRECTIVE), TEST LEVEL 3	EACH	2	2
70600350	IMPACT ATTENUATORS, RELOCATE (NON-REDIRECTIVE), TEST LEVEL 3	EACH	2	2
* 78009006	MODIFIED URETHANE PAVEMENT MARKING - LINE 6"	FOOT	500	500
78300100	PAVEMENT MARKING REMOVAL	SQ FT	250	250
Z0007101	CONTAINMENT AND DISPOSAL OF LEAD PAINT CLEANING RESIDUES NO. 1	L SUM	1	1

10
* SPECIALITY ITEM

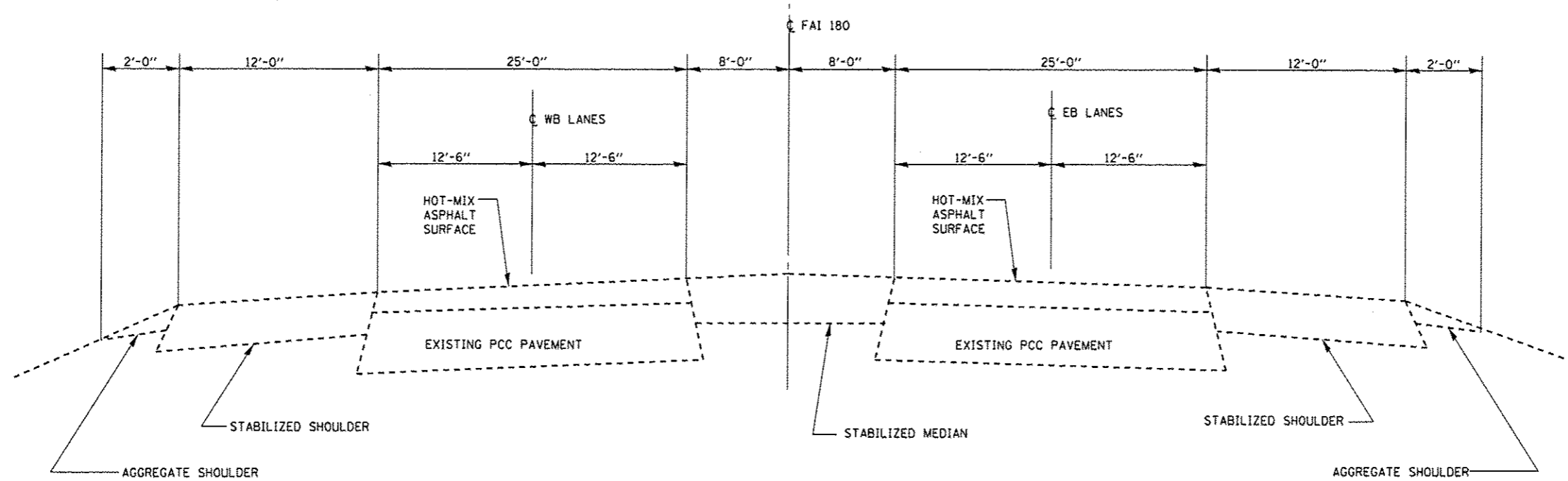

**TYPICAL SECTION
WEST OF ILLINOIS RIVER**

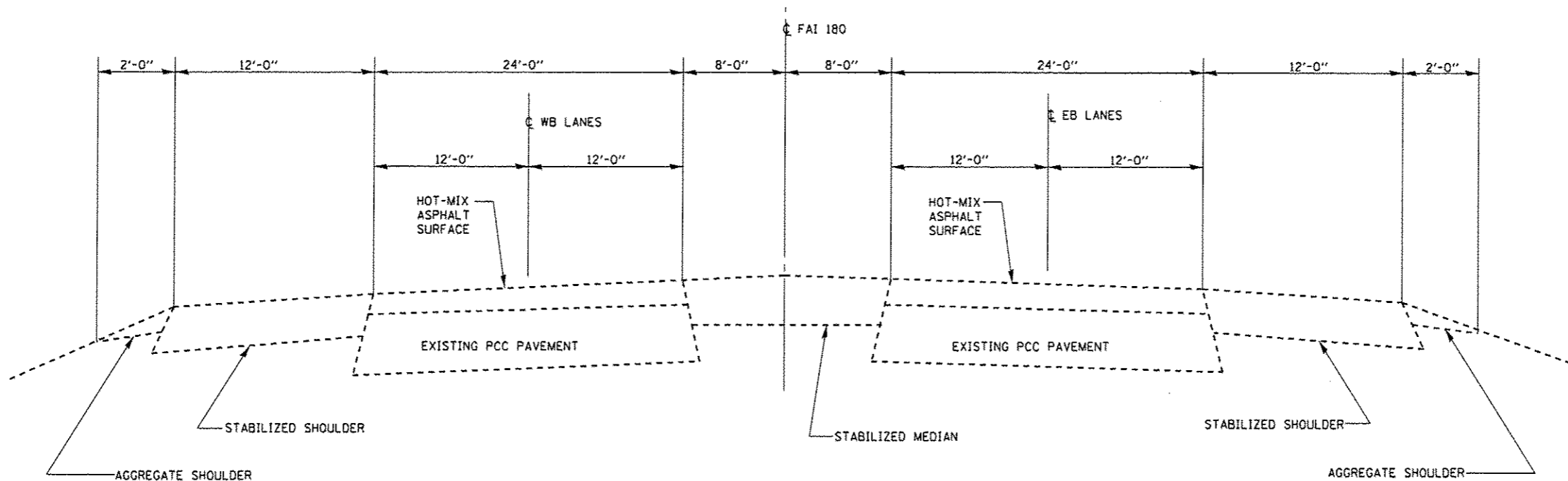

**TYPICAL SECTION
EAST OF ILLINOIS RIVER**

FILE NAME *	USER NAME * Pateli,j	DESIGNED - YOGESH PATEL	REVISED -	STATE OF ILLINOIS DEPARTMENT OF TRANSPORTATION	TYPICAL SECTIONS			F.A.I. RTE.	SECTION	COUNTY	TOTAL SHEETS	SHEET NO.
c:\pwork\pwork\pateli,j\d8358838\036627-ahd-detailed.dgn	PLOT SCALE * 100.0000 ' / in.	DRAWN - YOGESH PATEL	REVISED -					180	(06-3,78-1)PM-1	BUREAU	9	4
MODELNAME	PLOT DATE * 12/9/2013	CHECKED - RON WOODSHANK	REVISED -		SCALE:	SHEET 1 OF 1 SHEETS	STA.	TO STA.	CONTRACT NO. 66027			
		DATE -	REVISED -						ILLINOIS FED. AID PROJECT			

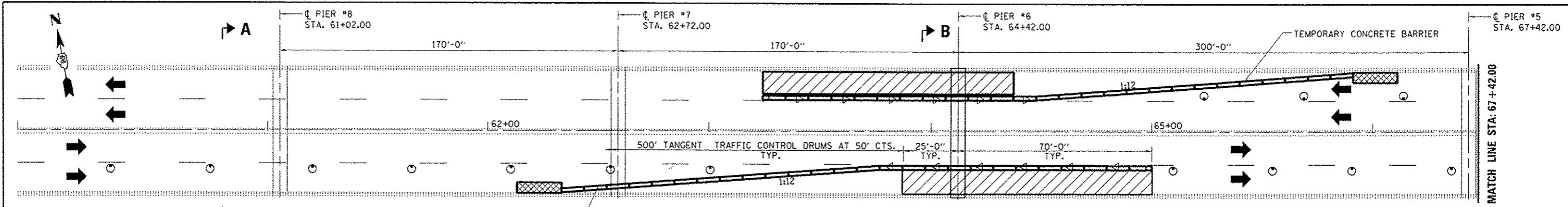

PLAN PIER 6

THE ENGINEER MAY REQUIRE ADDITIONAL TRAFFIC CONTROL DRUMS TO EXTEND THE WORKZONE BETWEEN THE WORKSITES. COST INCLUDED WITH THE ASSOCIATED TRAFFIC CONTROL AND PROTECTION.

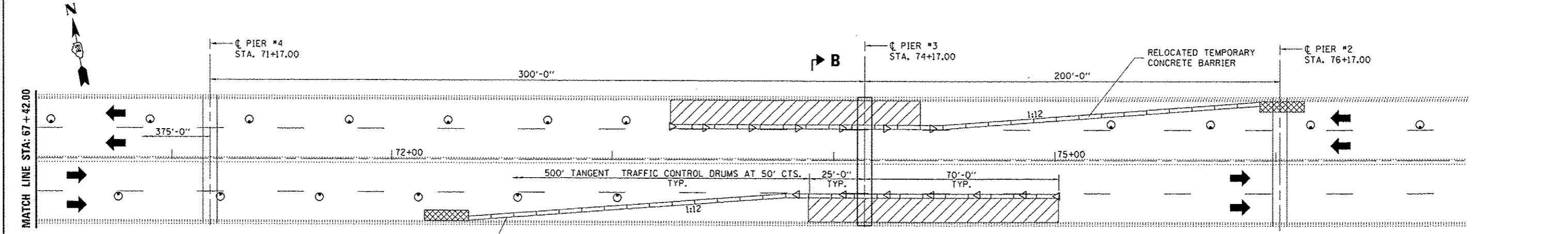

PLAN PIER 3

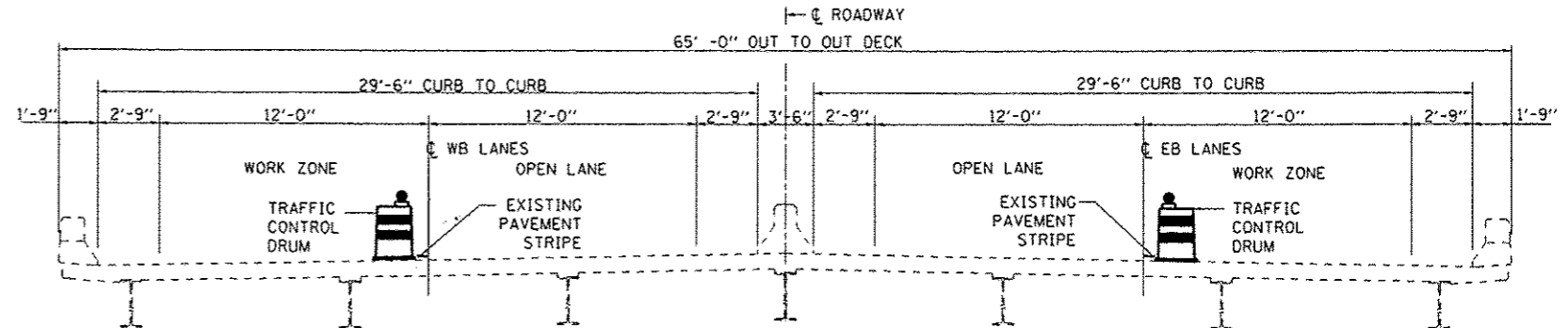

SECTION A-A TYP.
SHOWN LOOKING EAST

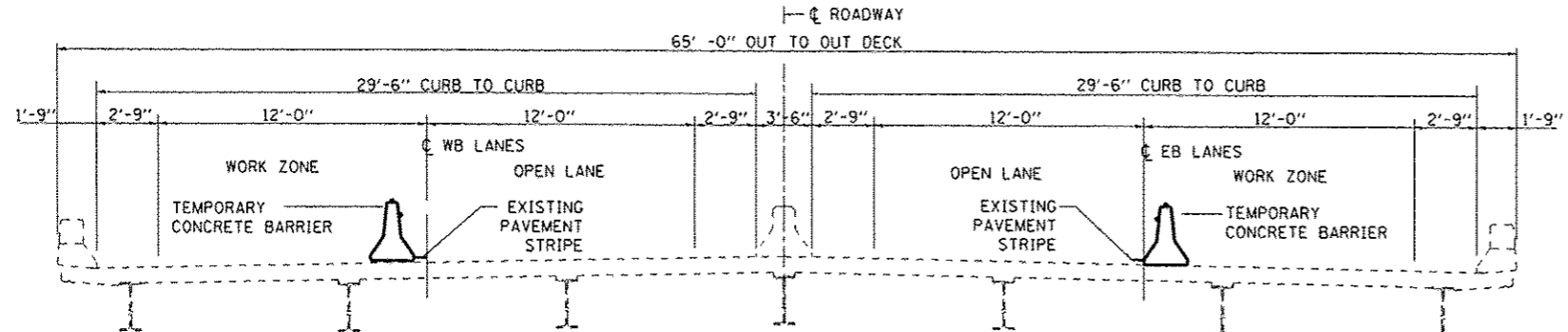

SECTION B-B TYP.
SHOWN LOOKING EAST

- SYMBOLS**
- Work area
 - Drum, with steady burn monodirectional light
 - Temporary concrete barrier
 - Relocated temporary concrete barrier
 - Monodirectional barrier wall/guardrail marker
 - Impact attenuator
 - Relocated impact attenuator

GENERAL NOTES

This standard is used where at any time any vehicle, equipment, workers or their activities will encroach on the pavement or on the shoulder within 24 (600) of the edge of pavement for day light operation exceeding one day and where temporary concrete barrier is utilized. This detail must always be used in combination with Standard 701402. When work is being performed in the left lane, the set up would be a mirror image to what is shown.

FILE NAME *	USER NAME * Pately	DESIGNED - YOGESH PATEL	REVISED -	STATE OF ILLINOIS DEPARTMENT OF TRANSPORTATION	LANE CLOSURE DETAILS FOR STRUCTURE NO. 078-0001	F.A.I. RTE.	SECTION	COUNTY	TOTAL SHEETS	SHEET NO.
cd:\pw\work\p\idat\pately\100358830\036027-shc-details.dgn	DRAWN - YOGESH PATEL	REVISIONS -	180			(06-3,78-11PM-1	BUREAU	9	5	
PLOT SCALE * 100.0000 1/2 in.	CHECKED - RON WOOSHANK	REVISIONS -	CONTRACT NO. 66027							
PLOT DATE * 12/9/2013	DATE -	REVISIONS -	ILLINOIS FED. AID PROJECT							
SCALE:		SHEET 1 OF 1 SHEETS		STA. TO STA.						

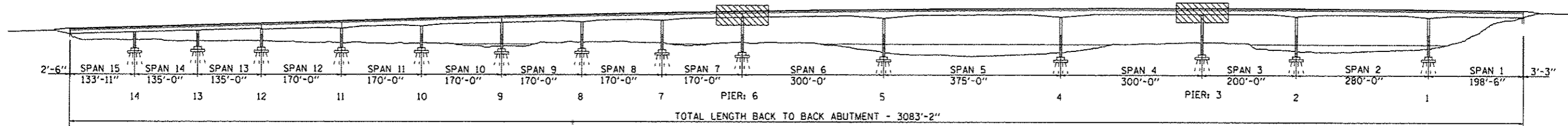

ELEVATION

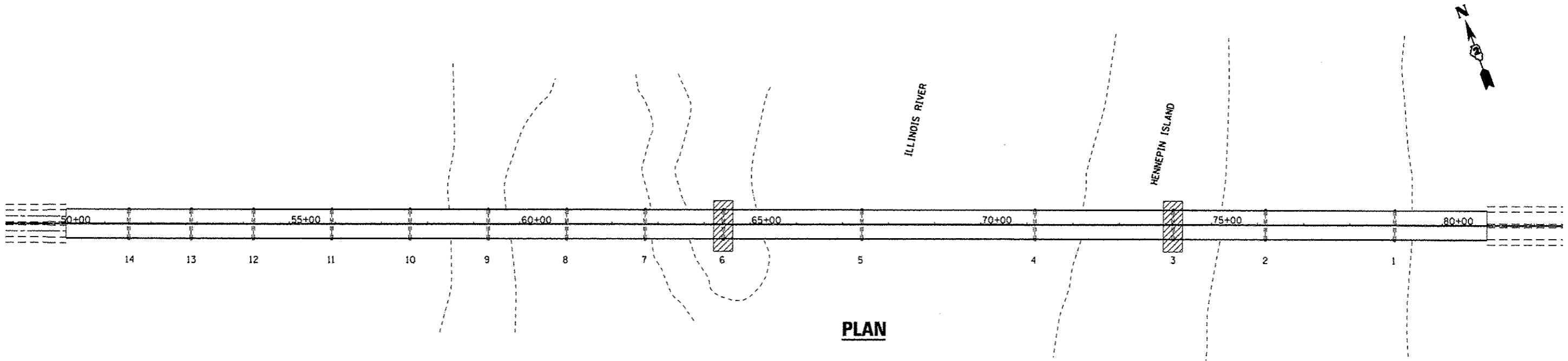

PLAN

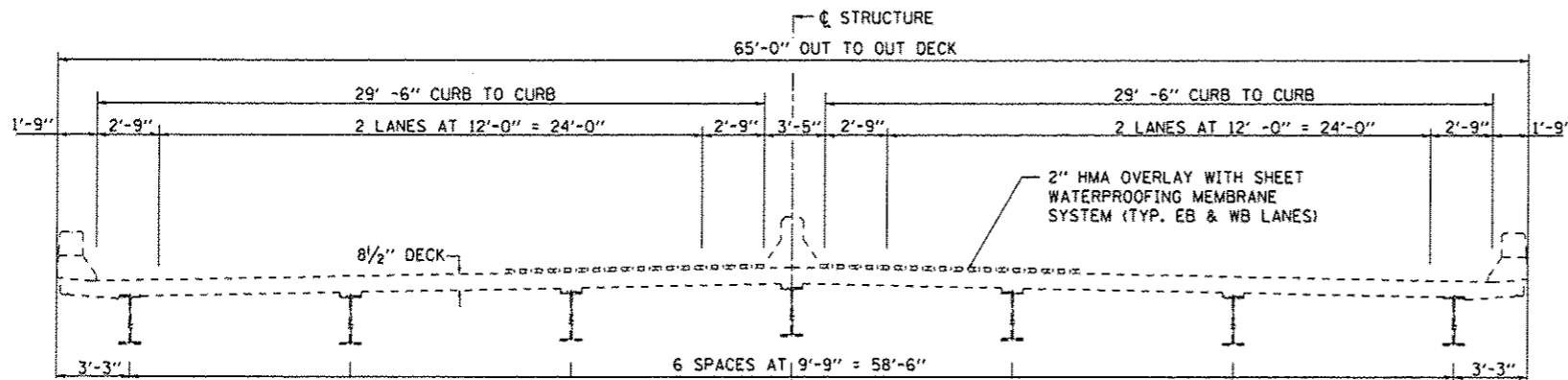

CROSS SECTION



CLEANING AND PAINTING EXISTING STRUCTURAL STEEL BEAM ENDS

TOTAL BILL OF MATERIAL

ITEM	UNIT	SUPER	SUB	TOTAL
CLEANING AND PAINTING STRUCTURAL STEEL, LOCATION 1	L. SUM	1		1
CONTAINMENT AND DISPOSAL OF LEAD PAINT CLEANING RESIDUES NO. 1	L. SUM	1		1

FOR INFORMATION ONLY

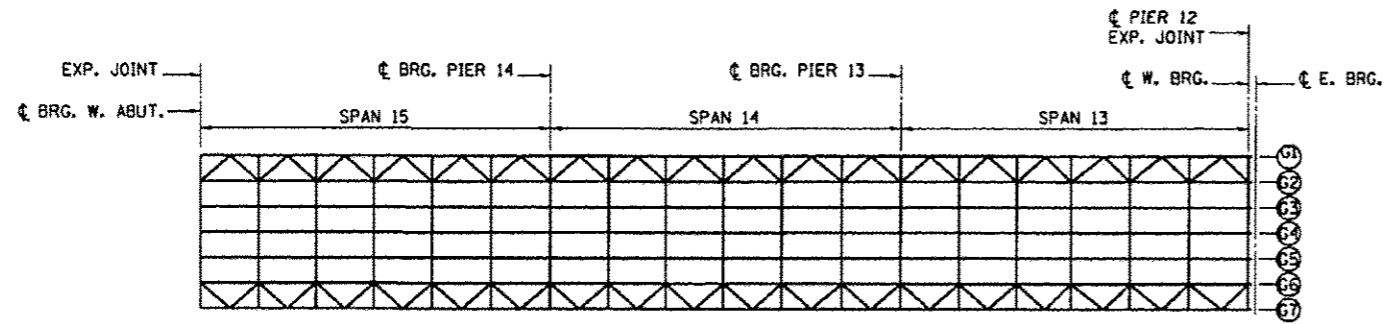

* CLEANING AND PAINTING STRUCTURAL STEEL LIMITS

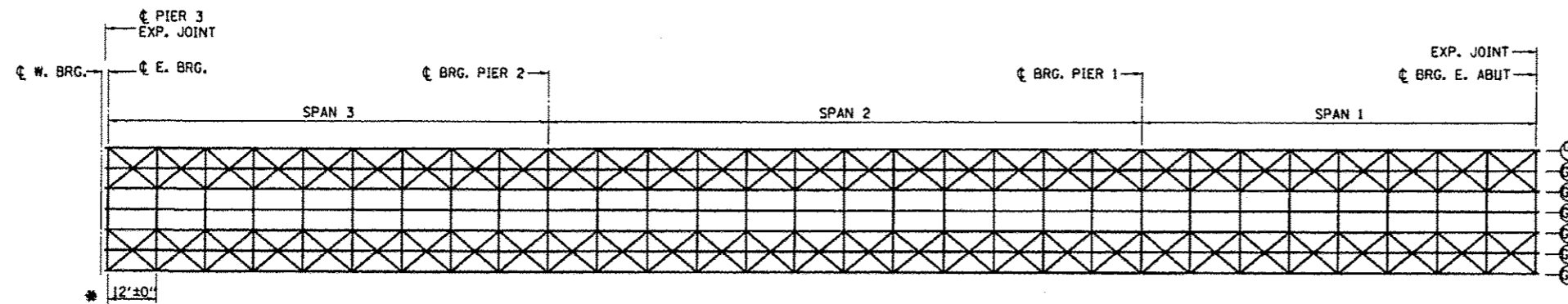
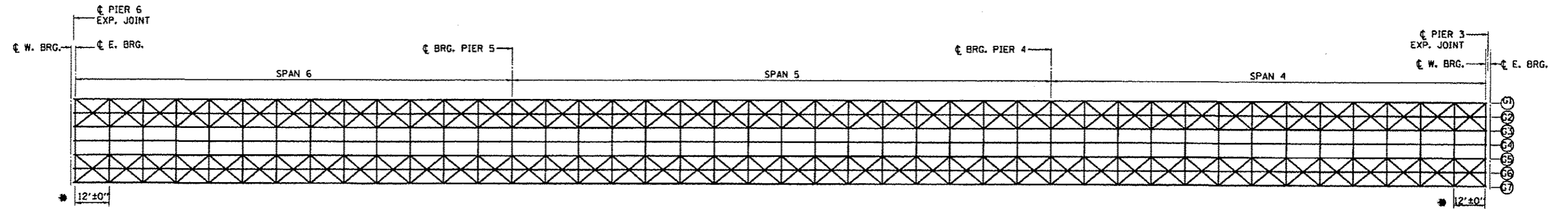
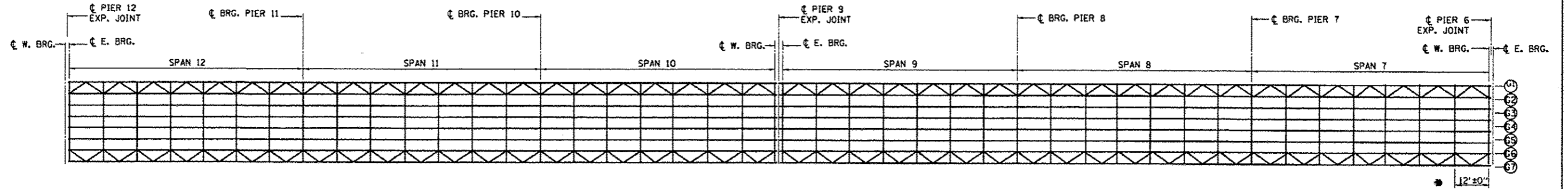

FOR INFORMATION ONLY

FILE NAME *	USER NAME * Patelyj	DESIGNED - YOGESH PATEL	REVISED -	STATE OF ILLINOIS DEPARTMENT OF TRANSPORTATION	FRAMING PLAN FOR STRUCTURE NO. 078-0001	P.A.J. RTE.	SECTION	COUNTY	TOTAL SHEETS	SHEET NO.	
orhp_wark\patej\patelyj\08358838\036627-shr-details.dgn	PLOT SCALE * 1/8"=1'-0"	DRAWN - YOGESH PATEL	REVISED -			180	06-3,78-11PM-1	BUREAU	9	7	
MODELNAME#	PLOT DATE * 12/9/2013	CHECKED - RON WOODSHANK	REVISED -			SCALE: SHEET 2 OF 4 SHEETS STA. TO STA.		CONTRACT NO. 66D27			
		DATE -	REVISED -			ILLINOIS FED. AID PROJECT					

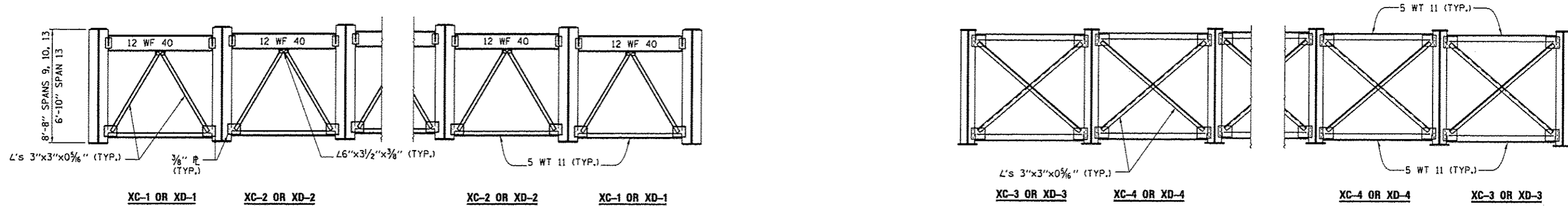

END CROSS FRAME
PIER 3 OR PIER 6

INTERMEDIATE CROSS FRAME
PIER 3 OR PIER 6

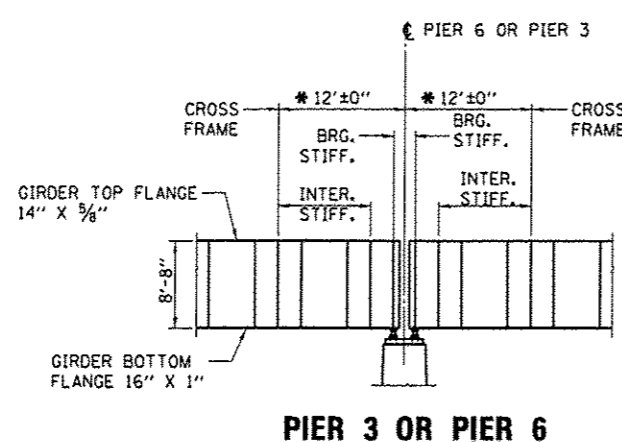

PIER 3 OR PIER 6

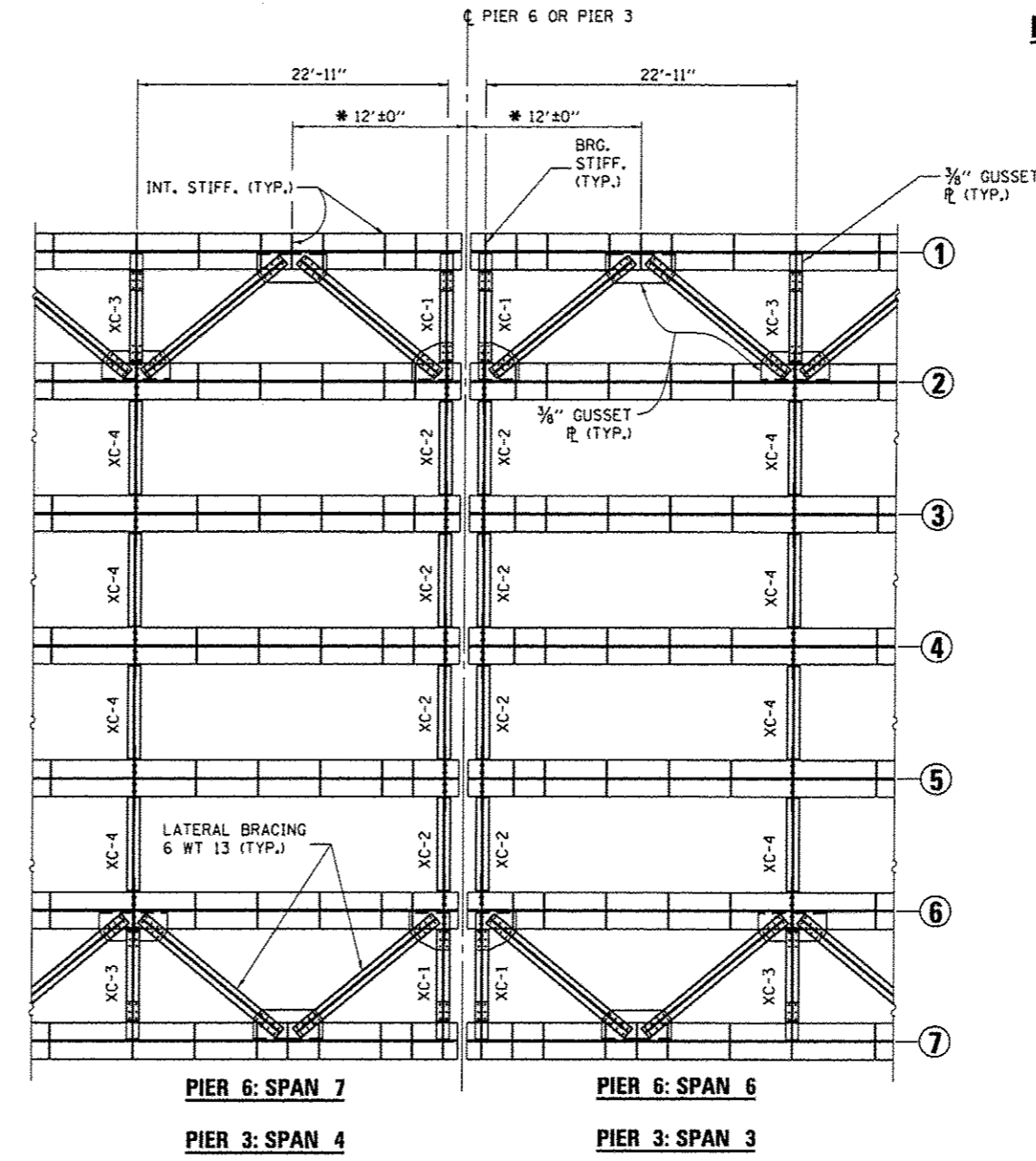

PIER 6: SPAN 7
PIER 3: SPAN 4
PIER 6: SPAN 6
PIER 3: SPAN 3

PLAN
AT PIER 3 OR PIER 6

* CLEANING AND PAINTING STRUCTURAL STEEL LIMITS

FOR INFORMATION ONLY

FILE NAME *	USER NAME * Patel, J	DESIGNED - YOGESH PATEL	REVISED -	STATE OF ILLINOIS DEPARTMENT OF TRANSPORTATION	FRAMING DETAILS FOR STRUCTURE NO. 078-0001	F.A.I. RTE.	SECTION	COUNTY	TOTAL SHEETS	SHEET NO.	
cr:\pwork\pwork\potel\j\036627-shl-details.dgn	PLOT SCALE * 1/8" = 1'-0"	DRAWN - YOGESH PATEL	REVISED -			180	(06-3,78-1)PM-1	BUREAU	9	8	
#MODELNAME#	PLOT DATE * 12/9/2013	CHECKED - RON WOODSHANK	REVISED -			SCALE:	SHEET 3 OF 4 SHEETS	STA.	TO STA.	CONTRACT NO. 66D27	
		DATE -	REVISED -							ILLINOIS FED. AID PROJECT	

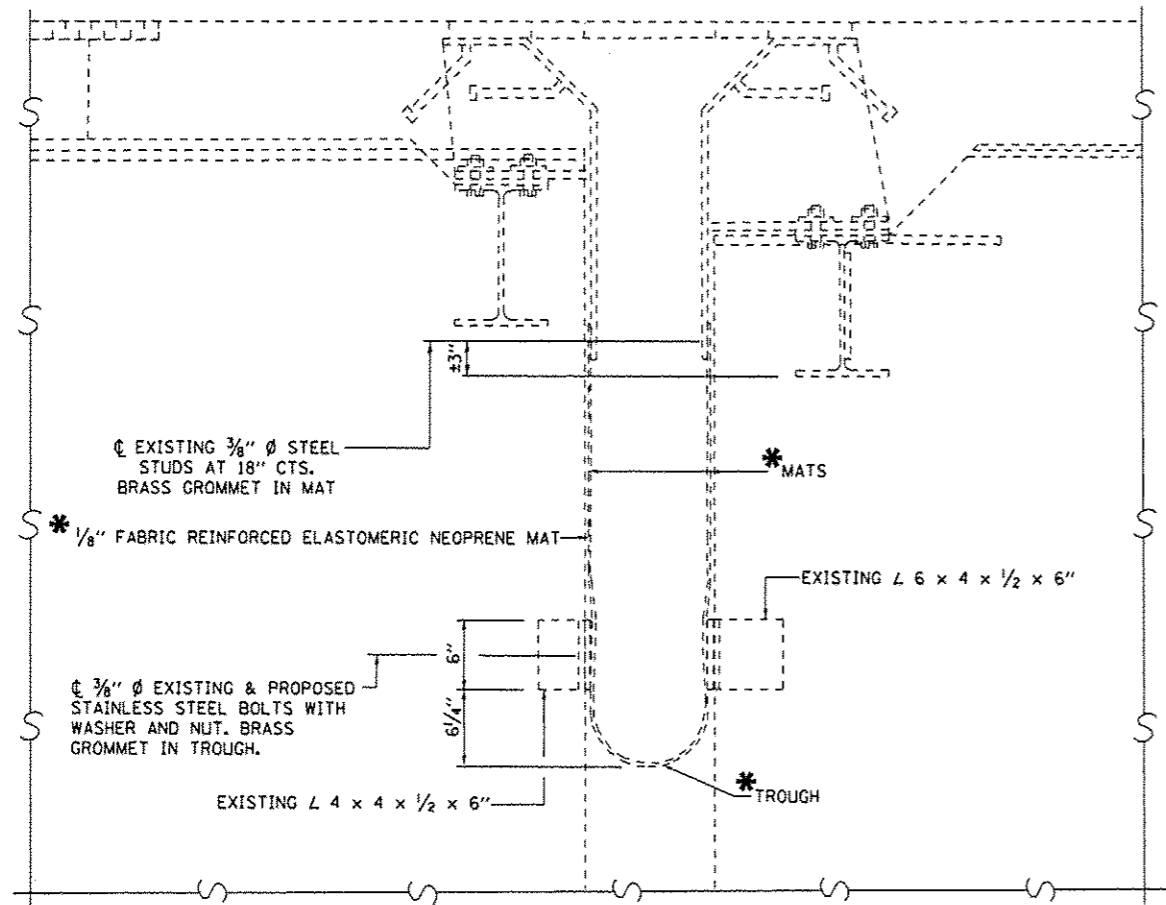

CROSS SECTION AT PIER 3 AND PIER 6

NOTES

* IF REQUIRED TO ACCESS THE EXISTING STRUCTURAL STEEL TO BE PAINTED, REMOVE AND REINSTALL THE EXISTING NEOPRENE TROUGHS, AND OR MATS.

PRIOR TO REINSTALLATION OF TROUGHS ALL DEBRIS AND REFUSE SHALL BE REMOVED FROM THE TROUGHS TO THE SATISFACTION OF THE ENGINEER.

EXISTING BOLTS, NUTS, WASHERS, AND RELATED ITEMS TO REINSTALL THE TROUGHS WHEN DEEMED SUITABLE BY THE ENGINEER SHALL BE REUSED. IF EXISTING BOLTS, NUTS, WASHERS, AND RELATED ITEMS ARE MISSING OR DAMAGED, THE CONTRACTOR SHALL FURNISH AND INSTALL THESE ITEMS TO REINSTALL THE TROUGHS TO THE SATISFACTION OF THE ENGINEER.

COST OF THE ABOVE MENTIONED WORK SHALL BE INCLUDED IN THE CLEANING AND PAINTING STRUCTURAL STEEL.

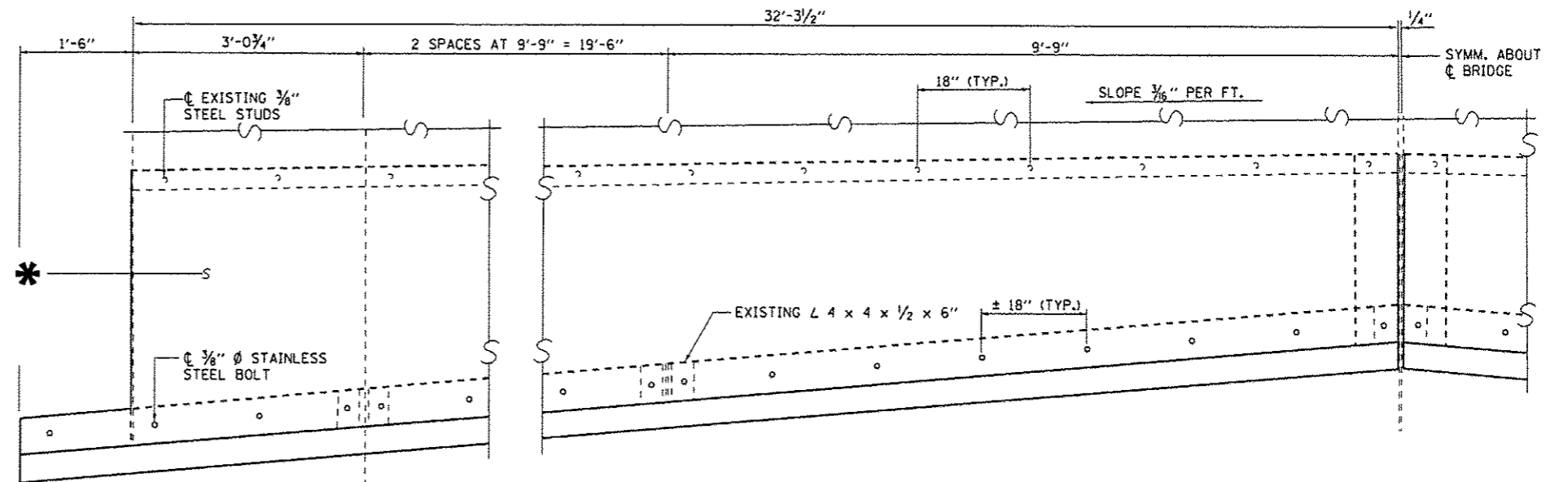

HALF ELEVATION

FOR INFORMATION ONLY

FILE NAME *	USER NAME * Patelyj	DESIGNED - YOGESH PATEL	REVISED -	STATE OF ILLINOIS DEPARTMENT OF TRANSPORTATION	EXPANSION JOINT DETAILS AT PIER 3 AND PIER 6 FOR STRUCTURE NO. 078-0001	F.A.I. RTE.	SECTION	COUNTY	TOTAL SHEETS	SHEET NO.	
c:\pwork\pwork\patelyj\08358939\036627-sht-details.dgn	PLT SCALE = 100,0000 ' / in.	DRAWN - YOGESH PATEL	REVISED -			180	(06-3,78-1)PM-1	BUREAU	9	9	
MODELNAME#	PLT DATE = 12/9/2813	CHECKED - RON WOOSHANK	REVISED -			SCALE: SHEET 4 OF 4 SHEETS STA. TO STA.		CONTRACT NO. 66027			
		DATE -	REVISED -			ILLINOIS FED. AID PROJECT					