

SEC. 9, T. 19 N, R. 10 E.

28-22-09-300-001  
SHEPARD, NANCY ANNE  
AS SUCCESSOR TRUSTEE  
5730019

PROPOSED R.O.W.

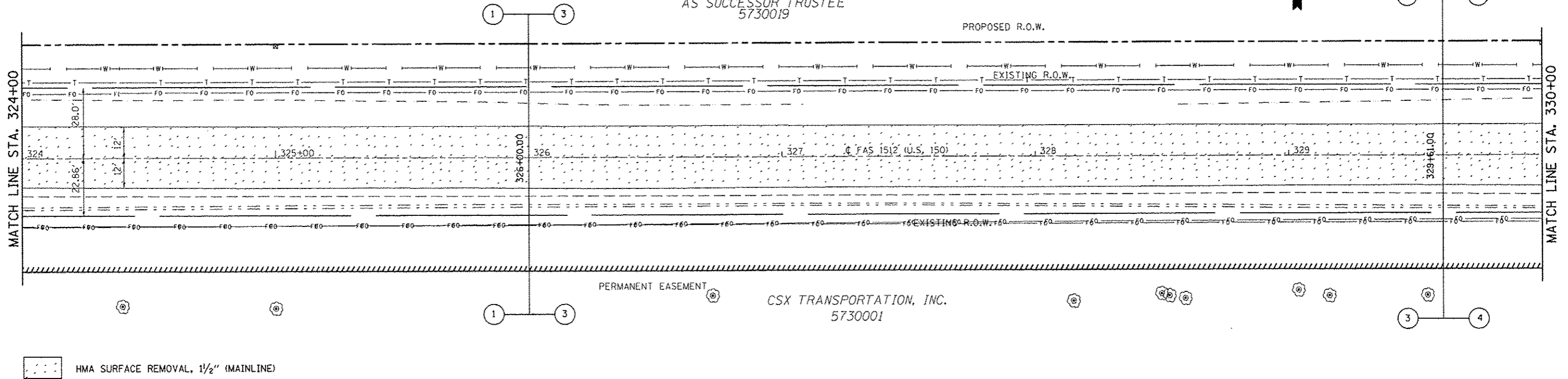

SEC. 16, T. 19 N, R. 10 E.

SEC. 9, T. 19 N, R. 10 E.

28-22-09-300-001  
RUSSELL, RAY JR.  
AS TRUSTEE  
5730019

28-22-09-400-05  
BARCUSS, ROBERT CHARLES  
AS TRUSTEE  
5730020

PROPOSED R.O.W.

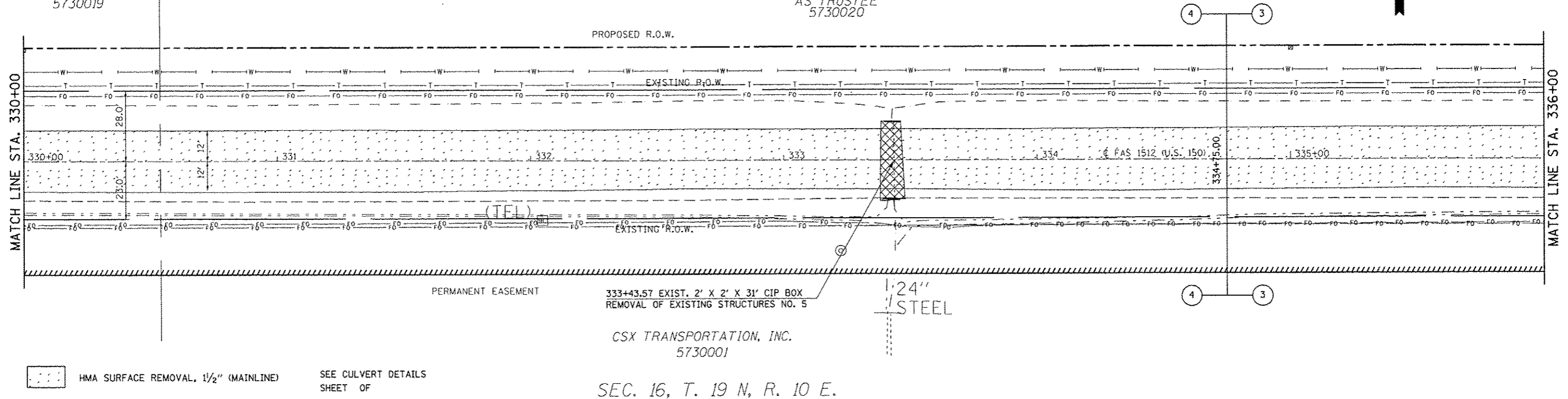

SEC. 16, T. 19 N, R. 10 E.

|   |                            |                   |           |   |  |                           |                                  |                           |           |        |                    |              |
|---|----------------------------|-------------------|-----------|---|--|---------------------------|----------------------------------|---------------------------|-----------|--------|--------------------|--------------|
| FILE NAME :<br>c:\pwwork\pwwork\2013\20130116\0570663-shr-removal.dgn | USER NAME :<br>cconlock_jd | DESIGNED -<br>JMS | REVISED - | <b>STATE OF ILLINOIS<br/>DEPARTMENT OF TRANSPORTATION</b> | <b>REMOVAL DETAILS<br/>US 150 MAINLINE</b> |                           |                                  | F.A.U.<br>RTE.            | SECTION   | COUNTY | TOTAL<br>SHEETS    | SHEET<br>NO. |
| PLOT SCALE : 48.0000 / 1" = 48'                                       | CHECKED -                  | DATE - 051011     | REVISED - |   | SCALE: 1:20                                | SHEET NO. 20 OF 27 SHEETS | STA. 324+00.00 TO STA. 336+00.00 | (2X,3RS-3 & 2RS-4)        | CHAMPAIGN | 551    | 62                 |              |
| PLOT DATE : 10/16/2013  | DATE - 051011              | REVISED -         | REVISED - |   |  |                           |                                  | FAU 7152 & FAS 1512       |           |        | CONTRACT NO. 70663 |              |
|   |                            |                   |           |   |  |                           |                                  | ILLINOIS FED. AID PROJECT |           |        |                    |              |