

SEC. 12, T. 19 N, R. 9 E.

30-21-12-300-004
SMITH, FRED J.
SMITH, PATRICIA D.
5730005

30-21-12-300-005
SMITH, DAVID T.
5730006



DATE	
BY	
REVISIONS	
NO.	
DESCRIPTION	
DATE	
BY	
REVISIONS	
NO.	
DESCRIPTION	
DATE	
BY	
REVISIONS	
NO.	
DESCRIPTION	

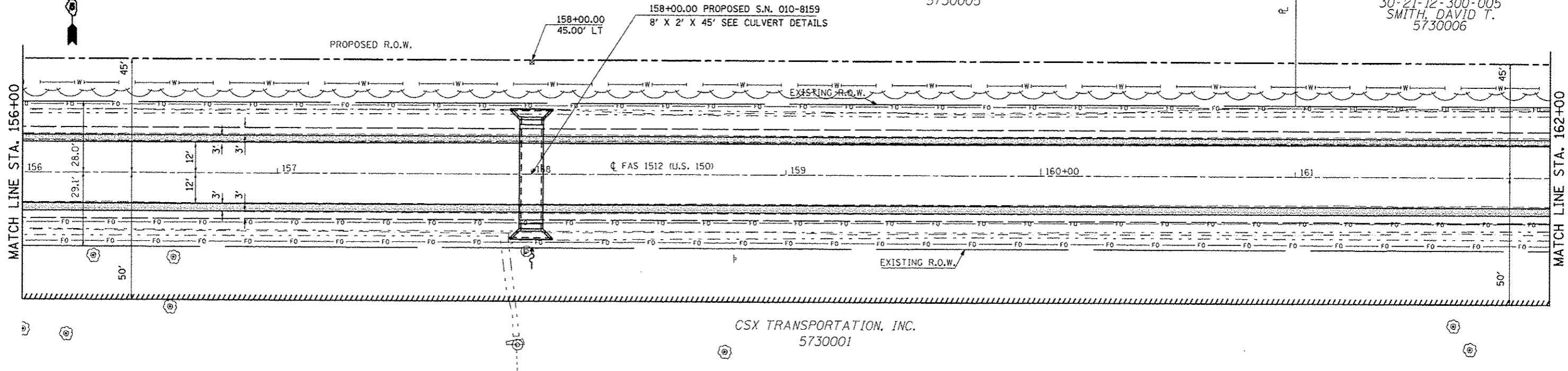

CSX TRANSPORTATION, INC.
5730001

HMA SHOULDERS, 6" AGG SHOULDERS-TYPE B, 6"

SEC. 13, T. 19 N, R. 9 E.

DATE	
BY	
REVISIONS	
NO.	
DESCRIPTION	
DATE	
BY	
REVISIONS	
NO.	
DESCRIPTION	

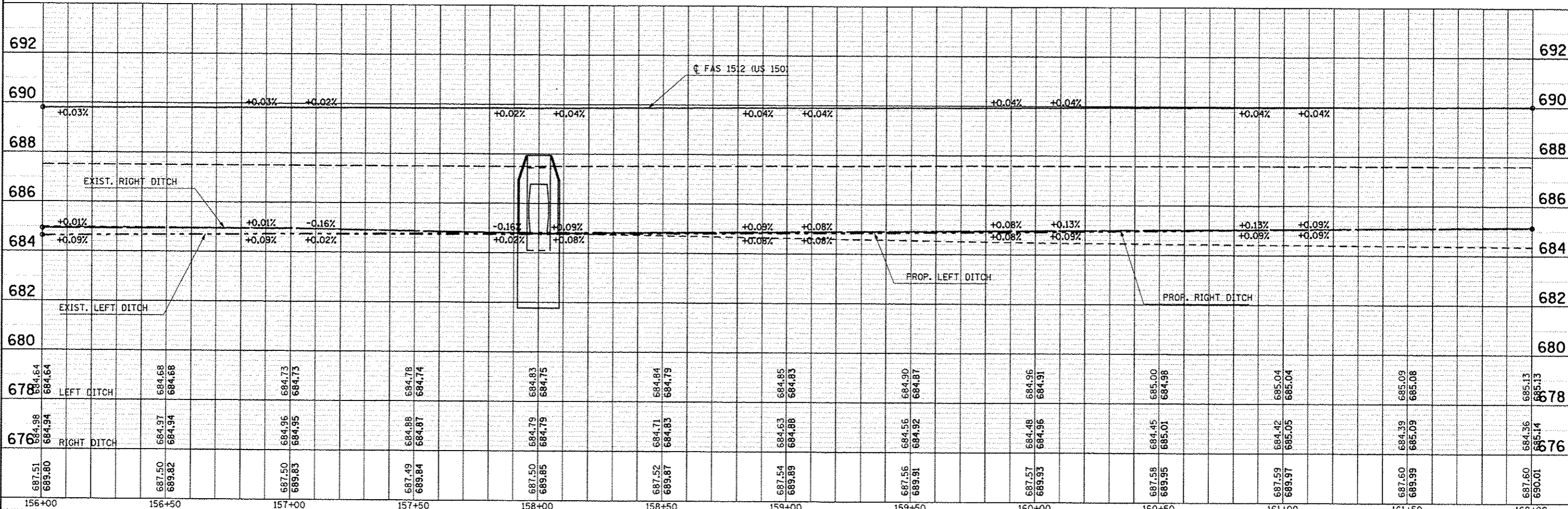

FILE NAME	USER NAME = carlock_jd	DESIGNED JMS	REVISED -	<p align="center">STATE OF ILLINOIS DEPARTMENT OF TRANSPORTATION</p> <p align="center">US 150 MAINLINE PLAN AND PROFILE SHEET</p>	F.A.U. RTE.	SECTION	COUNTY	TOTAL SHEETS	SHEET NO.			
663-ah1-plnpr.f.dgn		DRAWN JMS	REVISED -		2X,3RS-3 & 2RS-4	Champaign	551	92				
PLDT SCALE = 48.0000' / 1" =		CHECKED -	REVISED -		F.A.U. 7152 & F.A.S. 1512		CONTRACT NO. 70663					
PLDT DATE = 10/10/2013		DATE 081610	REVISED -		ILLINOIS FED. AID PROJECT							
156+00	156+50	157+00	157+50	158+00	158+50	159+00	159+50	160+00	160+50	161+00	161+50	162+00

SCALE: 1" = 20' SHEET NO. 11 OF 54 SHEETS STA. 156+00.00 TO STA. 162+00.00