

SEC. 7, T. 19 N, R. 10 E.

PLAN	DATE
BY	
DATE	
NO.	
DATE	
BY	
DATE	
NO.	
DATE	
BY	
DATE	
NO.	

PROFILE	DATE
BY	
DATE	
NO.	
DATE	
BY	
DATE	
NO.	
DATE	
BY	
DATE	
NO.	

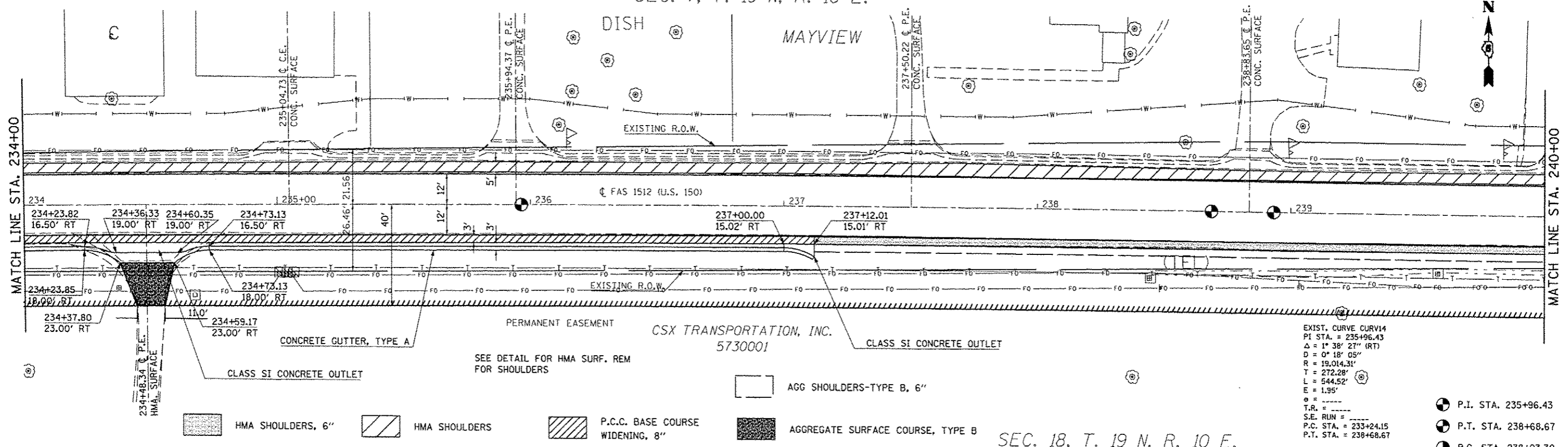

EXIST. CURVE CURV14
 PI STA. = 235+96.43
 Δ = 1° 38' 27" (RT)
 D = 0° 18' 05"
 R = 19,014.31'
 T = 272.28'
 L = 544.52'
 E = 1.95'
 P.I. STA. 235+96.43
 P.T. STA. 238+68.67
 P.C. STA. 238+93.30

SEC. 18, T. 19 N, R. 10 E.

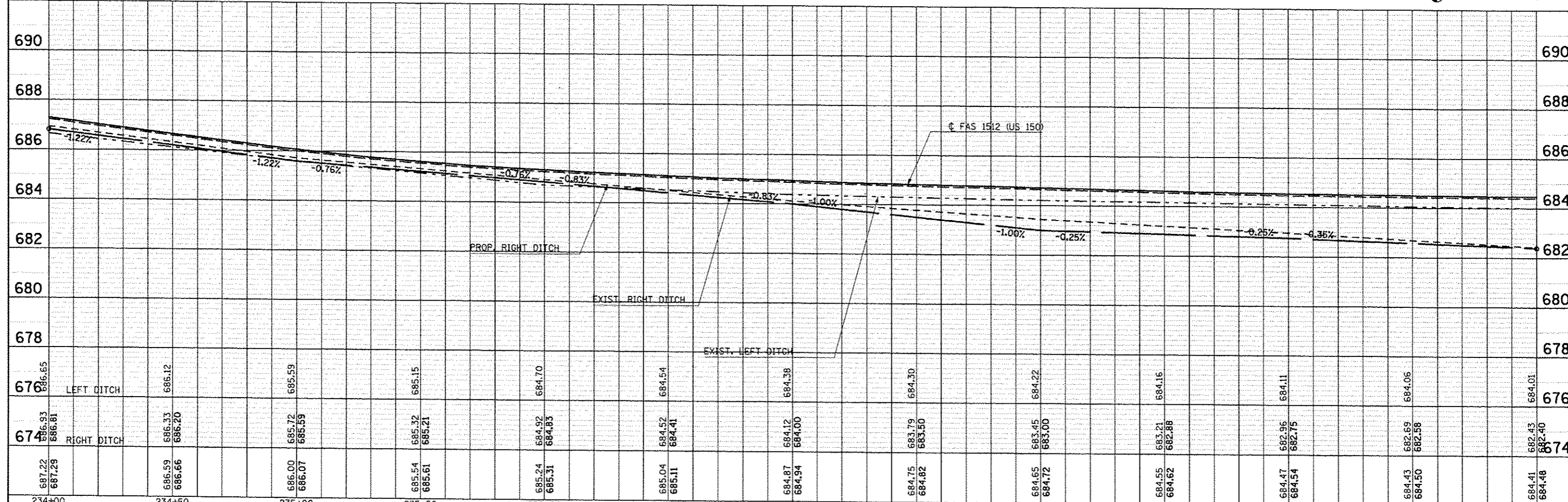

FILE NAME: c:\work\paidot\conrlook\j\0120316\05763-ahp-plnpr-f.dgn	USER NAME: conrlook_jd	DESIGNED: JMS	REVISED: -	<p align="center">STATE OF ILLINOIS DEPARTMENT OF TRANSPORTATION</p> <p align="center">US 150 MAINLINE PLAN AND PROFILE SHEET</p> <p>SCALE: 1" = 20' SHEET NO. 24 OF 54 SHEETS STA. 234+00.00 TO STA. 240+00.00</p>	<table border="1"> <tr><th>F.A.U. RTE.</th><th>SECTION</th><th>COUNTY</th><th>TOTAL SHEETS</th><th>SHEET NO.</th></tr> <tr><td>• F.A.U. 7152 & F.A.S. 1512</td><td>(2X,3)RS-3 & 2RS-4</td><td>Champaign</td><td>551</td><td>105</td></tr> <tr><td colspan="3"></td><td>CONTRACT NO. 70663</td><td></td></tr> <tr><td colspan="5">ILLINOIS FED. AID PROJECT</td></tr> </table>	F.A.U. RTE.	SECTION	COUNTY	TOTAL SHEETS	SHEET NO.	• F.A.U. 7152 & F.A.S. 1512	(2X,3)RS-3 & 2RS-4	Champaign	551	105				CONTRACT NO. 70663		ILLINOIS FED. AID PROJECT				
F.A.U. RTE.	SECTION	COUNTY	TOTAL SHEETS			SHEET NO.																			
• F.A.U. 7152 & F.A.S. 1512	(2X,3)RS-3 & 2RS-4	Champaign	551			105																			
			CONTRACT NO. 70663																						
ILLINOIS FED. AID PROJECT																									
PLOT SCALE: 1/8" = 20'	CHECKED: -	REVISOR: -	REVISOR: -																						
PLOT DATE: 10/10/2013	DATE: 081610	REVISOR: -	REVISOR: -																						