

SEC. 22, T21N, R-5E, 3RD PM

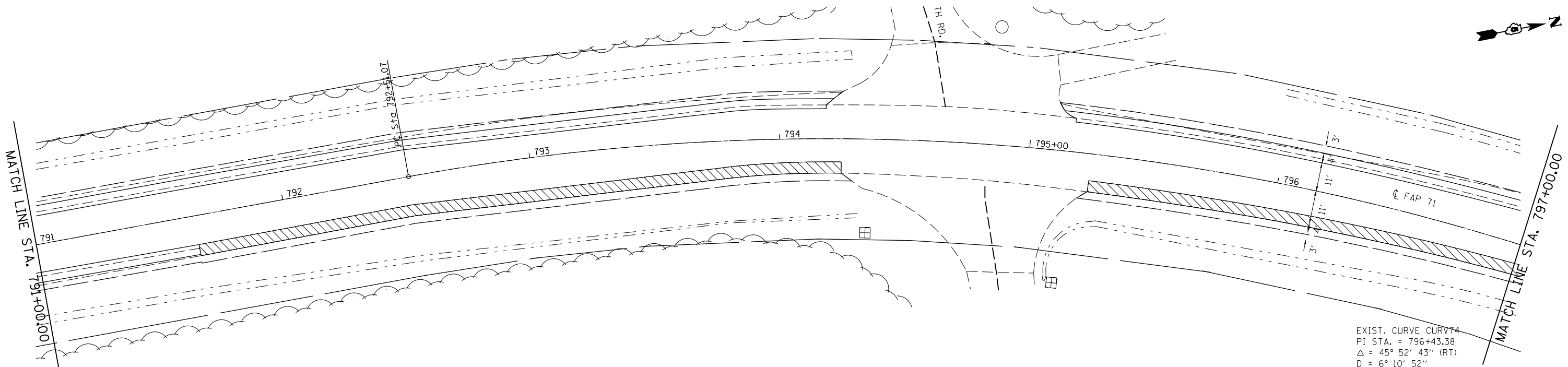

EXIST. CURVE CURV74
 PI STA. = 796+43.38
 Δ = 45° 52' 43" (RT)
 D = 6° 10' 52"
 R = 926.95'
 T = 392.31'
 L = 742.24'
 E = 79.60'
 e = ----
 T.R. = ----
 S.E. RUN = ----
 P.C. STA. = 792+51.07
 P.T. STA. = 799+93.31

 HOT-MIX ASPHALT SURFACE
 REMOVAL, 2"

SEC. 15, T21N, R-5E, 3RD PM

• DEWITT / MCLEAN

FILE NAME = e:\pw\work\p\dot\castrub\d0313174\057084-sh1-DblPIIn.1.dgn	USER NAME = castrub	DESIGNED -	REVISED -
	PLOT SCALE = 40.0000' / in.	DRAWN -	REVISED -
#MODELNAME#	PLOT DATE = 1/3/2014	CHECKED -	REVISED -
		DATE -	REVISED -

**STATE OF ILLINOIS
 DEPARTMENT OF TRANSPORTATION**

PLAN SHEET

SCALE: SHEET OF SHEETS STA. 785+00.00 TO STA. 797+00.00

F.A.P. RTE.	SECTION	COUNTY	TOTAL SHEETS	SHEET NO.
71	(122,121)I	•	199	21
CONTRACT NO. 70984			ILLINOIS FED. AID PROJECT	