

DATE	
BY	
FINAL SURVEY	
PLOTTED	
NOTE BOOK	
AREAS CHECKED	

DATE	
BY	
ORIGINAL SURVEY	
PLOTTED	
NOTE BOOK	
AREAS CHECKED	

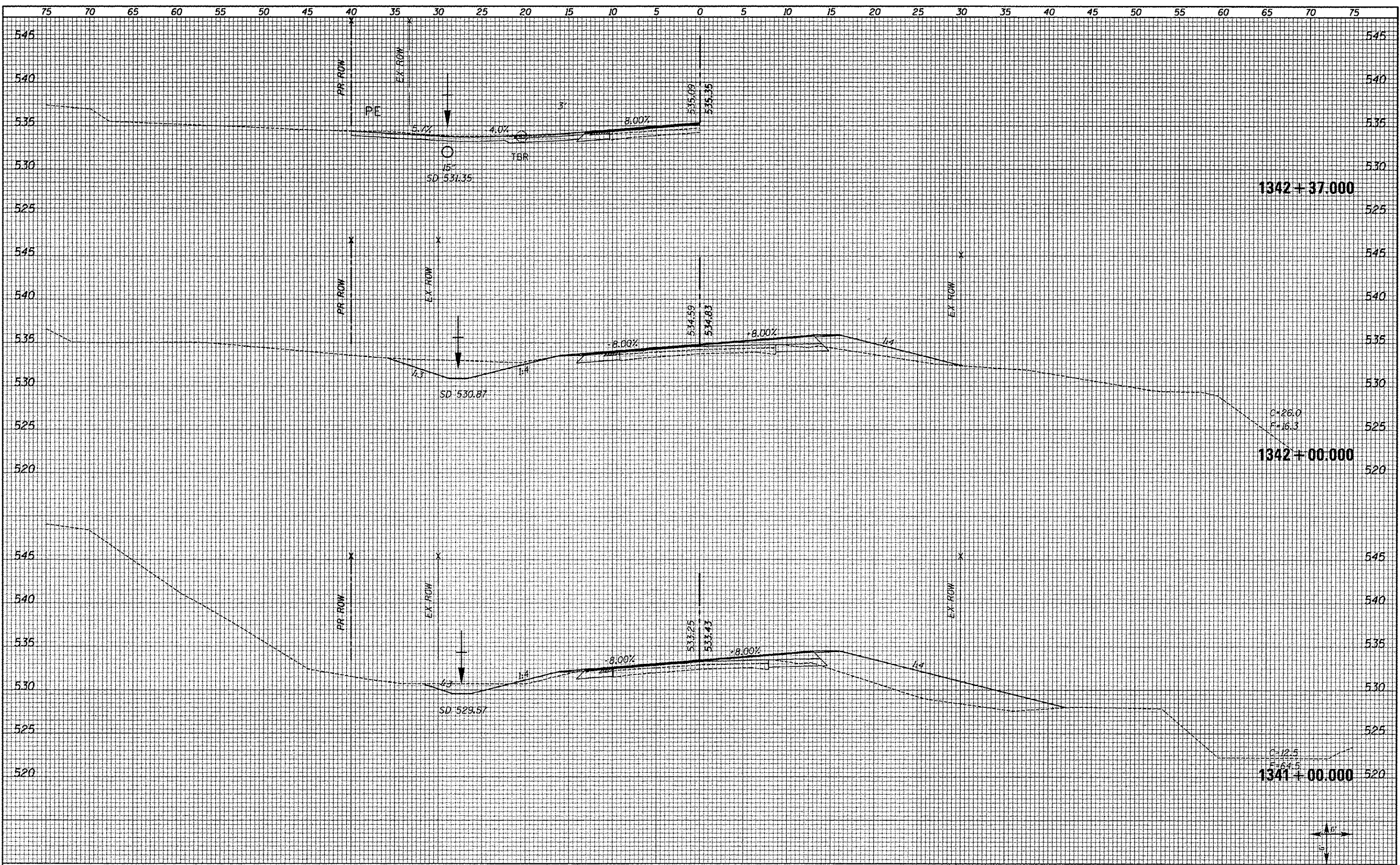

FILE NAME = XS_SHEETS-NEW.dgn	USER NAME = notel	DESIGNED -	REVISED -	STATE OF ILLINOIS DEPARTMENT OF TRANSPORTATION	FAS 1597 (IL 96) CROSS SECTIONS		F.A.S. RTE. 1597	SECTION 14 (W, RS-7)	COUNTY ADAMS/PIKE	TOTAL SHEETS 152	SHEET NO. 95	
	PLT SCALE = 10,0000' / 1"	DRAWN -	REVISED -		SCALE: SHOWN	SHEET NO. 20 OF 72 SHEETS	STA. 1341+00.000	STA. 1342+37.000	CONTRACT NO. 72781			
	PLT DATE = 8/15/2013	CHECKED -	REVISED -		ILLINOIS FED. AID PROJECT							
		DATE -	REVISED -									