

NOTE: FOR CONCRETE CURB SECTIONS ONLY,  
PLACE EDGE LINE 9" OFF OF CURB FACE

| LEGEND |  |
|--------|--|
| ①      | PREFORMED PLASTIC PAVEMENT MARKING, TYPE B - INLAID - LETTER AND SYMBOLS (SKIP-DASH WHITE) |
| ②      | PREFORMED PLASTIC PAVEMENT MARKING, TYPE B - INLAID - LINE 5" (SOLID WHITE)                |
| ③      | PREFORMED PLASTIC PAVEMENT MARKING, TYPE B - INLAID - LINE 6" (SOLID WHITE)                |
| ④      | PREFORMED PLASTIC PAVEMENT MARKING, TYPE B - INLAID - LINE 6" (MINI SKIP-DASH WHITE)       |
| ⑤      | PREFORMED PLASTIC PAVEMENT MARKING, TYPE B - INLAID - LINE 24" (SOLID WHITE)               |
| ⑥      | MODIFIED URETHANE PAVEMENT MARKING - LINE 5" (SOLID YELLOW)                                |
| ⑦      | MODIFIED URETHANE PAVEMENT MARKING - LINE 5" (SOLID WHITE)                                 |
| ⑧      | MODIFIED URETHANE PAVEMENT MARKING - LINE 5" (DOUBLE SOLID YELLOW)                         |
| ⑨      | MODIFIED URETHANE PAVEMENT MARKING - LINE 8" (SOLID WHITE)                                 |
| ⑩      | MODIFIED URETHANE PAVEMENT MARKING - LINE 12" (SOLID YELLOW)                               |
| ⑪      | MODIFIED URETHANE PAVEMENT MARKING - LINE 12" (SOLID WHITE)                                |

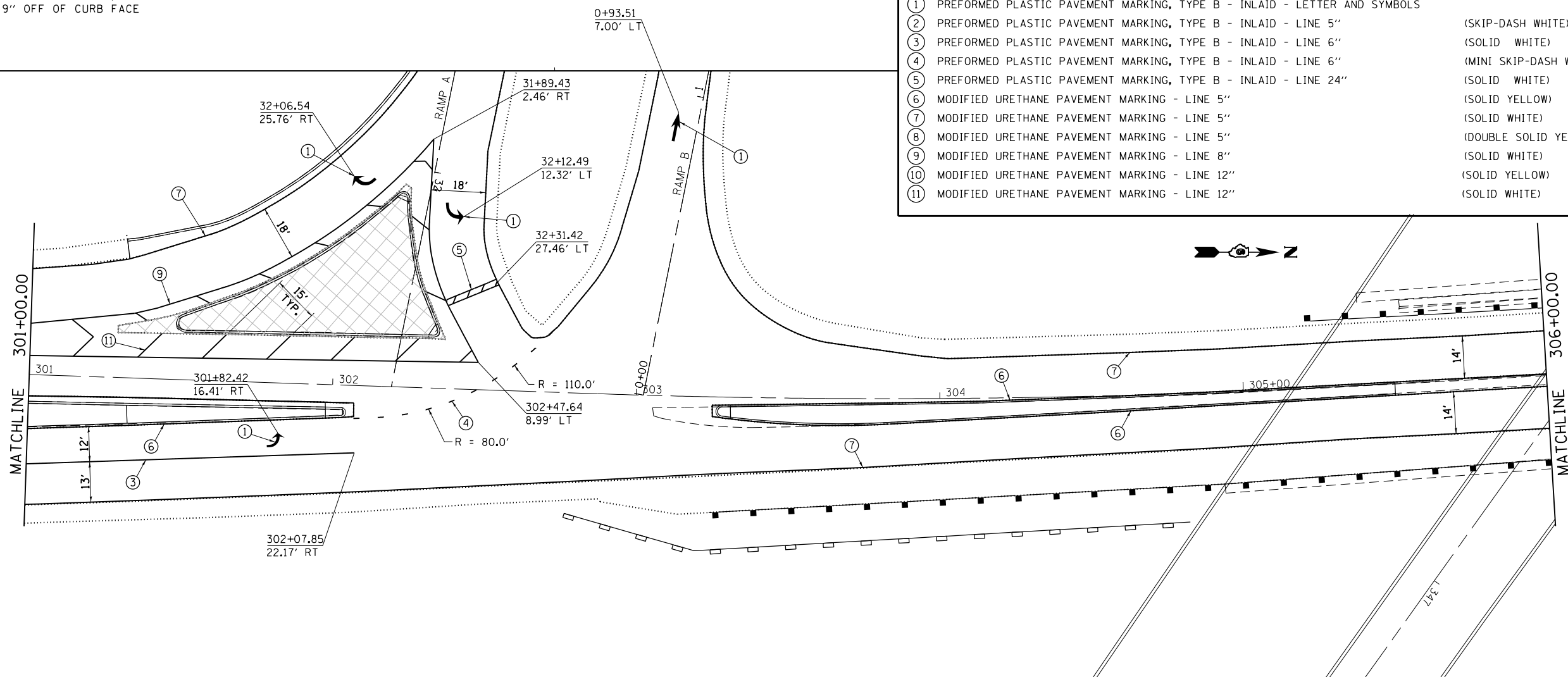

|  |                                    |            |           |
|--|------------------------------------|------------|-----------|
| FILE NAME =  | USER NAME = sparksgw               | DESIGNED - | REVISED - |
| ct:\pw\work\p\idot\sparksgw\10306018\067250-Sht-PMK-20.dgn |                                    | DRAWN -    | REVISED - |
|  |                                    | CHECKED -  | REVISED - |
|  |                                    | DATE -     | REVISED - |
| Default  | PLOT DATE = Dec-06-2013 09:54:18AM |            |           |

STATE OF ILLINOIS  
DEPARTMENT OF TRANSPORTATION

BUSINESS LOOP 55  
PAVEMENT MARKING SHEETS

SCALE: SHEET OF SHEETS STA. TO STA.

|                    |          |          |                           |           |
|--------------------|----------|----------|---------------------------|-----------|
| F.A.P. RTE.        | SECTION  | COUNTY   | TOTAL SHEETS              | SHEET NO. |
| 666                | (26)RS,I | SANGAMON | 116                       | 41        |
| CONTRACT NO. 72F50 |          |          | ILLINOIS FED. AID PROJECT |           |