

NORTH ABUTMENT

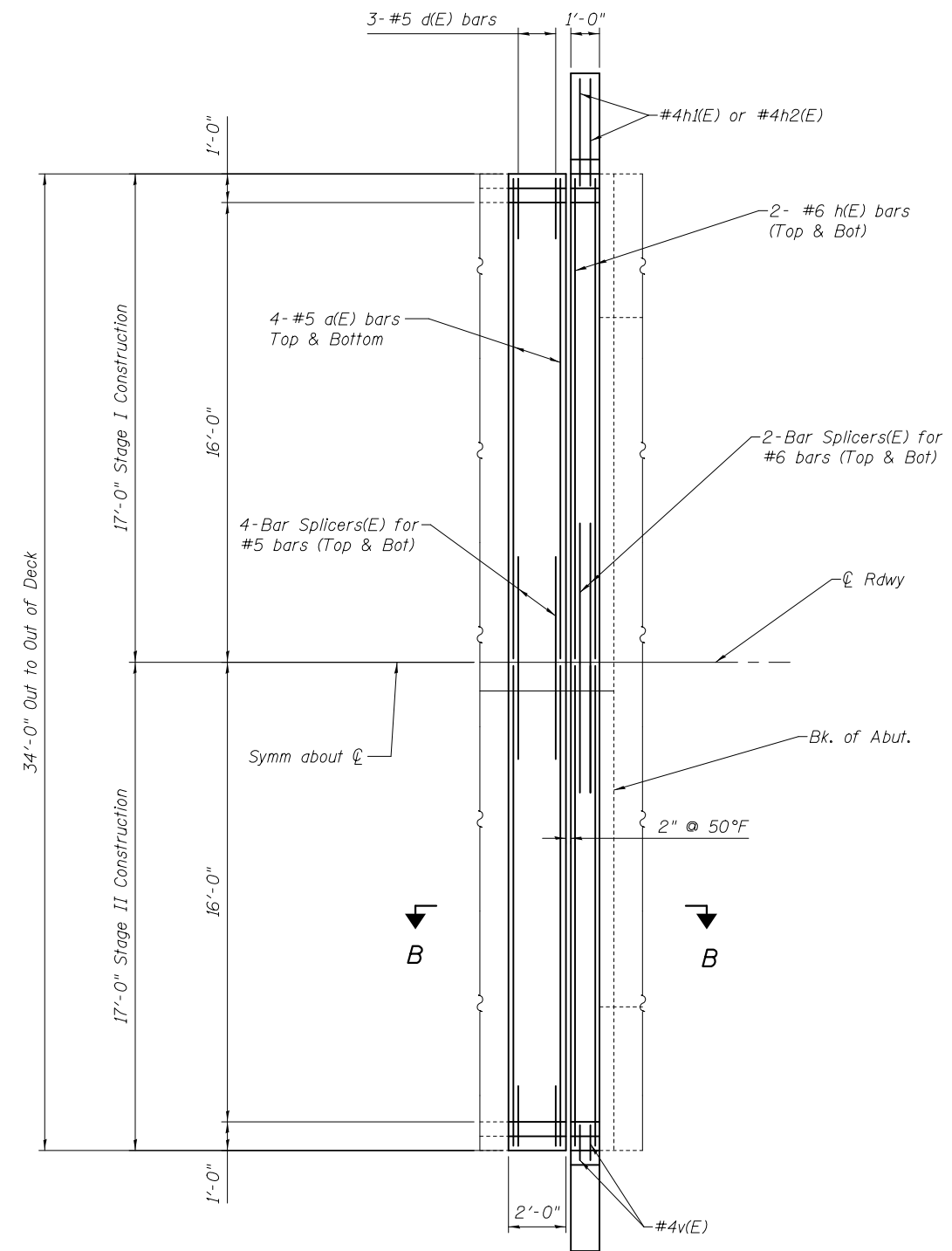

SOUTH ABUTMENT

CONCRETE REPLACEMENT

Note:

Existing reinforcement bars extending into removal area shall be cleaned, straightened and incorporated into the new construction. Any reinforcement bars that are damaged during concrete removal shall be replaced with an approved bar splicer or anchorage system. Cost included with Concrete Removal.

See sheet 5 of 12 for Section B-B & Reinforcement bars

See sheet 6 of 12 for Hatchblock & Wingwall details

DESIGNED - AYV	EXAMINED _____	DATE - _____
CHECKED - _____	ENGINEER OF STRUCTURAL SERVICES	
DRAWN - AYV	PASSED _____	REVISED _____
CHECKED - _____	ENGINEER OF BRIDGES AND STRUCTURES	REVISED _____

**STATE OF ILLINOIS
DEPARTMENT OF TRANSPORTATION**

**JOINT REPLACEMENT
SN 042-0012**

SHEET NO. 4 OF 12 SHEETS

F.A.P. RTE.	SECTION	COUNTY	TOTAL SHEETS	SHEET NO.
304	4-BY, 4B-1	JERSEY	26	18
CONTRACT NO. 76G49				

ILLINOIS FED. AID PROJECT