

SN 076-7094
 PROPOSED PRECAST SINGLE
 7' X 5' BOX CULVERT
 110' END TO END BARREL ALONG SKEW
 32' CLEAR WIDTH, 45° SKEW
 CL IL 34 STA. 755+46

SN 076-7021
 EXISTING 7' X 5' BOX CULVERT
 79'-7 1/2" END TO END BARREL ALONG SKEW
 45° SKEW, CL IL 34 STA. 755+46

DATE	
BY	
PLAN	
SURVEYED	
PLOTTED	
ALIGNED	
CHECKED	
FILE NAME	
NO.	

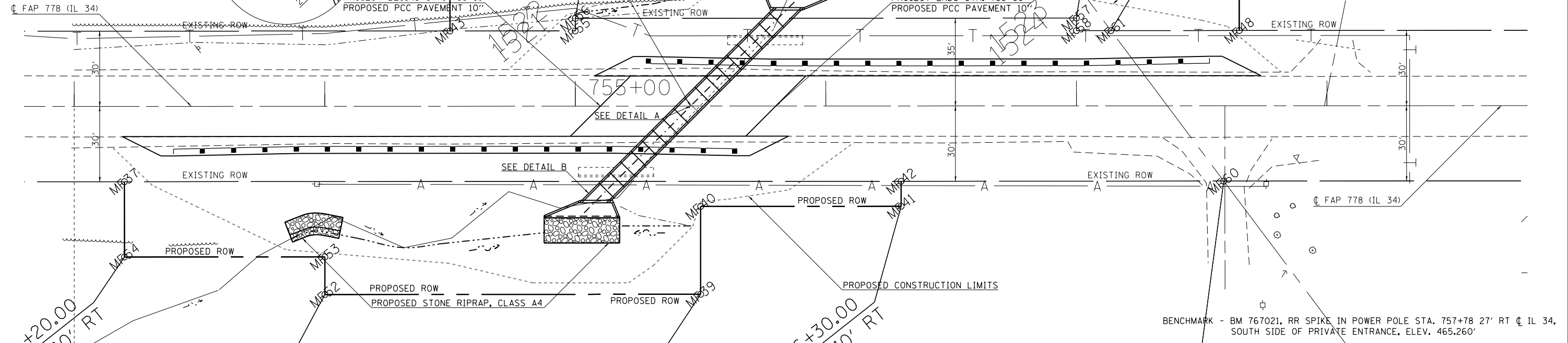

DATE	
BY	
PROFILE	
SURVEYED	
PLOTTED	
GRADES	
CHECKED	
STRUCTURE	
NOTATIONS	
CPAD	
NO.	

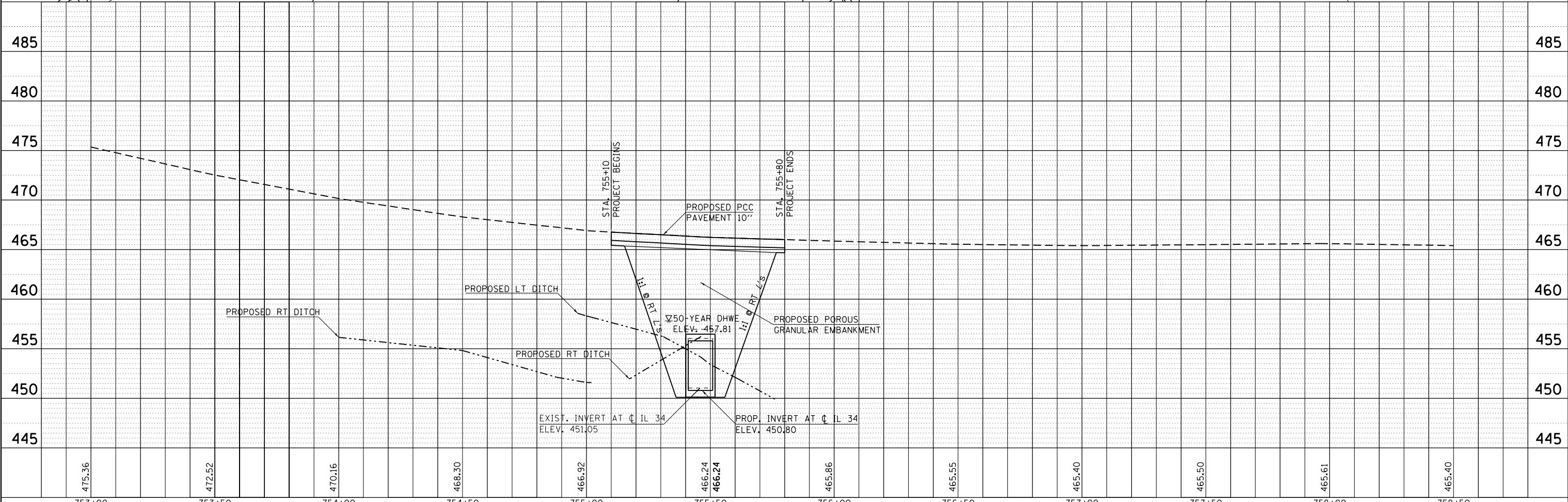

FILE NAME =	USER NAME =	DESIGNED -	REVISD -	STATE OF ILLINOIS DEPARTMENT OF TRANSPORTATION	PLAN & PROFILE SCALE: SHEET OF SHEETS STA. TO STA.	F.A.P. RTE.	SECTION	COUNTY	TOTAL SHEETS	SHEET NO.
c:\pwork\pwork\helstead\helstead\0325547\783	5-shtc-plnpr.f.dgn	DRAWN -	REVISD -			778	3B-3	POPE	25	7
Default	PLOT SCALE = 40.0000' / in.	CHECKED -	REVISD -			CONTRACT NO. 78315				
	PLOT DATE = 12/5/2013	DATE -	REVISD -			ILLINOIS FED. AID PROJECT				