

STATE OF ILLINOIS
DEPARTMENT OF TRANSPORTATION

F.A.S. RTE.	SECTION	COUNTY	TOTAL SHEETS	SHEET NO.
642	D7 HMA RESURF 2017-4	ILLINOIS	13	1
CONTRACT NO. 74776				

• MOULTRIE & COLES

FOR INDEX OF SHEETS, SEE SHEET NO. 2

AADT = 1,550 (2015)

PROPOSED HIGHWAY PLANS

FAS ROUTE 642 BRUCE / FINDLAY RD
SECTION D7 HMA RESURF 2017-4

RESURFACING (3P)
MOULTRIE, COLES COUNTY

C-97-071-16

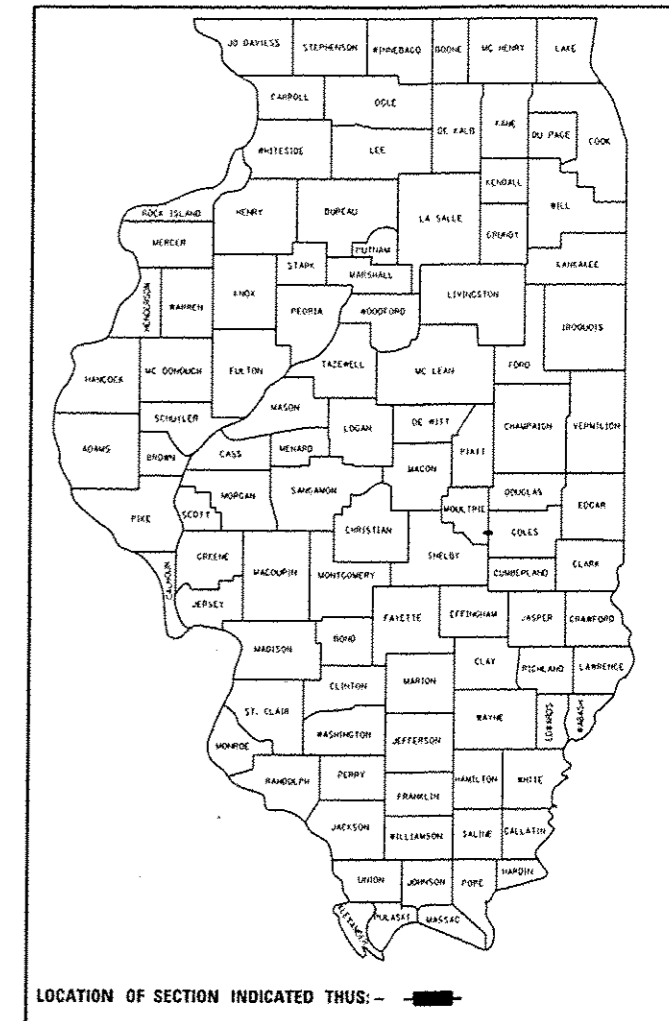

START STATION 273+40

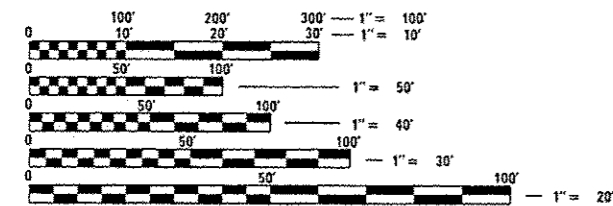

FULL SIZE PLANS HAVE BEEN PREPARED USING STANDARD ENGINEERING SCALES. REDUCED SIZED PLANS WILL NOT CONFORM TO STANDARD SCALES. IN MAKING MEASUREMENTS ON REDUCED PLANS, THE ABOVE SCALES MAY BE USED.

J.U.L.I.E.
JOINT UTILITY LOCATION INFORMATION FOR EXCAVATION
1-800-892-0123
OR 811

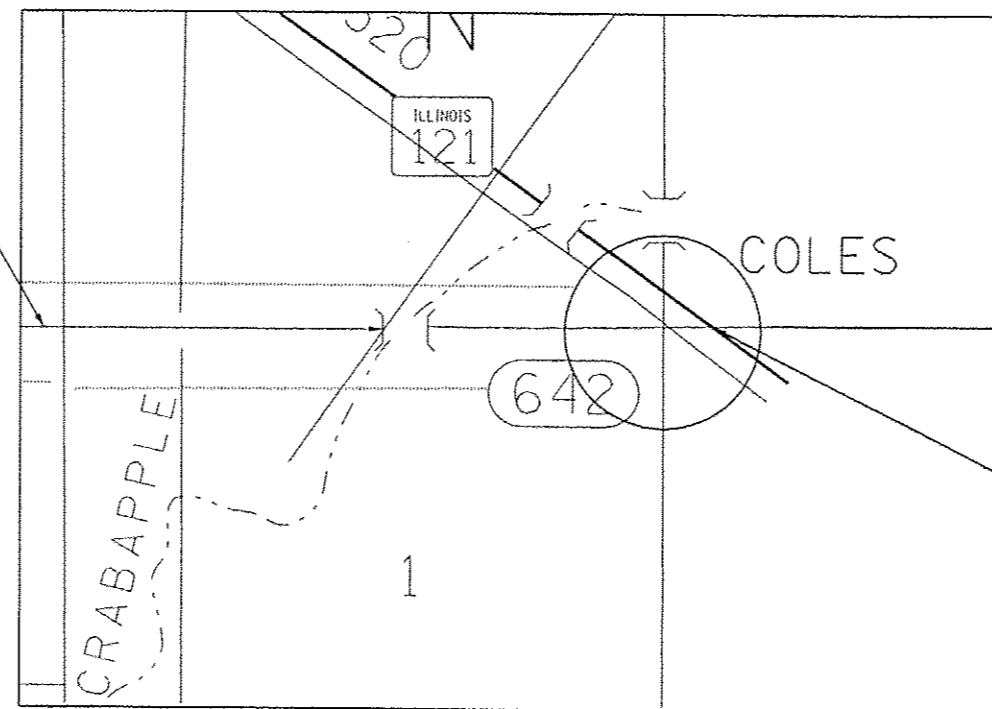

END STATION 352+60

GROSS LENGTH = 7,920 FT. = 1.5 MILE
NET LENGTH = 7,700 FT. = 1.46 MILE

PROJECT ENGINEER MARK DAUGHERTY
PROJECT MANAGER EDWIN TIPSWORD

CONTRACT NO. 74776

STATE OF ILLINOIS
DEPARTMENT OF TRANSPORTATION

SUBMITTED DECEMBER 22 2016
Jeffery M. Scott
REGIONAL ENGINEER

Jan 27 2017
Maureen M. Addis
ENGINEER OF DESIGN AND ENVIRONMENT

Jan 27 2017
Amelia
DIRECTOR OF PROGRAM DEVELOPMENT

PRINTED BY THE AUTHORITY
OF THE STATE OF ILLINOIS

INDEX OF SHEETS

SHEET NO	TITLE
1	COVER SHEET
2	GENERAL NOTES, INDEX OF SHEETS
3	SUMMARY OF QUANTITIES
4	TYPICAL SECTIONS
5-6	SCHEDULES OF QUANTITIES
7	LOCATION MAP
8	RURAL ENTRANCE DETAIL & SCHEDULE
9-12	PAVEMENT MARKING DETAILS
13	BUTT JOINT & MILLING DETAIL

THE FOLLOWING STANDARDS ARE A PART OF THESE PLANS AND ARE INCLUDED FOLLOWING THE LAST NUMBERED SHEET OF THE PLANS.

- 442201-03 CLASS C AND D PATCHES
- 406201-01 MAILBOX TURNOUT
- 701001-02 OFF-ROAD OPERATIONS, 2L, 2W, MORE THAN 15' AWAY
- 701006-05 OFF-ROAD OPERATIONS, 2L, 2W, 15' TO 24" FROM PAVEMENT EDGE
- 701011-04 OFF-ROAD MOVING OPERATIONS, 2L, 2W, DAY ONLY
- 701201-04 LANE CLOSURE, 2L, 2W, DAY ONLY, FOR SPEEDS >= 45 MPH
- 701301-04 LANE CLOSURE, 2L, 2W, SHORT TIME OPERATIONS
- 701306-03 LANE CLOSURE, 2L, 2W, SLOW MOVING OPERATIONS DAY ONLY, FOR SPEEDS >= 45 MPH
- 701311-03 LANE CLOSURE, 2L, 2W, MOVING OPERATIONS - DAY ONLY
- 701901-06 TRAFFIC CONTROL DEVICES

GENERAL NOTES

THIS SECTION SHALL BE CONSTRUCTED IN ACCORDANCE WITH THE PLANS, THE "STANDARD SPECIFICATIONS FOR ROAD AND BRIDGE CONSTRUCTION", ADOPTED APRIL 1, 2016; THE "SUPPLEMENTAL SPECIFICATIONS AND RECURRING SPECIAL PROVISIONS" INDICATED ON THE CHECK SHEET, AND THE SPECIAL PROVISIONS INCLUDED IN THE PROPOSAL.

THE WORK IN THIS SECTION INCLUDES PATCHING, MILLING AND RESURFACING THE EXISTING PAVEMENT, AGGREGATE SHOULDERS, PAINT PAVEMENT MARKINGS, THERMOPLASTIC PAVEMENT MARKINGS, AND OTHER WORK NECESSARY TO COMPLETE THIS SECTION.

THE PROPOSED PROJECT BEGINS 1.5 MILES WEST OF IL 121 ON BRUCE/FINDLAY ROAD AND ENDS AT THE INTERSECTION OF IL 121 AND BRUCE/FINDLAY ROAD.

SHORT TERM PAVEMENT MARKING ON THE MILLED SURFACE SHALL BE PAINT. ALL OTHER SHORT TERM PAVEMENT MARKINGS SHALL BE TAPE.

THE QUANTITIES FOR PAVEMENT PATCHING ITEMS ARE ESTIMATES. THE ACTUAL LOCATIONS AND QUANTITIES SHALL BE DETERMINED BY THE ENGINEER IN THE FIELD.

QUANTITIES FOR PAINT PAVEMENT MARKING - LINE 4" CONSISTS OF 2,903 FEET OF YELLOW, AND 15,500 FEET OF WHITE.

QUANTITIES FOR THERMOPLASTIC PAVEMENT MARKING - LINE 24" CONSISTS OF 44 FEET OF WHITE.

QUANTITIES FOR THERMOPLASTIC PAVEMENT MARKING - LETTERS AND SYMBOLS CONSISTS OF 61.2 SQ FT OF WHITE.

THE CONTRACTOR SHALL PROVIDE INTERNET ACCESS TO THE BITUMINOUS PLANT QUALITY CONTROL LAB SO THAT BITUMINOUS PLANT REPORTS CAN BE E-MAILED TO THE DISTRICT HEADQUARTERS. THIS WORK WILL NOT BE PAID FOR SEPARATELY BUT SHALL BE INCLUDED IN THE UNIT PRICES FOR OTHER ITEMS IN THE CONTRACT.

THE RESIDENT ENGINEER SHALL BE THE SOLE JUDGE CONCERNING THE CURING TIME FOR THE HMA SURFACE COURSE.

MATERIAL FOR AGGREGATE WEDGE SHOULDER, TYPE B SHALL BE CRUSHED STONE, CRUSHED CONCRETE OR RAP.

MATERIAL FOR AGGREGATE SURFACE COURSE, TYPE B SHALL BE CRUSHED STONE, OR CRUSHED CONCRETE.

THE FOLLOWING MIXTURE REQUIREMENTS ARE APPLICABLE TO THIS PROJECT:

APPLICATION	AC/PG	DESIGN AIR VOIDS	MIXTURE COMPOSITION	FRICTION AGGREGATE	TESTING PARAMETER
CLASS D PATCHES	PG 64-22	4.0% @ N=70	IL - 19.0	N/A	OC/OA
LEVELING BINDER, N70 FINE GRADED	PG 64-22	4.0% @ N=70	IL - 9.5	N/A	OC/OA
HMA SURFACE COURSE MIX "C" N70	PG 64-22	4.0% @ N=70	IL - 9.5	MIXTURE C	OCP
INCIDENTAL HMA SURFACING	PG 64-22	4.0% @ N=70	IL - 9.5	MIXTURE C	OC/OA

FILE NAME :	USER NAME : staffanmk	DESIGNED :	REVISED :	STATE OF ILLINOIS DEPARTMENT OF TRANSPORTATION	INDEX OF SHEETS & GENERAL NOTES					F.A.S. RTE.	SECTION	COUNTY	TOTAL SHEETS	SHEET NO.
\\IL084EBI0INTEG\illinois.gov\PI00T\Documents\DOT Offices\District 7\Projects\74776\Drawings\CD\Sheets\0774776-shs-gennote	DRAWN :	CHECKED :	REVISED :		642	07 HMA RESURF 2017-4	*	13	2					
PLOT SCALE = 100.0000' / 1"	DATE :	DATE :	DATE :		CONTRACT NO. 74776									
Default	PLOT DATE = 12/22/2016	DATE :	DATE :		ILLINOIS FED. AID PROJECT									

100 %
STATE

100 %
STATE

SUMMARY OF QUANTITIES			TOTAL QUANTITIES	CONSTRUCTION TYPE CODE		
CODE NO	ITEM	UNIT		0005 MOULTRIE COUNTY	0005 COLES COUNTY	
40200800	AGGREGATE SURFACE COURSE, TYPE B	TON	5	5		
40600290	BITUMINOUS MATERIALS (TACK COAT)	POUND	13099	11923	1176	
40600635	LEVELING BINDER (MACHINE METHOD), N70	TON	815	777	38	
40600982	HOT-MIX ASPHALT SURFACE REMOVAL - BUTT JOINT	SO YD	257	257		
40600990	TEMPORARY RAMP	SO YD	237	37	200	
40603315	HOT-MIX ASPHALT SURFACE COURSE, MIX "C", N70	TON	1630	1555	75	
40800050	INCIDENTAL HOT-MIX ASPHALT SURFACING	TON	46	46		
44000155	HOT-MIX ASPHALT SURFACE REMOVAL, 1 1/2"	SO YD	17260	17260		
44000158	HOT-MIX ASPHALT SURFACE REMOVAL, 2 1/4"	SO YD	1644		1644	
44201785	CLASS D PATCHES, TYPE I, 12 INCH	SO YD	51	51		
44201789	CLASS D PATCHES, TYPE II, 12 INCH	SO YD	662	662		
44201794	CLASS D PATCHES, TYPE III, 12 INCH	SO YD	219	219		
44201796	CLASS D PATCHES, TYPE IV, 12 INCH	SO YD	287	287		
48102100	AGGREGATE WEDGE SHOULDER, TYPE B	TON	1241	1241		

SUMMARY OF QUANTITIES			TOTAL QUANTITIES	CONSTRUCTION TYPE CODE		
CODE NO	ITEM	UNIT		0005 MOULTRIE COUNTY	0005 COLES COUNTY	
67100100	MOBILIZATION	LSUM	1	0.5	0.5	
70100450	TRAFFIC CONTROL AND PROTECTION, STANDARD 701201	LSUM	1	0.5	0.5	
70100460	TRAFFIC CONTROL AND PROTECTION, STANDARD 701306	LSUM	1	0.5	0.5	
70300100	SHORT TERM PAVEMENT MARKING	FOOT	3168	2964	204	
70300150	SHORT TERM PAVEMENT MARKING REMOVAL	SO FT	264	247	17	
* 78000100	THERMOPLASTIC PAVEMENT MARKING - LETTERS AND SYMBOLS	SO FT	61	61		
* 78000650	THERMOPLASTIC PAVEMENT MARKING - LINE 24"	FOOT	44	22	22	
* 78001110	PAINT PAVEMENT MARKING - LINE 4"	FOOT	18403	16913	1490	
X4060995	TEMPORARY RAMP, SPECIAL	SO YD	44		44	
X4401198	HOT-MIX ASPHALT SURFACE REMOVAL, VARIABLE DEPTH	SO YD	244	146	98	
X7015005	CHANGEABLE MESSAGE SIGN	CAL DA	28	14	14	
Z0048665	RAILROAD PROTECTIVE LIABILITY INSURANCE	LSUM	1		1	

* SPECIALTY ITEM

FILE NAME	USER NAME	DESIGNED	REVISED	STATE OF ILLINOIS DEPARTMENT OF TRANSPORTATION	SUMMARY OF QUANTITIES	F.A.S. RTE.	SECTION	COUNTY	TOTAL SHEETS	SHEET NO.
\\s:\b04\ER\B\INTEG\311\res\gov\FW\DOT\Documents\1001_0\Fish\District 7\Projects\74776\Drawn\CD\B\res\CD\74776\SH-S01.dgn	ltpw@order	CD				642	D7 HMA RESURF 2017-4		13	3
PLOT SCALE = 100.0000 / in.		CHECKED	REVISED			CONTRACT NO. 14776				
PLOT DATE = 1/3/2017		DATE	REVISED			ILLINOIS FED. AID PROJECT				
SCALE:	SHEET	OF	SHEETS	STA.	TO STA.					

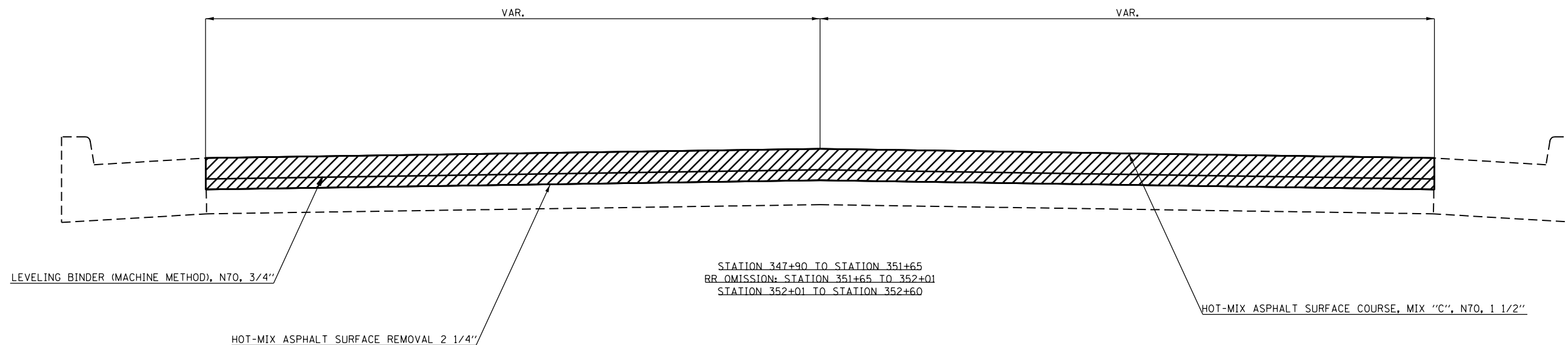
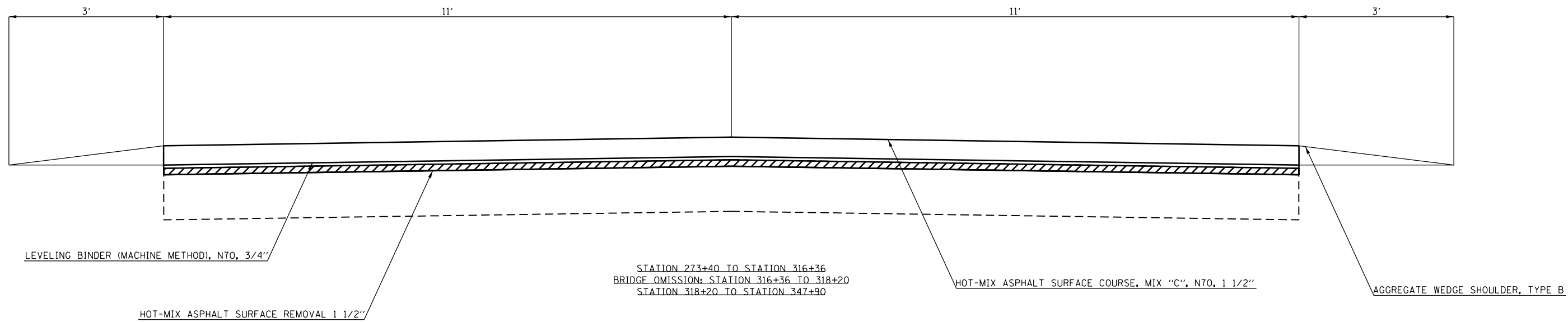

FILE NAME =	USER NAME = steffenk	DESIGNED -	REVISED -
pw:\IL\084EBID\INTEG.illinois.gov\PWIDOT\Documents\IDOT Offices\District 7\Projects\74776\Drawings\CAD\Sheets\0774776-sht-typical.dwg		DRAWN -	REVISED -
Default	PLOT SCALE = 100.0000' / 1"	CHECKED -	REVISED -
	PLOT DATE = 12/22/2016	DATE -	REVISED -

**STATE OF ILLINOIS
DEPARTMENT OF TRANSPORTATION**

PROPOSED TYPICAL SECTIONS

SCALE: SHEET OF SHEETS STA. TO STA.

F.A.S. RTE.	SECTION	COUNTY	TOTAL SHEETS	SHEET NO.
642	D7 HMA RESURF 2017-4	*	13	4
CONTRACT NO. 74776			ILLINOIS FED. AID PROJECT	

PATCH NUMBER	LANE	STA	LENGTH FT	WIDTH FT	PLAN DEPTH IN	44201785	44201789	44201794	44201796
						CLASS D TYPE 1 SQ YD	CLASS D TYPE 2 SQ YD	CLASS D TYPE 3 SQ YD	CLASS D TYPE 4 SQ YD
1	EB	275+00	8.0	11.0	12.0		9.8		
2	WB	275+00	8.0	11.0	12.0		9.8		
3	EB	277+20	4.0	11.0	12.0	4.9			
4	WB	277+20	4.0	11.0	12.0	4.9			
5	EB	278+00	8.0	11.0	12.0		9.8		
6	WB	278+00	8.0	11.0	12.0		9.8		
7	EB	285+00	6.0	11.0	12.0		7.3		
8	WB	285+00	6.0	11.0	12.0		7.3		
9	EB	288+00	6.0	11.0	12.0		7.3		
10	WB	288+00	6.0	11.0	12.0		7.3		
11	EB	293+00	6.0	11.0	12.0		7.3		
12	WB	293+00	6.0	11.0	12.0		7.3		
13	EB	294+00	8.0	11.0	12.0		9.8		
14	WB	294+00	8.0	11.0	12.0		9.8		
15	EB	295+25	10.0	11.0	12.0		12.2		
16	WB	295+25	10.0	11.0	12.0		12.2		
17	EB	297+00	8.0	11.0	12.0		9.8		
18	WB	297+00	8.0	11.0	12.0		9.8		
19	EB	299+00	6.0	11.0	12.0		7.3		
20	WB	299+00	6.0	11.0	12.0		7.3		
21	EB	300+00	6.0	11.0	12.0		7.3		
22	WB	300+00	6.0	11.0	12.0		7.3		
23	EB	302+00	10.0	11.0	12.0		12.2		
24	WB	302+00	10.0	11.0	12.0		12.2		
25	EB	302+00	10.0	11.0	12.0		12.2		
26	EB	303+55	6.0	11.0	12.0		7.3		
27	WB	303+55	6.0	11.0	12.0		7.3		
28	EBEP	305+45	45.0	6.0	12.0				30.0
29	WBEP	305+45	45.0	6.0	12.0				30.0
30	WB	305+75	10.0	11.0	12.0		12.2		
31	EB	305+90	4.0	11.0	12.0	4.9			
32	EB	306+40	4.0	11.0	12.0	4.9			
33	EB	306+55	10.0	11.0	12.0		12.2		
34	EBEP	306+80	6.0	6.0	12.0	4.0			
35	WBEP	306+80	65.0	6.0	12.0				43.3
36	EB	306+95	4.0	11.0	12.0	4.9			
37	WB	306+95	15.0	11.0	12.0			18.3	
38	WBEP	307+80	35.0	6.0	12.0			23.3	
39	EB	308+00	8.0	11.0	12.0		9.8		
40	WB	308+00	8.0	11.0	12.0		9.8		
41	EB	309+00	6.0	11.0	12.0		7.3		
42	WB	309+00	6.0	11.0	12.0		7.3		
43	EBEP	311+40	15.0	6.0	12.0		10.0		
44	EB	311+90	6.0	11.0	12.0		7.3		
45	WB	311+90	25.0	11.0	12.0				30.6
46	WBCL	312+90	10.0	4.0	12.0	4.4			
47	EB	312+90	8.0	11.0	12.0		9.8		
48	EB	313+30	15.0	11.0	12.0			18.3	
49	EB	313+60	20.0	11.0	12.0			24.4	

PATCH NUMBER	LANE	STA	LENGTH FT	WIDTH FT	PLAN DEPTH IN	44201785	44201789	44201794	44201796
						CLASS D TYPE 1 SQ YD	CLASS D TYPE 2 SQ YD	CLASS D TYPE 3 SQ YD	CLASS D TYPE 4 SQ YD
50	WB	313+60	20.0	11.0	12.0			24.4	
51	EB	313+90	6.0	11.0	12.0		7.3		
52	EB	315+00	8.0	11.0	12.0		9.8		
53	WB	315+00	8.0	11.0	12.0		9.8		
SN: 070-0046 Bridge Omission 316+36 to 318+20									
54	WB	320+00	10.0	11.0	12.0		12.2		
55	WB	320+40	6.0	11.0	12.0		7.3		
56	EBCL	320+70	15.0	4.0	12.0		6.7		
57	WB	321+30	45.0	11.0	12.0				55.0
58	EBEP	321+55	15.0	6.0	12.0		10.0		
59	WB	322+05	6.0	11.0	12.0		7.3		
60	WBEP	322+25	20.0	6.0	12.0		13.3		
61	EBEP	322+25	6.0	6.0	12.0	4.0			
62	EBEP	322+85	6.0	6.0	12.0	4.0			
63	WBCL	322+95	30.0	4.0	12.0		13.3		
64	WB	323+10	10.0	11.0	12.0		12.2		
65	WBEP	323+20	10.0	6.0	12.0		6.7		
66	WBCL	323+80	40.0	5.0	12.0			22.2	
67	EBCL	323+80	40.0	5.0	12.0			22.2	
68	WBEP	323+90	15.0	6.0	12.0		10.0		
69	WB	324+20	20.0	11.0	12.0			24.4	
70	EB	324+20	20.0	11.0	12.0			24.4	
71	EB	324+35	6.0	11.0	12.0		7.3		
72	WB	324+35	6.0	11.0	12.0		7.3		
73	WBEP	324+85	50.0	6.0	12.0				33.3
74	WB	328+90	8.0	11.0	12.0		9.8		
75	EB	328+90	8.0	11.0	12.0		9.8		
76	WBEP	330+85	10.0	6.0	12.0		6.7		
77	WBEP	331+55	20.0	6.0	12.0		13.3		
78	WB	332+00	4.0	11.0	12.0	4.9			
79	EB	332+00	4.0	11.0	12.0	4.9			
80	EBEP	333+85	20.0	6.0	12.0		13.3		
81	WBEP	333+85	50.0	6.0	12.0				33.3
82	WBEP	334+35	20.0	6.0	12.0		13.3		
83	EBEP	335+65	20.0	6.0	12.0		13.3		
84	WBEP	335+65	20.0	6.0	12.0		13.3		
85	WBEP	338+25	20.0	6.0	12.0		13.3		
86	EB	339+00	6.0	11.0	12.0		7.3		
87	WB	339+00	6.0	11.0	12.0		7.3		
88	EB	339+60	12.0	11.0	12.0		14.7		
89	WB	339+65	25.0	11.0	12.0				30.6
90	EB	339+65	10.0	11.0	12.0		12.2		
91	EB	339+85	12.0	11.0	12.0		14.7		
92	EBEP	340+50	25.0	6.0	12.0			16.7	
93	EB	340+60	10.0	11.0	12.0		12.2		
94	EB	341+35	6.0	11.0	12.0		7.3		
95	EB	342+65	10.0	11.0	12.0		12.2		
96	WB	342+65	12.0	11.0	12.0		14.7		
TOTALS						50.7	661.9	218.6	286.1

FILE NAME =	USER NAME = steffennk	DESIGNED -	REVISED -
p:\11\084EBIDINTEG.illinois.gov\PIWIDOT\Documents\DOT Offices\District 7\Projects\74776\Drawings\CAD\Sheets\0774776-sht-schedule.dwg		CHECKED -	REVISED -
Default	PLOT DATE = 12/22/2016	DATE -	REVISED -

**STATE OF ILLINOIS
DEPARTMENT OF TRANSPORTATION**

PATCHING SCHEDULE

SCALE: SHEET OF SHEETS STA. TO STA.

F.A.S. RTE.	SECTION	COUNTY	TOTAL SHEETS	SHEET NO.
642	D7 HMA RESURF 2017-4	*	13	5
CONTRACT NO. 74776			ILLINOIS FED. AID PROJECT	

PAVING SCHEDULE								
STATION	TO	STATION	LENGTH	WIDTH	HOT-MIX ASPHALT SURFACE COURSE, MIX "C", N70	LEVELING BINDER (MACHINE METHOD), N70	AGGREGATE WEDGE SHOULDER, TYPE B	BITUMINOUS MATERIALS (TACK COAT)
					40603315	40600635	48102100	40600275
					TON	TON	TON	POUNDS
273+40.00	TO	316+36.00	4296	22	882.1	441.1	733.9	7088.4
316+36.00	TO	318+20.00	184	22	BRIDGE OMISSION			
318+20.00	TO	350+95.00	3275	22	672.5	336.2	507.4	5403.8
350+95.00	TO	351+65.00	70	VAR.	19.6	9.8		157.5
351+65.00	TO	352+01.00	36	VAR.	RR OMISSION			
352+01.00	TO	352+60.00	59	VAR.	55.9	28.0		449.1
TOTAL					1630.07	815.04	1241.30	13098.80

REMOVAL SCHEDULE								
STATION	TO	STATION	LENGTH	WIDTH	HOT-MIX ASPHALT SURFACE REMOVAL, 1 1/2"	HOT-MIX ASPHALT SURFACE REMOVAL, VARIABLE DEPTH	HOT-MIX ASPHALT SURFACE REMOVAL, 2 1/4"	HOT-MIX ASPHALT SURFACE REMOVAL - BUTT JOINT
					44000155	X4401198	44000158	40600982
					SQ YD	SQ YD	SQ YD	SQ YD
273+40.00	TO	273+75.00	35	22				85.6
273+75.00	TO	316+01.00	4226	22	10330			
316+01.00	TO	316+36.00	35	22				85.6
316+36.00	TO	318+20.00	184	22	BRIDGE OMISSION			
318+20.00	TO	318+55.00	35	22				85.6
318+55.00	TO	346+90.00	2855	22	6930			
346+90.00	TO	347+90.00	100	22		244.4		
347+90.00	TO	350+95.00	305	22			745.6	
350+95.00	TO	351+65.00	70	VAR.			233.3	
351+65.00	TO	352+01.00	36	VAR.	RAILROAD OMISSION			
352+01.00	TO	352+60.00	59	VAR.			665.4	
TOTAL					17260	244.4	1644.3	256.8

STATION	LENGTH	TEMPORARY RAMP	TEMPORARY RAMP, SPECIAL
		40600990	X4060995
		SQ YD	SQ YD
273+40	22	12.2	
316+36	22	12.2	
318+20	22	12.2	
347+50	68		15.1
347+50	77		17.1
348+60	14		3.1
349+15	15		3.3
351+51	24		5.3
351+65	37	30.8	
352+01	54	45	
352+60	149	124.2	
TOTAL		236.6	43.9

PAVEMENT MARKING SCHEDULE								
STATION	TO	STATION	LENGTH	SHORT TERM PAVEMENT MARKING	SHORT TERM PAVEMENT MARKING REMOVAL	THERMOPLASTIC PAVEMENT MARKING - LETTERS AND SYMBOLS	THERMOPLASTIC PAVEMENT MARKING - LINE 24"	PAINT PAVEMENT MARKING - LINE 4"
				70300100	70300150	78000100	78000650	78001110
				FOOT	SQ FT	SQ FT	FT	FT
273+40	TO	352+60	7920	3168	264	61.2	44	18402.5

FILE NAME =	USER NAME = steffenmk	DESIGNED -	REVISED -
p:\11\084EBIDINTEG.illinois.gov\PIDOT\Documents\DOT Offices\District 7\Projects\7477\Drawings\CAD\Sheets\0774776-sht-schedule		DRAWN -	REVISED -
Default	PLOT SCALE = 100.0000' / in.	CHECKED -	REVISED -
	PLOT DATE = 12/22/2016	DATE -	REVISED -

**STATE OF ILLINOIS
DEPARTMENT OF TRANSPORTATION**

SCHEDULE OF QUANTITIES			
SCALE:	SHEET	OF SHEETS	STA. TO STA.

F.A.S. RTE.	SECTION	COUNTY	TOTAL SHEETS	SHEET NO.
642	D7 HMA RESURF 2017-4	*	13	6
CONTRACT NO. 74776			ILLINOIS FED. AID PROJECT	

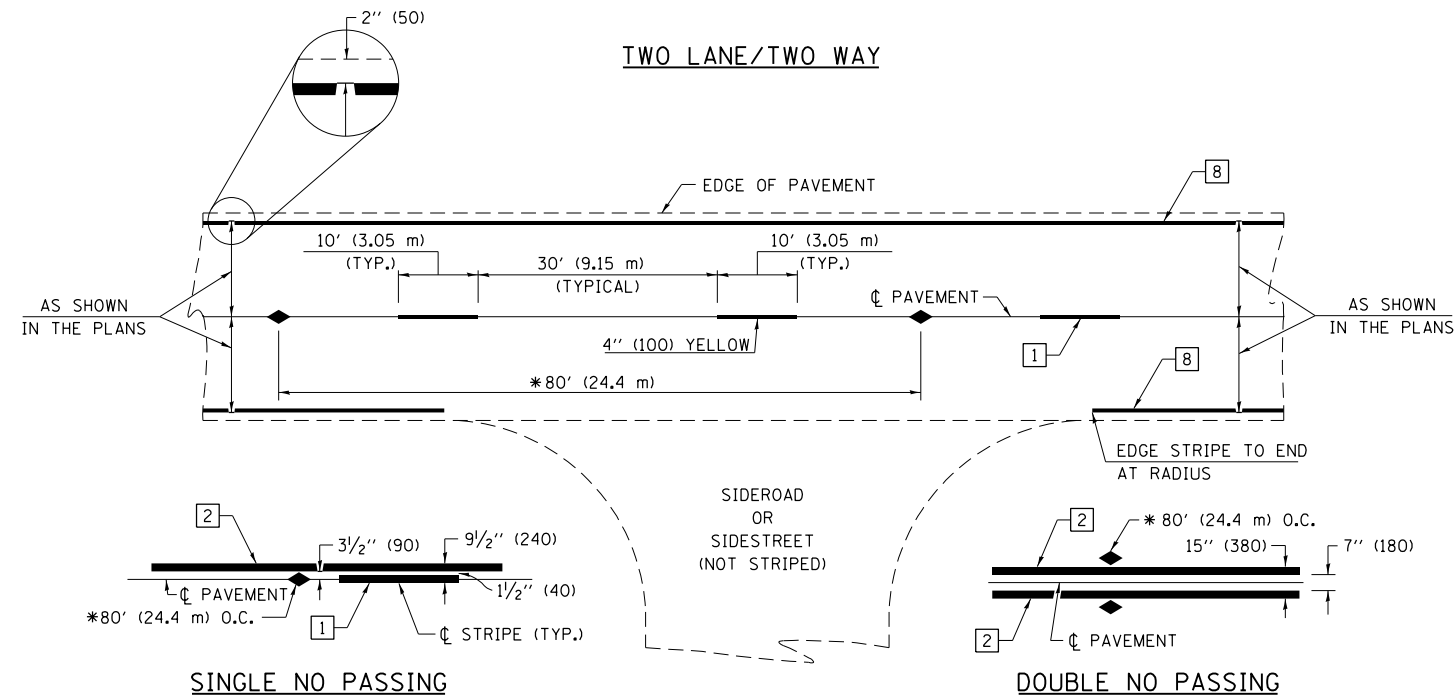

* REDUCE TO 40' (12.2 m) O.C. ON CURVES WITH POSTED OR ADVISORY SPEEDS OF 45 mph (70 km/h) OR LESS.

PAVEMENT MARKING LEGEND

- 1 4" (100) SKIP-DASH (YELLOW)
- 2 4" (100) SOLID (YELLOW)
- 3 12" (300) DIAGONAL (YELLOW)
- 4 4" (100) DOUBLE YELLOW (NARROW)
- 5 12" (300) SOLID WHITE
- 6 RESERVED
- 7 6" (150) SKIP-DASH (WHITE)
- 8 4" (100) SOLID (WHITE)
- 9 12" (300) DIAGONAL (WHITE)
- 10 6" (150) SOLID (WHITE)
- 11 24" (600) STOP BAR (WHITE)
- 12 8" (200) SOLID (WHITE)
- 13 4" (100) PARKING WHITE

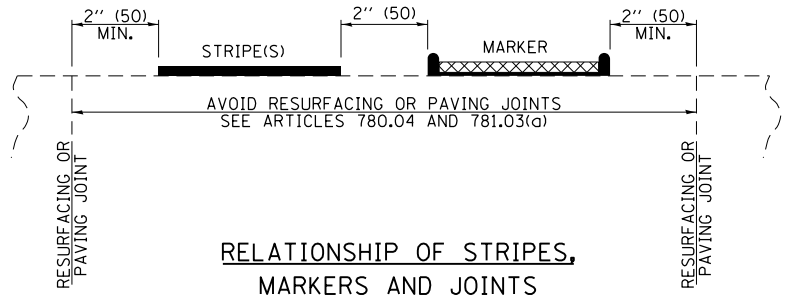

RELATIONSHIP OF STRIPES, MARKERS AND JOINTS

TYPICAL PAVEMENT MARKERS LEGEND

- ◆ TWO-WAY AMBER MARKER
- ▶ ONE-WAY AMBER MARKER
- ▷ ONE-WAY CRYSTAL MARKER

RAISED REFLECTIVE PAVEMENT MARKERS

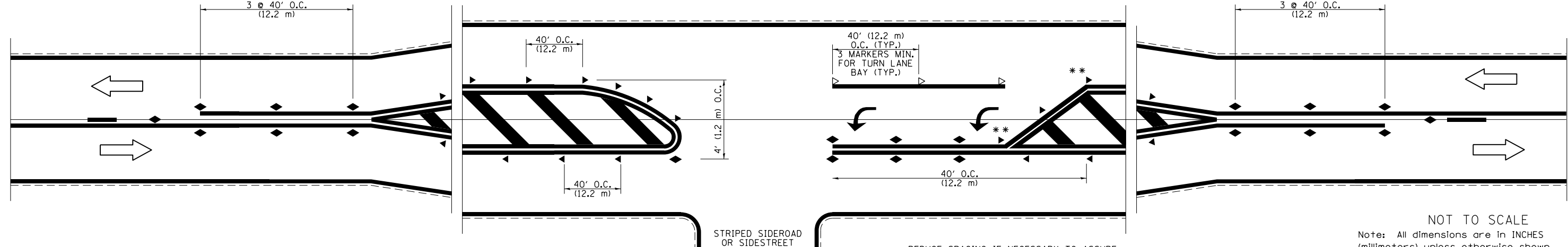

** REDUCE SPACING IF NECESSARY TO ASSURE MARKERS AT CORNER POINTS.

NOT TO SCALE
Note: All dimensions are in INCHES (millimeters) unless otherwise shown.

FILE NAME =	USER NAME = steffenmk	DESIGNED -	REVISED -
pw:\IL\084EBIDINTEG\illinois.gov\PIWIDOT\Documents\DOT Offices\District 7\Projects\74776\Drawings\CABsheets\D774776-shd-details.dwg		CHECKED -	REVISED -
		DATE -	REVISED -

**STATE OF ILLINOIS
DEPARTMENT OF TRANSPORTATION**

**PAVEMENT MARKING AND RAISED REFLECTIVE PAVEMENT MARKERS
(RURAL & URBAN APPLICATIONS)**

SCALE: SHEET NO. 1 OF 4 SHEETS STA. TO STA.

DISTRICT 7 DETAIL NO. 7800001				
F.A.S. RTE.	SECTION	COUNTY	TOTAL SHEETS	SHEET NO.
642	DY HAM RESURF 2017-4		13	9
• MOULTRIE, COLES			CONTRACT NO. 74776	
ILLINOIS FED. AID PROJECT				

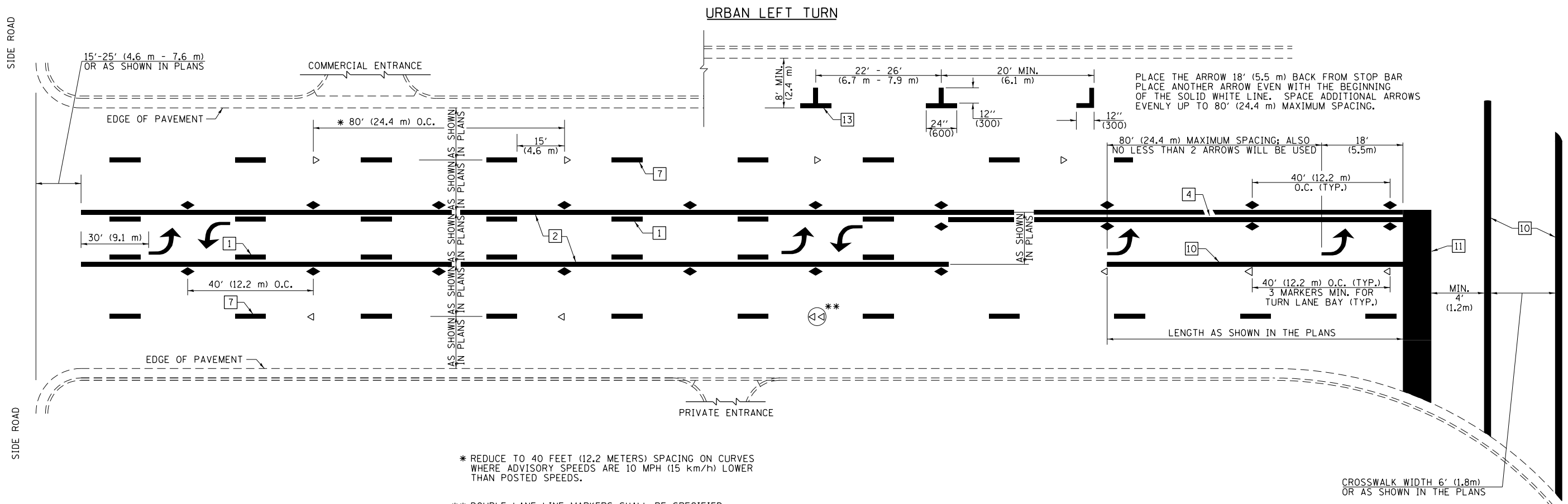

* REDUCE TO 40 FEET (12.2 METERS) SPACING ON CURVES WHERE ADVISORY SPEEDS ARE 10 MPH (15 km/h) LOWER THAN POSTED SPEEDS.

** DOUBLE LANE LINE MARKERS SHALL BE SPECIFIED AND SPACED AS SHOWN IN HIGHWAY STANDARD 781001 FOR MULTI-LANE DIVIDED AND UNDIVIDED HIGHWAYS.

PAVEMENT MARKING LEGEND

- 1 4" (100) SKIP-DASH (YELLOW)
- 2 4" (100) SOLID (YELLOW)
- 3 12" (300) DIAGONAL (YELLOW)
- 4 4" (100) DOUBLE YELLOW (NARROW)
- 5 12" (300) SOLID WHITE
- 6 RESERVED
- 7 6" (150) SKIP-DASH (WHITE)
- 8 4" (100) SOLID (WHITE)
- 9 12" (300) DIAGONAL (WHITE)
- 10 6" (150) SOLID (WHITE)
- 11 24" (600) STOP BAR (WHITE)
- 12 8" (200) SOLID (WHITE)
- 13 4" (100) PARKING WHITE

GENERAL NOTES

1. TURN ARROW PAIRS SHALL BE PLACED AT 250' (75 m) INTERVALS AND SHALL BE EVENLY SPACED BETWEEN BOTH ENDS OF THE BIDIRECTIONAL LEFT TURN LANE. USE A MINIMUM OF TWO PAIRS PER BLOCK.
2. THE SOLID YELLOW PAVEMENT MARKINGS [2] SHOULD GENERALLY START OR END NEAR THE RADIUS POINT OF EACH STREET RETURN EXCEPT WHERE ONE OR BOTH ENDS WOULD INCLUDE STOP BARS.
3. THE SKIP-DASH PAVEMENT MARKINGS [1] OR [7] SHOULD BE CENTERED BETWEEN BOTH ENDS OF EACH CITY BLOCK AND SHALL BE PLACED SO THEY LINE UP ACROSS FROM EACH OTHER.
4. USE LARGE ARROW SIZE FOR BOTH RURAL AND URBAN LOCATIONS. (SEE LAST PAGE OF SECTION 780x FOR SYMBOLS TABLE)
5. LANE LINE EXTENSIONS SHALL BE THE SAME COLOR AND WIDTH AS THE LANE LINE BEING EXTENDED.

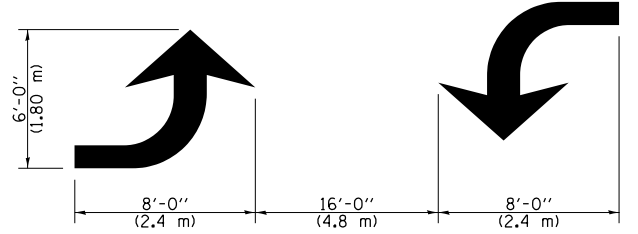
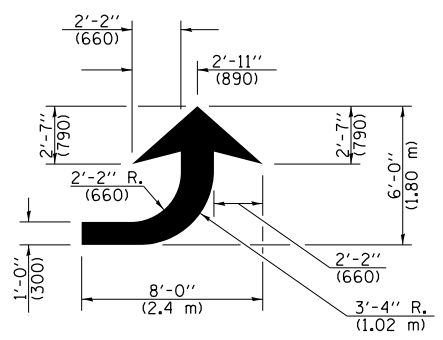
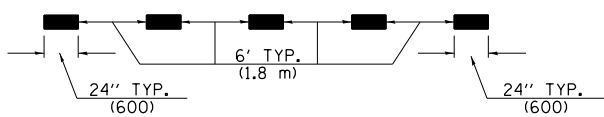
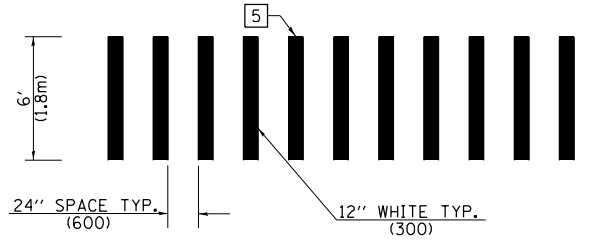

TYPICAL DOUBLE TURN ARROWS (WHITE)

LEFT ARROW
REVERSE FOR RIGHT ARROW
AREA = 15.6 SQ. FT. (1.47 m²)
(WHITE)

NOT TO SCALE

Note: All dimensions are in INCHES (millimeters) unless otherwise shown.

DISTRICT 7 DETAIL NO. 7800001

FILE NAME =	USER NAME = steffenmk	DESIGNED -	REVISED -
pw:\11\084EBIDINTEG.illinois.gov\PWIDOT\Documents\DOT Offices\District 7\Projects\74778\Drawings\CABsheets\0774778-sht-details		CHECKED -	REVISED -
		DATE -	REVISED -

**STATE OF ILLINOIS
DEPARTMENT OF TRANSPORTATION**

**PAVEMENT MARKING AND RAISED REFLECTIVE PAVEMENT MARKERS
(RURAL & URBAN APPLICATIONS)**

F.A.S R.T.E.	SECTION	COUNTY	TOTAL SHEETS	SHEET NO.
642	D7 HMA RESURF 2017-4		13	10
• MOULTRIE, COLES			CONTRACT NO. 74776	
ILLINOIS FED. AID PROJECT				

SCALE: SHEET NO. 2 OF 4 SHEETS STA. TO STA.

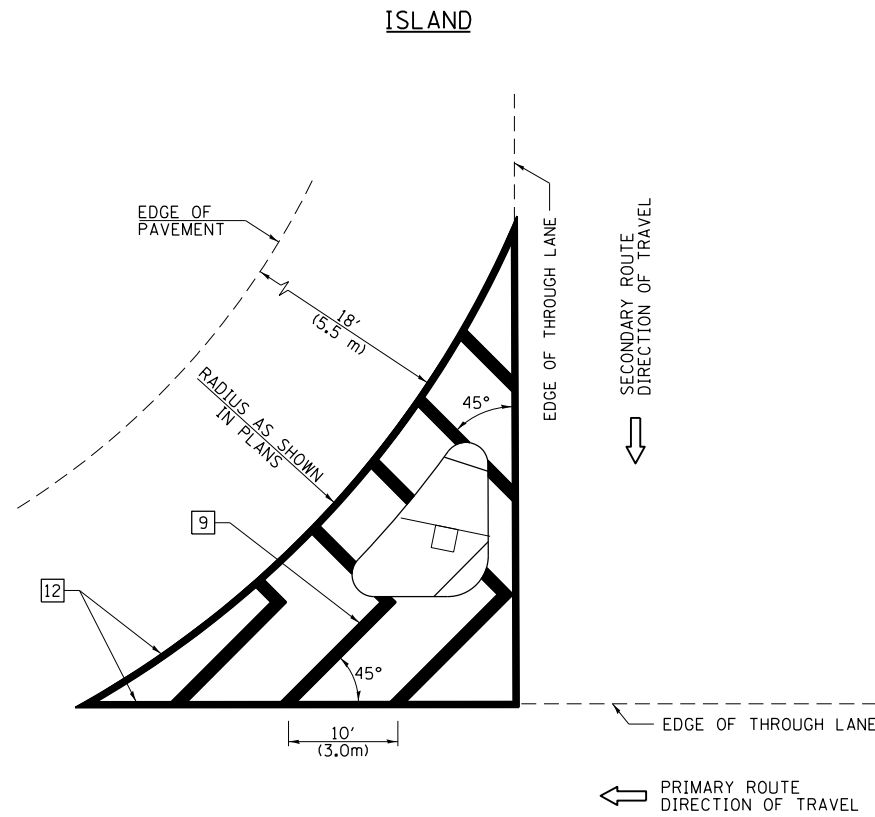

GENERAL NOTES

1. RAISED AND CORRUGATED MEDIANS SHALL BE OUTLINED WITH [2] IF PRESENT.
2. SOME OF THE INFORMATION INCLUDED WITH THIS DETAIL MAY NOT BE APPLICABLE TO THIS IMPROVEMENT.
3. PAVEMENT MARKINGS ARE TO BE EXTENDED THROUGH OMISSIONS WHEN APPLICABLE.
4. FINAL PAVEMENT MARKINGS SHALL BE IN PLACE PRIOR TO PLACING ANY RAISED REFLECTIVE PAVEMENT MARKERS.
5. THE FOLLOWING CRITERIA SHALL BE USED FOR SELECTING THE DIAGONAL PAVEMENT MARKING SPACING:

< 30 MPH (< 50 km/h)	15' (4.5 m)
30-45 MPH (50-75 km/h)	20' (6.0 m)
>45 MPH (>75 km/h)	30' (9.0 m)

PAVEMENT MARKING LEGEND

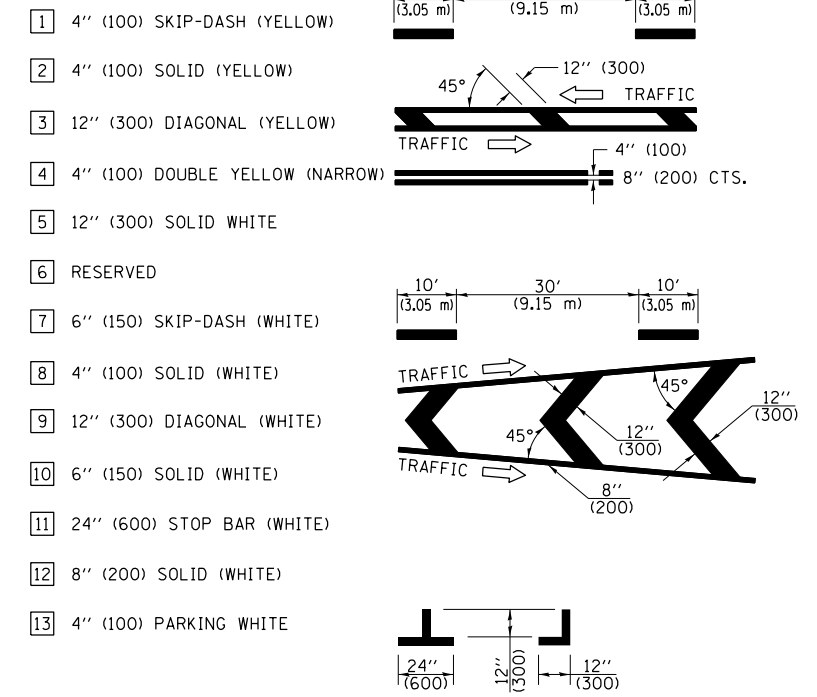

RURAL LEFT TURN STRIPING

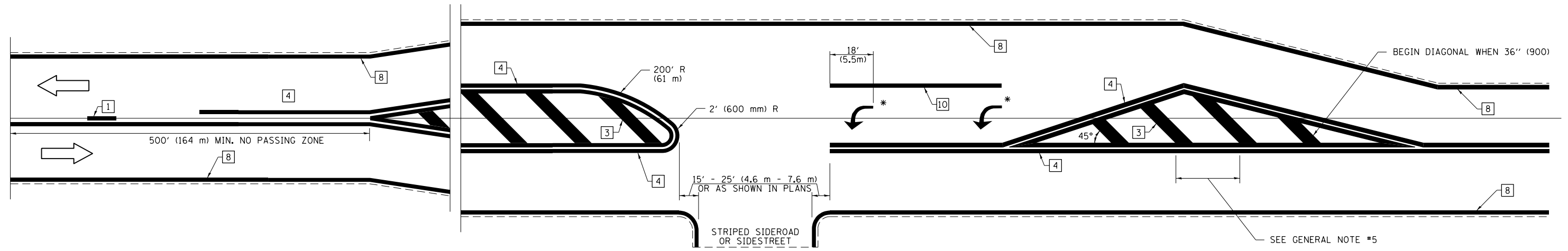

* PLACE AN ARROW 18' (5.5 m) BACK FROM STOP BAR. PLACE ANOTHER ARROW EVEN WITH THE BEGINNING OF THE SOLID WHITE LINE. SPACE ADDITIONAL ARROWS EVENLY UP TO 80' (24.4 m) MAXIMUM SPACING. USE MINIMUM OF 2 ARROWS.

NOT TO SCALE
 Note: All dimensions are in INCHES (millimeters) unless otherwise shown.

DISTRICT 7 DETAIL NO. 7800001

FILE NAME =	USER NAME = steffenmk	DESIGNED -	REVISED -
pw:\IL\084EBIDINTEG\illinois.gov\PWIDOT\Documents\IDOT Offices\District 7\Projects\74776\Drawings\CAB\Drawings\74776-shd-details.dwg		BY -	REVISED -
	PLOT SCALE = 100.0000' / in.	CHECKED -	REVISED -
	PLOT DATE = 12/22/2016	DATE -	REVISED -

**STATE OF ILLINOIS
 DEPARTMENT OF TRANSPORTATION**

**PAVEMENT MARKING AND RAISED REFLECTIVE PAVEMENT MARKERS
 (RURAL & URBAN APPLICATIONS)**

SCALE: SHEET NO. 3 OF 4 SHEETS STA. TO STA.

F.A.S. RTE.	SECTION	COUNTY	TOTAL SHEETS	SHEET NO.
642	D7 HAM RESURF 2017-4		13	11
• MOULTRIE, COLES			CONTRACT NO. 74776	
ILLINOIS FED. AID PROJECT				

PAVEMENT MARKINGS AT RAILROAD-HIGHWAY GRADE CROSSING

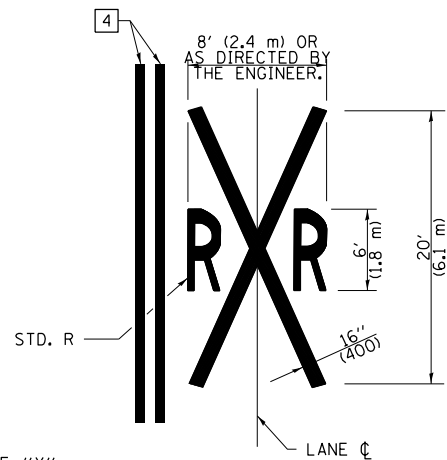
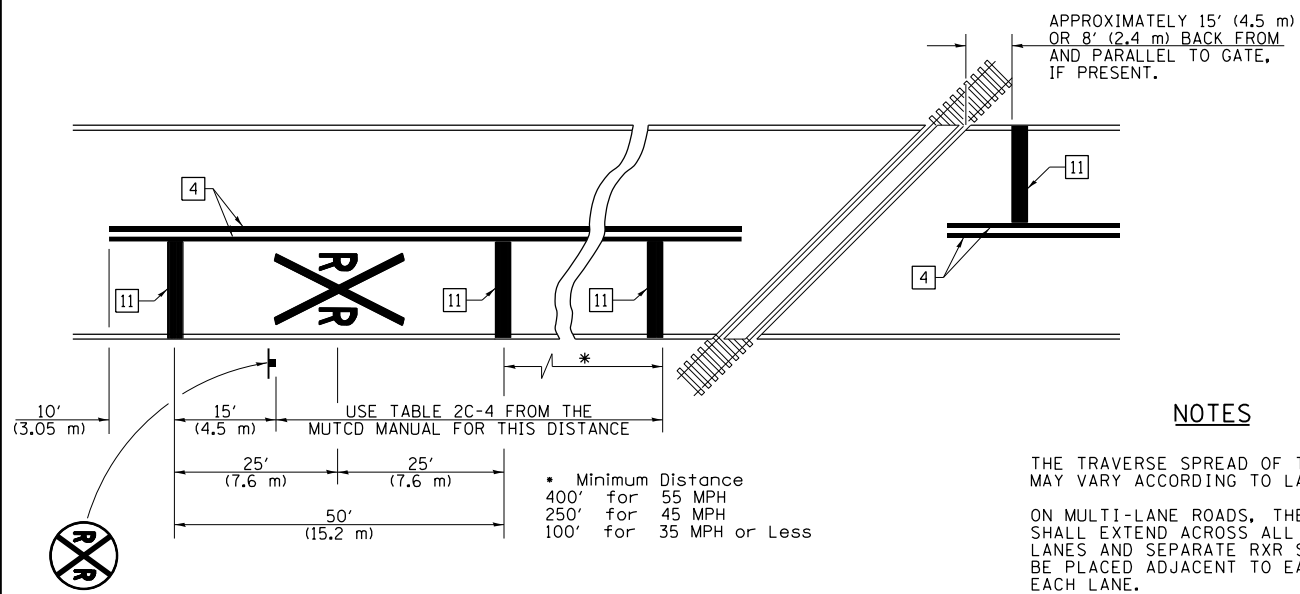

NOTES

THE TRAVERSE SPREAD OF THE "X" MAY VARY ACCORDING TO LANE WIDTH.

ON MULTI-LANE ROADS, THE STOP LINES SHALL EXTEND ACROSS ALL APPROACH LANES AND SEPARATE RXR SYMBOLS SHALL BE PLACED ADJACENT TO EACH OTHER IN EACH LANE.

WHEN THE PAVEMENT MARKING SYMBOL IS USED, A PORTION OF THE SYMBOL SHOULD BE LOCATED DIRECTLY ADJACENT TO THE ADVANCE WARNING SIGN (W10-1) AS PLACED BY TABLE II-1, CONDITION B OF THE MUTCD.

PAVEMENT MARKING LEGEND

- 1 4" (100) SKIP-DASH (YELLOW)
- 2 4" (100) SOLID (YELLOW)
- 3 12" (300) DIAGONAL (YELLOW)
- 4 4" (100) DOUBLE YELLOW (NARROW)
- 5 12" (300) SOLID WHITE
- 6 RESERVED
- 7 6" (150) SKIP-DASH (WHITE)
- 8 4" (100) SOLID (WHITE)
- 9 12" (300) DIAGONAL (WHITE)
- 10 6" (150) SOLID (WHITE)
- 11 24" (600) STOP BAR (WHITE)
- 12 8" (200) SOLID (WHITE)
- 13 4" (100) PARKING WHITE

RAILROAD CROSSING WITH INTERCONNECT ONLY

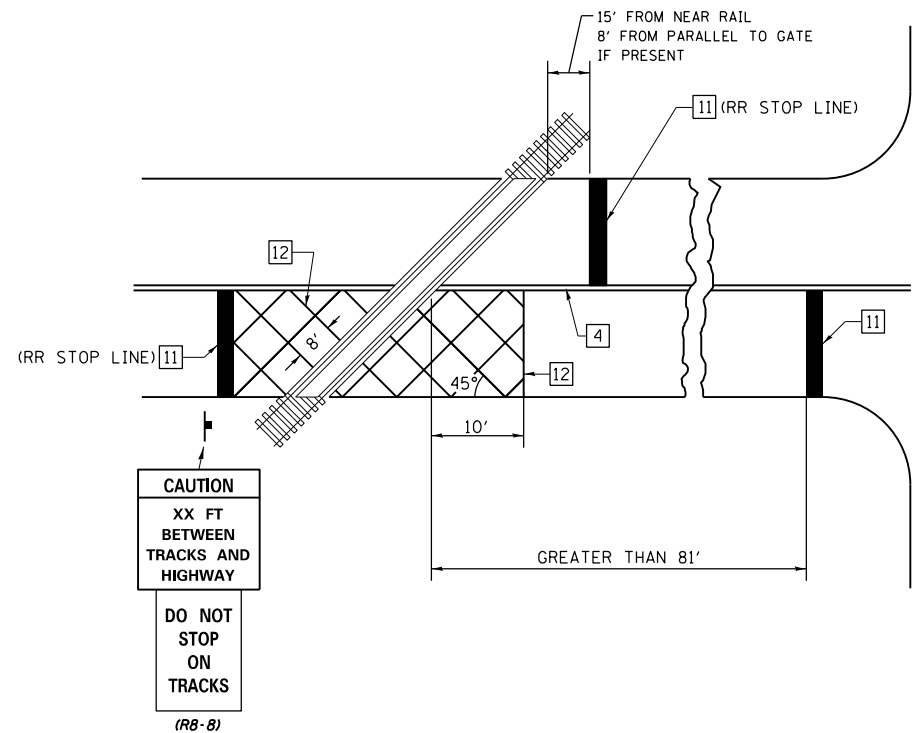

RAILROAD CROSSING WITH INTERCONNECT AND PRE-SIGNALS

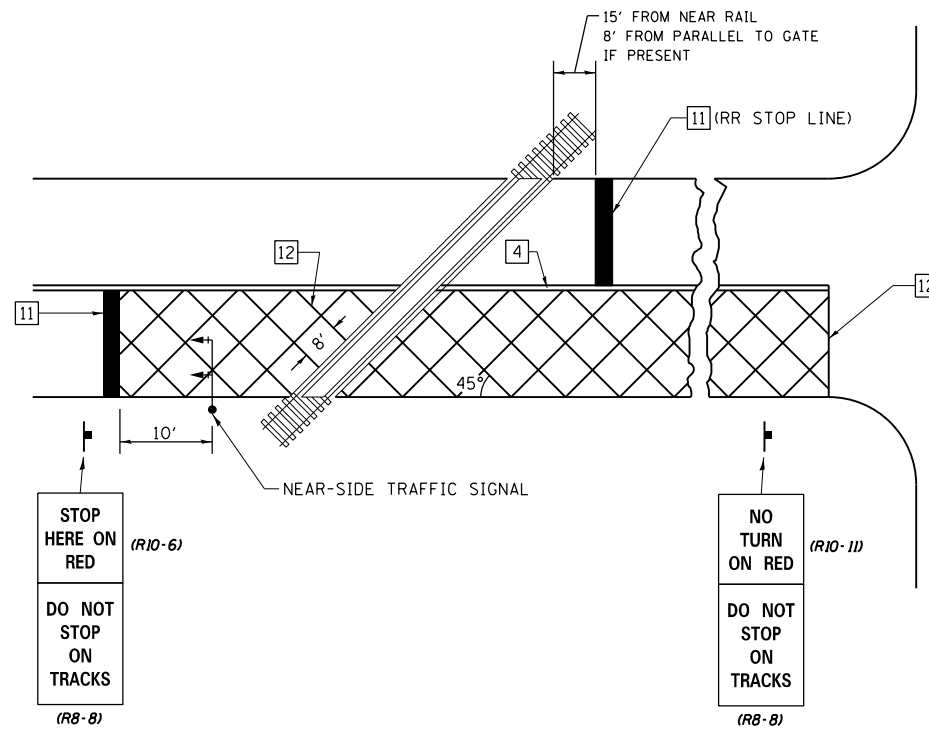

GENERAL NOTES

- SUPPLEMENTAL PAVEMENT MARKINGS TO BE INSTALLED ONLY ON APPROACHES TO INTERSECTIONS CONTROLLED BY TRAFFIC SIGNALS WHICH ARE INTERCONNECTED WITH THE RAILROAD WARNING SIGNALS.
- EXTEND PAVEMENT MARKINGS TO THE INTERSECTION ONLY WHERE NEAR-SIDE TRAFFIC SIGNALS ARE USED.

SUPPLEMENTAL PAVEMENT MARKING TREATMENT FOR RAILROAD-HIGHWAY GRADE CROSSING

NOT TO SCALE

Note: All dimensions are in INCHES (millimeters) unless otherwise shown.

DISTRICT 7 DETAIL NO. 7800001

FILE NAME =	USER NAME = steffenmk	DESIGNED -	REVISED -
pw:\11\084EBIDINTEG.illinois.gov\PIWIDOT\Documents\IDOT Offices\District 7\Projects\74776\Drawings\CABsheets\0774776-shd-details.dwg		CHECKED -	REVISED -
		DATE -	REVISED -

STATE OF ILLINOIS
DEPARTMENT OF TRANSPORTATION

PAVEMENT MARKING AND RAISED REFLECTIVE PAVEMENT MARKERS
(RURAL & URBAN APPLICATIONS)

SCALE: SHEET NO. 4 OF 4 SHEETS STA. TO STA.

F.A.S. RTE.	SECTION	COUNTY	TOTAL SHEETS	SHEET NO.
642	D7 HMA RESURF 2017-4		13	12
• MOULTRIE, COLES			CONTRACT NO. 74776	
ILLINOIS FED. AID PROJECT				

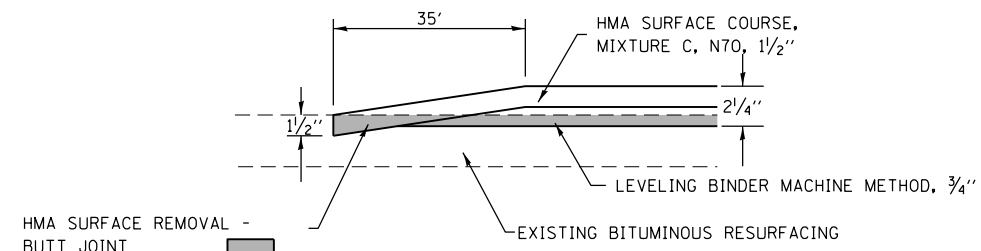

BUTT JOINT DETAIL

STA 273+40 TO STA 273+75
 STA 316+01 TO STA 316+36
 STA 318+20 TO STA 318+55

FILE NAME =	USER NAME = steffenmk	DESIGNED -	REVISED -
pw:\IL\084EBIDINTEG.illinois.gov\PWIDOT\Documents\DOT Offices\District 7\Projects\74776\Drawings\CAD\Sheets\0774776-sht-details.dwg		DRAWN -	REVISED -
Default	PLOT SCALE = 100.0000' / 1in.	CHECKED -	REVISED -
	PLOT DATE = 12/22/2016	DATE -	REVISED -

**STATE OF ILLINOIS
 DEPARTMENT OF TRANSPORTATION**

BUTT JOINT DETAIL

SCALE: SHEET OF SHEETS STA. TO STA.

F.A.S. RTE.	SECTION	COUNTY	TOTAL SHEETS	SHEET NO.
642	D7 HMA RESURF 2017-4	•	13	13
• MOULTRIE, COLES			CONTRACT NO. 74776	
ILLINOIS FED. AID PROJECT				