

F.A.I. 80/94 (KINGERY EXPRESSWAY) BORING LOCATION		F.A.I. R.T.E.	SECTION	CO. JNTY	TOTAL SHEETS	SHEET NO.
ILLINOIS DEPARTMENT OF TRANSPORTATION, COOK COUNTY		80/94	2626.2 R-1	COOK	452	500
DATE SCALE: 1/03	DESIGNED BY: ACE	STA.	TO STA.		FED. ROAD DIST. NO.	
Wong Engineering, Inc.	945 Main Street Lombard, IL 60148 630-953-9928				ILLINOIS	
Geo-Environmental Engineers					FED. AID PROJECT	
BASED ON DRAWINGS PREPARED BY AMERICAN CONSULTING ENGINEERS 256-08-04		CONTRACT No. C2113		INDOT DES. No. 0100987		

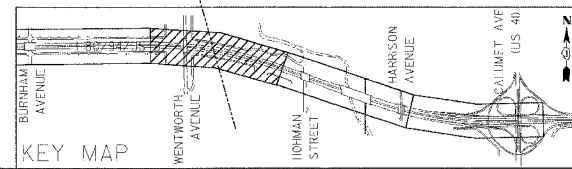
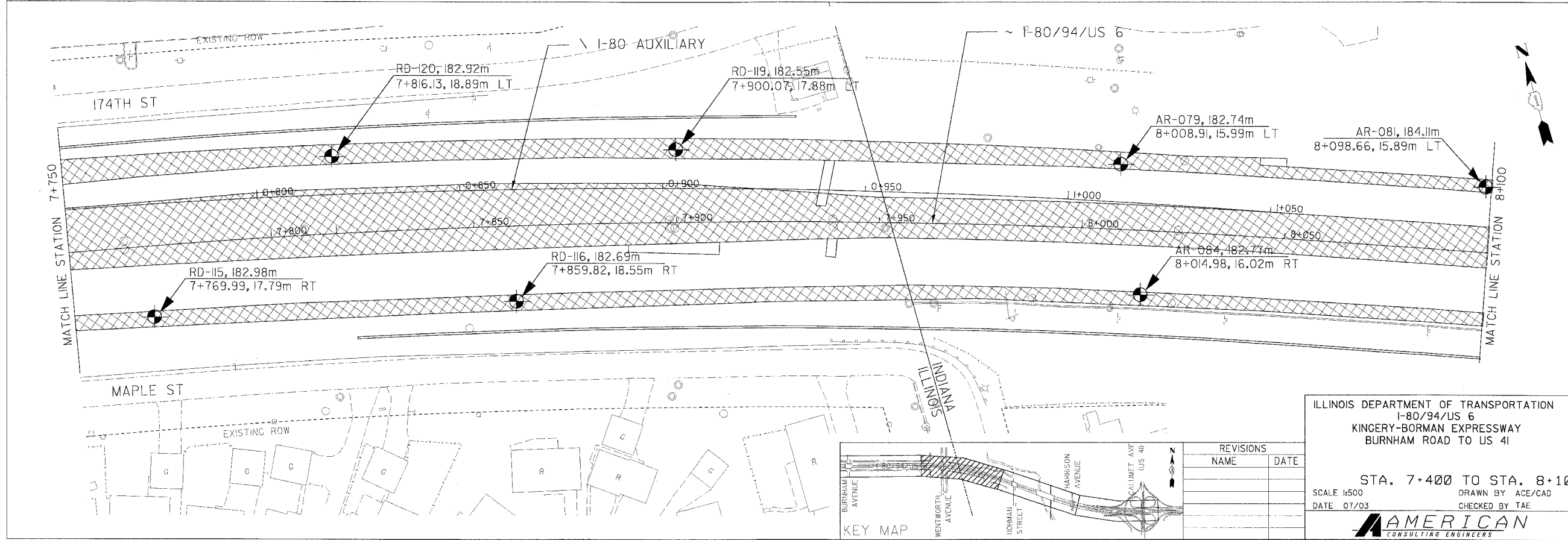
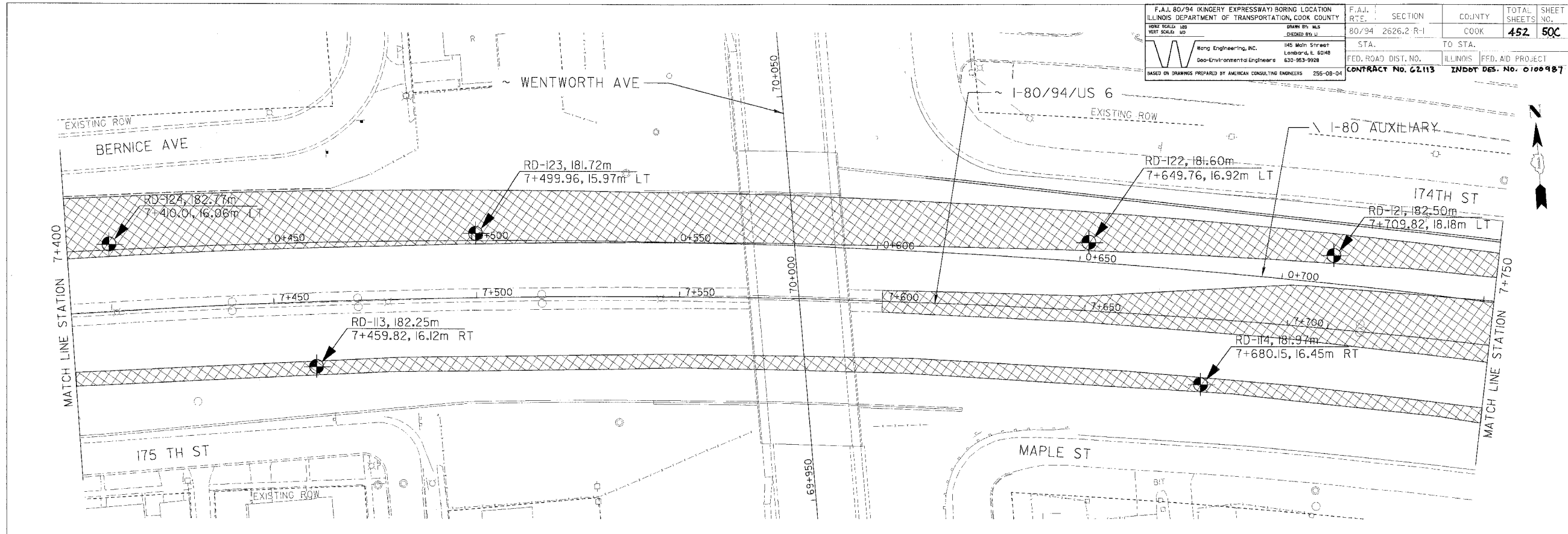

REVISIONS	
NAME	DATE

ILLINOIS DEPARTMENT OF TRANSPORTATION
 I-80/94/US 6
 KINGERY-BORMAN EXPRESSWAY
 BURNHAM ROAD TO US 41

STA. 7+400 TO STA. 8+100

SCALE 1:500
 DATE 07/03

DRAWN BY ACE/CAD
 CHECKED BY TAE

AMERICAN
 CONSULTING ENGINEERS

I:\CADD\8100.dwg 7/29/2001 2:38:28 PM