

F.A.I. 80/94 (KINGERY EXPRESSWAY) BORING LOCATION ILLINOIS DEPARTMENT OF TRANSPORTATION, COOK COUNTY		F.A. .	SECTION	COUNTY	TOTAL SHEETS	SHEET NO.
DRAWN BY: HES CHECKED BY: JLL		2626.2-R-1	COOK	452	504	
Wang Engineering, Inc. 185 Main Street Lombard, IL 60148 630-953-9928 Geo-Environmental Engineers		STA. 7+050 TO STA. 7+400		FED. ROAD DIST. NO. ILLINOIS FED. AD PROJECT CONTRACT NO. 62113 IN DOT DES. NO. 0100987		

FINAL SURVEY PLOTTED	DATE
NOTE BOOK TEMPLATE AREAS CHECKED	
NO.	

ORIGINAL SURVEY PLOTTED	DATE
NOTE BOOK TEMPLATE AREAS CHECKED	
NO.	

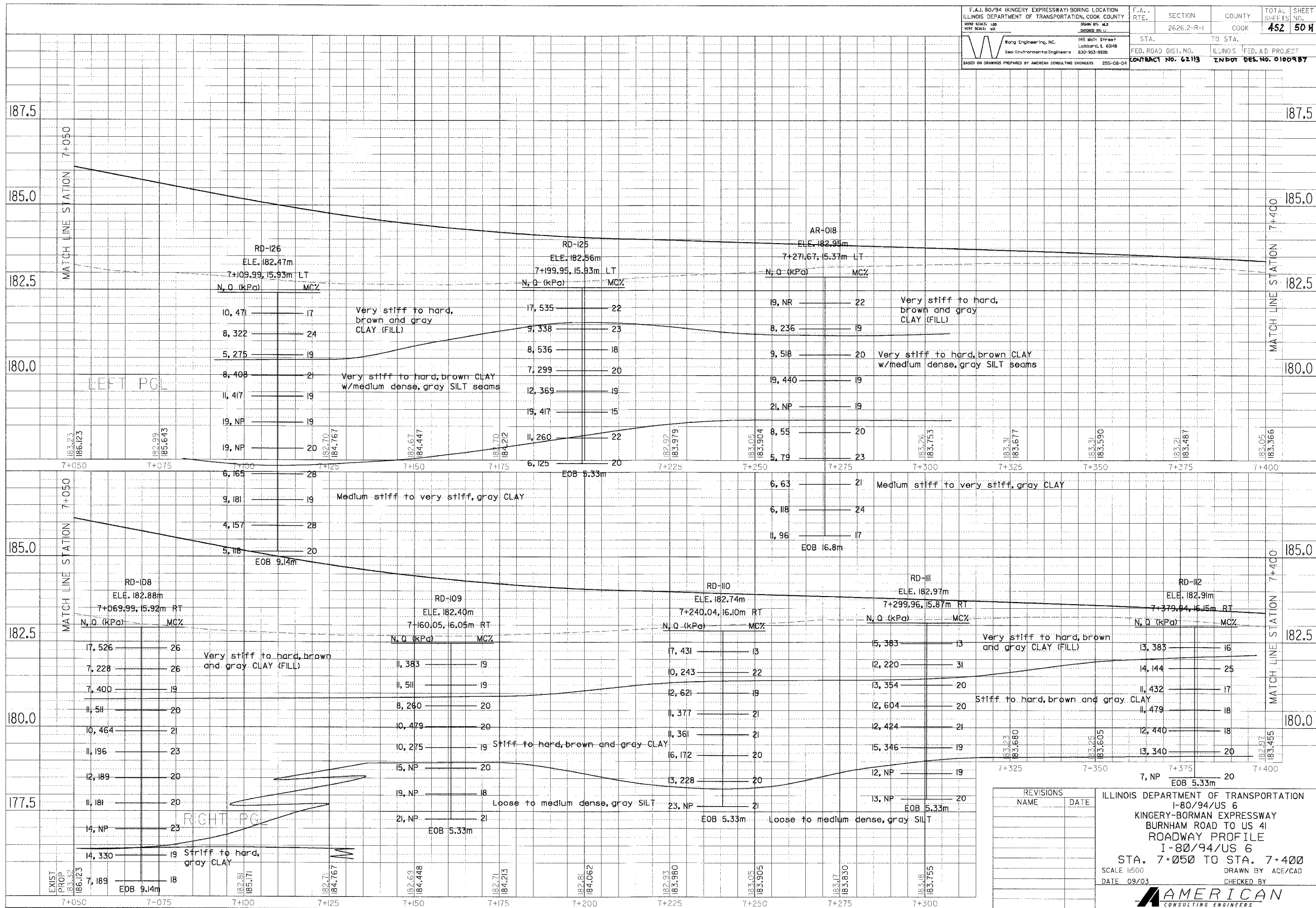

REVISIONS	NAME	DATE

ILLINOIS DEPARTMENT OF TRANSPORTATION  
I-80/94/US 6  
KINGERY-BORMAN EXPRESSWAY  
BURNHAM ROAD TO US 41  
ROADWAY PROFILE  
I-80/94/US 6  
STA. 7+050 TO STA. 7+400  
SCALE 1:500  
DATE 09/03  
DRAWN BY ACE/CAD  
CHECKED BY

**AMERICAN**  
CONSULTING ENGINEERS