

ALL DIMENSIONS IN METERS EXCEPT PAY ITEMS AND UNLESS NOTED OTHERWISE

F.A.I. RTE.	SECTION	COUNTY	TOTAL SHEETS	SHEET NO.
80/94	2626.2-R-1	COOK	452	88
STA.	TO STA.			
FED. ROAD DIST. NO.	ILLINOIS	FED. AID PROJECT		
CONTRACT NO. 62113		INDOT DES. NO. 0100987		

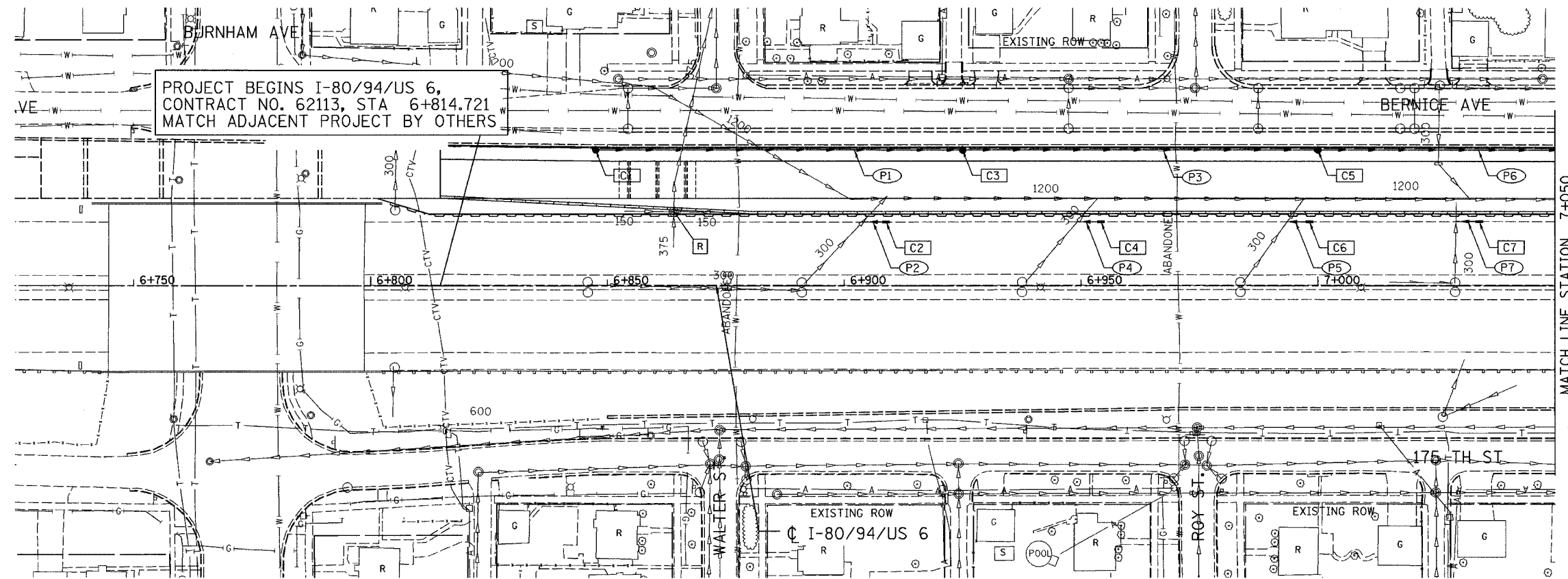

PROJECT BEGINS I-80/94/US 6,
CONTRACT NO. 62113, STA 6+814.721
MATCH ADJACENT PROJECT BY OTHERS

MATCH LINE STATION 7+050

LEGEND

- [R] REMOVE CATCH BAS
- [A] MAN ADJUST OR CB ADJUST
- [SP] STL PLATE INST DR STR AND FR & GRATES REMOVED
- [REC] MAN RECONST
- [F] MAN FILL TO MAIN FLOW
- (XXX) PROPOSED PIPE
- [XXX] PROPOSED STRUCTURE

NOTE: ALL EXISTING PIPES AND UTILITIES TO REMAIN IN SERVICE UNLESS NOTED OTHERWISE.

ILLINOIS DEPARTMENT OF TRANSPORTATION
I-80/94/US 6
KINGERY-BORMAN EXPRESSWAY
BURNHAM ROAD TO US 41
EXISTING AND PROPOSED DRAINAGE PLAN

STA. 6 + 814.721 TO STA. 7 + 050
SCALE 1:500 DRAWN BY ACE/CAD
DATE 07/04 CHECKED BY TAE

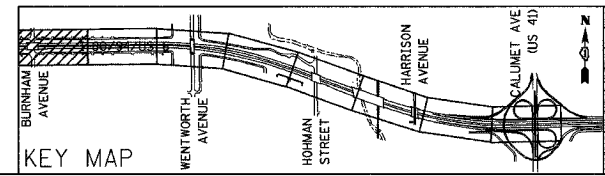

REVISIONS	
NAME	DATE