

| | | | | |
|-------------|------------|---------|--------------|-----------|
| F.A.I. RTE. | SECTION | COUNTY | TOTAL SHEETS | SHEET NO. |
| 80/94 | 2626.2-R-1 | | 452 | 116 |
| STA. | | TO STA. | | |
| | | | | |

CONTRACT NO. 62113 INDOT DES. NO. 0100987

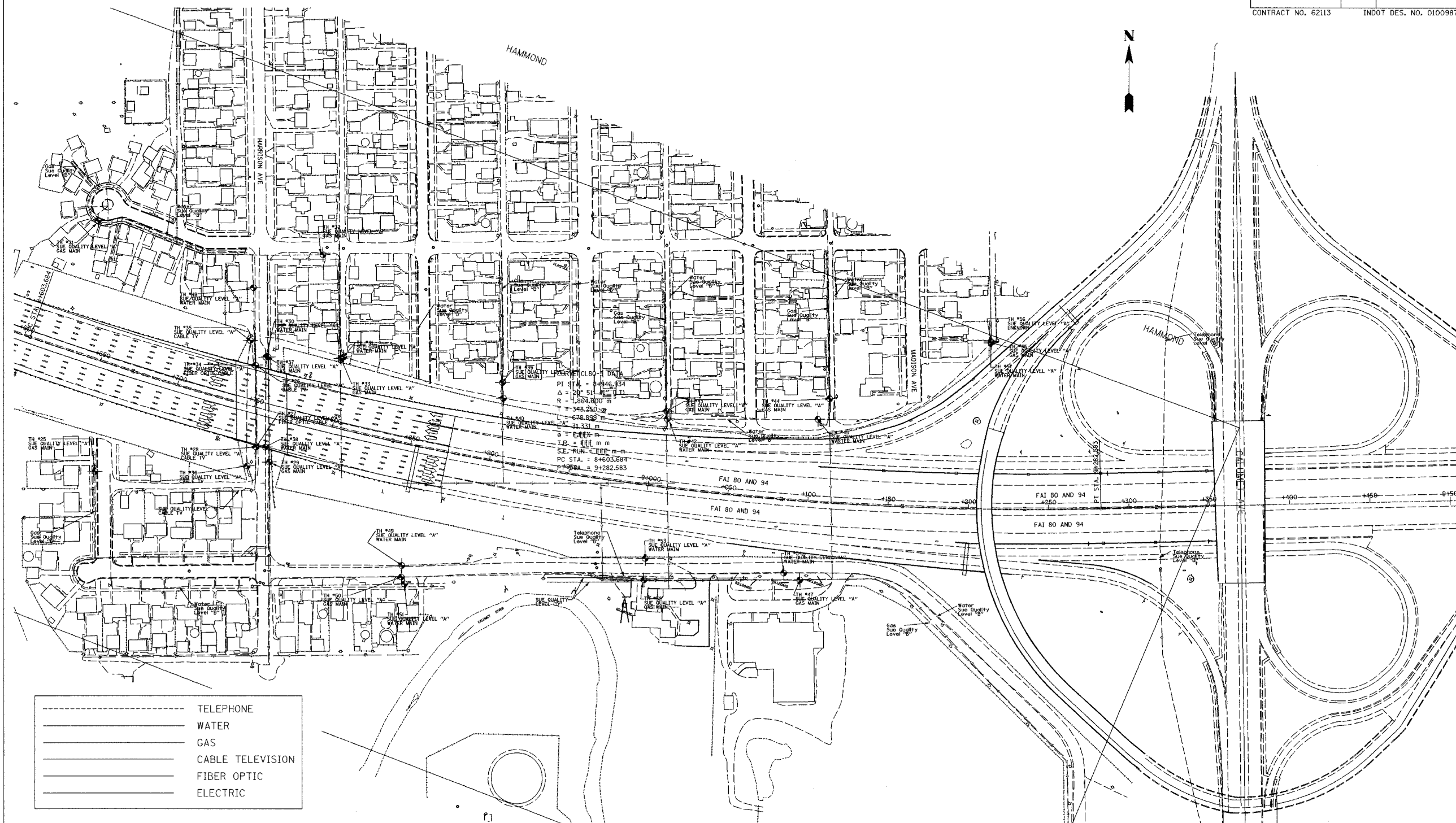

| | |
|-------|------------------|
| ----- | TELEPHONE |
| _____ | WATER |
| _____ | GAS |
| _____ | CABLE TELEVISION |
| _____ | FIBER OPTIC |
| _____ | ELECTRIC |

TBE GROUP, INC.
 CIVIL ENGINEERING • TRANSPORTATION • ENVIRONMENTAL
 • PLANNING • UTILITY ENGINEERING/LOCATING
 SOUTHERN REGION: FL, GA, SC, NC
 NORTHERN REGION: IL, IN, MI, OH, MD, NJ, NY
 PA, VA, CANADA
 WESTERN REGION: AZ, NV, NM, TX, CA, OR, UT, WA
 SUE Quality Level "A & B" Completed On : 2/27/02
 Prepared By: JAC QA/QC By: SLJ
 TBE Project No: IN09500411

Utilities shown on these plans as depicted in the legend have been investigated by TBE Group, Inc in accordance with SUE Industry Standards as of 2/27/02.
 All other information shown has been provided to TBE Group, Inc by others.

US
 CONSULTANTS, INC.
 8415 East 56th Street
 Indianapolis, Indiana 46218

| REVISIONS | | INDIANA DEPARTMENT OF TRANSPORTATION |
|-----------|------|--------------------------------------|
| NAME | DATE | |
| | | I-80 / 94 |
| | | |
| | | |
| | | |
| | | |

SCALE: 1" = 30'
 DATE: DRAWN BY: CHECKED BY:

\\s01500411-01\T\hammond.rws 07/06/2004 09:12:28 AM