

F.A.I. RTE.	SECTION	COUNTY	TOTAL SHEETS	SHEET NO.
80/94	2626.1-R-1	COOK	452	144
STA.		TO STA.		
FED. ROAD DIST. NO.		ILLINOIS FED. AID PROJECT		
CONTRACT # 62113		INDOT Des. No. 0100987		

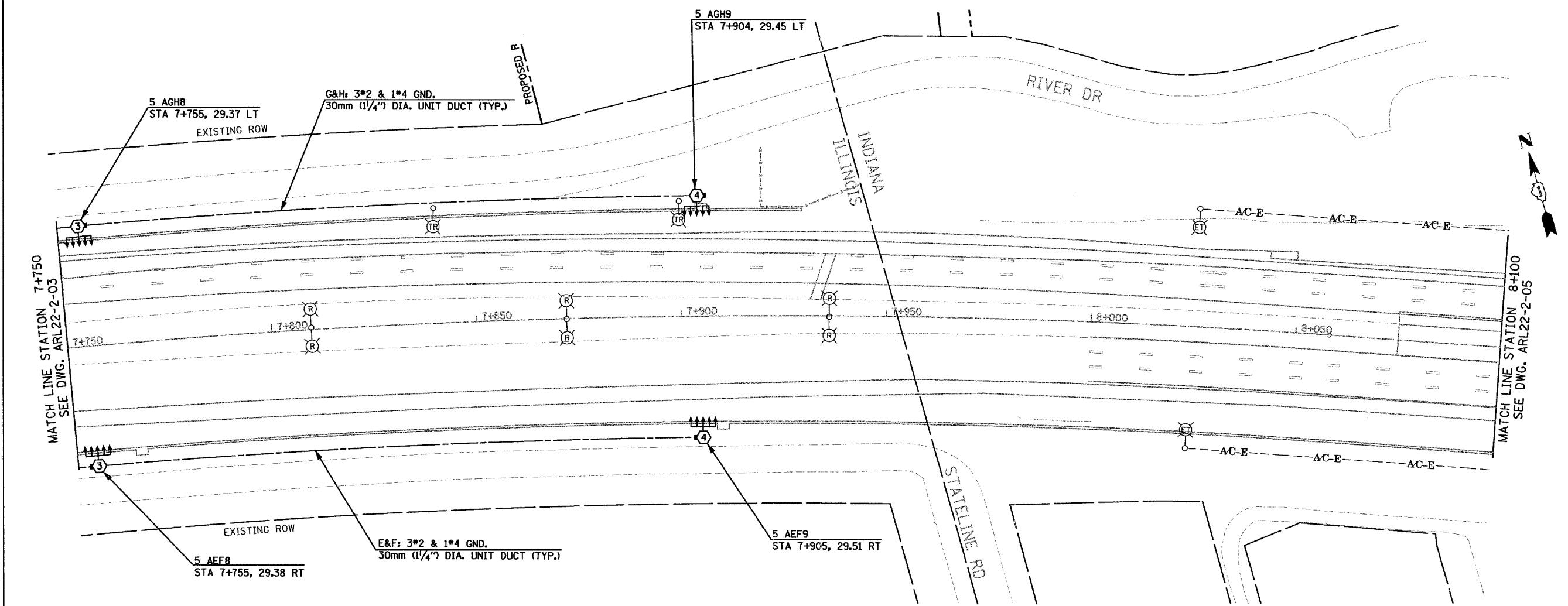

MATCH LINE STATION 7+750
SEE DWG. ARL22-2-03

MATCH LINE STATION 8+100
SEE DWG. ARL22-2-05

FOR REFERENCE ONLY-PROPOSED CONDITIONS 30 SEP 2005

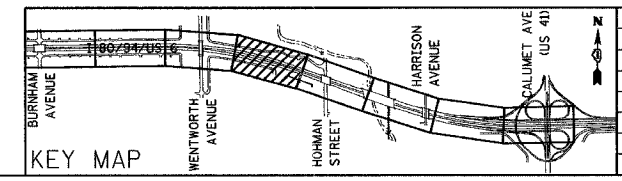

REVISIONS	
NAME	DATE
New Sheet	10/1/04

ARL22-2-04

ILLINOIS DEPARTMENT OF TRANSPORTATION
I-80/94/US 6
KINGERY-BORMAN EXPRESSWAY
BURNHAM ROAD TO US 41
INTERIM LIGHTING 2 PLAN
I-80/94/US-6
STA. 7+750 TO STA. 8+100

SCALE 1:500
DATE 12/17/03

DRAWN BY EAO/BC
CHECKED BY PKG/BC

\\projects\projects\2003\1-80-94\ARL22-04\info\sheet_for_ace\14220041.rvt
13 OCT 2004
15:25:54