

F.A.I. RTE.	SECTION	COUNTY	TOTAL SHEETS	SHEET NO.
80/94	2626.1-R-1	COOK	452	144n
STA.		TO STA.		
FED. ROAD DIST. NO.		ILLINOIS FED. AID PROJECT		
CONTRACT # 62113		INDOT Des. No. 0100987		

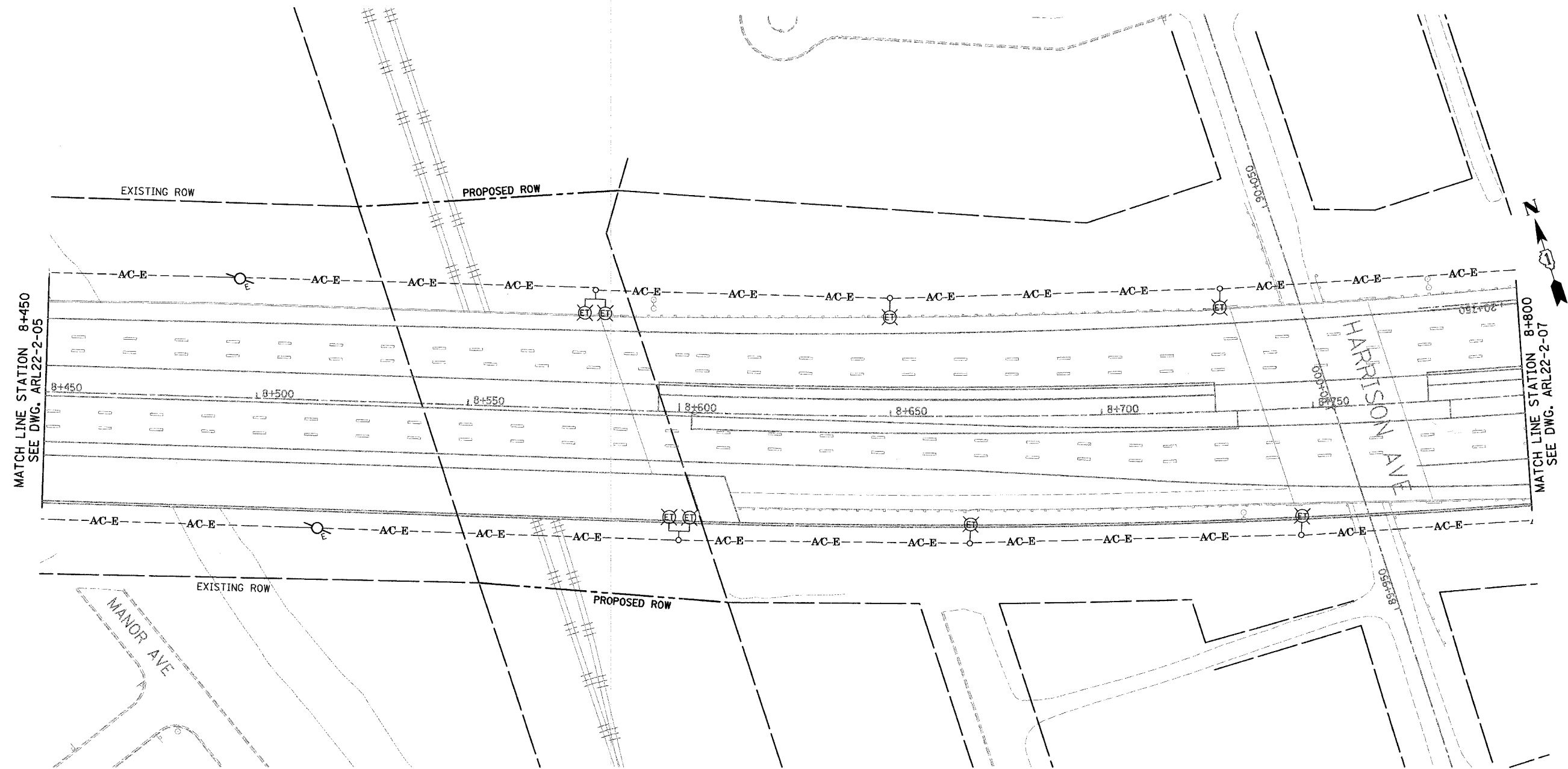

MATCH LINE STATION 8+450
SEE DWG. ARL22-2-05

MATCH LINE STATION 8+800
SEE DWG. ARL22-2-07

FOR REFERENCE ONLY-PROPOSED CONDITIONS 30 SEP 2005

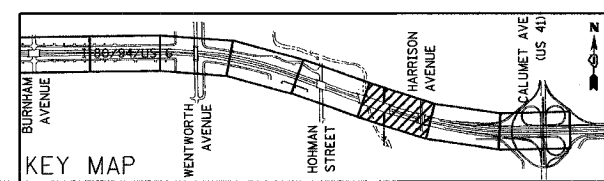

REVISIONS	
NAME	DATE
▲ New Sheet	10/1/04

ARL22- 2-06

ILLINOIS DEPARTMENT OF TRANSPORTATION
I-80/94/US 6
KINGERY-BORMAN EXPRESSWAY
BURNHAM ROAD TO US 41
INTERIM LIGHTING 2 PLAN
I-80 /94 /US-6
STA. 8 + 450 TO STA. 8 + 800
SCALE 1:500 DRAWN BY EA0/BC
DATE 12/17/03 CHECKED BY PKG/BC

GANDHI AND ASSOCIATES, INC.
ENGINEERS AND PLANNERS
500 N. NORTHWEST HWY
SUITE 300
CHICAGO, ILLINOIS 60610 TEL: 773-374-5900