

F.A.I. RTE.	SECTION	COUNTY	TOTAL SHEETS	SHEET NO.
80/94	2626.1-R-1	COOK	452	144b
STA.		TO STA.		
FED. ROAD DIST. NO.		ILLINOIS	FED. AID PROJECT	
CONTRACT # 62113		INDOT Des. No. 0100987		

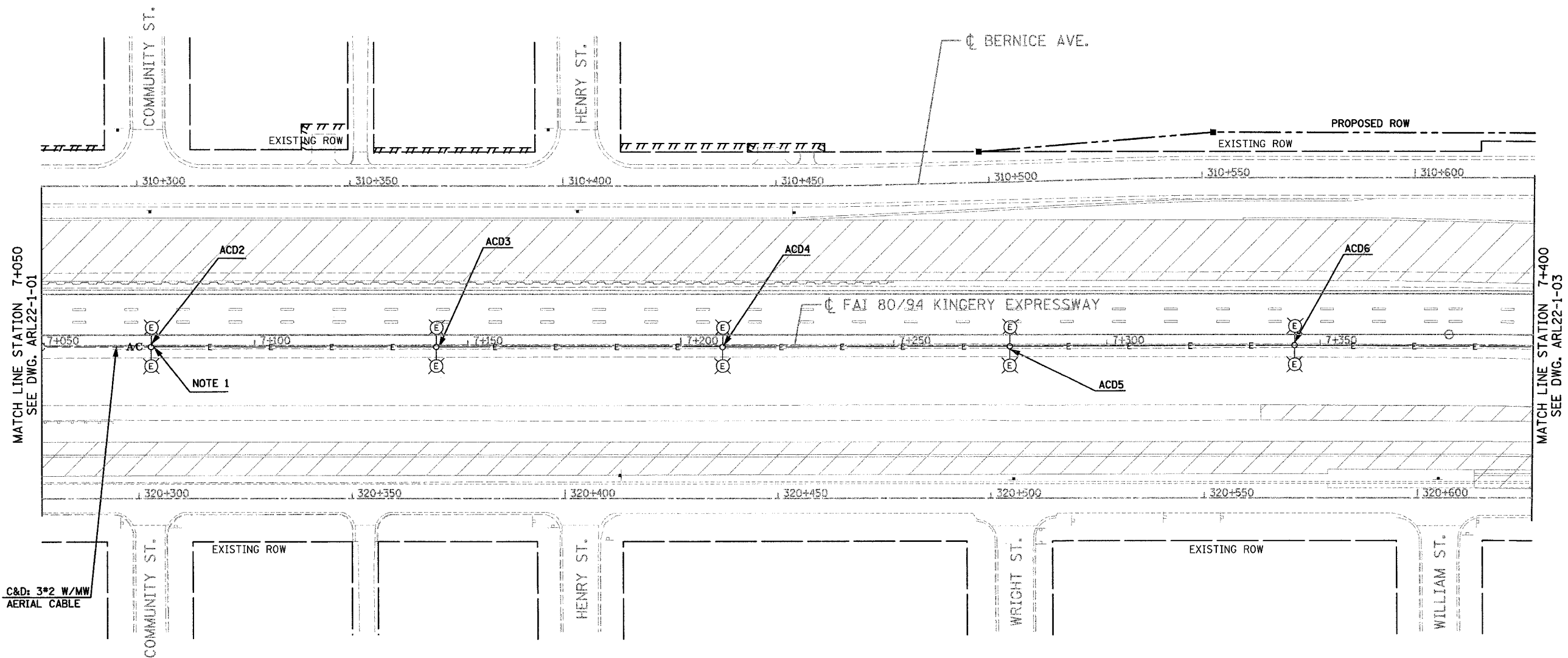

MATCH LINE STATION 7+050
SEE DWG. ARL22-1-01

MATCH LINE STATION 7+400
SEE DWG. ARL22-1-03

C&D: 3*2 W/MW
AERIAL CABLE

NOTE 1. SEE DETAIL AT DRAWING NO. ADL22-01
FOR TEMPORARY AERIAL CABLE CONNECTION TO
EXISTING LIGHT POLE.

FOR REFERENCE ONLY-EXISTING CONDITIONS 18 FEB 2005

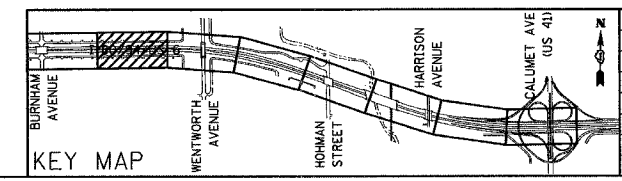

REVISIONS	
NAME	DATE
New Sheet	10/1/04

ARL22- 1-02

ILLINOIS DEPARTMENT OF TRANSPORTATION
I-80/94/US 6
KINGERY-BORMAN EXPRESSWAY
BURNHAM ROAD TO US 41
INTERIM LIGHTING 1 PLAN
I-80 /94 /US-6
STA. 7 +050 TO STA. 7 +400
SCALE 1:500 DRAWN BY EA0/BC
DATE 12/17/03 CHECKED BY PKG/BC

GO GANDHI AND ASSOCIATES, INC.
ENGINEERS AND PLANNERS
1005 N. WESTWIND HWY
SUITE 300
CHICAGO, ILLINOIS 60631 TEL: 773/714-5900