

F.A.I. RTE.	SECTION	COUNTY	TOTAL SHEETS	SHEET NO.
80/94	2626.1-R-1	COOK	452	144d
STA.		TO STA.		
FED. ROAD DIST. NO.		ILLINOIS FED. AID PROJECT		
CONTRACT # 62113		INDOT Des. No. 0100987		

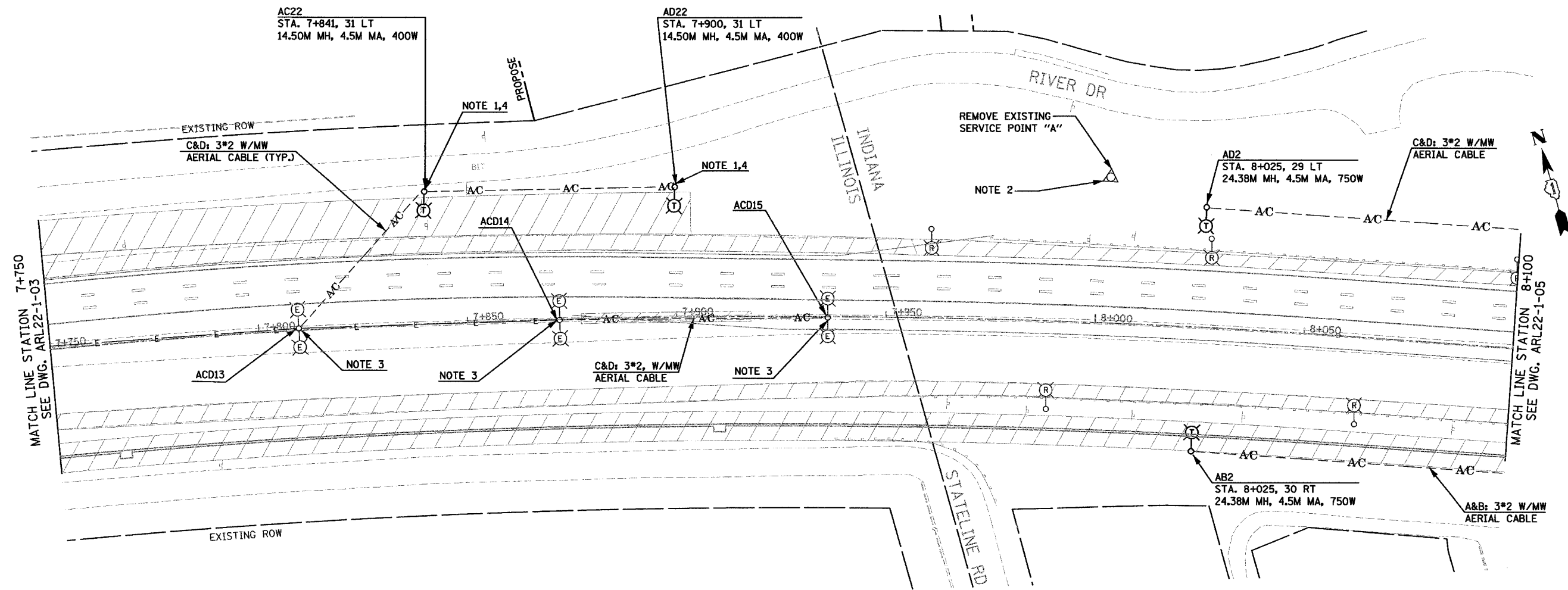

- NOTE 1. INSTALLING THESE WOOD POLES IS NOT PART OF THE INTERIM LIGHTING 1 COMPLETION DATE WORK. THESE WOOD POLES MUST BE INSTALLED PRIOR TO STAGE 2 CONSTRUCTION (JUNE 2005) TO HAVE ADEQUATE LIGHTING WHEN THE LANES ARE SHIFTED TOWARDS THE NORTH.
- NOTE 2. THE CONTRACTOR SHALL REMOVE AND DELIVER THE EXISTING CABINET IN THE INDIANA PORTION OF THE PROJECT TO THE INDOT LAPORTE DISTRICT, AS DIRECTED BY THE ENGINEER.
- NOTE 3. SEE DETAIL AT DRAWING NO. ADL22-01 FOR TEMPORARY AERIAL CABLE CONNECTION TO EXISTING LIGHT POLE.
- NOTE 4. INSTALL 18.3M WOOD POLE.

NOTE:
ALL TEMPORARY LIGHTING POLES IN INDIANA ARE 30.48M WOOD POLES UNLESS OTHERWISE NOTED.

FOR REFERENCE ONLY-EXISTING CONDITIONS 18 FEB 2005

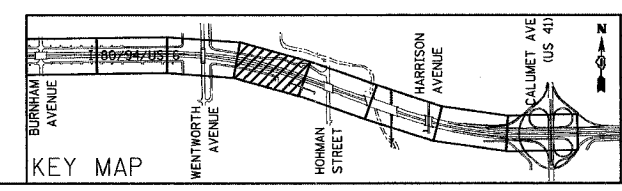

REVISIONS	
NAME	DATE
New Sheet	10/1/04

ARL22- 1-04

ILLINOIS DEPARTMENT OF TRANSPORTATION
I-80/94/US 6
KINGERY-BORMAN EXPRESSWAY
BURNHAM ROAD TO US 41
INTERIM LIGHTING 1 PLAN
I-80 /94 /US-6
STA. 7 + 750 TO STA. 8 + 100

SCALE 1:500 DRAWN BY EA0/BC
DATE 12/17/03 CHECKED BY PKG/BC

GO GANDHI AND ASSOCIATES, INC.
ENGINEERS AND PLANNERS
1000 N. WESTWIND HIGHWAY
SUITE 300
CHICAGO, ILLINOIS 60631 TEL: 773/714-5390