

F.A.I. RTE.	SECTION	COUNTY	TOTAL SHEETS	SHEET NO.
80/94	2626.1-R-1	COOK	452	144e
STA.		TO STA.		
FED. ROAD DIST. NO.		ILLINOIS FED. AID PROJECT		
CONTRACT # 62113		INDOT Des. No. 0100987		

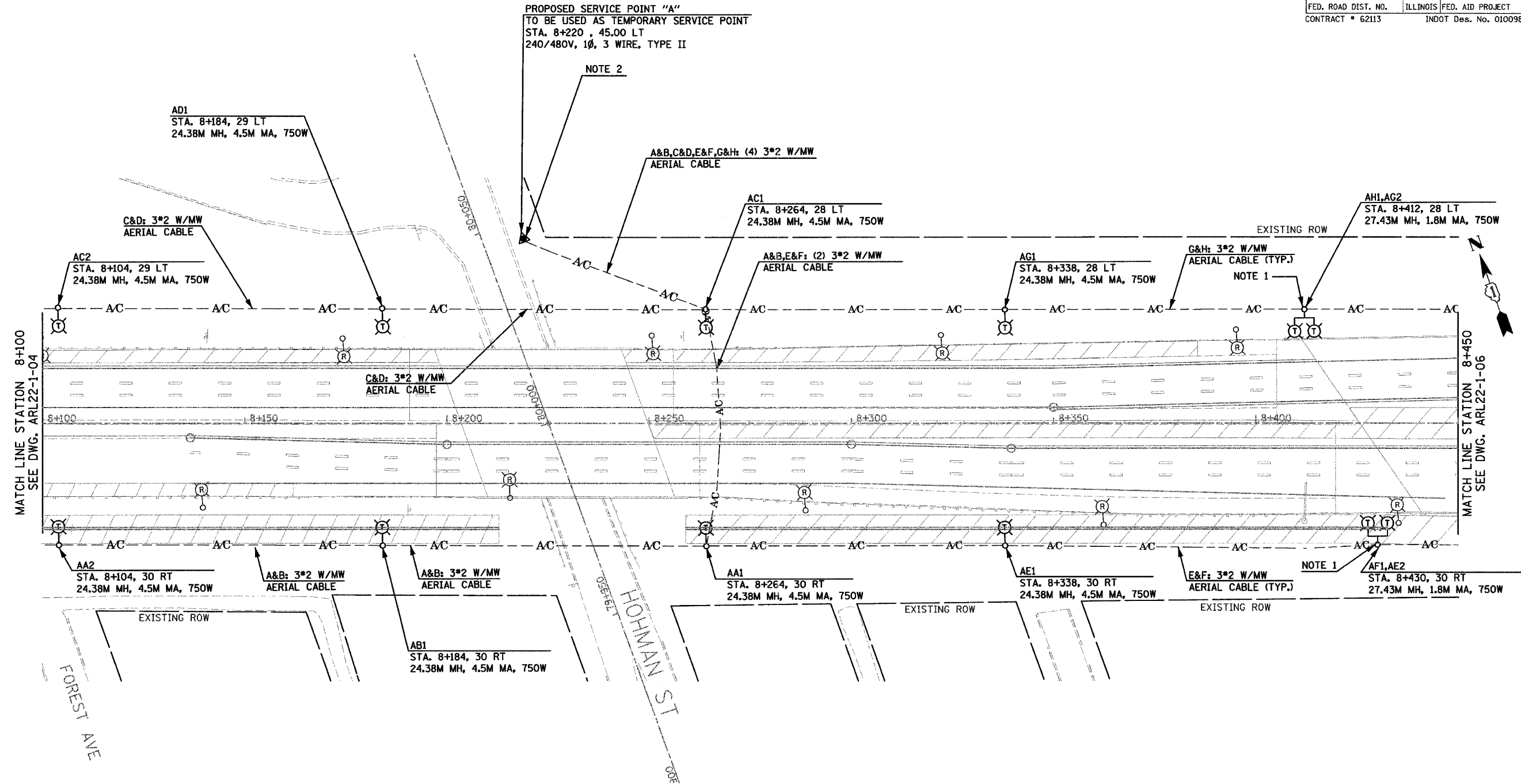

PROPOSED SERVICE POINT "A"
 TO BE USED AS TEMPORARY SERVICE POINT
 STA. 8+220 , 45.00 LT
 240/480V, 1Ø, 3 WIRE, TYPE II

NOTE 2

MATCH LINE STATION 8+100
 SEE DWG. ARL22-1-04

MATCH LINE STATION 8+450
 SEE DWG. ARL22-1-06

- NOTE 1. INSTALL 36.58M TALL WOOD POLE.
- NOTE 2. THIS PROPOSED SERVICE POINT SHALL BE INSTALLED PRIOR TO INTERIM LIGHTING-1 AND USED AS TEMPORARY SERVICE POINT UNTIL THE PROPOSED PERMANENT LIGHTING IS INSTALLED AND ENERGIZED.

NOTE:
 ALL TEMPORARY LIGHTING POLES IN INDIANA ARE 30.48M WOOD POLES UNLESS OTHERWISE NOTED.

FOR REFERENCE ONLY-EXISTING CONDITIONS 18 FEB 2005

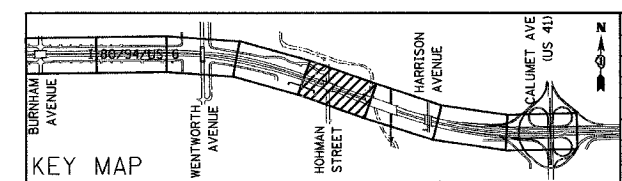

REVISIONS	
NAME	DATE
New Sheet	10/1/04

ARL22- 1-05

ILLINOIS DEPARTMENT OF TRANSPORTATION
 I-80/94/US 6
 KINGERY-BORMAN EXPRESSWAY
 BURNHAM ROAD TO US 41
 INTERIM LIGHTING 1 PLAN
 I-80 /94 /US-6
 STA. 8+100 TO STA. 8+450

SCALE 1:500
 DATE 12/17/03
 DRAWN BY EAO/BC
 CHECKED BY PKG/BC

GANDHI AND ASSOCIATES, INC.
 ENGINEERS AND PLANNERS
 500 N. WESTWIND HIGHWAY
 SUITE 300
 CHICAGO, ILLINOIS 60631 TEL: 312.737.1144 FAX: 312.737.1145