

F.A.I. RTE.	SECTION	COUNTY	TOTAL SHEETS	SHEET NO.
80/94	2626.1-R-1	COOK	452	144F
STA.		TO STA.		
FED. ROAD DIST. NO.		ILLINOIS FED. AID PROJECT		
CONTRACT # 62113		INDOT Des. No. 0100987		

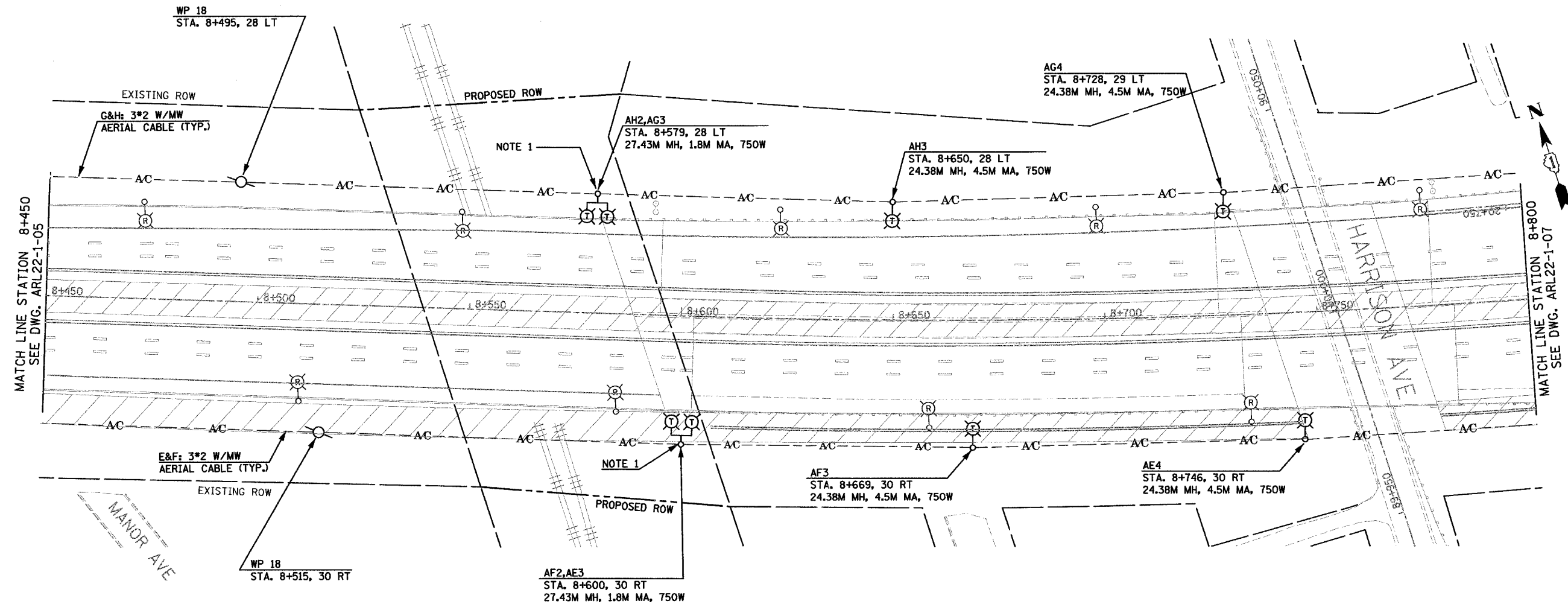

NOTE 1. INSTALL 36.58M TALL WOOD POLE.

FOR REFERENCE ONLY-EXISTING CONDITIONS 18 FEB 2005

NOTE:
ALL TEMPORARY LIGHTING POLES IN INDIANA ARE 30.48M WOOD POLES UNLESS OTHERWISE NOTED.

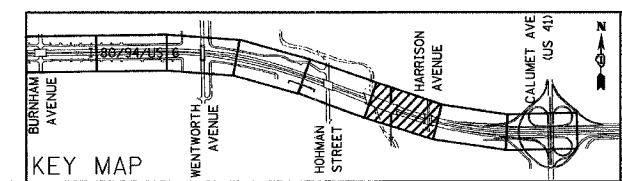

REVISIONS	
NAME	DATE
New Sheet	10/1/04

ARL22- 1-06

ILLINOIS DEPARTMENT OF TRANSPORTATION
I-80/94/US 6
KINGERY-BORMAN EXPRESSWAY
BURNHAM ROAD TO US 41
INTERIM LIGHTING 1 PLAN
I-80 /94 /US-6
STA. 8 + 450 TO STA. 8 + 800

SCALE 1:500 DRAWN BY EA0/BC
DATE 12/17/03 CHECKED BY PKG/BC

GANDHI AND ASSOCIATES, INC.
ENGINEERS AND PLANNERS
1000 N. WENTWORTH HIGHWAY
SUITE 300
CHICAGO, ILLINOIS 60614 TEL: 312/714-9980