

BAR h308(E)

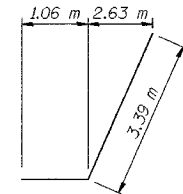

BAR h309(E)

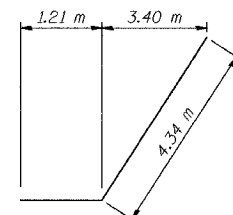

BAR h310(E)

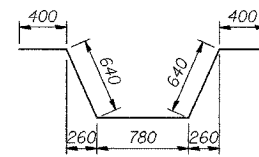

BAR h311(E)

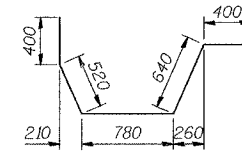

BAR h312(E)

BAR DIMENSIONS

Bar	A	B
n300(E)	3.51 m	260
n301(E)	3.51 m	400
n302(E)	3.57 m	500
n303(E)	1.22 m	260
w303(E)	1.46 m	2.06 m
w304(E)	1.46 m	-
w305(E)	1.36 m	1.92 m
w306(E)	1.36 m	-
w307(E)	1.06 m	1.50 m
w308(E)	1.06 m	-
w309(E)	1.66 m	2.35 m
w310(E)	1.66 m	-

BILL OF MATERIAL

Bar	No.	Size	Length (m)	Shape
n300(E)	704	#15	7.84	—
n301(E)	408	#15	7.10	—
n302(E)	51	#15	4.28	—
n303(E)	2	#15	1.49	—
n304(E)	35	#15	2.30	—
n305(E)	16	#15	1.10	—
n306(E)	24	#15	7.30	—
n307(E)	2	#15	5.50	—
n308(E)	104	#15	3.50	—
n309(E)	54	#15	4.45	—
n310(E)	54	#15	5.55	—
n311(E)	180	#20	2.86	—
n312(E)	4	#20	2.74	—
n313(E)	4	#15	0.90	—
n314(E)	8	#15	0.60	—
n300(E)	603	#15	3.77	—
n301(E)	1108	#25	3.91	—
n302(E)	53	#30	4.07	—
n303(E)	76	#15	1.48	—
t300(E)	696	#25	4.00	—
t301(E)	617	#20	4.00	—
t302(E)	43	#30	5.84	—
t303(E)	31	#20	5.84	—
t304(E)	54	#25	4.60	—
t305(E)	50	#20	4.60	—
t306(E)	58	#20	2.80	—
v300(E)	250	#15	5.33	—
v301(E)	490	#20	4.34	—
v302(E)	37	#15	4.98	—
v303(E)	53	#25	5.60	—
v304(E)	316	#15	4.93	—
v305(E)	618	#20	3.93	—
v306(E)	566	#20	1.99	—
v307(E)	276	#20	2.47	—
v308(E)	24	#15	3.44	—
v309(E)	26	#15	4.74	—
w300(E)	518	#15	7.84	—
w301(E)	150	#15	10.01	—
w302(E)	12	#15	7.10	—
w303(E)	15	#15	3.34	—
w304(E)	15	#15	2.92	—
w305(E)	15	#15	3.20	—
w306(E)	15	#15	2.72	—
w307(E)	45	#15	2.78	—
w308(E)	45	#15	2.12	—
w309(E)	15	#15	3.63	—
w310(E)	15	#15	3.32	—
w311(E)	44	#15	3.97	—
Test Pile, 356 mm	Each		4	
Excavation, Foundation, Unclassified	m ³		3,336	
Concrete, A, Substructure	m ³		1261.8	
Reinforcing Bars, Epoxy Coated	kg		90,300	
Surface Seal (Estimated)	m ²		268	
Pile, Concrete, Steel Shell Encased, 6.35 mm, 356 mm	m		5,776.0	
Geocomposite Wall Drain	m ²		935	
Pipe, Underdrain, Perf., 163 mm, 150 mm	m		189.0	
Noise Abatement Wall Anchor Rod Assembly	Each		52	

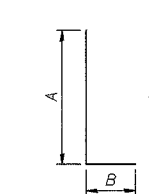

BARS n300(E) thru n303(E)

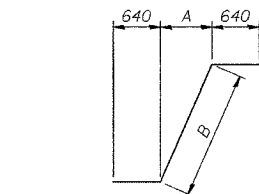

BARS w303(E), w305(E), w307(E) or w309(E)

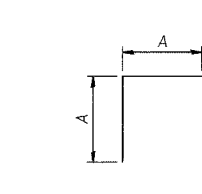

BARS w304(E), w306(E), w308(E) or w310(E)

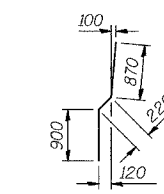

BARS v306(E)

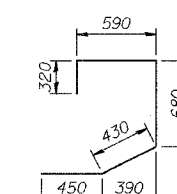

BAR v307(E)

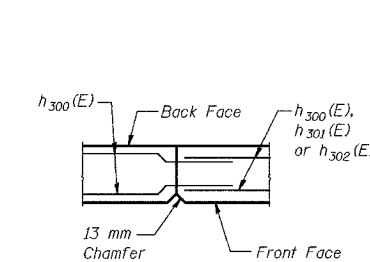

CONSTRUCTION JOINT DETAIL

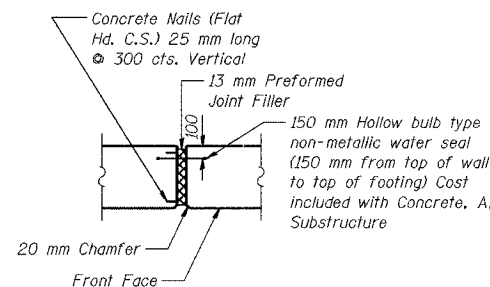

13 MM EXPANSION JOINT DETAIL

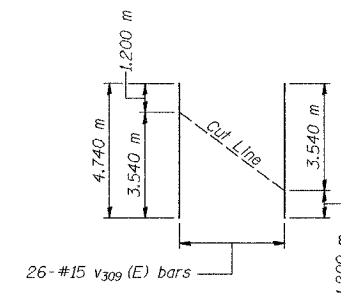

FIELD CUTTING DIAGRAM

Order v309(E) bars full length. Cut as shown and use remainder of bars in opposite face.

NOTES:

- See Sheet S-11 for Wall and Parapet Sections and Anchor Rod Assembly Details
- See Sheet S-13 for Rustication details.
- Reinforcement bars designated (E) shall be epoxy coated.
- All dimensions are in millimeters (mm) except as noted.
- See Typical Section on Sheet S-2 for Drainage Details and Surface Seal Limits.

DESIGNED	MJW
CHECKED	KFA
DRAWN	MJB
CHECKED	GSP

ILLINOIS DEPARTMENT OF TRANSPORTATION
 I-80/94/US 6
 KINGERY-BORMAN EXPRESSWAY
 BURNHAM ROAD TO US 41

WALL SECTIONS AND DETAILS
SECTION 2626.2-R-1
LAKE COUNTY, INDIANA
STATION 8+268.572 TO STATION 8+445.954
STRUCTURE NO. 016-W857

DATE 07/04

AMERICAN
 CONSULTING ENGINEERS