

# LOCATION MAP 1A

DOUGLAS CO.  
F.A.I. 57

**CURRENT ADT**

FUNCTIONAL CLASSIFICATION: INTERSTATE  
FAI 57 (I-57)

LEG "A" ADT(2014) = 18,500 SU=5.0% MU=35.7%

STATION EQUATION:  
STA. 791 + 00.00 (BK) =  
STA. 791 + 02.17 (AH)

STATION EQUATION:  
STA. 736 + 24.61 (BK) =  
STA. 736 + 26.44 (AH)

STATION EQUATION:  
STA. 687 + 00.00 (BK) =  
STA. 687 + 03.30 (AH)

STATION EQUATION:  
STA. 575 + 43.68 (BK) =  
STA. 575 + 43.98 (AH)

STATION EQUATION:  
STA. 547 + 00.00 (BK) =  
STA. 547 + 01.25 (AH)

STATION EQUATION:  
STA. 360 + 83.33 (BK) =  
STA. 360 + 87.35 (AH)

STATION EQUATION:  
STA. 1510 + 00.00 (BK) =  
STA. 117 + 23.47 (AH)

DOUGLAS /CHAMPAIGN CO. LINE  
STA. 848 + 62.49

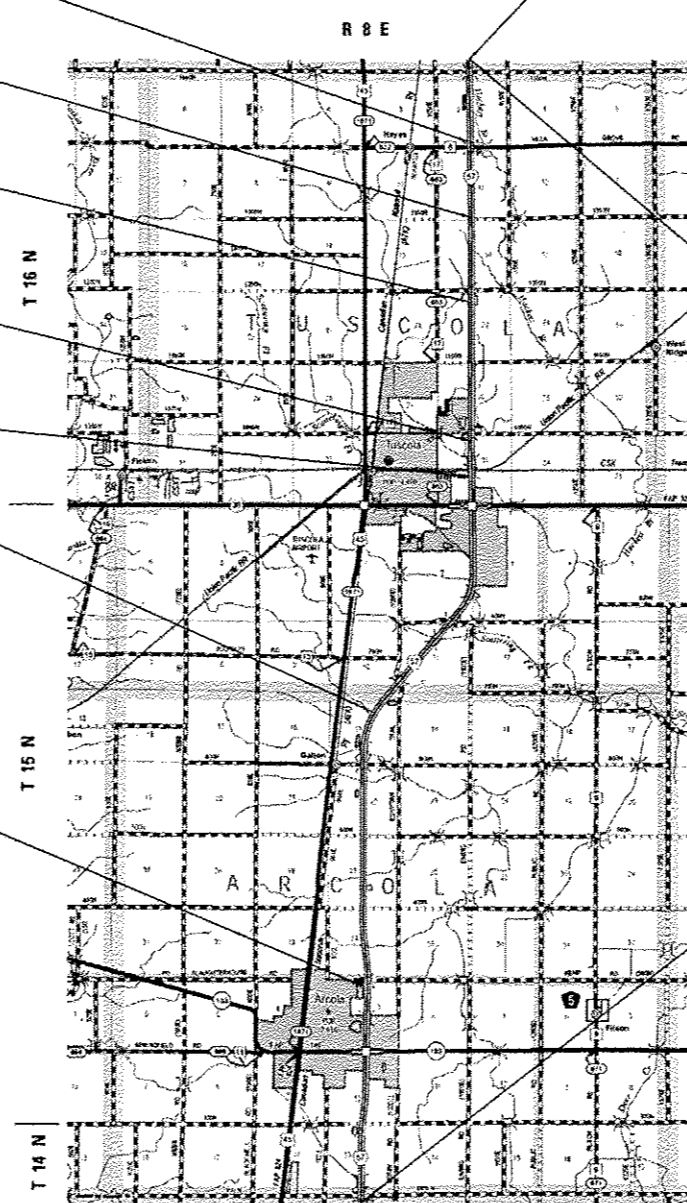

BEGIN SECTION  
DOUGLAS /COLES CO. LINE  
STA. 1386 + 91.00



GROSS LENGTH = 85,435.15 FT. = 16.181 MILE  
NET LENGTH = 85,435.15 FT. = 16.181 MILE

TOWNSHIPS	
TUSCOLA	
ARCOLA	

REVISOR SHEET 2-26-16

FILE NAME -	USER NAME - piersorb	DESIGNED -	REVISED -	STATE OF ILLINOIS DEPARTMENT OF TRANSPORTATION	LOCATION MAP 1A		F.A. RTE.	SECTION	COUNTY	TOTAL SHEETS	SHEET NO.	
par\1084EBID\INTEG\Illinois.gov\PI\DOT\Documents\DOT Offices\District 5\Projects\057\DRAWING\DATA\EA\Sheets\057B044-sh1-Location Map 1A.dwg		DRAWN -	REVISED -		SCALE:	SHEET 1 OF 3 SHEETS	STA. TO STA.	VAR.	D5 CM PATCHING 2016-5	*	20	3
#MODELNAME#	PLT SCALE = 40.0000 1/2 in.	CHECKED -	REVISED -							CONTRACT NO. 70B44		
	PLT DATE = 2/26/2016	DATE -	REVISED -							ILLINOIS FED. AID PROJECT		

• CHAMPAIGN, DOUGLAS

# LOCATION MAP 1B

CHAMPAIGN CO.  
F.A.I. 57

**CURRENT ADT**  
FUNCTIONAL CLASSIFICATION: INTERSTATE  
FAI 57 (I-57)

LEG "A" ADT(2014) = 18,500	SU=5.0% MU=35.7%
LEG "B" ADT(2014) = 21,400	SU=4.8% MU=28.5%
LEG "C" ADT(2014) = 24,200	SU=4.3% MU=26.0%
LEG "D" ADT(2014) = 32,400	SU=6.2% MU=25.6%
LEG "E" ADT(2014) = 22,200	SU=3.9% MU=24.0%

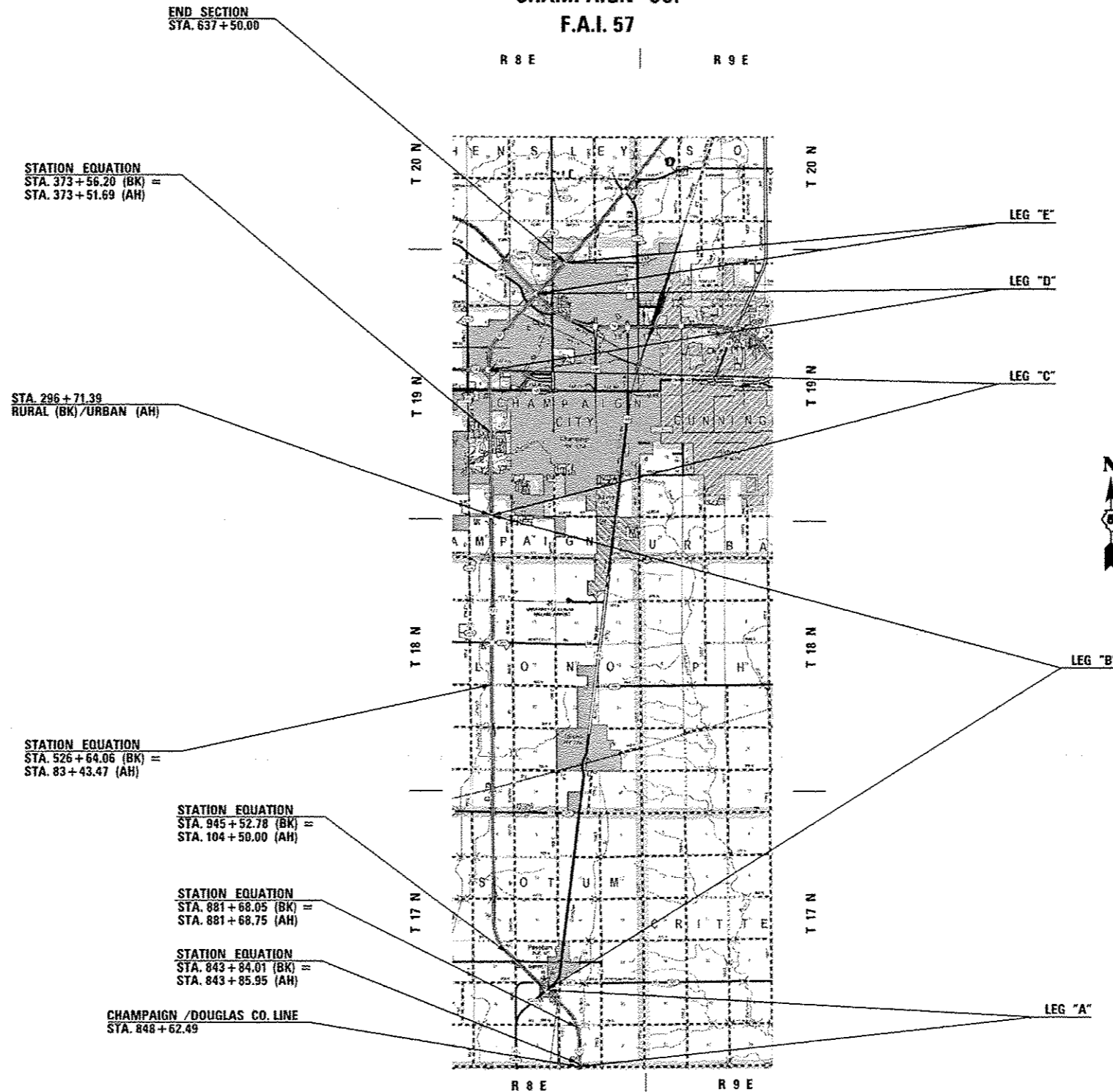

GROSS LENGTH = 108,269.71 FT. = 20.506 MILE  
NET LENGTH = 108,269.71 FT. = 20.506 MILE

TOWNSHIPS	
PESOTUM	
TOLONO	
CHAMPAIGN	
HENSLEY	

△ REVISED SHEET 2-20-10

FILE NAME :	USER NAME :	DESIGNED :	REVISED :	<b>STATE OF ILLINOIS DEPARTMENT OF TRANSPORTATION</b>	<b>LOCATION MAP 1B</b>	F.A. RTE.	SECTION	COUNTY	TOTAL SHEETS	SHEET NO.	
p:\11084EBID\INTEG\Illinois.gov\PIDOT\Docu...	Documents\DOT Offices\District 5\Projects\057...	DRAWN :	REVISED :			VAR.	05 CM PATCHING 2016-5	*	20	4	
MODEL NAME :	PLD1 SCALE : 48,000 1" = 1 mi.	CHECKED :	REVISED :			CONTRACT NO. 70B44					
	PLOT DATE : 2/26/2016	DATE :	REVISED :			ILLINOIS FED. AID PROJECT					

# LOCATION MAP 2

CHAMPAIGN CO.  
F.A.I. 72

## CURRENT ADT

FUNCTIONAL CLASSIFICATION: INTERSTATE  
FAI 72 (I-72)

LEG "A" ADT (2015) = 14,800 SU = 3.2% MU = 15.2%  
LEG "B" ADT (2015) = 15,100 SU = 3.8% MU = 15.0%

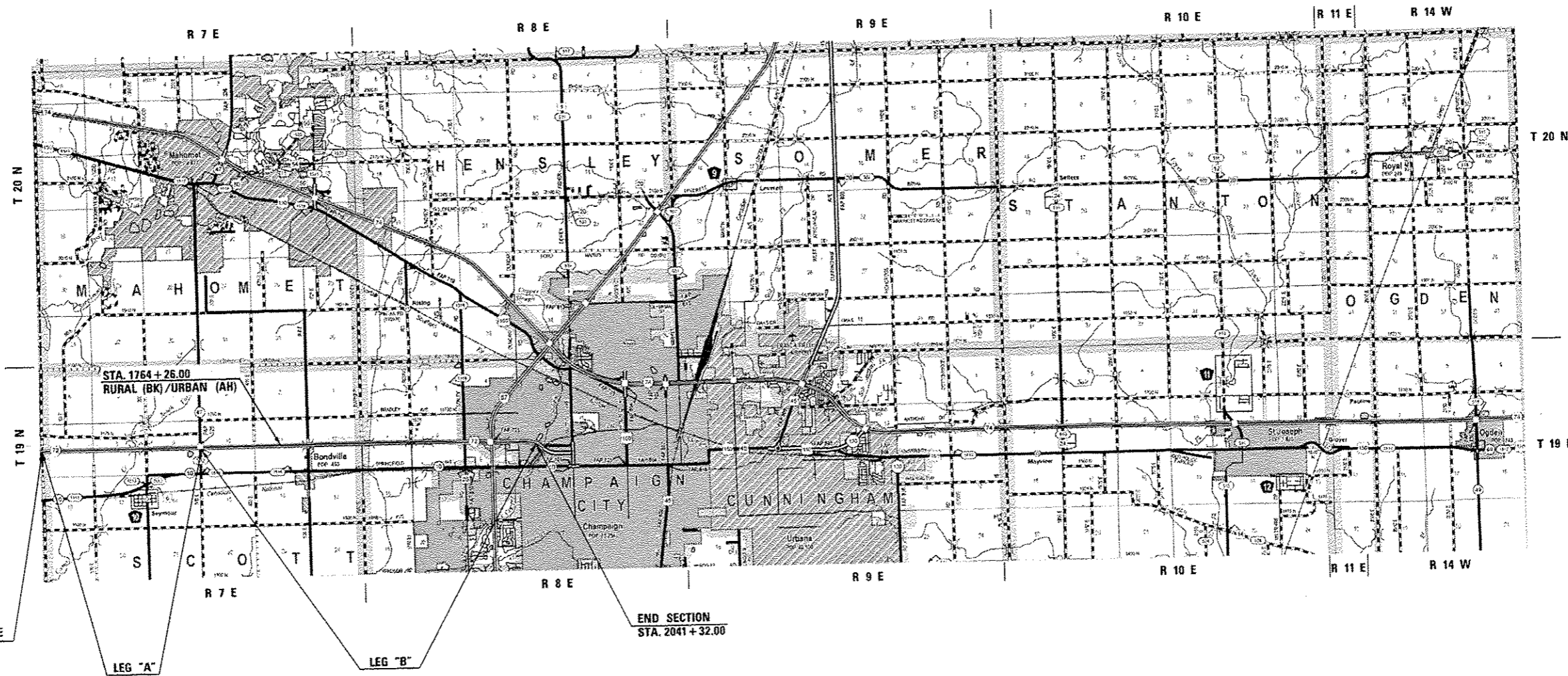

PIATT / CHAMPAIGN CO. LINE  
STA. 1518 + 02.71

END SECTION  
STA. 2041 + 32.00

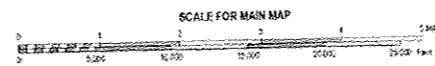

### F.A.I. 72 (I-72)

GROSS LENGTH = 52,329.29 FT. = 9.911 MILE  
NET LENGTH = 52,329.29 FT. = 9.911 MILE

TOWNSHIPS	
CHAMPAIGN	SCOTT

▲ REVISED SHEET 2-26-16

• CHAMPAIGN, DOUGLAS

I-72 CHAMPAIGN

FILE NAME *	USER NAME *	DESIGNED -	REVISED -	STATE OF ILLINOIS DEPARTMENT OF TRANSPORTATION	LOCATION MAP 2		F.A. RTE. VAR.	SECTION	COUNTY	TOTAL SHEETS	SHEET NO.
	PILOT SCALE *	CHECKED -	REVISED -		SCALE:	SHEET 3 OF 3 SHEETS		STA. TO STA.	D5 CM PATCHING 2016-5	*	20
#MODELNAME*	PILOT DATE *	DATE -	REVISED -				ILLINOIS FED. AID PROJECT				

CONTRACT NO. 70B44

LOCATION OF WORK:

FAI 57	FAI 57	FAI 57	FAI 72	FAI 72
RURAL	RURAL	URBAN	RURAL	URBAN
INTERSTATE	INTERSTATE	INTERSTATE	INTERSTATE	INTERSTATE
DOUGLAS CO.	CHAMPAIGN CO.	CHAMPAIGN CO.	CHAMPAIGN CO.	CHAMPAIGN CO.
100% STATE	100% STATE	100% STATE	100% STATE	100% STATE

CONSTRUCTION TYPE CODE:

0005	0005	0005	0005	0005
------	------	------	------	------

CODE NO	ITEM	UNIT	TOTAL QUANTITY						
44213100	PAVEMENT FABRIC	SQ YD	94.0			47.0		47.0	
44200629	CLASS A PATCHES, TYPE I, 15 INCH	SQ YD	56.0	32.0		8.0		8.0	8.0
44200630	CLASS A PATCHES, TYPE II, 15 INCH	SQ YD	232.0	160.0		40.0		16.0	16.0
44200631	CLASS A PATCHES, TYPE III, 15 INCH	SQ YD	160.0	100.0		20.0		20.0	20.0
44200632	CLASS A PATCHES, TYPE IV, 15 INCH	SQ YD	80.0	53.0		27.0			
44201031	CLASS B PATCHES, TYPE II, 15 INCH	SQ YD	40.0			40.0			
44201035	CLASS B PATCHES, TYPE III, 15 INCH	SQ YD	20.0			20.0			
44201037	CLASS B PATCHES, TYPE IV, 15 INCH	SQ YD	27.0			27.0			
44201043	CLASS B PATCHES, TYPE II, 16 INCH	SQ YD	40.0					40.0	
44201047	CLASS B PATCHES, TYPE III, 16 INCH	SQ YD	20.0					20.0	
44201048	CLASS B PATCHES, TYPE IV, 16 INCH	SQ YD	27.0					27.0	
44201299	DOWEL BARS 1 1/2"	EACH	300.0			150.0		150.0	
44213000	PATCHING REINFORCEMENT	SQ YD	528.0	345.0		95.0		44.0	44.0
44213200	SAW CUTS	FOOT	3,896.0	2,054.0		920.0		382.0	270.0
44213204	TIE BARS 3/4"	EACH	40.0	10.0		20.0		10.0	

⚠️ REVISED SHEET 2-26-16

\* CHAMPAIGN, DOUGLAS

FILE NAME *	USER NAME * ceerlock_d	DESIGNED -	REVISED -	<b>STATE OF ILLINOIS DEPARTMENT OF TRANSPORTATION</b>	<b>SUMMARY OF QUANTITIES</b>			F.A. RTE.	SECTION	COUNTY	TOTAL SHEETS	SHEET NO.	
p:\11\2084EBID\INTEG\illinois.gov\PIDOT\Documents\DOT Offices\District 5\Projects\0578\DRAWINGData\EAD\Sheets\0578B44-3nt-500.d	PLOT SCALE = 48,0000 "/>												
MODEL NAME *	PLOT DATE = 12/22/2015	CHECKED -	REVISED -		SCALE:	SHEET 1 OF 2 SHEETS	STA.	TO STA.	VAR.	D5 CM PATCHING 2016-5	*	20	6
											CONTRACT NO. 70B44		

ILLINOIS FED. AID PROJECT

LOCATION OF WORK:

FAI 57	FAI 57	FAI 57	FAI 72	FAI 72
RURAL	RURAL	URBAN	RURAL	URBAN
INTERSTATE	INTERSTATE	INTERSTATE	INTERSTATE	INTERSTATE
DOUGLAS CO.	CHAMPAIGN CO.	CHAMPAIGN CO.	CHAMPAIGN CO.	CHAMPAIGN CO.
100% STATE	100% STATE	100% STATE	100% STATE	100% STATE

CONSTRUCTION TYPE CODE:

0005	0005	0005	0005	0005
------	------	------	------	------

CODE NO	ITEM	UNIT	TOTAL				
			QUANTITY				
67100100	MOBILIZATION	LSUM	1.0	0.2	0.2	0.2	0.2
70100420	TRAFFIC CONTROL AND PROTECTION, STANDARD 701411	EACH	3.0	1.0		1.0	1.0
70100800	TRAFFIC CONTROL AND PROTECTION, STANDARD 701401	LSUM	1.0	0.2	0.2	0.2	0.2
70103815	TRAFFIC CONTROL SURVEILLANCE	CAL DA	12.0	4.0	2.0	2.0	2.0
X7010410	SPEED DISPLAY TRAILER	CAL MO	1.0	0.2	0.2	0.2	0.2
X7015005	CHANGEABLE MESSAGE SIGN	CAL DA	28.0	7.0	3.0	4.0	7.0

6

⚠ REVISÉD SHEET 2-26-16

• CHAMPAIGN, DOUGLAS

FILE NAME =	USER NAME = cea-lock_d	DESIGNED -	REVISÉD -	<b>STATE OF ILLINOIS DEPARTMENT OF TRANSPORTATION</b>	<b>SUMMARY OF QUANTITIES</b>	F.A. RTE.	SECTION	COUNTY	TOTAL SHEETS	SHEET NO.
p:\11\28458\INTEG\illness.gov\PI\DOT\Documents\DOT Offices\District 5\Projects\DS7\DRAN\Drawings\MEAD\Drawings\DS72B44-aht-500.d	PLÓT SCALE = 48.8888 ' / 1"	CHECKED -	REVISÉD -			VAR.	D5 CM PATCHING 2016-5	*	20	7
#MODELNAME#	PLÓT DATE = 12/22/2015	DATE -	REVISÉD -			SCALE:	SHEET 2 OF 2 SHEETS	STA.	TO STA.	CONTRACT NO. 70B44
						ILLINOIS FED. AID PROJECT				