











INDEX OF SHEETS

SHEET NO.	SHEET TITLE
1	COVER SHEET
2	SUMMARY, SCHEDULE OF QUANTITIES, STANDARDS, & GENERAL NOTES
3	TYPICAL SECTIONS AND DETAILS
4	WALKWAY PLAN AND PROFILE STA. 40+00 - 46+00
5	WALKWAY PLAN AND PROFILE STA. 46+00 - 51+00
6	SITE MANAGER HOUSE PLAN SHEET

LEGEND

-  PROPOSED PARKING LOT
-  EXISTING PAVED DITCH
-  EXISTING FENCE
-  EXISTING LIGHT POLE
-  EXISTING SIGN
-  EXISTING MANHOLE
-  EXISTING CATCH BASIN
-  EXISTING DECIDUOUS TREE
-  PROPOSED SWALE
-  PROPOSED DIRECTION OF FLOW
-  PROPOSED PAVEMENT ELEVATION

PROPOSED IMPROVEMENTS

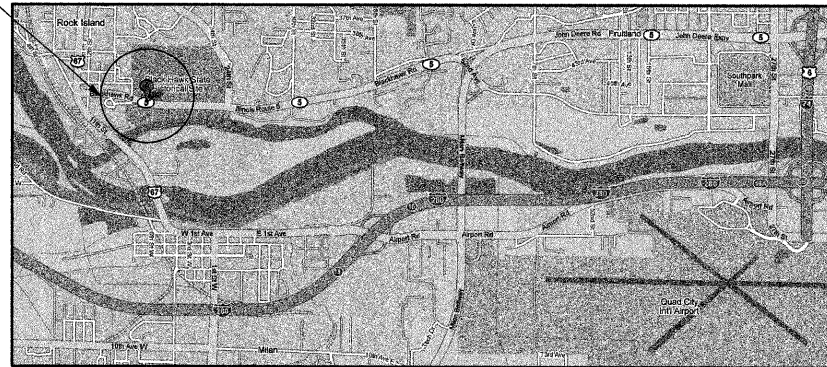

STATE OF ILLINOIS
DEPARTMENT OF TRANSPORTATION
DIVISION OF HIGHWAYS
PROPOSED
HIGHWAY PLANS
IDOT / IHPA STATEWIDE
BLACKHAWK STATE HISTORIC SITE
RESURFACING DRIVES & PATHS
ROCK ISLAND COUNTY
C-30-003-10

F.A. RTE.	SECTION	COUNTY	TOTAL SHEETS	SHEET NO.
		ROCK ISLAND	6	1
FED. ROAD DIST. NO.		ILLINOIS CONTRACT NO. 46070		



LOCATION OF SECTION INDICATED THUS: 

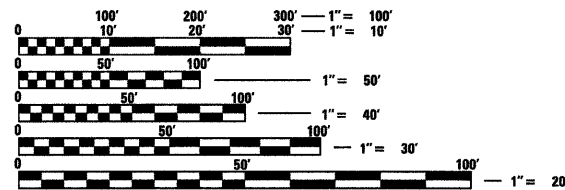

FULL SIZE PLANS HAVE BEEN PREPARED USING STANDARD ENGINEERING SCALES. REDUCED SIZED PLANS WILL NOT CONFORM TO STANDARD SCALES. IN MAKING MEASUREMENTS ON REDUCED PLANS, THE ABOVE SCALES MAY BE USED.

J.U.L.I.E.
 JOINT UTILITY LOCATION INFORMATION FOR EXCAVATION
 1-800-892-0123
 OR 811

PROJECT ENGINEER
PROJECT MANAGER

CONTRACT NO. 46070

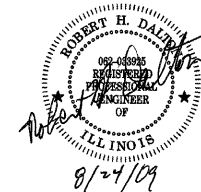

STATE OF ILLINOIS
DEPARTMENT OF TRANSPORTATION
DIVISION OF HIGHWAYS
 SUBMITTED December 2, 2009
William R. Freck
 DEPUTY DIRECTOR OF HIGHWAYS, REGION ENGINEER
January 09, 2010
Scott E. Skiff P.E./a
 ACTIVE ENGINEER OF DESIGN AND ENVIRONMENT
January 09, 2010
Christine M. Reed/a
 DIRECTOR OF HIGHWAYS, CHIEF ENGINEER

PRINTED BY THE AUTHORITY OF THE STATE OF ILLINOIS

JOB NO. 250-061-P VASCONCELLES ENGINEERING CORP. DESIGN FIRM REGISTRATION NUMBER 184-002107

SUMMARY OF QUANTITIES			100% STATE TOTAL
CODE #	PAY ITEM	UNITS	TOTAL
20200600	EXCAVATING AND GRADING EXISTING SHOULDER	UNIT	0.5
21101600	TOPSOIL FURNISH AND PLACE, VARIABLE DEPTH	SQ YD	703
35101400	AGGREGATE BASE COURSE, TYPE B	TON	102
35102000	AGGREGATE BASE COURSE, TYPE B 8"	SQ YD	31
40600100	BITUMINOUS MATERIALS (PRIME COAT)	GALLON	211
40600982	HOT-MIX ASPHALT SURFACE REMOVAL-BUTT JOINT	SQ YD	188
40603085	HOT-MIX ASPHALT BINDER COURSE, IL-19.0, N70	TON	3
40603315	HOT-MIX ASPHALT SURFACE COURSE, ^{MIX} "C", N70	TON	45
42400200	PORTLAND CEMENT CONCRETE SIDEWALK 5 INCH	SQ FT	5,474
42400800	DETECTABLE WARNINGS	SQ FT	36
44000100	PAVEMENT REMOVAL	SQ YD	42
48101500	AGGREGATE SHOULDERS, TYPE B 6"	SQ YD	23
50900605	HANDRAIL REMOVAL	FOOT	12
*50901760	PIPE HANDRAIL	FOOT	127
*63400105	GUARD POSTS	EACH	14
67100100	MOBILIZATION	L SUM	1
*72000100	SIGN PANEL - TYPE 1	SQ FT	2
*73000100	WOOD SIGN SUPPORT	FOOT	20
X0300019	REMOVE AND REINSTALL PARKING BLOCKS	EACH	3
X0323265	REMOVE EXISTING RIPRAP	SQ YD	9
XX000061	STUMP REMOVAL	EACH	1
X0324858	EARTH EXCAVATION, SPECIAL	L SUM	1
XX007217	PAVER BLOCKS, SPECIAL	SQ FT	2350
25100900	TURF REINFORCEMENT MAT	SQ YD	5

*SPECIALTY ITEM

REMOVAL ITEMS					
LOCATION (STATION TO STATION)	STUMP REMOVAL	HMA SURF REM BUTT JT	PAVEMENT REMOVAL	HANDRAIL REMOVAL	REMOVE EXISTING RIPRAP
	(EACH)	(SQ YD)	(SQ YD)	(FOOT)	(SQ YD)
ENTIRE PROJECT STA. 40+21.64 TO STA. 40+41.67 STA. 49+36.65, 4.56' RT TO STA. 49+48.27, 2.68' RT STA. 50+80.91, 14.7' RT TO STA. 51+03.72, 14.6' RT STA. 100+42.77, 11.36' RT STA. 100+08.96, 22.12' LT TO STA. 100+45.87, 51.02' LT STA. 100+16.28, 14.97' RT TO STA. 100+67.41, 12.65' LT STA. 100+20, 27' LT STA. 101+00, 16' LT STA. 101+18.24, 5.67' LT	1	130	20	12	9
TOTAL =	1	188	42	12	9

MISCELLANEOUS ITEMS				
LOCATION (STATION TO STATION)	GUARD POSTS	PIPE HANDRAIL	SIGN PANEL T-1	WOOD SIGN SUPPORT (4X4)
	(EACH)	(FOOT)	(SQ FT)	(FOOT)
ENTIRE PROJECT STA. 47+08, LT & RT STA. 49+36, 3' LT TO STA. 49+63, 3' LT STA. 49+43, 3' RT TO STA. 49+63, 3' RT STA. 50+14, 3' LT TO STA. 50+34, 3' LT STA. 50+14, 3' RT TO STA. 50+34, 3' RT STA. 50+65, 3' LT TO STA. 50+85, 3' LT STA. 50+65, 3' RT TO STA. 50+85, 3' RT STA. 100+08.96, 22.12' LT TO STA. 100+45.87, 51.02' LT	14	127	2	20
TOTAL =	14	127	2	20

NOTE - MESSAGE ON SIGNS SHALL READ: NOT A HANDICAP ACCESSIBLE ROUTE

PAVING SCHEDULE															
LOCATION	EXC & GR EX SHOULDER	EARTH EXCAVATION SPECIAL	BIT MATLS PR CT	HMA BC "C" IL-19.0, N70	HMA SC "C" N70	AGG BASE CSE B 8	AGG BASE CSE B	AGGREGATE SHLDS B 6	PC CONC SIDEWALK 5	DETECTABLE WARNINGS	PAVER BLOCKS SPECIAL	REM REIN PARKING BLKS	TOPSOIL VAR. DEPTH	MOBILIZATION	TURF REINF. MAT
	(UNIT)	(L SUM)	(GALLONS)	(TON)	(TON)	(SQ YD)	(TON)	(SQ YD)	(SQ FT)	(SQ FT)	(SQ FT)	(FOOT)	(SY YD)	(L SUM)	(SY YD)
ENTIRE PROJECT STA. 40+21.64 TO STA. 41+76.64 STA. 40+41.32 TO STA. 40+43.32 STA. 41+76.64 TO STA. 41+96.64 STA. 41+96.64 TO STA. 46+70 STA. 46+70 TO 46+90 STA. 46+90 TO STA. 47+00 STA. 47+00 TO STA. 47+20 STA. 47+08 TO STA. 47+10 STA. 47+20 TO STA. 49+48.95 STA. 49+56.95 TO STA. 50+20.02 STA. 50+28.13 TO STA. 50+71.46 STA. 50+28.55, 8.5' RT TO STA. 51+03.72, 14.6' RT STA. 100+08.96, 22.12' LT TO STA. 100+45.87, 51.02' LT STA. 100+16.28, 14.97' RT TO STA. 101+17.96, 25.46' LT STA. 100+20, 27' LT STA. 100+42.77, 11.36' RT STA. 101+00, 16' LT STA. 101+18.24, 15.42' LT PARKING LOT	0.5	1	211	3	45	31	102	23	5,474	36	2350	3	703	1	42
TOTAL =	0.5	1	211	3	45	31	102	23	5,474	36	2350	3	703	1	42

LIST OF STANDARDS

- 424001-05 CURB RAMPS FOR SIDEWALKS
- 701901-TRAFFIC CONTROL DEVICES

GENERAL NOTES

- ALL ELEVATIONS ARE REFERENCED TO ELEVATIONS ESTABLISHED BY VASCONCELLES ENGINEERING CORP.
- WHERE SECTION OR SUBSECTION MONUMENTS ARE ENCOUNTERED, THE ENGINEER SHALL BE NOTIFIED BEFORE SUCH MONUMENTS ARE REMOVED. THE CONTRACTOR SHALL PROTECT AND CAREFULLY PRESERVE ALL PROPERTY MARKERS AND MONUMENTS UNTIL THE OWNER AND AUTHORIZED SURVEYOR OR AGENT HAS WITNESSED OR OTHERWISE REFERENCED THEIR LOCATION. IF THE ENGINEER DECIDES TO HAVE THE CONTRACTOR RESET THE MONUMENT, THIS WORK WILL BE PAID FOR IN ACCORDANCE WITH ARTICLE 109.04.
- THE CONTRACTOR SHALL CONTACT J.U.L.I.E. PRIOR TO ANY EXCAVATION TO HAVE ALL PUBLIC AND PRIVATE UTILITIES LOCATED.
- THE CONTRACTOR SHALL BE RESPONSIBLE FOR PROTECTING UTILITY PROPERTY FROM CONSTRUCTION OPERATIONS AS OUTLINED IN ARTICLE 107.26 OF THE STANDARD SPECIFICATIONS. THE J.U.L.I.E. NUMBER IS (800) 892-0123. A MINIMUM OF 48 HOURS ADVANCE NOTICE IS REQUIRED. SEE SPECIAL PROVISIONS FOR STATUS OF UTILITIES, WITH UTILITY COMPANIES LISTED.
- ANY REFERENCE TO THE STANDARDS THROUGHOUT THE PLANS SHALL BE INTERPRETED TO BE THE LATEST STANDARDS OF THE DEPARTMENT AS INCLUDED IN THE PLANS.
- ALL DETAILS IN THE PLANS SHALL GOVERN CONSTRUCTION OF THIS PROJECT, AND IN CASE OF CONFLICT WITH ANY STANDARD DRAWINGS INCLUDED, THE SAID DETAILS SHALL TAKE PRECEDENCE AND GOVERN.

FILE NAME =	USER NAME = #USER#	DESIGNED - S.D.K.	REVISED -	STATE OF ILLINOIS DEPARTMENT OF TRANSPORTATION	SUMMARY OF QUANTITIES, STANDARDS, & GENERAL NOTES BLACKHAWK STATE HISTORIC SITES			F.A. RTE.	SECTION	COUNTY	TOTAL SHEETS	SHEET NO.
#FILE#	PLOT SCALE = #SCALE#	DRAWN - S.D.K.	REVISED -						ROCK ISLAND	6	2	
	PLOT DATE = #DATE#	CHECKED - R.H.D.	REVISED -		SCALE:	SHEET NO. 2 OF 6 SHEETS	STA.	TO STA.	FED. ROAD DIST. NO.	ILLINOIS FED. AID PROJECT	CONTRACT NO. 46070	
		DATE - 8/24/09	REVISED -									

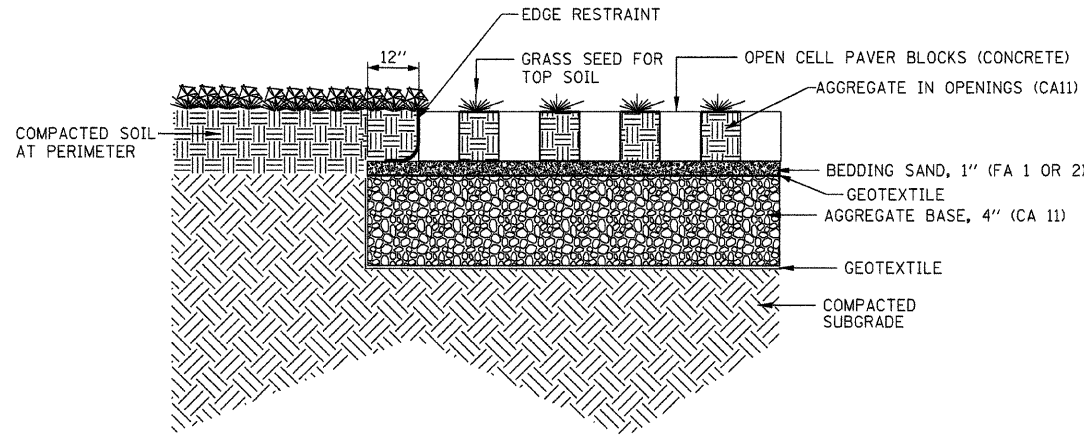

PAVER DETAIL CROSS SECTION
NOT TO SCALE

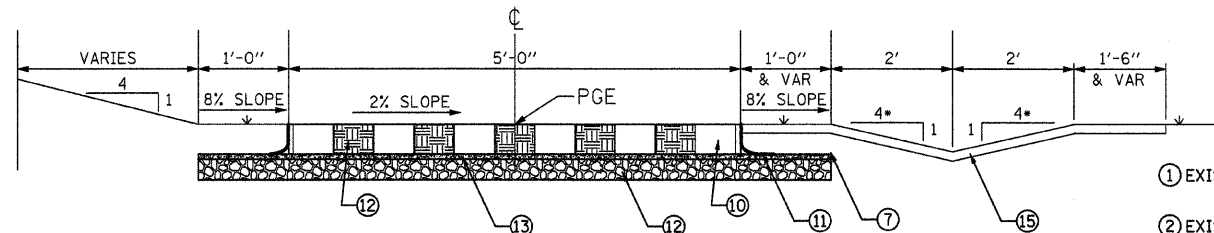

OPEN CELL PAVER BLOCK SECTION (STEPS)

STA. 49+56.95 TO STA. 50+20.02
STA. 50+28.13 TO STA. 50+71.46

* TYPICAL SLOPE AS NECESSARY TO DIRECT FLOW TO THE INLET RT STA. 51+05

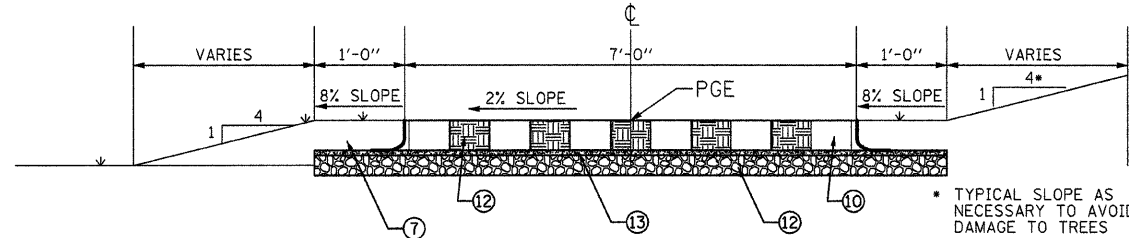

OPEN CELL PAVER BLOCK SECTION

STA. 47+20 TO STA. 49+48.95

* TYPICAL SLOPE AS NECESSARY TO AVOID DAMAGE TO TREES

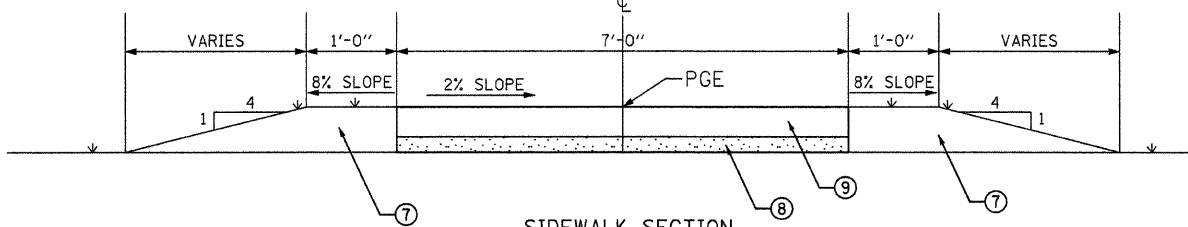

SIDEWALK SECTION

STA. 41+96.64 TO STA. 46+70

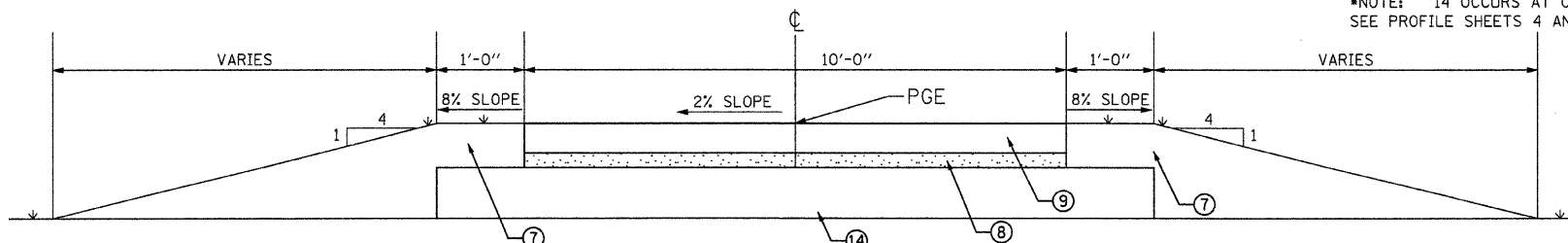

SIDEWALK SECTION

STA. 40+21.64 TO STA. 41+76.64

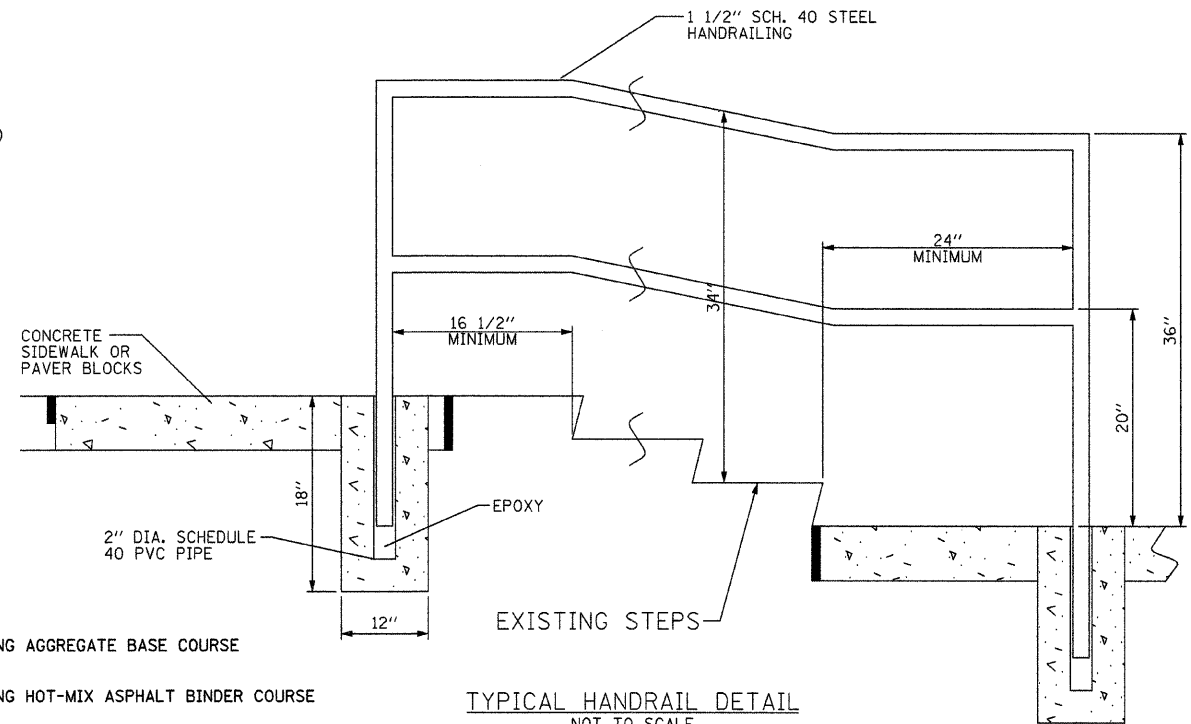

TYPICAL HANDRAIL DETAIL
NOT TO SCALE

- ① EXISTING AGGREGATE BASE COURSE
 - ② EXISTING HOT-MIX ASPHALT BINDER COURSE
 - ③ EXISTING HOT-MIX ASPHALT SURFACE COURSE
 - ④ PROPOSED HOT-MIX ASPHALT SURFACE COURSE, MIX "C", N70, 1 1/2"
 - ⑤ PROPOSED HOT MIX BINDER COURSE, IL-19.0, N70, 1 1/2"
 - ⑥ PROPOSED AGGREGATE BASE COURSE, TYPE B, 8"
 - ⑦ PROPOSED TOPSOIL FURNISH AND PLACE, VARIABLE DEPTH.
 - ⑧ PROPOSED 3" MINIMUM AGGREGATE BASE COURSE, TYPE B
 - ⑨ PROPOSED PORTLAND CEMENT CONCRETE SIDEWALK 5"
 - ⑩ OPEN CELL PAVER BLOCKS (CONCRETE)
 - ⑪ PAVER BLOCK EDGE RESTRAINT
 - ⑫ AGGREGATE (CA11), 6"
 - ⑬ BEDDING SAND (FA 1 OR 2), 1"
 - ⑭ EMBANKMENT* (EARTH EXCAVATION SPECIAL)
 - ⑮ TURF REINFORCEMENT MAT
- *NOTE: 14 OCCURS AT OTHER LOCATIONS, SEE PROFILE SHEETS 4 AND 5

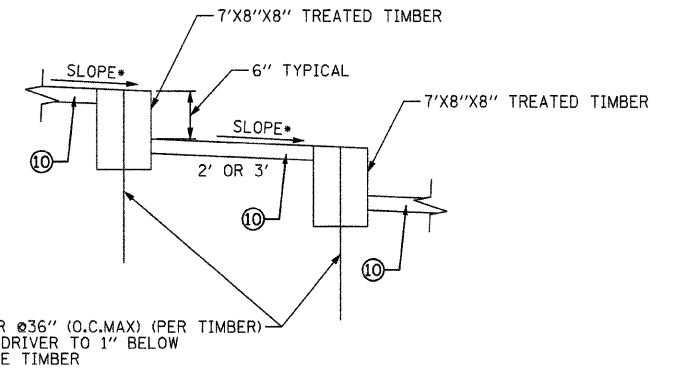

TIMBER STEP DETAIL
NOT TO SCALE

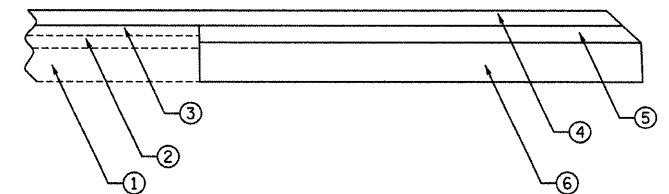

PAVEMENT REMOVAL & REPLACEMENT SECTION

FILE NAME =	USER NAME = #USER#	DESIGNED - S.D.K.	REVISED -
#FILEL#		DRAWN - S.D.K.	REVISED -
	PLOT SCALE = #SCALE#	CHECKED - R.H.D.	REVISED -
	PLOT DATE = #DATE#	DATE - 8/24/09	REVISED -

STATE OF ILLINOIS
DEPARTMENT OF TRANSPORTATION

TYPICAL SECTIONS & DETAILS
BLACK HAWK STATE HISTORIC SITE

SCALE: SHEET NO. 3 OF 6 SHEETS STA. TO STA.

F.A. RTE.	SECTION	COUNTY	TOTAL SHEETS	SHEET NO.
		ROCK ISLAND	6	3
FED. ROAD DIST. NO.		ILLINOIS FED. AID PROJECT		
		CONTRACT NO. 46070		

DATE	BY
REVISIONS	PLANNED
ALIGNED	CHECKED
NO. BOOK	NO. SHEET
NOTE	NO. FILE
NO.	NO.

DATE	BY
REVISIONS	PLANNED
GRADES	CHECKED
NO. BOOK	NO. SHEET
NO.	NO.

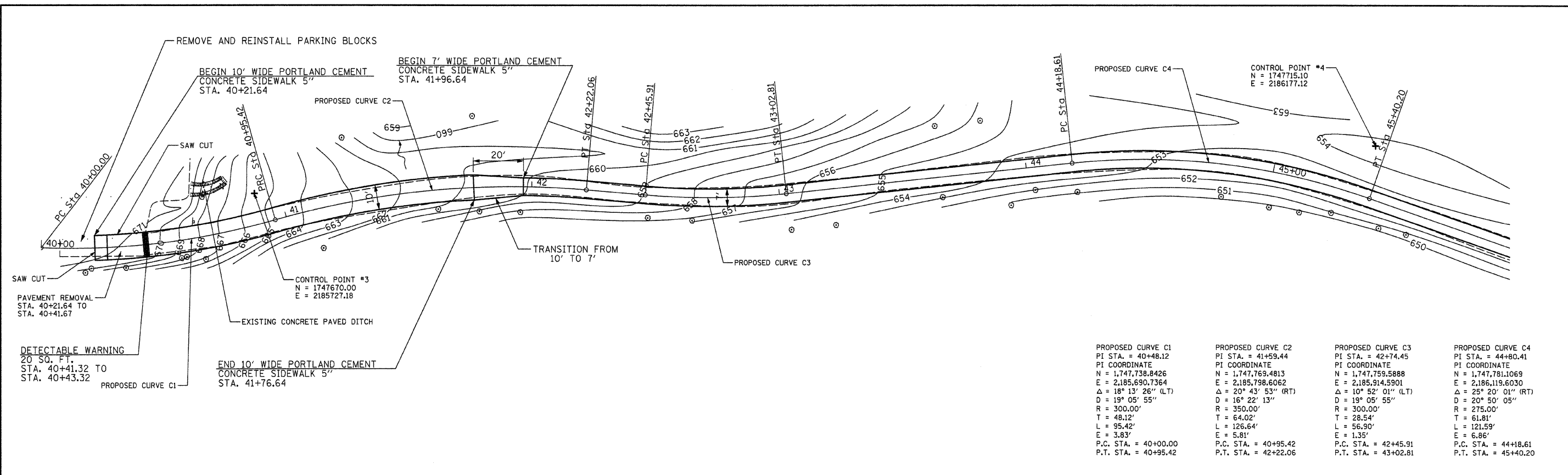

PROPOSED CURVE C1	PROPOSED CURVE C2	PROPOSED CURVE C3	PROPOSED CURVE C4
PI STA. = 40+48.12	PI STA. = 41+59.44	PI STA. = 42+74.45	PI STA. = 44+80.41
PI COORDINATE N = 1,747,738.8426 E = 2,185,690.7364	PI COORDINATE N = 1,747,769.4813 E = 2,185,798.6062	PI COORDINATE N = 1,747,759.5888 E = 2,185,914.5901	PI COORDINATE N = 1,747,781.1069 E = 2,186,119.6030
Δ = 18° 13' 26" (LT)	Δ = 20° 43' 53" (RT)	Δ = 10° 52' 01" (LT)	Δ = 25° 20' 01" (RT)
D = 19° 05' 55"	D = 16° 22' 13"	D = 19° 05' 55"	D = 20° 50' 05"
R = 300.00'	R = 350.00'	R = 300.00'	R = 275.00'
T = 48.12'	T = 64.02'	T = 28.54'	T = 61.81'
L = 95.42'	L = 126.64'	L = 56.90'	L = 121.59'
E = 3.83'	E = 5.91'	E = 1.35'	E = 6.86'
P.C. STA. = 40+00.00 P.T. STA. = 40+95.42	P.C. STA. = 40+95.42 P.T. STA. = 42+22.06	P.C. STA. = 42+45.91 P.T. STA. = 43+02.81	P.C. STA. = 44+18.61 P.T. STA. = 45+40.20

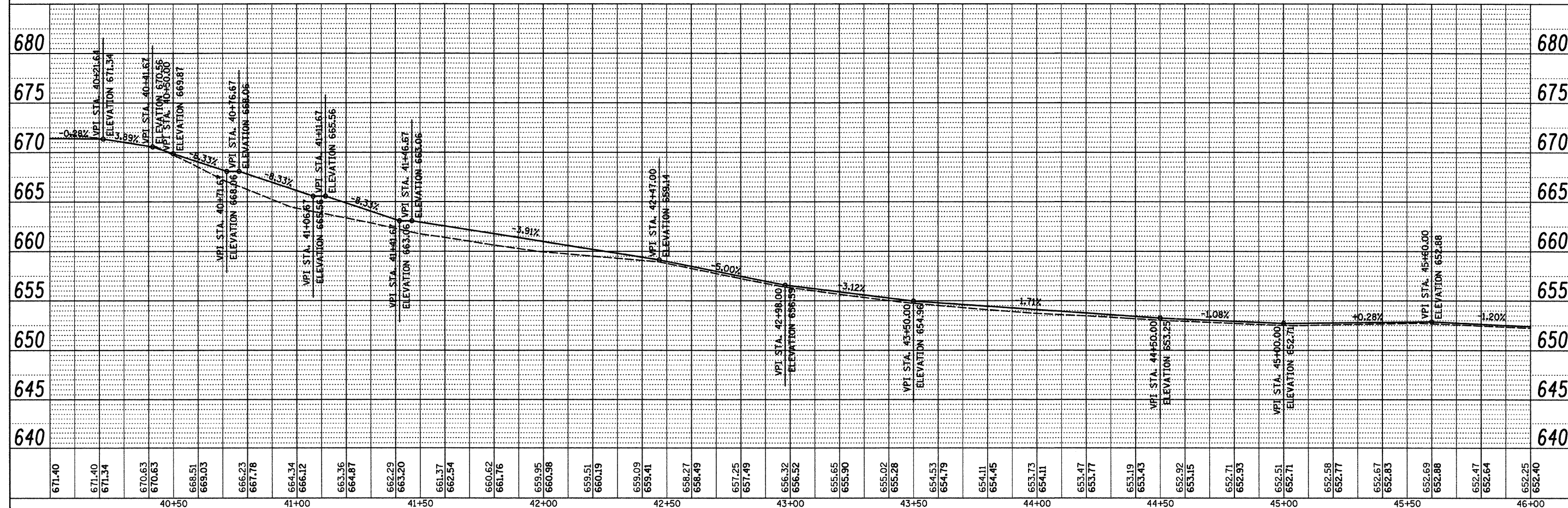

FILE NAME =	USER NAME = #USER#	DESIGNED - S.D.K.	REVISED -	STATE OF ILLINOIS DEPARTMENT OF TRANSPORTATION	PLAN PROFILE SHEET	F.A. RTE.	SECTION	COUNTY	TOTAL SHEETS	SHEET NO.
#FILE#		DRAWN - S.D.K.	REVISED -			ROCK ISLAND	6	4		
PLOT SCALE = #SCALE#		CHECKED - R.H.D.	REVISED -			CONTRACT NO. 46070				
PLOT DATE = #DATE#		DATE - 8/24/09	REVISED -			ILLINOIS FED. AID PROJECT				
SCALE:		SHEET NO. OF SHEETS		STA. TO STA.						

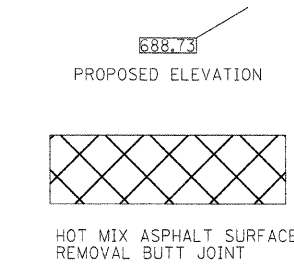
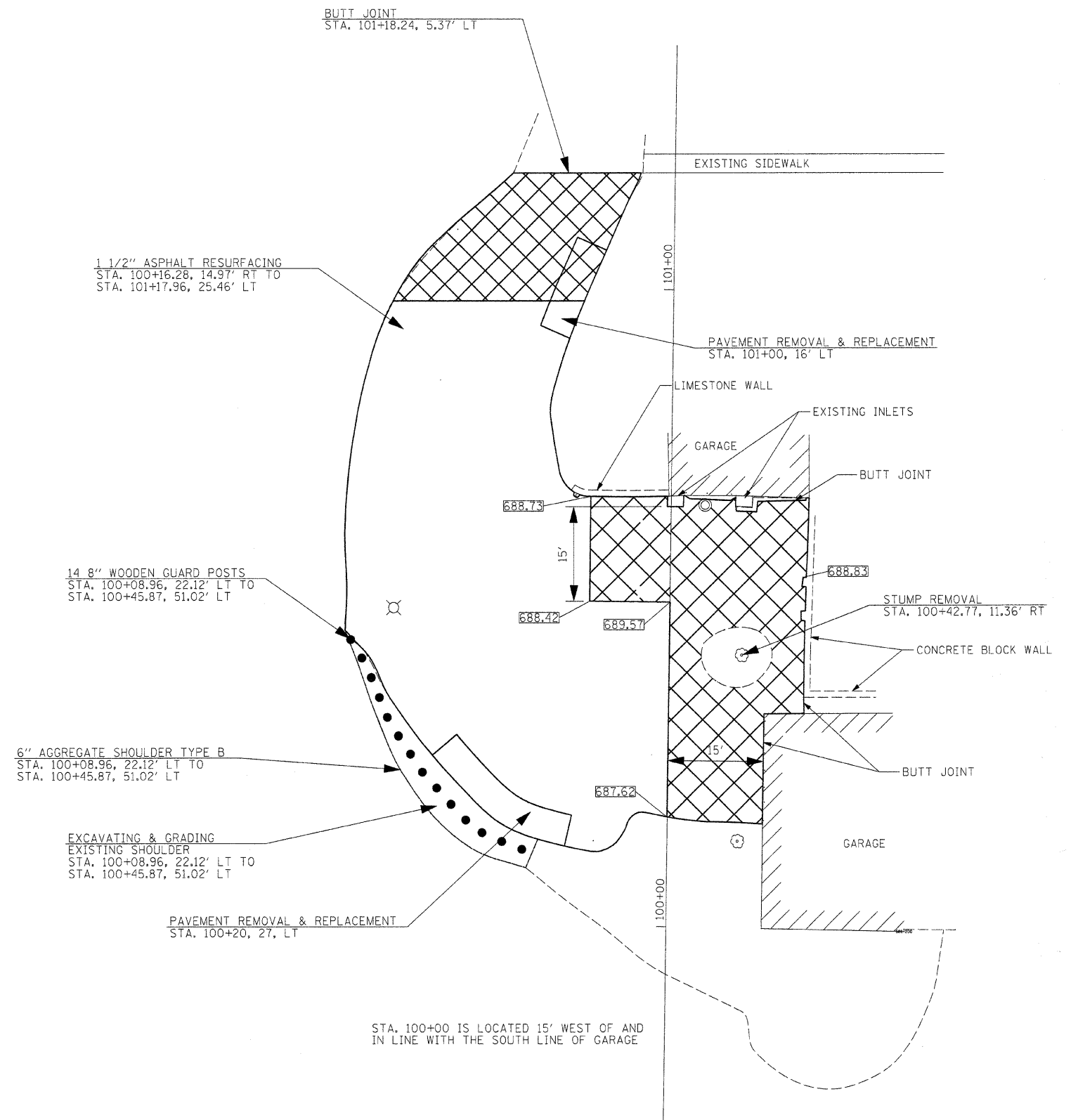

*NOTE: AREAS OF PAVEMENT REMOVAL AND REPLACEMENT SHALL BE COORDINATED WITH THE SITE MANAGER

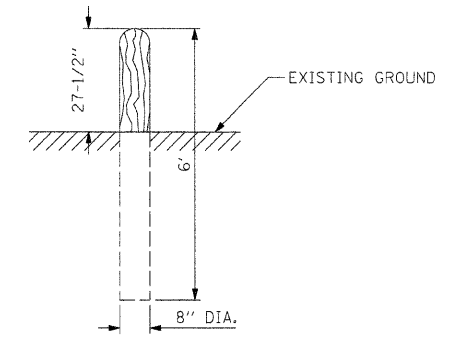

STA. 100+00 IS LOCATED 15' WEST OF AND IN LINE WITH THE SOUTH LINE OF GARAGE

FILE NAME =	USER NAME = #USER#	DESIGNED - S.D.K.	REVISED -	STATE OF ILLINOIS DEPARTMENT OF TRANSPORTATION	SITE MANAGER HOUSE PLAN SHEET BLACKHAWK STATE HISTORIC SITE			F.A. RTE.	SECTION	COUNTY	TOTAL SHEETS	SHEET NO.
#FILE#		DRAWN - S.D.K.	REVISED -		SCALE: 1"=10'	SHEET NO. 6 OF 6 SHEETS	STA.	TO STA.	ROCK ISLAND	6	6	
	PLOT SCALE = #SCALE#	CHECKED - R.H.D.	REVISED -						CONTRACT NO. 46070			
	PLOT DATE = #DATE#	DATE - 8/24/09	REVISED -						ILLINOIS FED. AID PROJECT			