

ROUTE	SECTION	COUNTY	TOTAL SHEETS	SHEET NUMBER
VARIOUS	2009-072 I	LAKE	14	1

**STATE OF ILLINOIS**  
**DEPARTMENT OF TRANSPORTATION**  
**DIVISION OF HIGHWAYS**  
**DISTRICT ONE**  
**PROPOSED HIGHWAY PLANS**

**CONTRACT NO. 60H82**

D-91-818-09

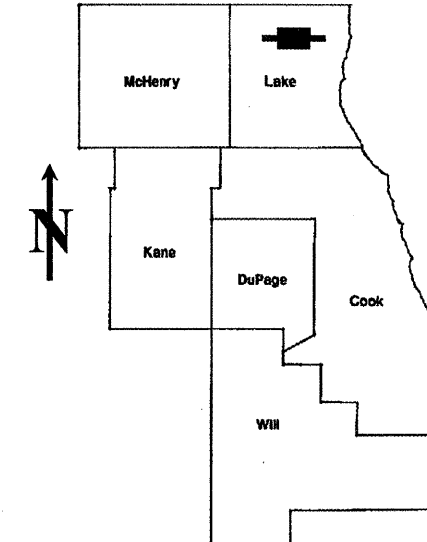

LOCATION OF IMPROVEMENT INDICATED THUS:

VARIOUS ROUTES  
 SECTION: 2009-072 I  
 VARIOUS LOCATIONS IN LAKE COUNTY  
 DRAINAGE IMPROVEMENTS & CURB AND GUTTER REPAIRS  
 LAKE COUNTY  
 C-91-818-09

FOR INDEX OF SHEETS, SEE SHEET NO. 2

**STATE OF ILLINOIS**  
**DEPARTMENT OF TRANSPORTATION**  
**DIVISION OF HIGHWAYS**

SUBMITTED: JANUARY 13, 2010

*Diane M. O'Keefe*  
 DEPUTY DIRECTOR OF HIGHWAYS, REGION ENGINEER

January 29, 2010  
*Scott E. Stett* P.E.  
 acting ENGINEER OF DESIGN AND ENVIRONMENT

January 29, 2010  
*Christine M. Reed*  
 DIRECTOR, DIVISION OF HIGHWAYS

*Peter M. Johnston*  
 1-12-10  
  
*Expires 11-30-11*

**PRINTED BY THE AUTHORITY**  
**OF THE STATE OF ILLINOIS**

**J.U.L.I.E.: JOINT UTILITY LOCATION**  
**INFORMATION FOR EXCAVATION**  
**(312) 744-7000**

DISTRICT ONE - DESIGN - PLAN PREPARATION ENGINEER:  
 KEN ENG / (847) 705-4247

**CONTRACT NO. 60H82**

INDEX OF SHEETS

SHEET NO.	DESCRIPTION
1	COVER SHEET
2	GENERAL NOTES
3	SUMMARY OF QUANTITIES
4-5	SCHEDULES
6	LOCATION MAP
7	DRIVEWAY DETAILS - DISTANCE BETWEEN R.O.W. AND CURB OR EDGE GRATER THAN OR EQUAL TO 15' (4.5 m) (BD01)
8	CONCRETE MEDIAN TYPE SB (DOWELLED) AND CORRUGATED MEDIAN (MODIFIED) (BD05)
9	PAVEMENT PATCHING FOR HMA SURFACED PAVEMENT (BD22)
10	CURB OR CURB AND GUTTER REMOVAL AND REPLACEMENT (BD24)
11	TRAFFIC CONTROL AND PROTECTION FOR SIDEROADS, INTERSECTION AND DRIVEWAYS (TC10)
12	TRAFFIC CONTROL AND PROTECTION AT TURN BAYS (TO REMAIN OPEN TO TRAFFIC) (TC14)
13	ARTERIAL ROAD INFORMATION SIGN (TC22)
14	DRIVEWAY ENTRANCE SIGNING (TC26)

HIGHWAY STANDARDS

STD. NO.	TITLE
424001-05	CURB RAMPS FOR SIDEWALKS
442201-03	CLASS C AND D PATCHES
483001-04	PCC SHOULDER
542301-02	PRECAST REINFORCED CONCRETE FLARED END SECTION
542311-01	GRATING FOR CONCRETE FLARED END SECTION (FOR 600 mm (24") THRU 1300 mm (54") PIPE
604036-02	GRATE, TYPE 8
604056-03	FRAME AND GRATE, TYPE 11V
604091-02	FRAME AND GRATE, TYPE 24
606001-04	CONCRETE CURB AND COMBINATION CONCRETE CURB AND GUTTER
606301-04	PORTLAND CEMENT CONCRETE ISLANDS AND MEDIANS
606306-03	CORRUGATED PORTLAND CEMENT CONCRETE MEDIANS
606401-01	PAVED DITCH
701501-05	URBAN LANE CLOSURE, 2L, 2W - UNDIVIDED
701601-06	URBAN LANE CLOSURE, MULTILANE, 1W OR 2W WITH NON TRAVERSABLE MEDIAN
701602-04	URBAN LANE CLOSURE, MULTILANE, 2W WITH BIDIRECTIONAL LEFT TURN LANE
701606-06	URBAN LANE CLOSURE, MULTILANE, 2W WITH MOUNTABLE MEDIAN
701701-06	URBAN LANE CLOSURE, MULTILANE INTERSECTION
701901-01	TRAFFIC CONTROL DEVICES

GENERAL NOTES

- BEFORE STARTING ANY EXCAVATION, THE CONTRACTOR SHALL CALL "J.U.L.I.E." AT 800-892-0123 FOR FIELD LOCATIONS OF BURIED ELECTRIC, TELEPHONE AND GAS FACILITIES. (48 HOUR NOTIFICATION IS REQUIRED).
- THE CONTRACTOR SHALL COORDINATE CONSTRUCTION ACTIVITIES WITH UTILITY COMPANIES.
- THE CONTRACTOR WILL NOT BE ALLOWED TO SET UP A YARD OR FIELD OFFICE ON STATE PROPERTY WITHOUT WRITTEN PERMISSION FROM THE DEPARTMENT.
- WHEN ARTIFICIAL LIGHTING IS USED IN NIGHT OPERATIONS THE CONTRACTOR SHALL EXERCISE THE UTMOST PRECAUTIONS IN PREVENTING ADVERSE VISIBILITY TO THE MOTORING PUBLIC AND ADJOINING RESIDENTIAL AREAS.
- THE RESIDENT ENGINEER SHALL CONTACT THE TRAFFIC CONTROL SUPERVISOR AT (847) 705-4470 A MINIMUM 72 HOURS PRIOR TO THE PLACEMENT OF ANY TEMPORARY TRAFFIC CONTROL DEVICES.

HOT-MIX ASPHALT MIXTURE REQUIREMENTS

MIXTURE TYPE	AIR VOIDS
<b>PAVEMENT PATCHING, TYPE I, II &amp; III</b>	
CLASS D PATCHES (HMA BINDER, IL 19.0), THICKNESS VARIES	4% @ 70 GYR
<b>HMA SHOULDERS</b>	
HOT MIX ASPHALT SHOULDER, (HMA BINDER IL 19.0mm) 6"	2% @ 30 GYR
<b>STABILIZED MEDIAN SURFACE, 12"</b>	
HOT-MIX ASPHALT SURFACE COURSE, MIX "C", N50 (IL 9.5mm) - 2"	4% @ 50 GYR
HOT-MIX ASPHALT BASE COURSE (HMA BINDER IL 19.0mm), 10"	4% @ 50 GYR
<b>STABILIZED DRIVEWAYS, 8"</b>	
HOT-MIX ASPHALT SURFACE COURSE, MIX "C", N50 (IL 9.5mm) - 2"	4% @ 50GYR
HOT-MIX ASPHALT BASE COURSE (HMA BINDER IL 19.0mm), 8"	4% @ 50 GYR

THE UNIT WEIGHT USED TO CALCULATE ALL HOT-MIX ASPHALT SURFACE MIXTURE A IS 112 LBS/SQ YD/IN.

THE "AC TYPE" FOR POLYMERIZED HMA MIXES SHALL BE "SBS/SBR PG 70-22" AND FOR NON-POLYMERIZED HMA THE "AC TYPE" SHALL BE "PG 64-22" UNLESS MODIFIED BY DISTRICT ONE SPECIAL PROVISIONS.

FOR "PERCENT OF RAP" SEE DISTRICT ONE SPECIAL PROVISIONS.

FILE NAME =	USER NAME = _USER_	DESIGNED -	REVISED -	<b>STATE OF ILLINOIS DEPARTMENT OF TRANSPORTATION</b>	<b>DRAINAGE IMPROVEMENTS &amp; CURB AND GUTTER REPAIRS INDEX OF SHEETS, HIGHWAY STANDARDS AND GENERAL NOTES</b>	F.A.P. RTE.	SECTION	COUNTY	TOTAL SHEETS	SHEET NO.
*FILEL*		DRAWN - EF	REVISED -			*	2009-072 I	LAKE	14	2
	PLOT SCALE = 48.0000' / IN.	CHECKED - RS	REVISED -			* VARIOUS	CONTRACT NO. 6082			
	PLOT DATE = 1/11/2010	DATE - 01-11-2010	REVISED -			SCALE: 20	SHEET NO. 1 OF 1 SHEETS	STA.	TO STA.	ILLINOIS FED. AID PROJECT

SUMMARY OF QUANTITIES

URBAN  
100%  
STATE

ITEM NO.	DESCRIPTION	UNIT	TOTAL QUANTITY	Y007 DRAINAGE QUANTITY
20400800	FURNISHED EXCAVATION	CU YD	8	8
21101615	TOPSOIL FURNISH & PLACE, 4" AND	SQ YD	360	360
25200110	SODDING, SALT TOLERANT	SQ YD	360	360
42300400	PORTLAND CEMENT CONCRETE DRIVEWAY PAVEMENT, 8 INCH	SQ YD	90	90
42400200	PORTLAND CEMENT CONCRETE SIDEWALK 5 INCH	SQ FT	66	66
44000200	DRIVEWAY PAVEMENT REMOVAL	SQ YD	250	250
44000600	SIDEWALK REMOVAL AND AND	SQ FT	66	66
44001700	COMBINATION CONCRETE CURB & GUTTER REMOVAL & REPLACEMENT	FOOT	4,350	4,350
44003100	MEDIAN REMOVAL	SQ FT	5,611	5,611
44004000	PAVED DITCH REMOVAL	FOOT	307	307
44004250	PAVED SHOULDER REMOVAL	SQ YD	24	24
44200274	PAVEMENT PATCHING, TYPE I	SQ YD	45	45
44200276	PAVEMENT PATCHING, TYPE II	SQ YD	51	51
44200278	PAVEMENT PATCHING, TYPE III	SQ YD	23	23
48101200	AGGREGATE SHOULDERS, TYPE B	TON	11	11
48203021	HOT-MIX ASPHALT SHOULDERS, 6"	SQ YD	24	24
48300100	PORTLAND CEMENT CONCRETE SHOULDERS 6"	SQ YD	14	14
50105220	PIPE CULVERT REMOVAL	FOOT	148	148
542A0217	PIPE CULVERTS, CLASS A, TYPE 1 12"	FOOT	16	16
542A0229	PIPE CULVERTS, CLASS A, TYPE 1 24"	FOOT	36	36
542A0241	PIPE CULVERTS, CLASS A, TYPE 1 36"	FOOT	96	96
54213657	PRECAST REINFORCED CONCRETE FLARED END SECTIONS 12"	EACH	1	1
54213666	PRECAST REINFORCED CONCRETE FLARED END SECTIONS 21"	EACH	1	1
54213669	PRECAST REINFORCED CONCRETE FLARED END SECTIONS 24"	EACH	2	2
54213681	PRECAST REINFORCED CONCRETE FLARED END SECTIONS 36"	EACH	1	1
54247120	GRATING FOR CONCRETE END SECTION 21"	EACH	1	1
54247130	GRATING FOR CONCRETE END SECTION 24"	EACH	2	2
54247170	GRATING FOR CONCRETE END SECTION 36"	EACH	1	1
60402210	GRATE, TYPE 8	EACH	1	1
60404805	FRAMES AND GRATES, TYPE 11V	EACH	9	9
60404950	FRAMES AND GRATES, TYPE 24	EACH	4	4
60616800	PAVED DITCH, TYPE B-15	FOOT	307	307
60618300	CONCRETE MEDIAN SURFACE, 4 INCH	SQ FT	258	258
60618800	CONCRETE MEDIAN, TYPE SB	SQ FT	1,712	1,712
60624600	CORRUGATED MEDIAN	SQ FT	2,610	2,610
67000400	ENGINEER'S FIELD OFFICE, TYPE A	CAL MO	6	6
67100100	MOBILIZATION	L SUM	1	1
70102620	TRAFFIC CONTROL AND PROTECTION, STANDARD 701501	L SUM	1	1
70102625	TRAFFIC CONTROL AND PROTECTION, STANDARD 701606	L SUM	1	1
70102630	TRAFFIC CONTROL AND PROTECTION, STANDARD 701601	L SUM	1	1
70102632	TRAFFIC CONTROL AND PROTECTION, STANDARD 701602	L SUM	1	1
70102635	TRAFFIC CONTROL AND PROTECTION, STANDARD 701701	L SUM	1	1
X0322256	TEMPORARY INFORMATION SIGNING	SQ FT	759	759
X6062100	STABILIZED MEDIAN SURFACE 12"	SQ YD	115	115
Z0018400	DRAINAGE STRUCTURES TO BE ADJUSTED	EACH	76	76
Z0018600	DRAINAGE STRUCTURES TO BE RECONSTRUCTED	EACH	5	5
Z0066700	STABILIZED DRIVEWAYS, 10"	SQ YD	155	155

FILE NAME *	USER NAME = _USER_	DESIGNED -	REVISED -	<b>STATE OF ILLINOIS DEPARTMENT OF TRANSPORTATION</b>	<b>DRAINAGE IMPROVEMENTS &amp; CURB AND GUTTER REPAIRS SUMMARY OF QUANTITIES</b>			F.A.P. RTE.	SECTION	COUNTY	TOTAL SHEETS	SHEET NO.
*FILEL*		DRAWN - EF	REVISED -					•	2009-072 I	LAKE	14	3
	PLOT SCALE = 48:0.0000 1' / IN.	CHECKED - RS	REVISED -		SCALE: 20			SHEET NO. 1 OF 1 SHEETS		STA.	TO STA.	
	PLOT DATE = 1/12/2010	DATE - 01-11-2010	REVISED -					• VARIOUS		CONTRACT NO. 60H82		
[ILLINOIS] FED. AID PROJECT												

INDEX #	ROUTE	GENERAL LOCATION	FURNISHED EXCAVATION	TOPSOIL, FURNISH & PLACE, #	SODDING, SALT TOLERANT	PORTLAND CEMENT CONCRETE DRIVEWAY PAVEMENT, 8"	PORTLAND CEMENT CONCRETE SIDEWALK, 5"	DRIVEWAY PAVEMENT REMOVAL	SIDEWALK REMOVAL	COMBINATION CONCRETE CURB & GUTTER, REMOVAL & REPLACEMENT	MEDIAN REMOVAL	PAVED DITCH REMOVAL	PAVED SHOULDER REMOVAL	PAVEMENT PATCHING, TYPE I	PAVEMENT PATCHING, TYPE II	PAVEMENT PATCHING, TYPE III	AGGREGATE SHOULDERS, TYPE B	HOT-MIX ASPHALT SHOULDERS, 6"	PORTLAND CEMENT CONCRETE SHOULDERS, 6"	PIPE CULVERT REMOVAL	PIPE CULVERTS, CLASS A, TYPE 1, 12"	PIPE CULVERTS, CLASS A, TYPE 1, 24"	PIPE CULVERTS, CLASS A, TYPE 1, 36"	PRECAST REINFORCED CONCRETE FLARED END SECTIONS, 12"	PRECAST REINFORCED CONCRETE FLARED END SECTIONS, 21"	PRECAST REINFORCED CONCRETE FLARED END SECTIONS, 24"	PRECAST REINFORCED CONCRETE FLARED END SECTIONS, 36"	GRATING FOR CONCRETE END SECTION, 21"	GRATING FOR CONCRETE END SECTION, 24"	GRATING FOR CONCRETE END SECTION, 36"	GRATE, TYPE B	FRAME AND GRATE, TYPE 11V	FRAME AND GRATE, TYPE 24	PAVED DITCH, TYPE B-15	CONCRETE MEDIAN SURFACE, 4"	CONCRETE MEDIAN, TYPE SB	CORRUGATED MEDIAN	STABILIZED MEDIAN SURFACE, 12"	DRAINAGE STRUCTURES TO BE ADJUSTED	DRAINAGE STRUCTURES TO BE RECONSTRUCTED	STABILIZED DRIVEWAYS, 10'											
			CU YD	SQ YD	SQ YD	SQ YD	SQ FT	SQ YD	SQ FT	FT	SQ FT	FT	SQ YD	SQ YD	SQ YD	TON	SQ YD	SQ YD	SQ YD	FT	FT	FT	FT	EA	EA	EA	EA	EA	EA	EA	EA	EA	EA	EA	EA	EA	SQ FT	SQ FT	SQ FT	SQ YD	EA	EA	SQ YD									
1	IL-22	200' E. of Old Barrington													23.1				36		36					2		2																								
2	IL-60	From IL-83 to US-45				5.0		5.0		30																																										
4.5	IL-60	Betw. US-45 & Butterfield																																										2150								
5	IL-60	From Butterfield to US-45				13.3		13.3		80																																										
6	IL-60	From Butterfield to IL-21		17.7	17.7					214	162																																		18.0	1						
6.5	IL-60	Betw. Butterfield & IL-21								200	780																																	480	33.3							
7	IL-60	From IL-21 to Butterfield		3.0	3.0					28	15																																			1.7	2					
8	IL-176	From US-12 to Roberts																																													2					
9	IL-176	Betw. IL-60 & Gilmer		1.0	1.0					6																																										
10	IL-176	West of IL-60/83						6.7		40																																					6.7					
11	IL-176	Betw. Midlothian & IL-60/83		4.7	4.7					28																																										
12	IL-176	Betw. Midlothian & US-45		28.3	28.3			15.0		265				13.8		0.3																																	15.0			
13	IL-176	Betw. IL-43 & US-41		0.7	0.7					4				3.6																																		2				
15	IL-137	Betw. IL-83 & IL-21		4.0	4.0			38.3		254				3.6	51.1																																	1	38.3			
16	IL-137	Betw. IL-21 & Des Plaines Rvr.		0.7	0.7					12			4.9					4.9																														2				
17	IL-120	NW comer @ Hainsville		2.7	2.7					16																																										
18	IL-120	NE comer @ Deerpoint		1.0	1.0					6																																										
19	IL-120	SE comer @ Lake		1.3	1.3					8																																										
20	IL-120	Betw. US-41 & Knight		4.3	4.3					26																																							1	2		
21	IL-134	Betw. Fairfield & US-12						3.0		18																																								3.0		
23	IL-132	0.2 mi. W. of Fairfield										307																																					307			
24	IL-132	From Deep Lake Rd to US-45		0.3	0.3	7.3		18.0		154								7.5																															1	8	10.7	
25	IL-132	From US-45 to Deep Lake Rd								16				1.1				1.1																															1	6		
27	IL-173	Betw. IL-83 & Fox River bridge		16.5	16.5			10.0		159																																								2	10.0	
28	IL-173	W. of Grimm								12								0.7																																2		
30	IL-173	Betw. Mill Creek & Hunt Club								70	1600							3.9																																1200	400	
31	IL-173	E. of US-41 just E. of R&R crossing on NE comer		2.0																																														1		
33	IL-59	Betw. Roberts & Miller		1.0	28.7	28.7		19.3		198				3.3																																					3	14.3
34	IL-59	Betw. US-12 & IL-176		4.3	4.3					26																																										
36	IL-59	@ Grand		1.7	1.7					10	60			4.4																																					60	1



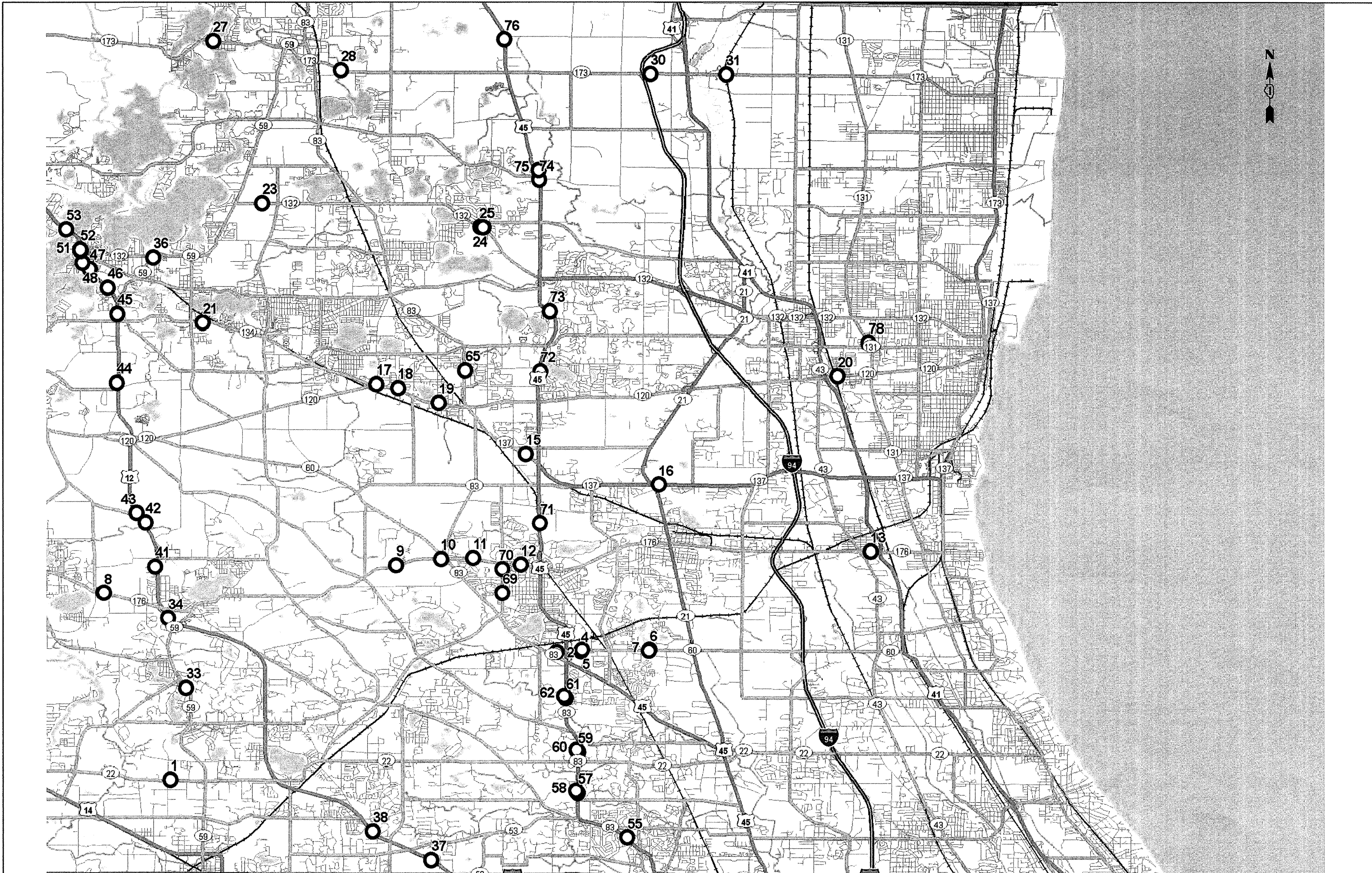

FILE NAME = #FILE#	USER NAME = .USER.	DESIGNED -	REVISED -	<b>STATE OF ILLINOIS</b> <b>DEPARTMENT OF TRANSPORTATION</b>	<b>DRAINAGE IMPROVEMENTS &amp; CURB AND GUTTER REPAIRS</b> <b>LOCATION MAP</b>		F.A.P. RTE.	SECTION	COUNTY	TOTAL SHEETS	SHEET NO.
	PLOT SCALE = 40:0.0000 " / IN.	DRAWN - EF	REVISED -		• 2009-072 I	LAKE	14	6	CONTRACT NO. 60H82		
	PLOT DATE = 1/11/2010	CHECKED - RS	REVISED -		• VARIOUS	ILLINOIS FED. AID PROJECT					
	DATE - 01-11-2010	REVISED -	SCALE: 20		SHEET NO. 1 OF 1 SHEETS	STA.	TO STA.				

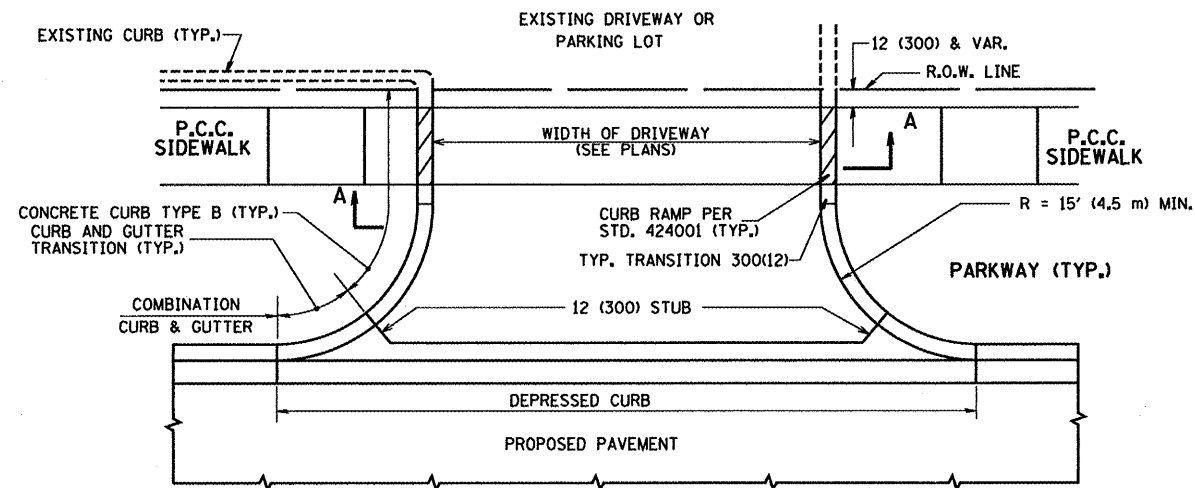

WITH CONCRETE CURB, TYPE B

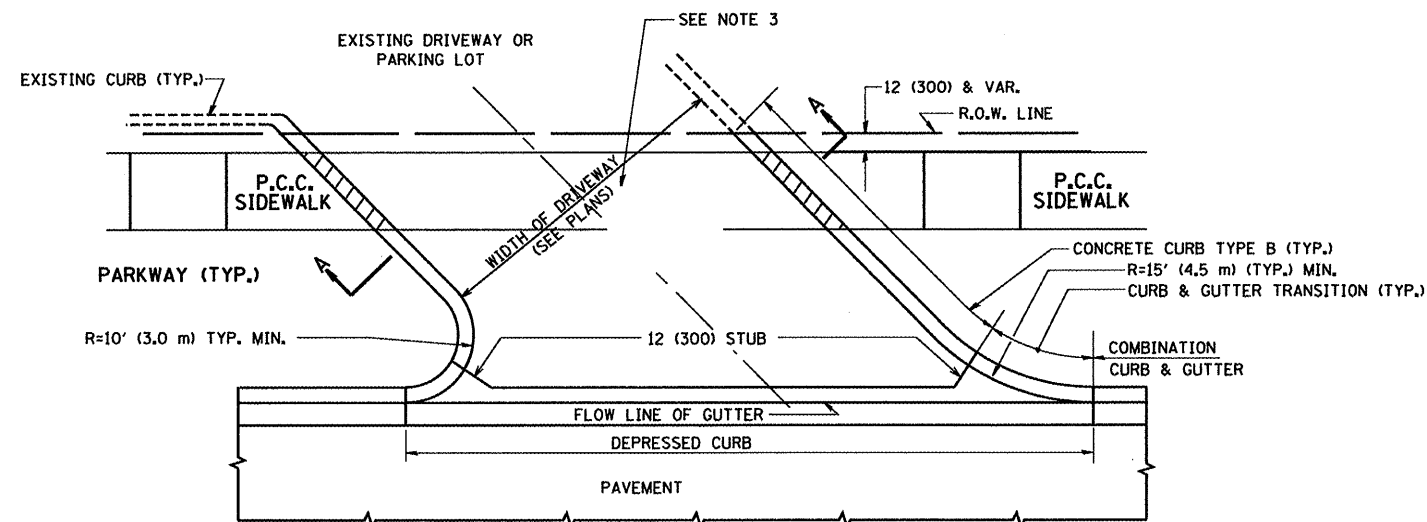

WITH CONCRETE CURB, TYPE B

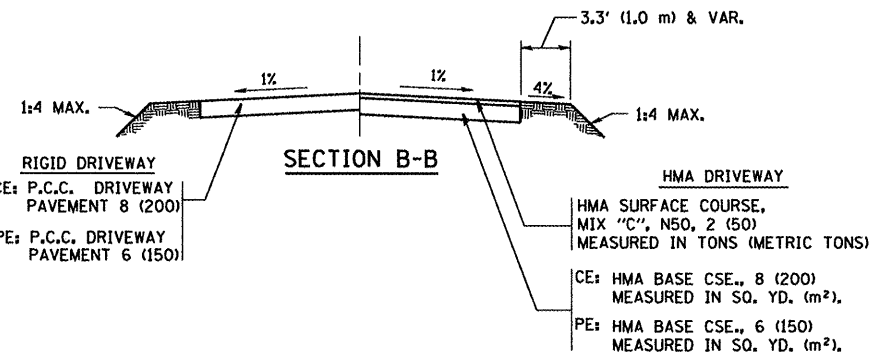
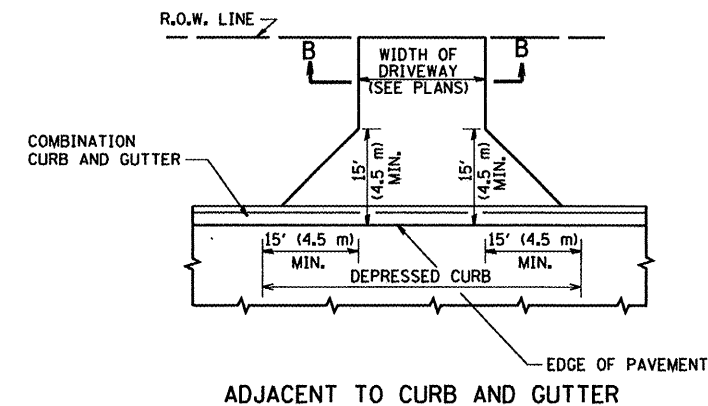
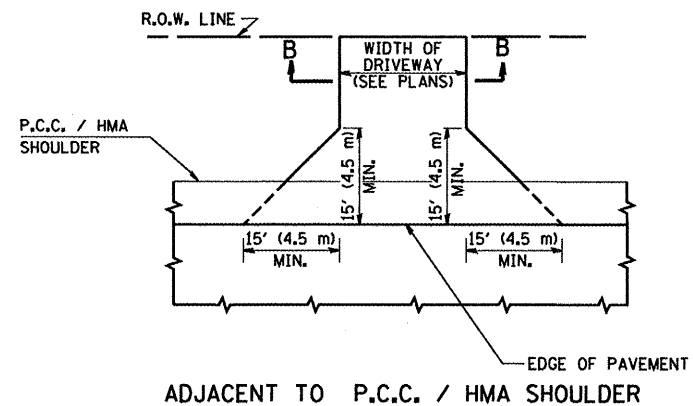
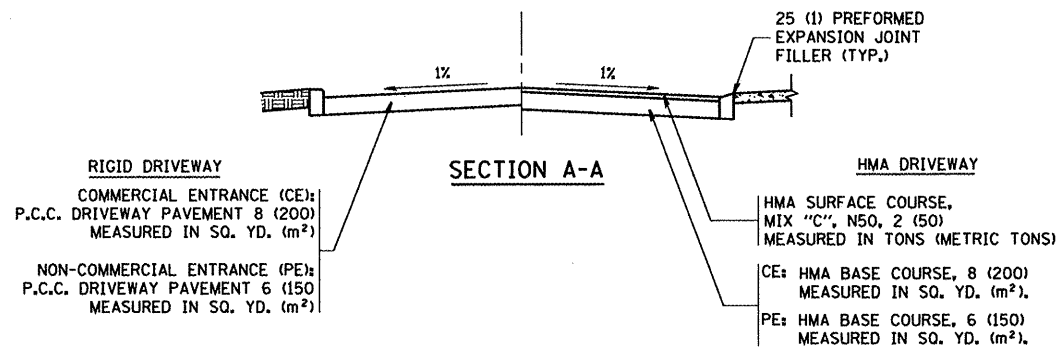

RURAL FIELD ENTRANCE (FE)

HMA SURFACE COURSE, MIX "C", N50, 2 (50) MEASURED IN TONS (METRIC TONS)

AGGREGATE BASE CSE., TYPE B, 8 (200) MEASURED IN SQ. YD. (m<sup>2</sup>).

GENERAL NOTES:

DRIVEWAY SLOPES, LOCATIONS, & GEOMETRIC LAYOUT SHALL BE IN ACCORDANCE WITH THE LATEST EDITION OF THE "HANDBOOK FOR POLICY ON PERMITS FOR ACCESS DRIVEWAYS TO STATE HIGHWAYS". FOR FURTHER LAYOUT REQUIREMENTS, REFER TO ILLUSTRATIONS IN THE PERMIT HANDBOOK. DRIVEWAYS SHALL BE REPLACED IN KIND, UNLESS OTHERWISE NOTED ON THE PLANS.

COMMERCIAL DRIVEWAYS SHALL BE CONSTRUCTED WITH CONCRETE CURB, TYPE B RETURNS EXCEPT WHEN THE SIDEWALK EDGE IS 4 FEET (1.2 METERS) OR LESS FROM THE BACK OF CURB, CONSTRUCT A FLARE DRIVEWAY WITHOUT CURB.

THE RESIDENT ENGINEER SHALL CONTACT THE TRAFFIC PERMIT OFFICE AT 847/ 705-4131 FOR ANY QUESTIONS ON DRIVEWAYS SHOWN IN THE PLANS; SPECIFICALLY IN REFERENCE TO ADDITIONAL AND/OR RELOCATION/REMOVAL OF A DRIVEWAY.

COMBINATION CONCRETE CURB & GUTTER SHALL BE MEASURED STRAIGHT ACROSS THE DRIVEWAY. NO ADDITIONAL COMPENSATION WILL BE ALLOWED FOR THE CURB & GUTTER TRANSITION.

1 (25) PREFORMED EXPANSION JOINT FILLER WILL NOT BE PAID SEPARATELY, BUT SHALL BE CONSIDERED INCLUDED IN THE COST OF THE P.C.C. DRIVEWAY PAVEMENT OR P.C.C. SIDEWALK.

WHEN THE P.C.C. SIDEWALK EXTENDS THROUGH THE DRIVEWAY, THE THICKNESS OF THE SIDEWALK IN THE DRIVEWAY AREA SHALL BE THE SAME AS THE DRIVEWAY THICKNESS. SIDEWALK WILL BE PAID FOR AS P.C.C. SIDEWALK OF THE THICKNESS SPECIFIED. SIDEWALK CROSS SLOPE THRU DRIVEWAY AREA TO BE A MAXIMUM OF 1:50.

\* VARIOUS

FILE NAME = c:\p\proj\ata\dists\d22x34\bd01.dgn

USER NAME = bevard1

PLOT SCALE = 49.9999' / IN.

PLOT DATE = 6/12/2008

DESIGNED - R. SHAH

DRAWN -

CHECKED -

DATE - 11-04-95

REVISED - M. GOMEZ 04-06-01

REVISED - P. LOFLUER 04-15-03

REVISED - R. BORO 01-01-07

REVISED - R. BORO 06-11-08

STATE OF ILLINOIS  
DEPARTMENT OF TRANSPORTATION

DRIVEWAY DETAILS - DISTANCE BETWEEN R.O.W.  
AND FACE OF CURB & EDGE OF SHOULDER >= 15' (4.5 m)

SCALE: NONE SHEET NO. 1 OF 1 SHEETS STA. TO STA.

F.A.P. RTE.	SECTION	COUNTY	TOTAL SHEETS	SHEET NO.
*	2009-072 I	LAKE	14	7
BD0156-07 (BD-01)			CONTRACT NO. 60R82	
FED. ROAD DIST. NO. 1 [ILLINOIS] FED. AID PROJECT				

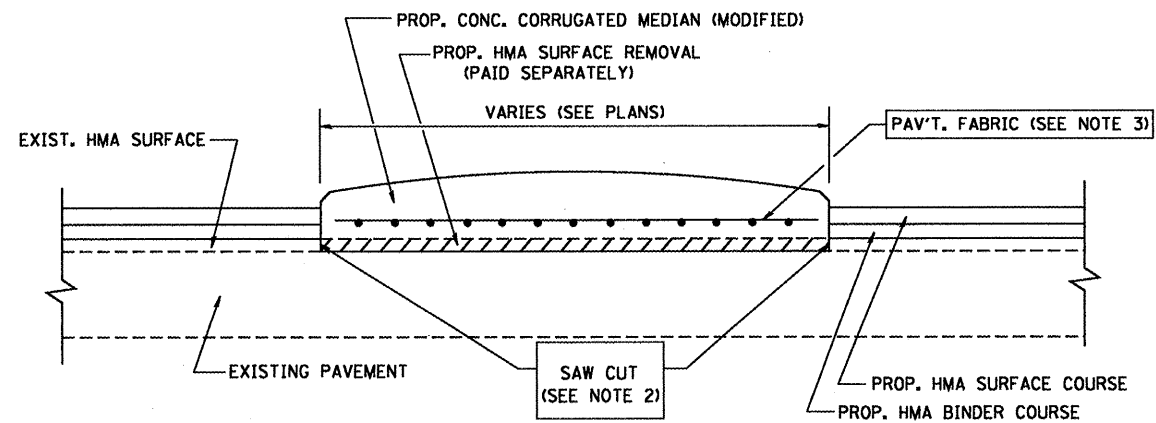

- NOTES:
1. CORRUGATED MEDIAN (MODIFIED) SHALL BE CONSTRUCTED IN ACCORDANCE WITH SECTION 606 OF THE STANDARD SPECIFICATIONS AND THE APPLICABLE PORTIONS OF STATE STANDARD 606306.
  2. WITH THE APPROVAL OF THE ENGINEER, THE CONTRACTOR MAY DELETE THE SAW CUT IF A NEAT JOINT CAN BE OBTAINED BY MILLING THE HMA SURFACE TO BE REMOVED. SAW CUT WILL BE INCLUDED IN THE COST OF CORRUGATED MEDIAN (MODIFIED)
  3. PAVEMENT FABRIC WILL BE INCLUDED IN THE COST OF CORRUGATED MEDIAN (MODIFIED)

**DETAILS FOR CORRUGATED MEDIAN (MODIFIED)**

THIS WORK WILL BE PAID FOR AT THE CONTRACT UNIT PRICE PER SQUARE FOOT (SQUARE METER) FOR "CORRUGATED MEDIAN (MODIFIED)"

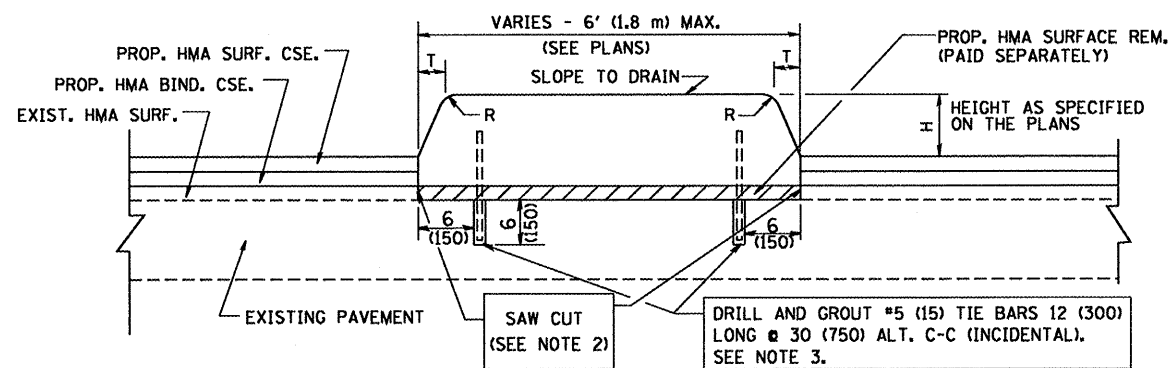

- NOTES:
1. CONCRETE MEDIAN TYPE SB (DOWELLED) SHALL BE CONSTRUCTED IN ACCORDANCE WITH THE APPLICABLE PORTIONS OF STATE STANDARD 606301 AND SECTION 606 OF THE STANDARD SPECIFICATIONS.
  2. WITH THE APPROVAL OF THE ENGINEER, THE CONTRACTOR MAY DELETE THE SAW CUT IF A NEAT JOINT CAN BE OBTAINED BY MILLING THE HMA SURFACE TO BE REMOVED. SAW CUT WILL BE INCLUDED IN THE COST OF "CONCRETE MEDIAN TYPE SB (DOWELLED)"
  3. FOR MEDIAN WIDTH LESS THAN 4' (1.2 m) USE ONE ROW OF #5 (15) BARS @ 30 (750) C-C ALONG THE MEDIAN CENTERLINE. TIE BARS WILL BE INCLUDED IN THE COST OF "CONCRETE MEDIAN TYPE SB (DOWELLED)"

H	R	T
6(150)	1(25)	1(25)
9(225)	1(25)	2(150)

**DETAILS FOR CONCRETE MEDIAN TYPE SB (DOWELLED)**

THIS WORK WILL BE PAID FOR AT THE CONTRACT UNIT PRICE PER SQUARE FOOT (SQUARE METER) FOR "CONCRETE MEDIAN TYPE SB (DOWELLED)"

ALL DIMENSIONS ARE IN INCHES (MILLIMETERS) UNLESS OTHERWISE SHOWN. \* VARIOUS

FILE NAME = W:\distatd\22x34\bd05.dgn	USER NAME = geglano	DESIGNED - M. DE YONG	REVISED - R. SHAH 09-09-94	<b>STATE OF ILLINOIS DEPARTMENT OF TRANSPORTATION</b>	<b>DETAILS FOR CONCRETE MEDIAN TYPE SB (DOWELLED) CORRUGATED MEDIAN (MODIFIED)</b>			F.A.P. RTE. *	SECTION	COUNTY	TOTAL SHEETS	SHEET NO.
		DRAWN -	REVISED - R. SHAH 10-25-94		SCALE: NONE	SHEET NO. 1 OF 1 SHEETS	STA.	TO STA.	2009-072 I	LAKE	14	8
		CHECKED -	REVISED - E. GOMEZ 08-28-00					BD600-02 (BD-5)		CONTRACT NO. 60882		
		DATE - 05-14-90	REVISED - R. BORO 01-01-07					FED. ROAD DIST. NO. 1 ILLINOIS FED. AID PROJECT				



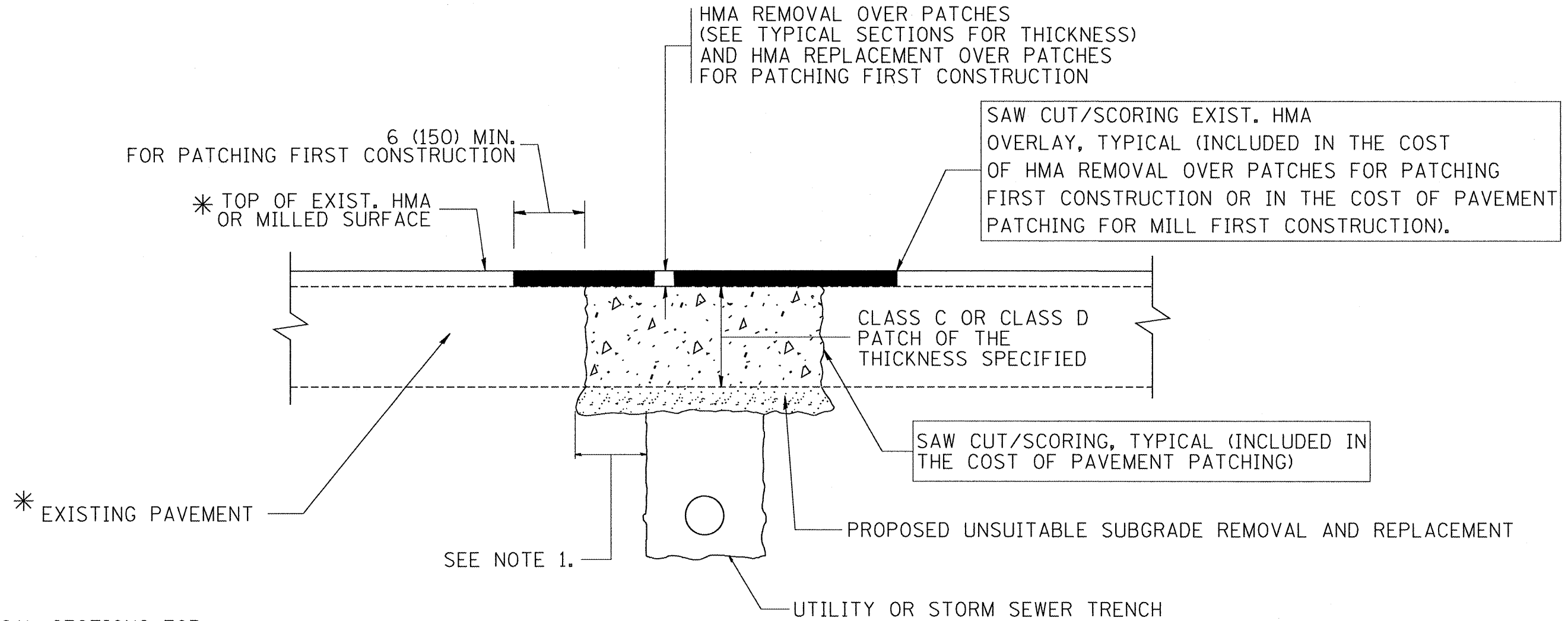

\* SEE TYPICAL SECTIONS FOR THICKNESS AND MATERIALS

**NOTES:**

1. THE WIDTH OF THE FULL DEPTH PATCH OVER A TRENCH SHALL BE 12 (300) WIDER ON EACH SIDE OF THE TRENCH.
2. FOR METHOD OF MEASUREMENT AND BASIS OF PAYMENT, SEE RECURRING SPECIAL PROVISION "PATCHING WITH HOT-MIX ASPHALT OVERLAY REMOVAL".

SEQUENCE OF CONSTRUCTION (PATCHING FIRST)

1. REMOVE THE EXISTING HMA MATERIAL OVER THE AREA TO BE PATCHED.
2. REMOVE AND REPLACE WITH CLASS C OR D PATCH.
3. REPLACE HMA MATERIAL OVER THE AREA TO BE PATCHED.

SEQUENCE OF CONSTRUCTION (MILLING FIRST)

1. MILL HMA FIRST IF THERE IS AT LEAST 4 1/2 INCHES OR MORE OF HMA MATERIAL ON TOP OF THE EXISTING PAVEMENT OR IF THE PAVEMENT IS FULL DEPTH HMA. A MINIMUM OF 2 INCHES OF HMA MATERIAL SHALL BE IN PLACE AFTER MILLING.
2. REMOVE AND REPLACE WITH FULL DEPTH CLASS D PATCHES TO TOP OF MILLED SURFACE.

ALL DIMENSIONS ARE IN INCHES (MILLIMETERS) UNLESS OTHERWISE SHOWN. \* VARIOUS

FILE NAME = c:\projects\dist\d22x34\bd22.dgn	USER NAME = beurd1	DESIGNED - R. SHAH	REVISED - A. ABBAS 04-27-98	<b>STATE OF ILLINOIS DEPARTMENT OF TRANSPORTATION</b>	<b>PAVEMENT PATCHING FOR HMA SURFACED PAVEMENT</b>			F.A.P. RTE.	SECTION	COUNTY	TOTAL SHEETS	SHEET NO.	
		DRAWN -	REVISED - R. BORO 01-01-07		SCALE: NONE	SHEET NO. 1 OF 1 SHEETS	STA.	TO STA.	*	2009-072 I	LAKE	14	9
		PLOT SCALE = 50.000' / IN.	REVISED - R. BORO 09-04-07					<b>BD400-04 (BD-22)</b>		CONTRACT NO. 60R82			
		PLOT DATE = 10/27/2008	REVISED - K. ENG 10-27-08		FED. ROAD DIST. NO. 1   ILLINOIS   FED. AID PROJECT								

VARIABLE - TO MEET EXISTING DIMENSIONS AND FIELD CONDITIONS (SEE NOTE ②)

PROP. CONC. CURB OR CURB AND GUTTER REPLACEMENT IN ACCORDANCE WITH STATE STANDARD 606001. (SEE NOTE ②)

SAW CUT FULL DEPTH - INCLUDED IN THE COST OF SIDEWALK, DRIVEWAY OR MEDIAN SURFACE REMOVAL PAY ITEM.

EXISTING SIDEWALK, DRIVEWAY, MEDIAN SURFACE, SOD OR GROUND.

PROPOSED SIDEWALK, DRIVEWAY PAVEMENT, MEDIAN SURFACE OR SODDING SALT TOLERANT WITH TOP SOIL, 4" (100) SOD RESTORATION (SEE NOTE ①).

SUITABLE BACKFILL MATERIAL (INCLUDED IN THE COST OF CURB OR CURB AND GUTTER REMOVAL AND REPLACEMENT)

PROPOSED 3/4" (20) PREFORMED EXPANSION JOINT AT CONCRETE SIDEWALKS, DRIVEWAYS, AND MEDIANS. (INCLUDED IN THE COST OF CURB OR CURB AND GUTTER REMOVAL AND REPLACEMENT.)

UNSUITABLE SUB-BASE MATERIAL TO BE REMOVED, IF DIRECTED BY THE ENGINEER, SHALL BE REPLACED WITH EITHER SUB-BASE GRANULAR MATERIAL, TYPE B OR ADDITIONAL THICKNESS OF CONCRETE.

REMOVAL AND REPLACEMENT 4" (100) OR LESS IS INCLUDED IN THE COST OF CURB OR CURB AND GUTTER REMOVAL AND REPLACEMENT.

REMOVAL AND REPLACEMENT IN EXCESS OF 4" (100) WILL BE PAID FOR IN ACCORDANCE WITH ARTICLE 109.04 OF THE STANDARD SPECIFICATIONS.

PROPOSED #6 (20) EPOXY COATED TIE BARS 24" (600) LONG AT 24" (600) CENTERS WILL NOT BE PAID FOR SEPARATELY. DELETE EPOXY COATED TIE BARS IF EXISTING TIE BARS ARE USUABLE AS DETERMINED BY THE ENGINEER. (SEE NOTE ③).

**BASIS OF PAYMENT:**

THIS WORK WILL BE PAID FOR AT THE CONTRACT UNIT PRICE PER FOOT (METER) FOR "CURB REMOVAL AND REPLACEMENT" OR "COMBINATION CONCRETE CURB AND GUTTER REMOVAL AND REPLACEMENT".

EXISTING OR PROPOSED HMA SURFACE (IF APPLICABLE)  
SEE STATE STANDARD 606001  
1/4" (5) \*\*

18" (450) MAX.

T/2 \*

3" (75) MIN.

EXISTING CONCRETE PAVEMENT, CONCRETE BASE COURSE OR FLEXIBLE PAVEMENT

\* 3" (75) MINIMUM FROM TOP AND BOTTOM OF THE CONCRETE PAVEMENT OR BASE COURSE.

\*\* IF THE FINAL SURFACE OF THE PAVEMENT IS CONCRETE, THE GUTTER IS TO BE FLUSH WITH THE PAVEMENT.

NOTE: ① SIDEWALK, DRIVEWAY PAVEMENT OR MEDIAN SURFACE SHALL BE SIMILAR TO THE MATERIAL BEING REMOVED AND WILL BE PAID FOR SEPARATELY.

SODDING, SALT TOLERANT AND TOP SOIL, FURNISH AND PLACE 4" WILL BE PAID FOR SEPARATELY.

② FERTILIZER FOR THE PLACEMENT OF THE SOD IS NOT REQUIRED

③ CURB OR CURB AND GUTTER REPLACEMENT SHALL MATCH THE SHAPE OF THE EXISTING CURB OR CURB AND GUTTER UNLESS OTHERWISE SPECIFIED.

④ FOR CURB OR CURB AND GUTTER REMOVAL AND REPLACEMENT ADJACENT TO FLEXIBLE PAVEMENT DELETE EPOXY COATED TIE BARS.

⑤ LONGITUDINAL BARS, IF ENCOUNTERED IN THE EXISTING CURB OR CURB AND GUTTER, ARE NOT TO BE REPLACED. CUTTING AND REMOVING LONGITUDINAL BARS SHALL BE INCLUDED IN THE COST OF CURB OR CURB AND GUTTER REMOVAL AND REPLACEMENT.

⑥ THE COST OF HMA SURFACE REMOVAL IN THE EXISTING GUTTER FLAG SHALL BE INCLUDED IN THE COST OF THE CURB AND GUTTER REMOVAL AND REPLACEMENT.

⑦ THE REMOVAL AND REPLACEMENT OF THE EXISTING CURB OR CURB AND GUTTER SHALL BE DONE IN ACCORDANCE WITH THE APPLICABLE PORTIONS OF SECTION 440 AND 606 OF THE STANDARD SPECIFICATIONS.

⑧ THE LOCATIONS OF REMOVAL AND REPLACEMENT OF EXISTING CURB OR CURB AND GUTTER SHALL BE DETERMINED BY THE RESIDENT ENGINEER AT THE TIME OF CONSTRUCTION.

# CURB OR CURB AND GUTTER REMOVAL AND REPLACEMENT

ALL DIMENSIONS ARE IN INCHES (MILLIMETERS) UNLESS OTHERWISE SHOWN. \* VARIOUS

FILE NAME =	USER NAME = dr-ivkosgn	DESIGNED - A. HOUSEH	REVISED - R. SHAH 10-03-96	<b>STATE OF ILLINOIS DEPARTMENT OF TRANSPORTATION</b>	<b>CURB OR CURB AND GUTTER REMOVAL AND REPLACEMENT</b>	F.A. RTE.	SECTION	COUNTY	TOTAL SHEETS	SHEET NO.
cr:\pwr\work\pwr\dot\dr-ivkosgn\d0108315\bd24.dgn	DRAWN -	REVISED - A. ABBAS 03-21-97	REVISED - M. GOMEZ 01-22-01			*	2009-072 I	LAKE	14	10
PLOT SCALE = 50,000' / IN.	CHECKED -	REVISED - M. GOMEZ 01-22-01	REVISED - R. BORO 12-15-09			<b>BD600-06 (BD-24)</b>		CONTRACT NO. 60R82		
PLOT DATE = 12/15/2009	DATE - 03-11-94	REVISED - R. BORO 12-15-09	SCALE: NONE			SHEET NO. 1 OF 1 SHEETS	STA.	TO STA.	FED. ROAD DIST. NO. 1   ILLINOIS   FED. AID PROJECT	

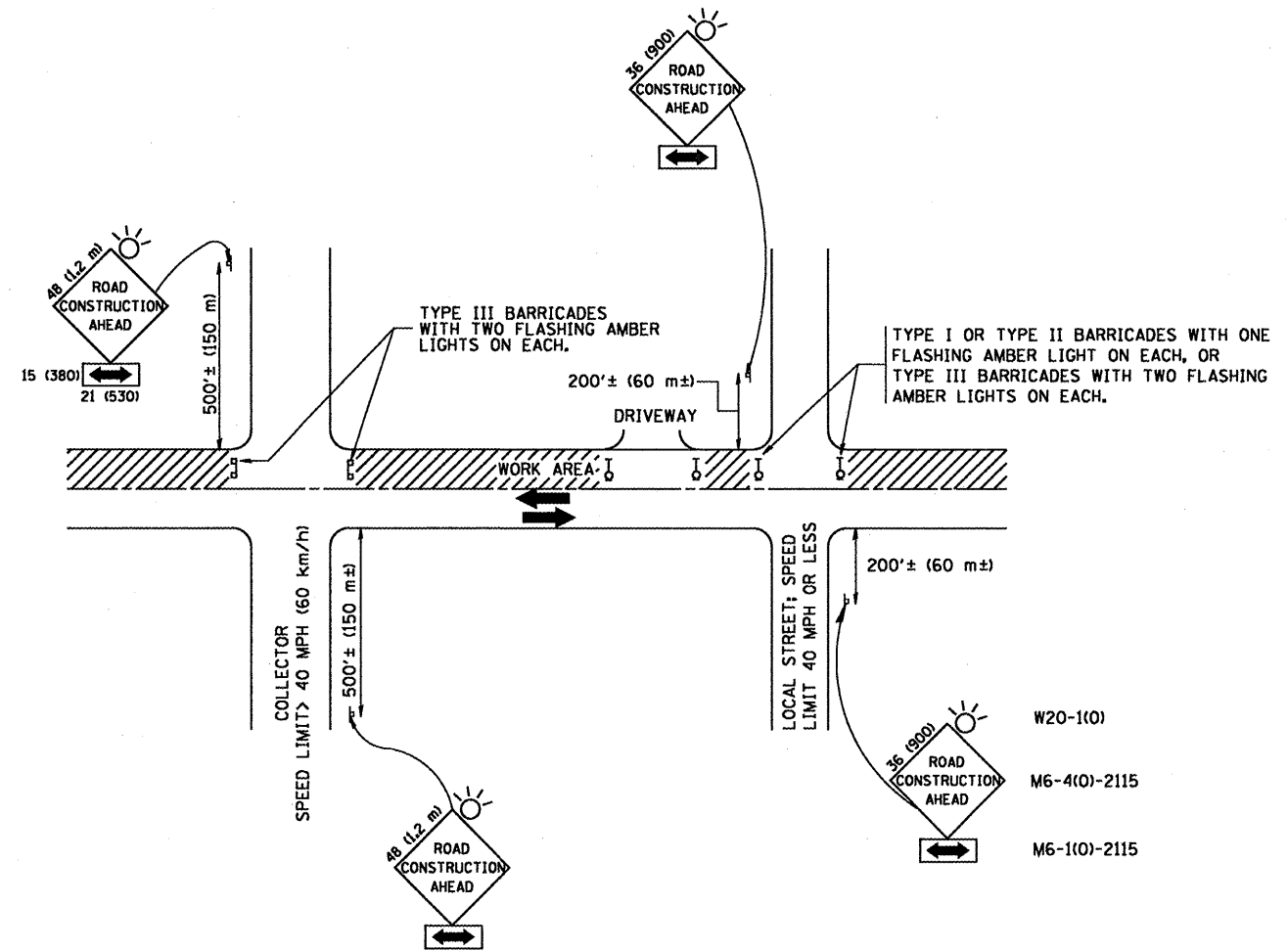

TRAFFIC CONTROL AND PROTECTION FOR SIDE ROADS, INTERSECTIONS, AND DRIVEWAYS

NOTES:

- A. FOR NO LANE RESTRICTION ON THE SIDE ROAD OR DRIVEWAYS
  1. SIDE ROAD WITH A SPEED LIMIT OF 40 MPH (60 km/h) OR LESS AS SHOWN ON THE DRAWING AND AS DIRECTED BY THE ENGINEER:
    - a) ONE ROAD CONSTRUCTION AHEAD SIGN 36 x 36 (900x900) WITH A FLASHER AND FLAG MOUNTED ON IT APPROXIMATELY 200' (60 m) IN ADVANCE OF THE MAIN ROUTE.
    - b) THE CLOSED PORTION OF THE MAIN ROUTE SHALL BE PROTECTED BY BLOCKING WITH TYPE I, TYPE II OR TYPE III BARRICADES, 1/3 OF THE CROSS SECTION OF THE CLOSED PORTION.
  2. SIDE ROAD WITH A SPEED LIMIT GREATER THAN 40 MPH (60 km/h) AS SHOWN ON THE DRAWING AND AS DIRECTED BY THE ENGINEER:
    - a) ONE ROAD CONSTRUCTION AHEAD SIGN 48 x 48 (1.2 m x 1.2 m) WITH A FLASHER MOUNTED ON IT APPROXIMATELY 500' (150 m) IN ADVANCE OF THE MAIN ROUTE.
    - b) THE CLOSED PORTION OF THE MAIN ROUTE SHALL BE PROTECTED BY BLOCKING WITH TYPE III BARRICADES, 1/2 OF THE CROSS SECTION OF THE CLOSED PORTION.
- 3. WHEN THE SIDE ROAD LIES BETWEEN THE BEGINNING OF THE MAINLINE SIGNING AND THE WORK ZONE, A SINGLE HEADED ARROW (M6-1) SHALL BE USED IN LIEU OF THE DOUBLE HEADED ARROW (M6-4).
- B. FOR A LANE CLOSURE ON A SIDE ROAD OR DRIVEWAY:
 

USE APPLICABLE PORTIONS OF THE TYPICAL APPLICATION OF TRAFFIC CONTROL DEVICES (STD. 701501, STD. 701606 OR THE APPROPRIATE STANDARD). THE SPACING OF SIGNS AND BARRICADES SHALL BE ADJUSTED FOR FIELD CONDITIONS AS DIRECTED BY THE ENGINEER. THE DIRECTIONAL ARROW SHALL BE COVERED OR REMOVED WHEN NO LONGER CONSISTENT WITH THE SIDE ROAD LANE CLOSURE.
- C. ADVANCE WARNING SIGNS ARE TO BE OMITTED ON DRIVEWAY UNLESS OTHERWISE NOTED.
- D. THE TRAFFIC CONTROL AND PROTECTION FOR SIDE ROADS, INTERSECTIONS, AND DRIVEWAYS SHALL BE INCIDENTAL TO THE COST OF SPECIFIED TRAFFIC CONTROL STANDARDS OR ITEMS.

All dimensions are in millimeters (inches) unless otherwise shown. \* VARIOUS

FILE NAME = W:\distatd\22x34\to18.dgn	USER NAME = gaglianobt	DESIGNED - LHA	REVISED - J. OBERLE 10-18-95	<b>STATE OF ILLINOIS DEPARTMENT OF TRANSPORTATION</b>	<b>TRAFFIC CONTROL AND PROTECTION FOR SIDE ROADS, INTERSECTIONS, AND DRIVEWAYS</b>	F.A. RTE. *	SECTION	COUNTY	TOTAL SHEETS	SHEET NO.
	PLOT SCALE = 50.000' / IN.	CHECKED -	REVISED - A. HOUSEH 03-06-96			*	2009-072 I	LAKE	14	11
PLOT DATE = 1/4/2008	DATE - 06-89	REVISED - T. RAMMACHER 01-06-00		SCALE: NONE	SHEET NO. 1 OF 1 SHEETS	STA.	TO STA.	TC-10 CONTRACT NO. 60R82		
						FED. ROAD DIST. NO. 1 ILLINOIS FED. AID PROJECT				

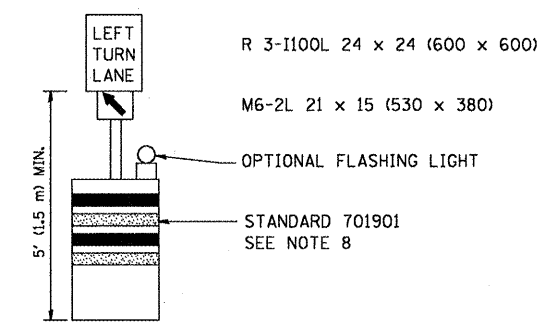
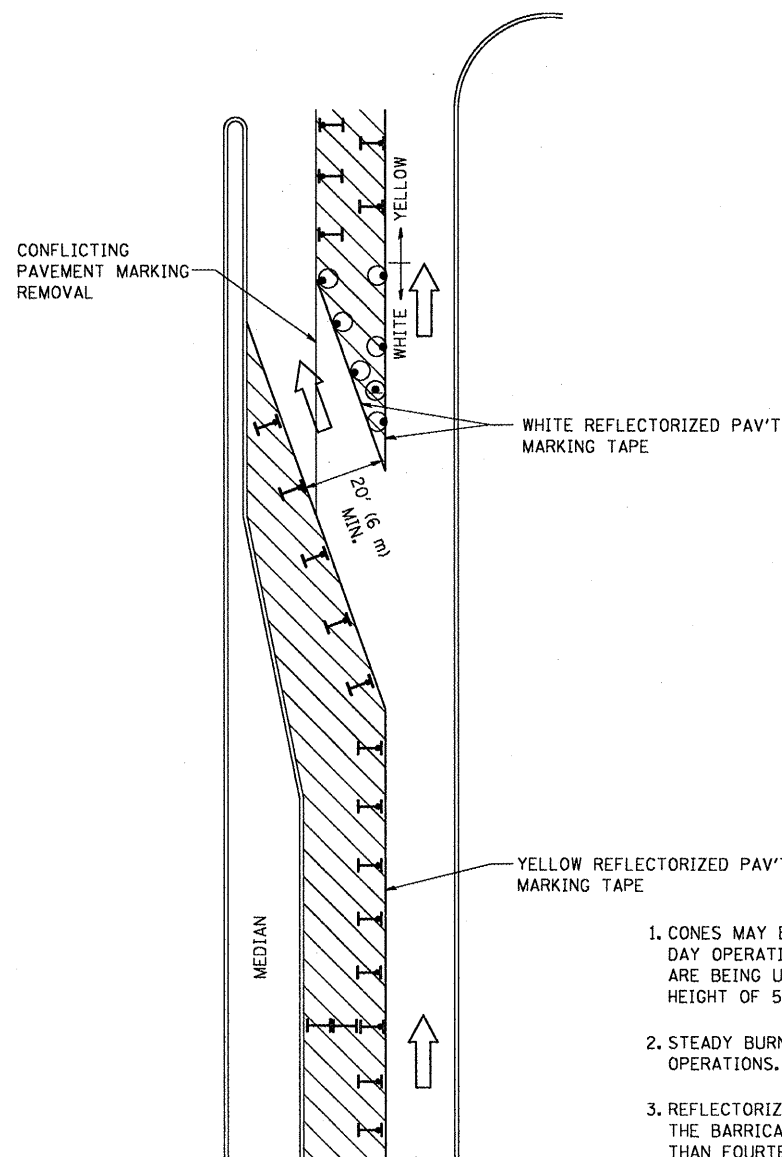





**GENERAL NOTES**

1. CONES MAY BE SUBSTITUTED FOR BARRICADES OR DRUMS AT HALF THE SPACING DURING DAY OPERATIONS. CONES SHALL BE A MINIMUM OF 28 (710) IN HEIGHT. WHEN CONES ARE BEING USED, THE "LEFT TURN LANE" SIGN MAY BE SKID MOUNTED AT A MINIMUM HEIGHT OF 5' (1.5 m).
2. STEADY BURNING LIGHTS WILL NOT BE REQUIRED ON BARRICADES OR DRUMS FOR DAY OPERATIONS. ALL LIGHTS SHALL BE MONODIRECTIONAL.
3. REFLECTORIZED TEMPORARY PAVEMENT MARKING TAPE SHALL BE PLACED THROUGHOUT THE BARRICADED AREA OF EACH TURN BAY WHERE THE CLOSURE TIME IS GREATER THAN FOURTEEN DAYS.
4. THIS APPLICATION ALSO APPLIES WHEN WORK IS BEING PERFORMED IN THE RIGHT LANE(S) AND THE RIGHT TURN BAY IS TO REMAIN OPEN. UNDER THIS CONDITION, "RIGHT TURN LANE" R3-100 24 x 24 (600 x 600) AND M6-2R 21 x 15 (530 x 380) SHALL BE USED.
5. THESE CONTROLS SHALL SUPPLEMENT MAINLINE TRAFFIC CONTROL FOR LANE CLOSURES.
6. LONGITUDINAL DIMENSIONS MAY BE ADJUSTED TO FIT FIELD CONDITIONS.
7. FORM OPER 725 IS REQUIRED.
8. IF A DRUM OR TYPE II BARRICADE WITH AN ATTACHED SIGN PANEL WHICH MEETS NCHRP 350 REQUIREMENTS IS NOT AVAILABLE, THE SIGNS SHALL BE MOUNTED, ABOVE THE BARRICADES, ON SEPARATE SIGNS SUPPORTS THAT MEET NCHRP 350 REQUIREMENTS.
9. TRAFFIC CONTROL AND PROTECTION AT TURN BAYS (TO REMAIN OPEN TO TRAFFIC) SHALL BE INCLUDED IN THE COST SPECIFIED TRAFFIC CONTROL STANDARDS OR ITEMS.

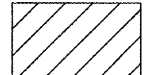
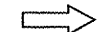
All dimensions are in inches (millimeters) unless otherwise shown.

**LEGEND**

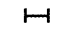
-  WORK AREA
-  LANE OPEN TO TRAFFIC
-  TYPE I OR II BARRICADE WITH STEADY BURN LIGHT
-  DRUM WITH STEADY BURN LIGHT
-  DRUM WITH SIGN (WITH OPTIONAL FLASHING LIGHT) SEE DETAIL
-  TYPE I OR II CHECK BARRICADE WITH FLASHING LIGHT

\* VARIOUS

FILE NAME =	USER NAME = drivakosgn	REVISED -T. RAMMACHER 09-08-94	REVISED - R. BORO 09-14-09
ct\pwwork\pwidot\DRIVAKOSGN\d0108315\14.dgn		REVISED - A. HOUSEH 11-07-95	REVISED -
		REVISED - A. HOUSEH 10-12-96	REVISED -
PLOT SCALE = 49.9999 / IN.		REVISED -T. RAMMACHER 01-06-00	REVISED -
PLOT DATE = 9/14/2009			

**STATE OF ILLINOIS  
DEPARTMENT OF TRANSPORTATION**

<b>TRAFFIC CONTROL AND PROTECTION AT TURN BAYS (TO REMAIN OPEN TO TRAFFIC)</b>			
SCALE: NONE	SHEET NO. 1 OF 1 SHEETS	STA.	TO STA.

F.A. RTE.	SECTION	COUNTY	TOTAL SHEETS	SHEET NO.
*	2009-072 I	LAKE	14	12
<b>TC-14</b>			CONTRACT NO. 60882	
FED. ROAD DIST. NO. 1 ILLINOIS FED. AID PROJECT				

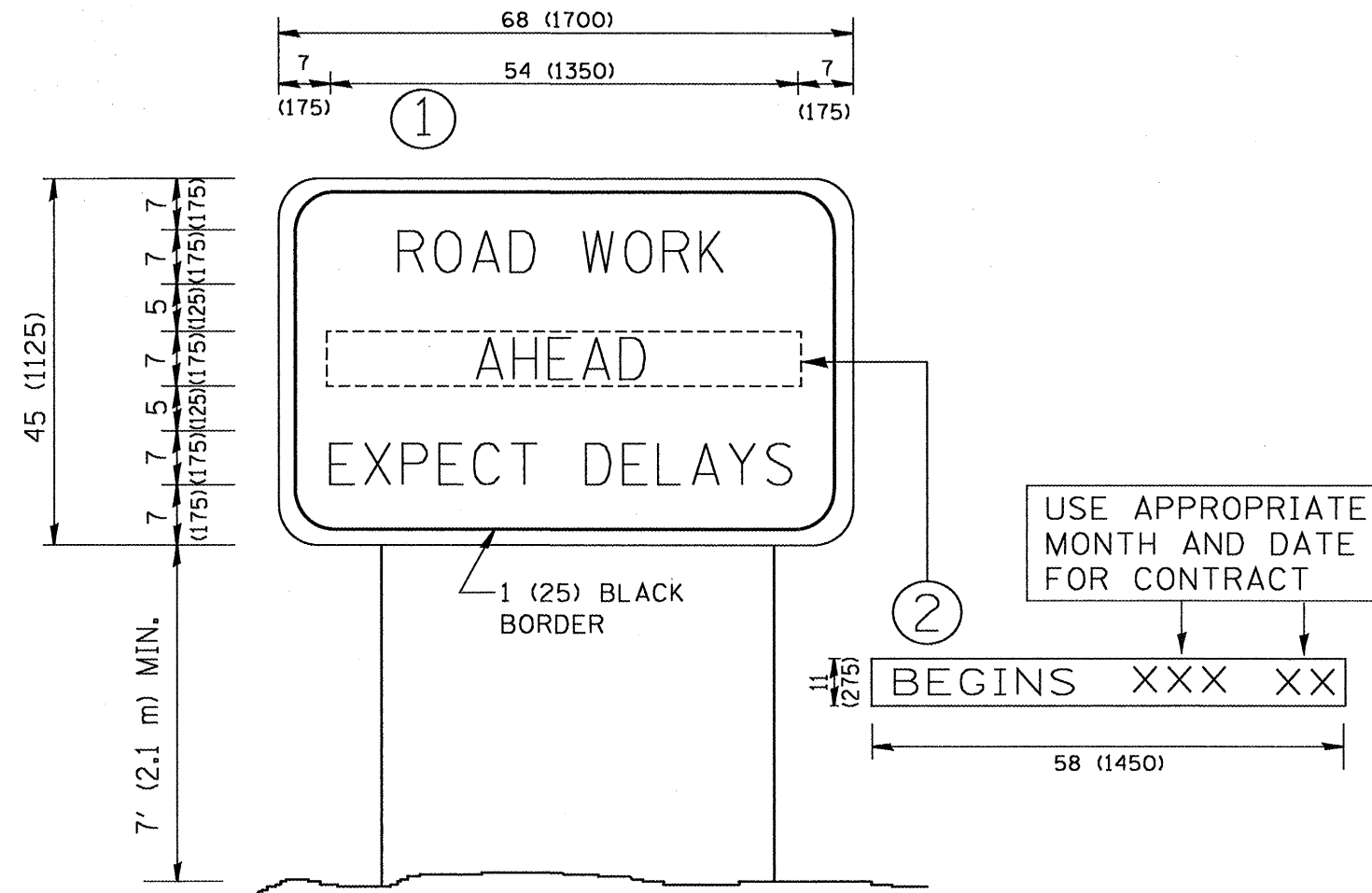

**NOTES:**

1. USE BLACK LETTERING ON ORANGE BACKGROUND.
2. ERECT SIGNS IN ADVANCE OF THE LOCATION FOR THE "ROAD CONSTRUCTION AHEAD" SIGN AT LOCATIONS AS DIRECTED BY THE ENGINEER.
3. ERECT SIGN ① WITH INSTALLED PANEL ② ONE WEEK PRIOR TO THE START OF CONSTRUCTION.
4. REMOVE PANEL ② SOON AFTER THE START OF CONSTRUCTION.
5. SEE SPECIAL PROVISION FOR "TEMPORARY INFORMATION SIGNING" FOR ADDITIONAL INFORMATION.
6. ONE SIGN ASSEMBLY EQUALS 25.70 SQ. FT. (2.3 SQ. M.)
7. SHALL BE PAID FOR AS TEMPORARY INFORMATION SIGNING.

ALL DIMENSIONS ARE IN INCHES (MILLIMETERS) UNLESS OTHERWISE SHOWN.

\* VARIOUS

FILE NAME = W:\distatd\22x34\to22.dgn	USER NAME = geglentobt	DESIGNED -	REVISED - R. MIRS 09-15-97	<b>STATE OF ILLINOIS DEPARTMENT OF TRANSPORTATION</b>	<b>ARTERIAL ROAD INFORMATION SIGN</b>			F.A. RTE. *	SECTION	COUNTY	TOTAL SHEETS	SHEET NO.
	PLOT SCALE = 50.000' / IN.	CHECKED -	REVISED - R. MIRS 12-11-97					*	2009-072 I	LAKE	14	13
PLOT DATE = 1/4/2008	DATE -	REVISED - T. RAMMACHER 02-02-99	REVISED - C. JUCIUS 01-31-07	SCALE: NONE	SHEET NO. 1 OF 1 SHEETS	STA.	TO STA.	TC-22		CONTRACT NO. 60R82		
								FED. ROAD DIST. NO. 1   ILLINOIS FED. AID PROJECT				

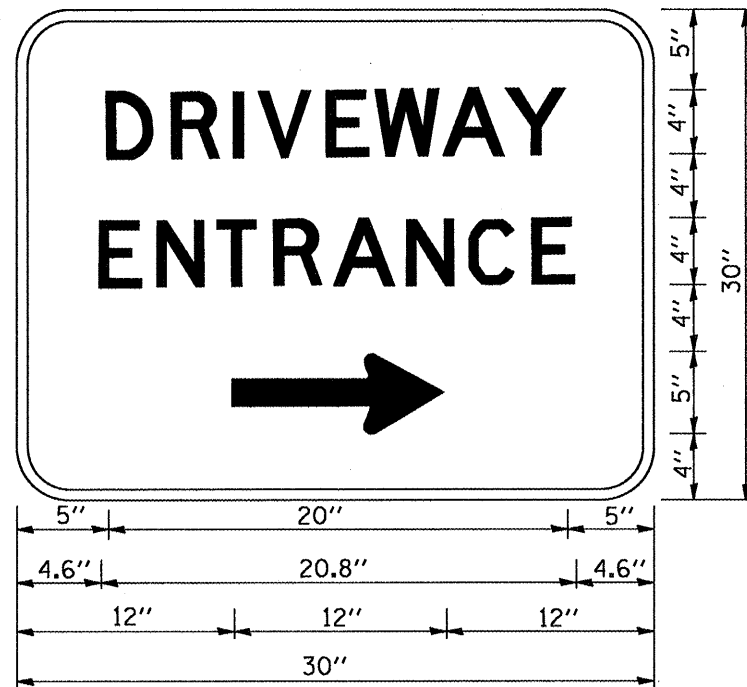

3.0" RADIUS, 0.5" BORDER, WHITE ON GREEN; REFLECTORIZED  
 "DRIVEWAY" D; "ENTRANCE" D; STANDARD ARROW CUSTOM 12.0" x 5.0"

**NOTES:**

1. HALF OF THE SIGNS WILL REQUIRE A LEFT HAND FACING ARROW.
2. TWO SIGNS SHALL BE USED AT EACH COMMERCIAL ENTRANCE PLACED BACK-TO-BACK: ONE WITH A RIGHT HAND ARROW (SHOWN) SHALL BE PLACED ON THE NEAR RIGHT SIDE THE DRIVEWAY AND ONE WITH A LEFT HAND ARROW SHALL BE PLACED ON THE FAR LEFT SIDE OF THE DRIVEWAY.
3. SIGNS TO BE PAID FOR AS ITEM "TEMPORARY INFORMATION SIGNING".

\* VARIOUS

FILE NAME = W:\diststd\22x34\to26.dgn	USER NAME = geglennobt	DESIGNED -	REVISED - C. JUCIUS 02-15-07	<b>STATE OF ILLINOIS DEPARTMENT OF TRANSPORTATION</b>	<b>DRIVEWAY ENTRANCE SIGNING</b>			F.A. RTE. *	SECTION	COUNTY	TOTAL SHEETS	SHEET NO.	
	PLOT SCALE = 50.000 ' / IN.	DRAWN -	REVISED -					* 2009-072 I	LAKE	14	14		
	PLOT DATE = 1/4/2008	CHECKED -	REVISED -		SCALE: NONE			SHEET NO. 1 OF 1 SHEETS STA. TO STA.			TC-26 CONTRACT NO. 60882		
		DATE -	REVISED -		FED. ROAD DIST. NO. 1 [ILLINOIS] FED. AID PROJECT								