

TRAFFIC SIGNAL LEGEND

	PROPOSED	EXISTING
DETECTOR LOOP		
SIGNAL HEAD		
G.S. CONDUIT IN TRENCH OR PUSHED		
SIGNAL HEAD WITH BACKPLATE		
RACEWAY FOR MAGNETIC DETECTOR, TYPE I OR II		
VEHICLE DETECTOR, NON-COMPENSATED MAGNETIC TYPE		

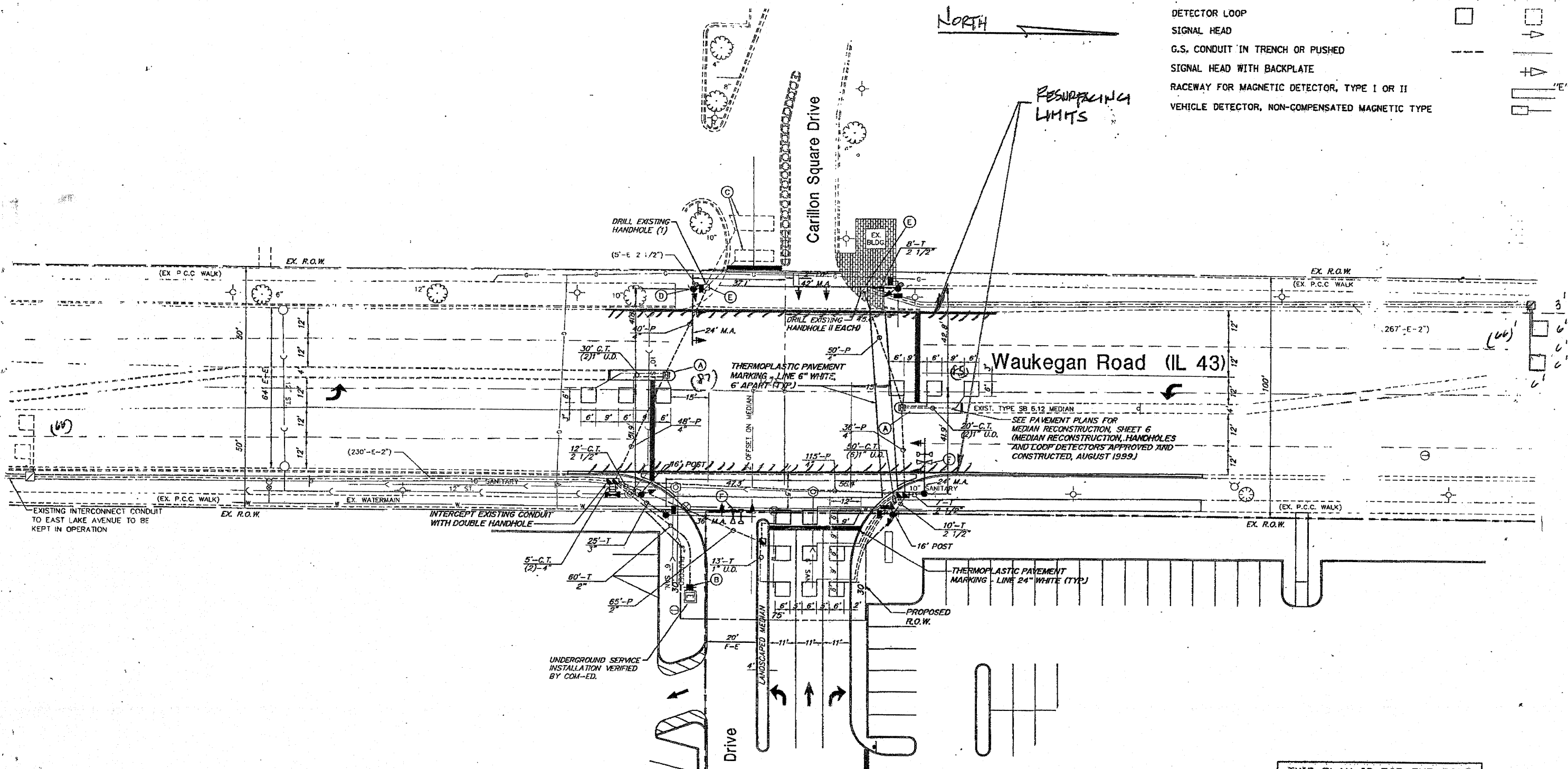
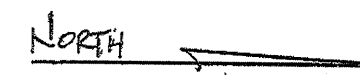

THIS PLAN IS FOR THE SOLE PURPOSE OF DETECTOR LOOP REPLACEMENTS ONLY

REPLACE ALL DETECTOR LOOPS AS SHOWN (WITHIN THE RESURFACING LIMITS)

CODE	QUANTITY	UNIT	ITEM
86600600	304	FOOT	DETECTOR LOOP, REPLACEMENT

FILE NAME =	USER NAME = kenthaphixaybo	DESIGNED - BCK	REVISED -
4:\work\PH\DOT\KANTHAPHIXAYBO\01126	4:\work\PH\DOT\KANTHAPHIXAYBO\01126	DRAWN - BCK	REVISED -
		CHECKED - DAD	REVISED -
		DATE -	REVISED -

STATE OF ILLINOIS
DEPARTMENT OF TRANSPORTATION

DISTRICT ONE - DETECTOR LOOP REPLACEMENT
ILL. ROUTE 43 (WAUKEGAN) @ CARILLON SQ.

F.A.P. RTE.	SECTION	COUNTY	TOTAL SHEETS	SHEET NO.
SAF 571 (R1) R1-4		COOK	35	31

SCALE: NONE SHEET NO. OF SHEETS STA. TO STA. CONTRACT NO. 60-01