

STATE OF ILLINOIS
DEPARTMENT OF TRANSPORTATION

GENERAL NOTES

Reinforcement bars shall conform to the requirements of ASTM A 706 Gr 60. See Special Provisions.

Plan dimensions and details relative to existing plans are subject to nominal construction variations. The Contractor shall field verify existing dimensions and details affecting new construction and make necessary approved adjustments prior to construction or ordering of materials. Such variations shall not be cause for additional compensation for a change in scope of the work, however, the Contractor will be paid for the quantity actually furnished at the unit price bid for the work.

Shoulder material shall be replaced in kind. The cost of this work shall be incidental to Structure Excavation.

Temporary concrete barrier included in the cost of Traffic Control & Protection. (See Roadway Plans.)

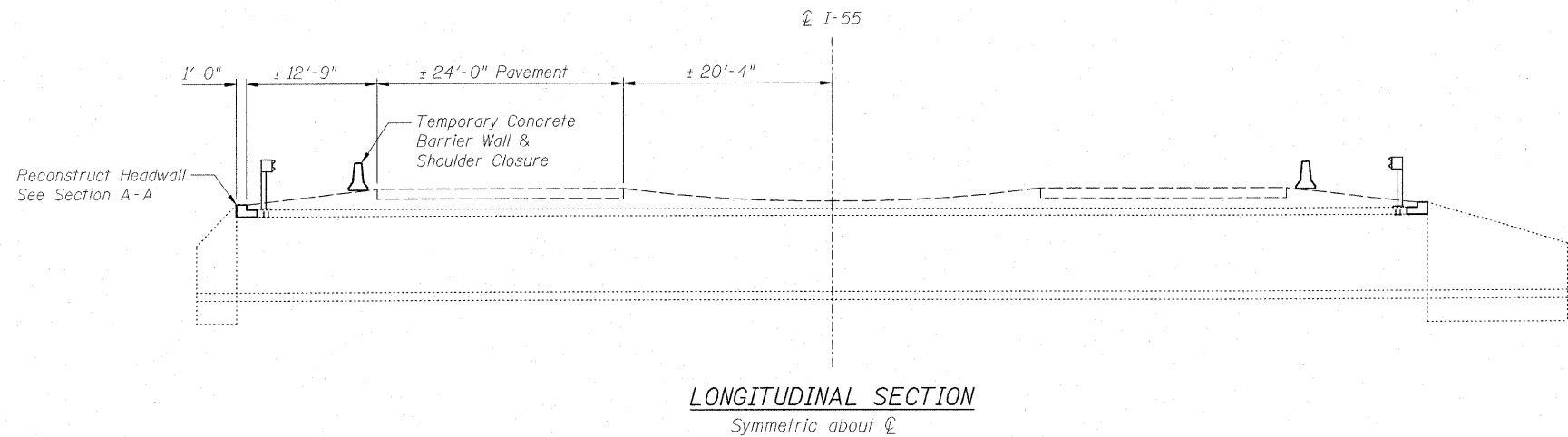

TOTAL BILL OF MATERIAL

ITEM	UNIT	TOTAL
Concrete Removal	Cu. Yd.	5.2
Concrete Box Culverts	Cu. Yd.	5.2
Reinforcement Bars	Pound	2000
REMOVE AND RE-ERECT Steel Plate Beam Guardrail, TYPE B	Ft.	82
Structural Repair of Concrete (Depth Equal to or Less than 5 in.)	Sq. Ft.	15.8
Structure Excavation	Cu. Yd.	9.0

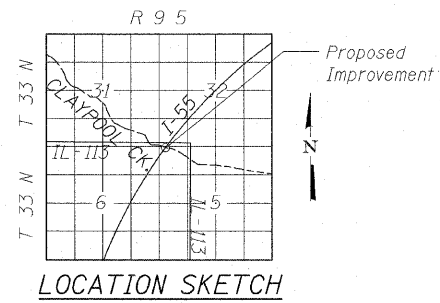
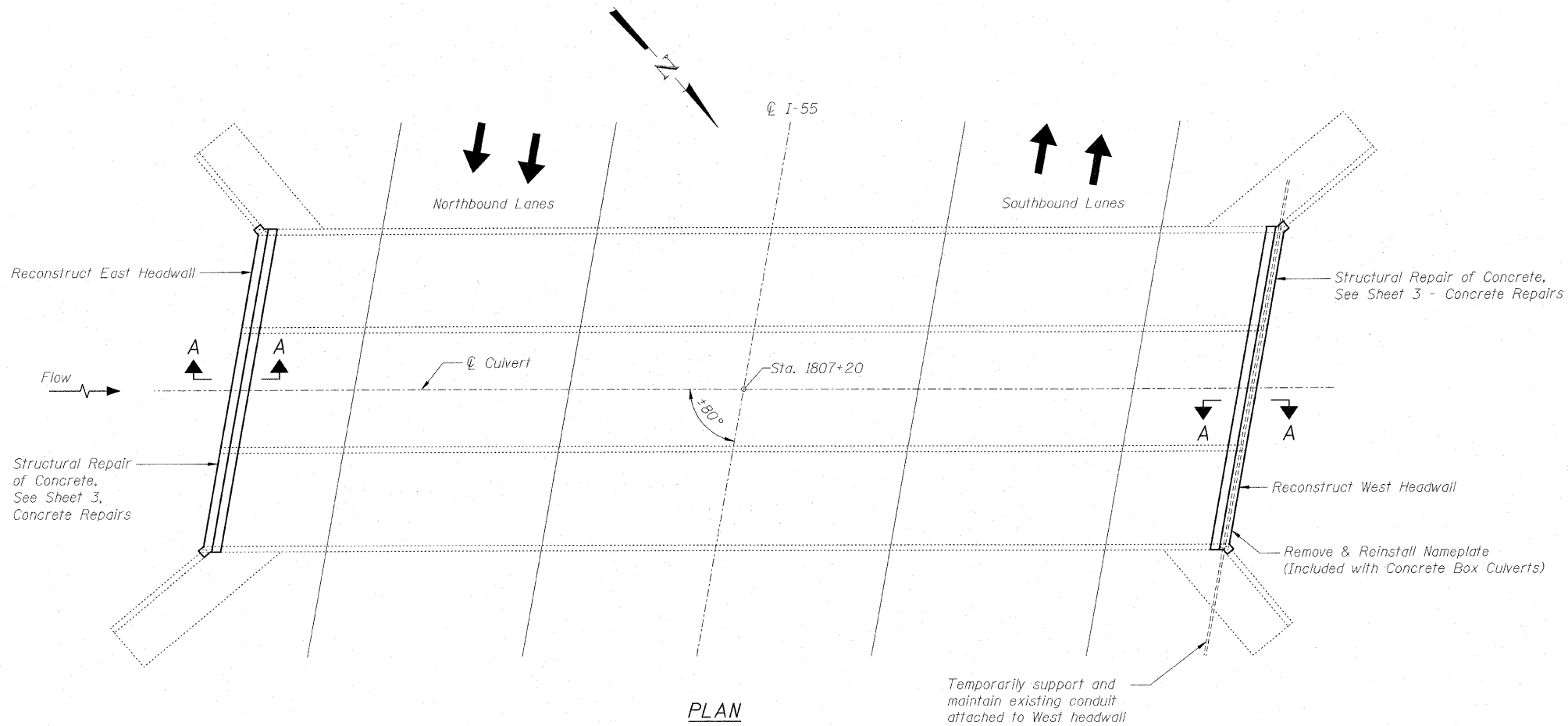

INDEX OF SHEETS:

1. General Plan & Section
2. Headwall Reconstruction
3. Concrete Repairs

**GENERAL PLAN & SECTION
I-55 OVER CLAYPOOL CREEK
FAI ROUTE 55 - SECTION 90R
WILL COUNTY
STATION 1807+20
STRUCTURE NO. 099-2000**

DESIGNED	BRT
CHECKED	BJM
DRAWN	JNH
CHECKED	BJM

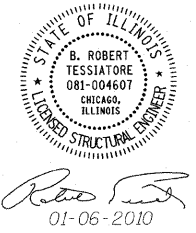

Wight & Company
2500 North Frontage Road, Darien, IL 60561
630.969.7000 630.969.7979 fax
Design Firm Registration 184-000451

SHEET NO. 1 3 SHEETS	F.A.I. RTE.	SECTION	COUNTY	TOTAL SHEETS	SHEET NO.
	55	99 (1+2) RS-1-1	WILL	45	32
CONTRACT NO. 60153					
FED. ROAD DIST. NO. ILLINOIS FED. AID PROJECT					