

TYPICAL ENTRANCE/EXIT RAMP COMBINATION PAVEMENT MARKINGS

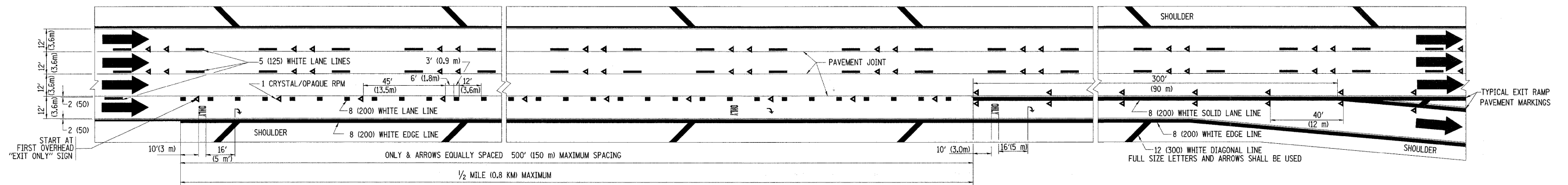

TYPICAL EXIT ONLY LANE PAVEMENT MARKINGS

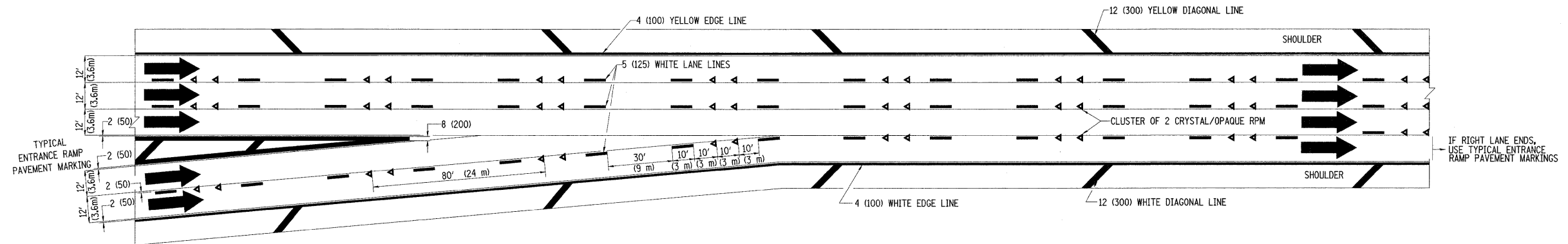

TYPICAL TWO LANE ENTRANCE RAMP PAVEMENT MARKINGS

FILE NAME =	USER NAME = abebawa	DESIGNED - D.W.S.	REVISED - A.H. 03-96	STATE OF ILLINOIS DEPARTMENT OF TRANSPORTATION	MULTI-LANE FREEWAY PAVEMENT MARKING DETAILS			F.A.I. RTE.:	SECTION	COUNTY	TOTAL SHEETS	SHEET NO.	
et:\pw\work\p\DOT\ABEBAWA\0169692\01st	td.dgn	DRAWN -	REVISED - D.W.S. 07-96		SCALE: NONE	SHEET NO. 2 OF 2 SHEETS	STA.	TO STA.	55	99 (1&2) RS-11	WILL	45	41
	PLOT SCALE = 5/8" = 1' IN.	CHECKED -	REVISED - J.A.F. 02-06						TC-12				
	PLOT DATE = 12/23/2009	DATE - 01-90	REVISED - S.P.B. 01-07						CONTRACT NO. 60153				

FED. ROAD DIST. NO. 1 | ILLINOIS | FED. AID PROJECT