

STATE OF ILLINOIS  
DEPARTMENT OF TRANSPORTATION

GENERAL NOTES

All structural steel shall conform to AASHTO Classification M-270 Gr. 36, unless otherwise noted.  
Diaphragm connection holes shall be  $\frac{15}{16}$ "  $\phi$  for  $\frac{3}{4}$ " bolts. Two hardened washers shall be required at diaphragm connections.  
Fasteners shall be high strength bolts. Bolts  $\frac{7}{8}$ "  $\phi$ , open holes  $\frac{15}{16}$ "  $\phi$ , unless otherwise noted.

The Contractor shall provide support and/or shoring systems for the slab and beam in the area of existing beam removal. See Special Provisions "Temporary Shoring and Cribbing" and "Temporary Slab Support System."

Plan dimensions and details relative to existing plans are subject to nominal construction variations. The Contractor shall field verify existing dimensions and details affecting new construction and make necessary approved adjustments prior to construction or ordering of materials. Such variations shall not be cause for additional compensation for a change in scope of the work, however, the Contractor will be paid for the quantity actually furnished at the unit price bid for the work.

Cost of removal and re-installation of all members necessary to complete the work as detailed on the plans and as specified in the Special Provisions shall be included with Furnishing and Erecting Structural Steel.

The existing structural steel coating contains lead. The Contractor shall take appropriate precautions to deal with the presence of lead on this project.

The Inorganic Zinc Rich Primer / Acrylic / Acrylic Paint System shall be used for shop and field painting of new structural steel except where otherwise noted. The color of the final finish coat shall be Interstate Green, Munsell No. 7.5G 4/8. See Special Provision "Cleaning and Painting New Metal Structures".

Existing reinforcement bars extending into the removal area shall be cleaned, straightened and incorporated into the new construction. Any reinforcement bars that are damaged during concrete removal shall be replaced with an approved bar splicer or anchorage system. Cost included with Concrete Removal.

After the new beam is in its final position and/or beam straightening operations have been completed, the Engineer in the field shall check to see that the top flange is tight against the slab. If not, the Contractor shall inject epoxy between the existing concrete deck and the top flange of the beam. See Special Provision "Epoxy Injection".

Existing structural steel that will be in contact with new structural steel shall be cleaned and painted prior to erection as required by the Special Provision "Cleaning and Painting Contact Surface Areas of Existing Steel Structures".

Load carrying components designated "NTR" shall conform to the Supplemental Requirements for Notch Toughness, Zone 2.

The Contractor must be careful not to damage the existing bearing to be reused while removing the beam section to be replaced.

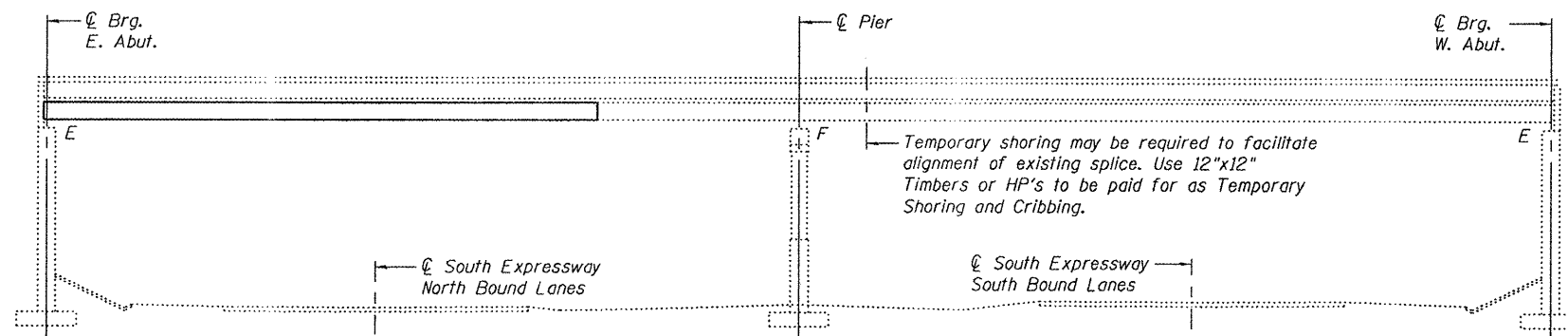

ELEVATION

Existing sign structure to be removed, stored and reinstalled. Cost included with Remove, Store and Re-Erect Overhead Sign Structure (Bridge Mounted)

Permanent Protective Shield in this area to be removed, stored and reinstalled. Cost included with Structural Steel Removal.

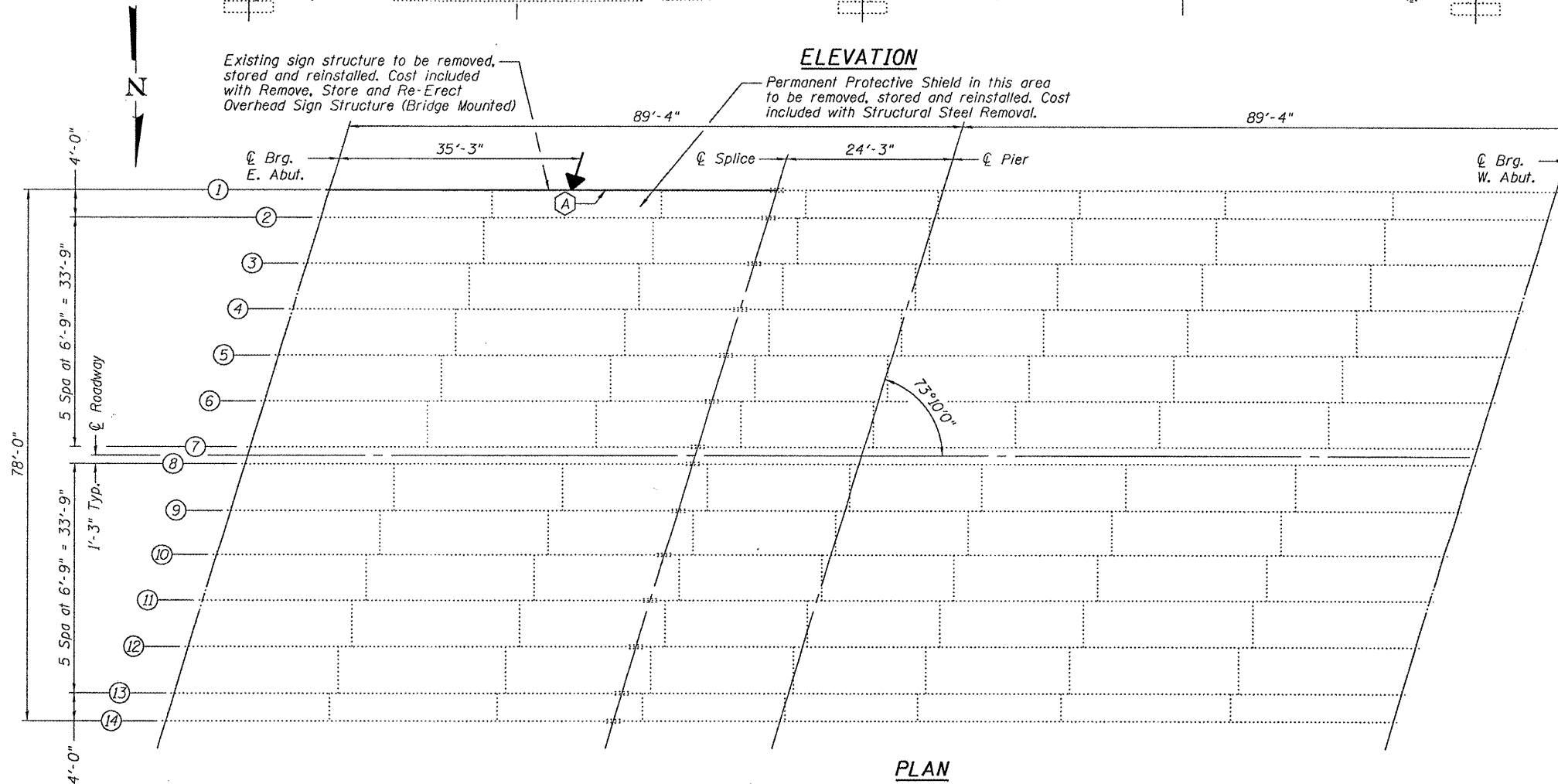

PLAN

(A) Remove and Replace existing beam section.

Impact  
Line →

TOTAL BILL OF MATERIAL

ITEM	UNIT	QUANTITY
Concrete Removal	Cu. Yd.	0.5
Concrete Superstructure	Cu. Yd.	0.5
Furnishing and Erecting Structural Steel	Pound	12,490
Structural Steel Removal	Pound	12,490
Temporary Slab Support System	L.S.	1
Temporary Shoring and Cribbing	L.S.	1
Remove, Store and Re-Erect Overhead Sign Structure-Bridge Mounted	Each	1

PLAN AND ELEVATION  
SN 016-0575

DESIGNED BY: William J. Holloway  
CHECKED: William K. Veltz  
DRAWN: [Signature]  
CHECKED: ASH VSTU

EXAMINED: [Signature]  
PASSED: Ralph E. Anderson  
ENGINEER OF BRIDGES AND STRUCTURES

January 22, 2010



Expires: November 30, 2010

SHEET NO.	F.A.I. RTE.	SECTION	COUNTY	TOTAL SHEETS	SHEET NO.
1	57	0203-1001 HB	Cook	11	5
2 SHEETS		CONTRACT NO.		60J19	
FED. ROAD DIST. NO.		ILLINOIS FED. AID PROJECT			