

F.A.U. RTE.	SECTION	COUNTY	TOTAL SHEETS	SHEET NO.
0085	00-00246-01-FP	MCHENRY	236	124
STA.	TO STA.			
FED. ROAD DIST. NO. 1	ILLINOIS	FED. AID PROJECT		
CONTRACT NO: 63266				

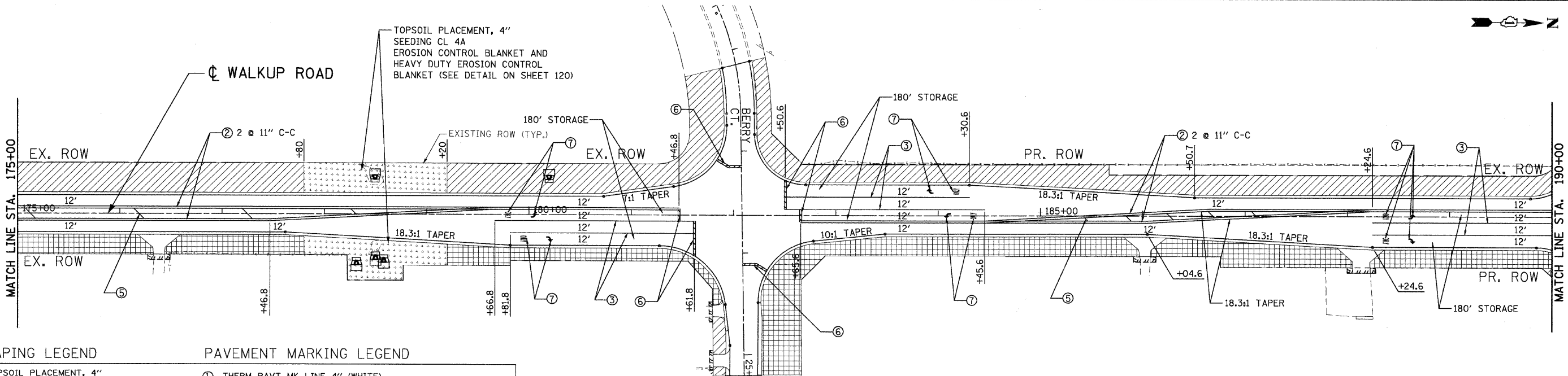
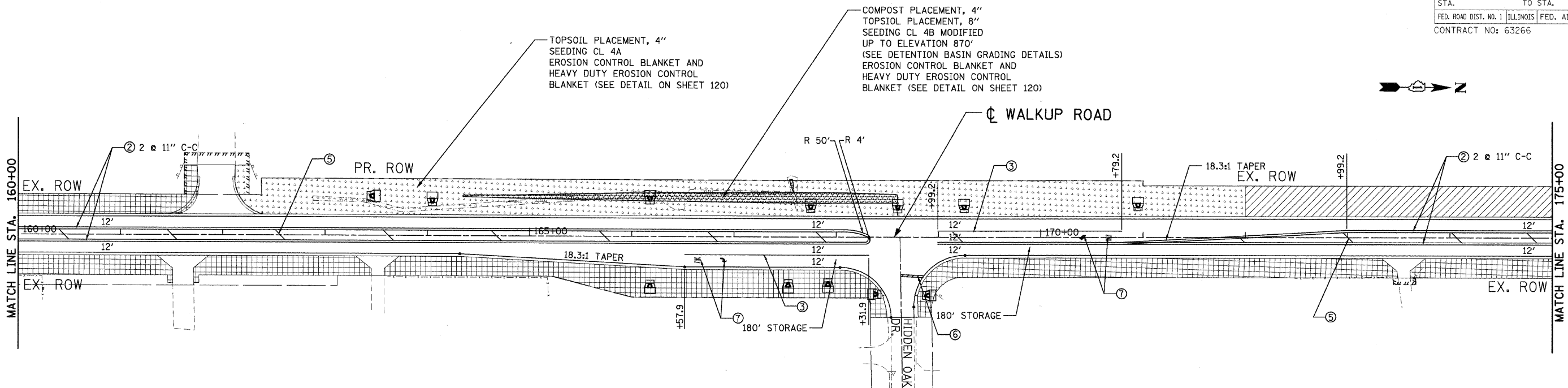

**LANDSCAPING LEGEND**

- TOPSOIL PLACEMENT, 4" SEEDING CL 2A EROSION CONTROL BLANKET AND HEAVY DUTY EROSION CONTROL BLANKET (SEE DETAIL ON SHEET 120)
- SODDING SALT TOLERANT AND TURF REINFORCEMENT MAT (SEE DETAIL ON SHEET 120)
- SODDING, SALT TOLERANT

**PAVEMENT MARKING LEGEND**

- ① THERM PAVT MK LINE 4" (WHITE)
- ② THERM PAVT MK LINE 4" (YELLOW)
- ③ THERM PAVT MK LINE 6" (WHITE)
- ④ THERM PAVT MK LINE 12" (WHITE)
- ⑤ THERM PAVT MK LINE 12" (YELLOW)
- ⑥ THERM PAVT MK LINE 24" (WHITE)
- ⑦ THERM PAVT MK L&S

PAVEMENT MARKING TO FOLLOW IDOT D1 DETAIL TC-13.

REVISIONS	
NAME	DATE

MCHENRY COUNTY DIVISION OF TRANSPORTATION  
WALKUP ROAD F.A.U. 0085

**PAVT MARKING & LANDSCAPING**  
WALKUP ROAD  
STA 160+00 TO STA 190+00

SCALE: 1" = 50'  
DATE: 12/01/09  
DRAWN BY: MZD  
CHECKED BY: MCD

**TENG**  
TENG & ASSOCIATES, INC.  
ENGINEERS/ARCHITECTS/PLANNERS  
209 N. MICHIGAN AVE., CHICAGO, IL 60601  
TELEPHONE: 312/616-0000

\ALT\0040A.DGN, \P\WORKSPACE.DGN, \TERRORY.V.DGN, \R\WORKSPACE.DGN, \L\00000001.DGN, \L\00000002.DGN, \L\00000003.DGN, \L\00000004.DGN, \L\00000005.DGN, \L\00000006.DGN, \L\00000007.DGN, \L\00000008.DGN, \L\00000009.DGN, \L\00000010.DGN, \L\00000011.DGN, \L\00000012.DGN, \L\00000013.DGN, \L\00000014.DGN, \L\00000015.DGN, \L\00000016.DGN, \L\00000017.DGN, \L\00000018.DGN, \L\00000019.DGN, \L\00000020.DGN, \L\00000021.DGN, \L\00000022.DGN, \L\00000023.DGN, \L\00000024.DGN, \L\00000025.DGN, \L\00000026.DGN, \L\00000027.DGN, \L\00000028.DGN, \L\00000029.DGN, \L\00000030.DGN, \L\00000031.DGN, \L\00000032.DGN, \L\00000033.DGN, \L\00000034.DGN, \L\00000035.DGN, \L\00000036.DGN, \L\00000037.DGN, \L\00000038.DGN, \L\00000039.DGN, \L\00000040.DGN, \L\00000041.DGN, \L\00000042.DGN, \L\00000043.DGN, \L\00000044.DGN, \L\00000045.DGN, \L\00000046.DGN, \L\00000047.DGN, \L\00000048.DGN, \L\00000049.DGN, \L\00000050.DGN, \L\00000051.DGN, \L\00000052.DGN, \L\00000053.DGN, \L\00000054.DGN, \L\00000055.DGN, \L\00000056.DGN, \L\00000057.DGN, \L\00000058.DGN, \L\00000059.DGN, \L\00000060.DGN, \L\00000061.DGN, \L\00000062.DGN, \L\00000063.DGN