

F.A.U. RTE.	SECTION	COUNTY	TOTAL SHEETS	SHEET NO.
0085	00-00246-01-FP	MCHENRY	236	29
STA.		TO STA.		
FED. ROAD DIST. NO. 1		ILLINOIS FED. AID PROJECT		
CONTRACT NO: 63266				

EXISTING PLAN  
MATCH LINE STA. 115+00

PROPOSED PLAN  
MATCH LINE STA. 115+00

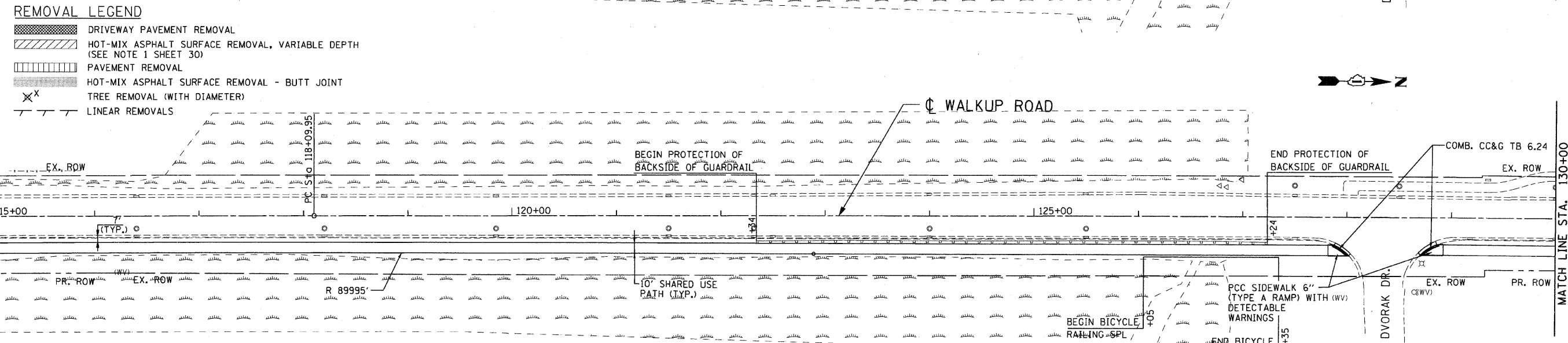
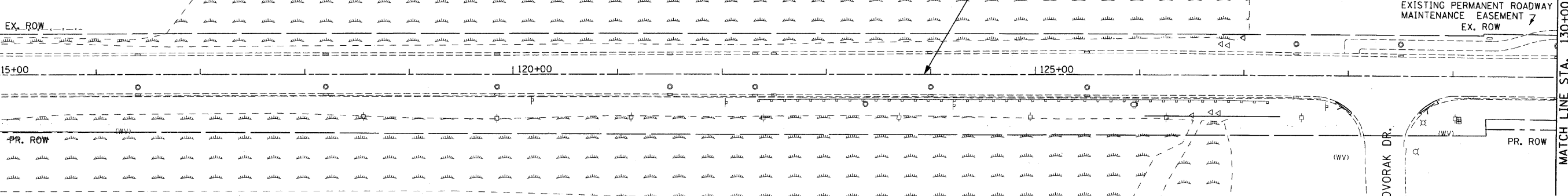

**REMOVAL LEGEND**

	DRIVEWAY PAVEMENT REMOVAL
	HOT-MIX ASPHALT SURFACE REMOVAL, VARIABLE DEPTH (SEE NOTE 1 SHEET 30)
	PAVEMENT REMOVAL
	HOT-MIX ASPHALT SURFACE REMOVAL - BUTT JOINT
	TREE REMOVAL (WITH DIAMETER)
	LINEAR REMOVALS

PLAN	DATE
BY	
NO.	
DATE	
BY	
NO.	
DATE	

PROFILE	DATE
BY	
NO.	
DATE	
BY	
NO.	
DATE	

\AL10084.DGN, \VROW008R6.DGN, \T BODY.VLGN, \VROW008R5.DGN, \MEM008R3.DGN, \VROW008R4.DGN, \AL10084.DGN, \VROW008R6.DGN, \TPO008R2.DGN, \VROW008R7.DGN, \VROW008R8.DGN, \VROW008R9.DGN, \VROW008R10.DGN, \VROW008R11.DGN, \VROW008R12.DGN, \VROW008R13.DGN, \VROW008R14.DGN, \VROW008R15.DGN, \VROW008R16.DGN, \VROW008R17.DGN, \VROW008R18.DGN, \VROW008R19.DGN, \VROW008R20.DGN, \VROW008R21.DGN, \VROW008R22.DGN, \VROW008R23.DGN, \VROW008R24.DGN, \VROW008R25.DGN, \VROW008R26.DGN, \VROW008R27.DGN, \VROW008R28.DGN, \VROW008R29.DGN, \VROW008R30.DGN, \VROW008R31.DGN, \VROW008R32.DGN, \VROW008R33.DGN, \VROW008R34.DGN, \VROW008R35.DGN, \VROW008R36.DGN, \VROW008R37.DGN, \VROW008R38.DGN, \VROW008R39.DGN, \VROW008R40.DGN, \VROW008R41.DGN, \VROW008R42.DGN, \VROW008R43.DGN, \VROW008R44.DGN, \VROW008R45.DGN, \VROW008R46.DGN, \VROW008R47.DGN, \VROW008R48.DGN, \VROW008R49.DGN, \VROW008R50.DGN, \VROW008R51.DGN, \VROW008R52.DGN, \VROW008R53.DGN, \VROW008R54.DGN, \VROW008R55.DGN, \VROW008R56.DGN, \VROW008R57.DGN, \VROW008R58.DGN, \VROW008R59.DGN, \VROW008R60.DGN, \VROW008R61.DGN, \VROW008R62.DGN, \VROW008R63.DGN, \VROW008R64.DGN, \VROW008R65.DGN, \VROW008R66.DGN, \VROW008R67.DGN, \VROW008R68.DGN, \VROW008R69.DGN, \VROW008R70.DGN, \VROW008R71.DGN, \VROW008R72.DGN, \VROW008R73.DGN, \VROW008R74.DGN, \VROW008R75.DGN, \VROW008R76.DGN, \VROW008R77.DGN, \VROW008R78.DGN, \VROW008R79.DGN, \VROW008R80.DGN, \VROW008R81.DGN, \VROW008R82.DGN, \VROW008R83.DGN, \VROW008R84.DGN, \VROW008R85.DGN, \VROW008R86.DGN, \VROW008R87.DGN, \VROW008R88.DGN, \VROW008R89.DGN, \VROW008R90.DGN, \VROW008R91.DGN, \VROW008R92.DGN, \VROW008R93.DGN, \VROW008R94.DGN, \VROW008R95.DGN, \VROW008R96.DGN, \VROW008R97.DGN, \VROW008R98.DGN, \VROW008R99.DGN, \VROW008R100.DGN

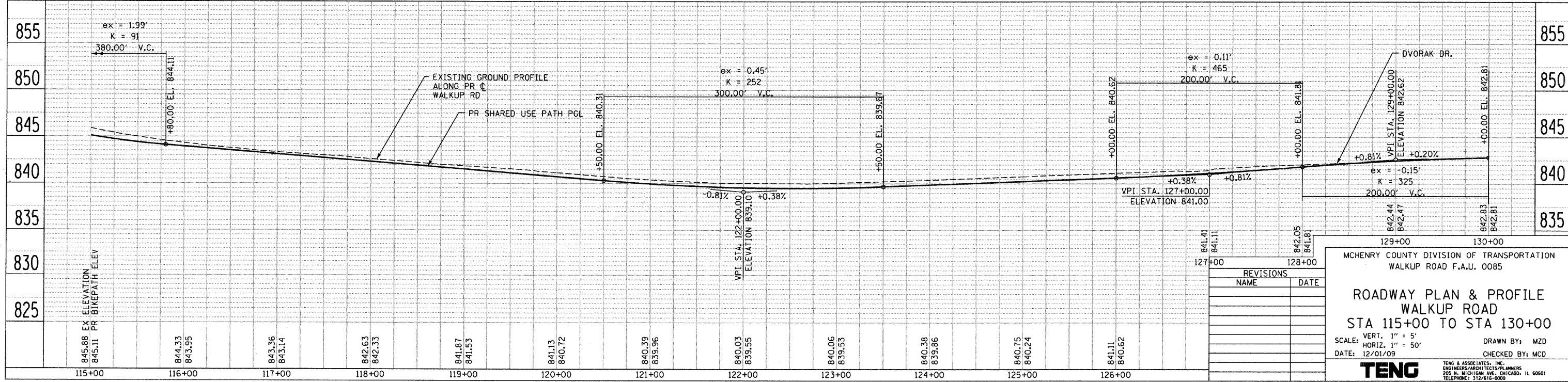

REVISIONS	
NAME	DATE

MCHENRY COUNTY DIVISION OF TRANSPORTATION  
WALKUP ROAD F.A.U. 0085

**ROADWAY PLAN & PROFILE**  
WALKUP ROAD  
STA 115+00 TO STA 130+00

SCALE: VERT. 1" = 5'  
HORIZ. 1" = 50'

DATE: 12/01/09

DRAWN BY: MZD  
CHECKED BY: MCD

**TENG**  
TENG & ASSOCIATES, INC.  
ENGINEERS/ARCHITECTS/PLANNERS  
225 N. MICHIGAN AVE., CHICAGO, IL 60601  
TELEPHONE: 312/616-0000