

F.A.U. SECTION	COUNTY	TOTAL SHEETS	SHEET NO.
0085 00-00246-01-FP	MCHENRY	236	32
STA.	TO STA.	FED. ROAD DIST. NO. 1 ILLINOIS FED. AID PROJECT	
		CONTRACT NO: 63266	

PLAN	DATE	BY
SURVEYED		
PLOTTED		
CHECKED		
NO. OF WAY CHECKED		
FILE NAME		
NO.		

PROFILE	DATE	BY
SURVEYED		
PLOTTED		
CHECKED		
NO. OF WAY CHECKED		
FILE NAME		
NO.		

EXISTING PLAN
MATCH LINE STA. 145+00

PROPOSED PLAN
MATCH LINE STA. 145+00

- REMOVAL LEGEND**
- DRIVEWAY PAVEMENT REMOVAL
 - HOT-MIX ASPHALT SURFACE REMOVAL, VARIABLE DEPTH (SEE NOTE 1 SHEET 30)
 - PAVEMENT REMOVAL
 - HOT-MIX ASPHALT SURFACE REMOVAL - BUTT JOINT
 - TREE REMOVAL (WITH DIAMETER)
 - LINEAR REMOVALS

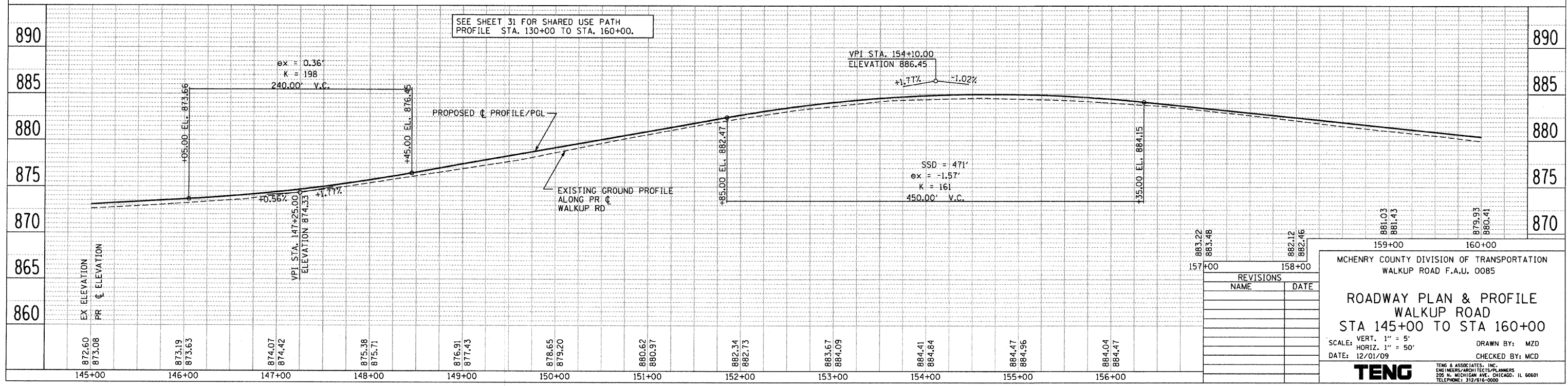
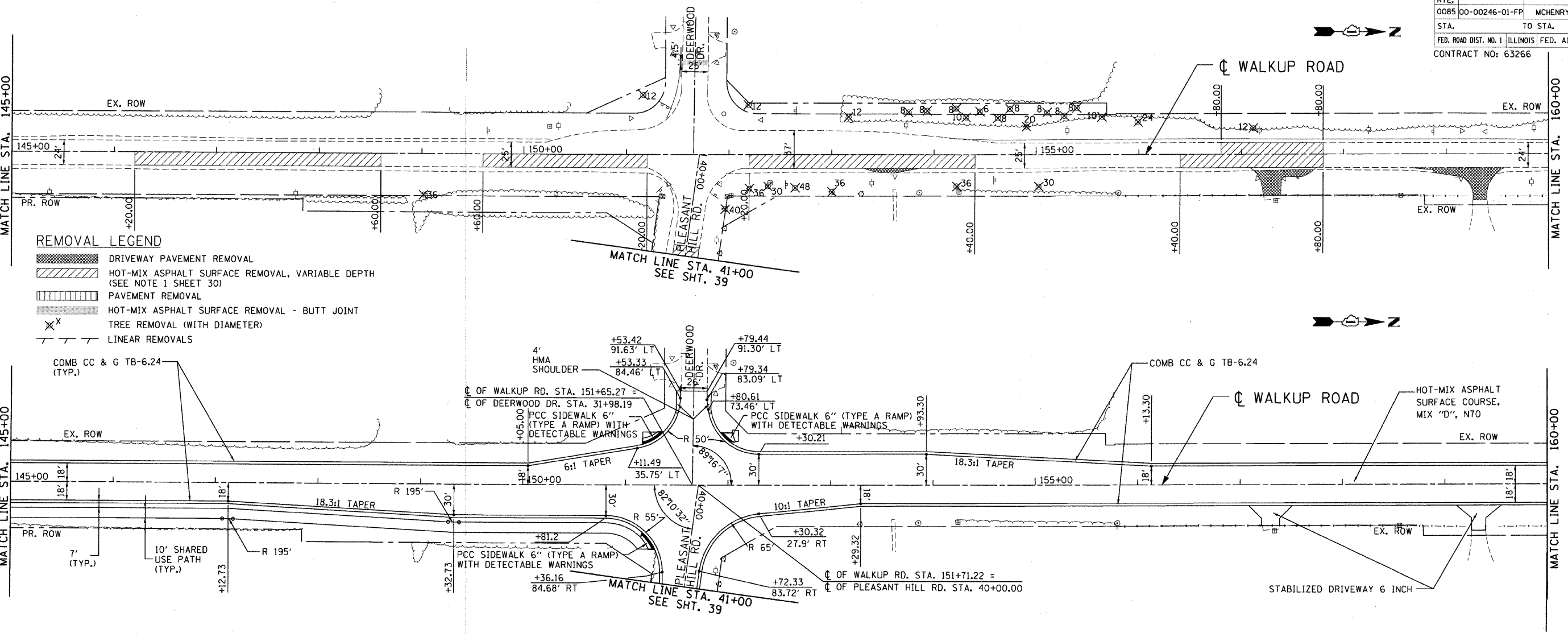

SEE SHEET 31 FOR SHARED USE PATH PROFILE STA. 130+00 TO STA. 160+00.

REVISIONS	NAME	DATE

MCHENRY COUNTY DIVISION OF TRANSPORTATION
WALKUP ROAD F.A.U. 0085

**ROADWAY PLAN & PROFILE
WALKUP ROAD
STA 145+00 TO STA 160+00**

SCALE: VERT. 1" = 5'
HORIZ. 1" = 50'

DATE: 12/01/09
DRAWN BY: MZD
CHECKED BY: MCD

TENG
TENG & ASSOCIATES, INC.
ENGINEERS-ARCHITECTS-PLANNERS
205 N. MICHIGAN AVE., CHICAGO, IL 60601
TELEPHONE: 312/616-0000