

PLAN	SURVEYED	DATE
	PLOTTED	BY
	CHECKED	
	FILED	
	NO. OF WAY CHECKED	
	CADD FILE NAME	

PROFILE	SURVEYED	DATE
	PLOTTED	BY
	CHECKED	
	FILED	
	NO. OF WAY CHECKED	
	STRUCTURE NOTATIONS CHKD	

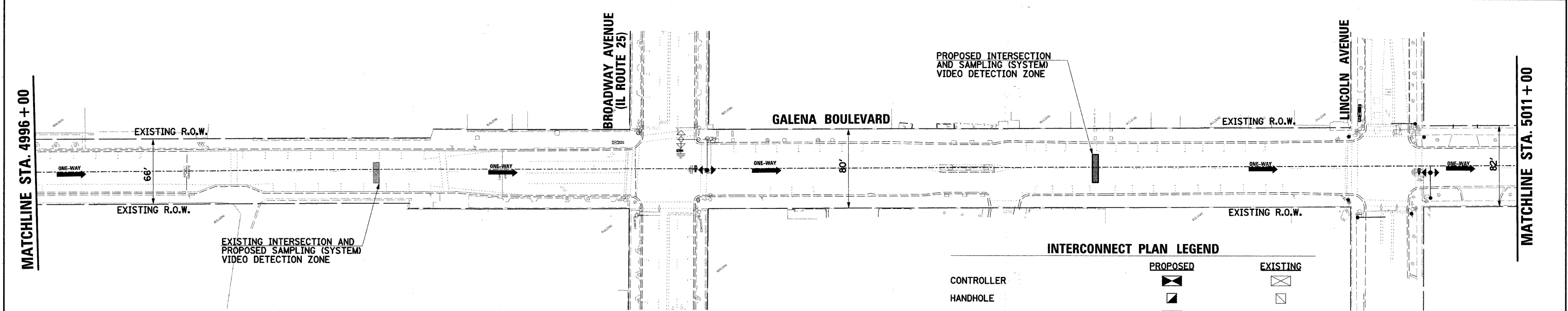
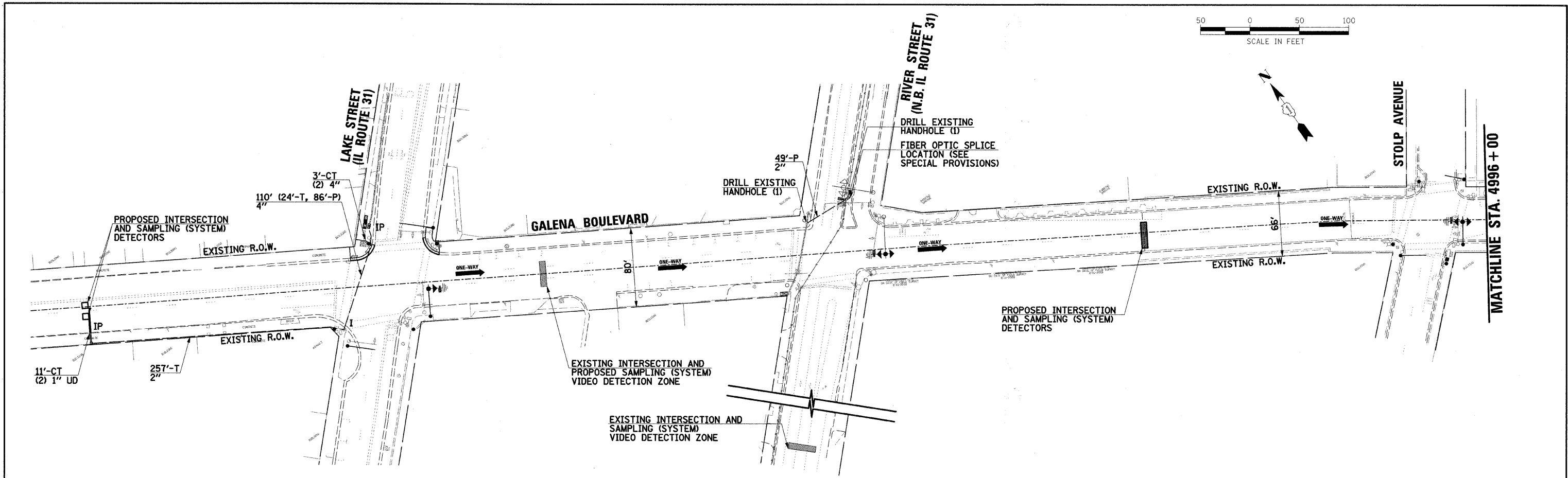

THE TRAFFIC SIGNAL CONTROL EQUIPMENT FOR THIS PROJECT SHALL BE "ECONOLITE" TO MATCH THE EXISTING ADJACENT SYSTEM.

NOTE:
THE PROPOSED TERMINAL SERVER AND ETHERNET SWITCH SHALL BE INSTALLED WITHIN THE EXISTING TRAFFIC SIGNAL CONTROLLER CABINET AT RIVER STREET (SEE SPECIAL PROVISIONS).

RESTORATION OF WORK AREA:
RESTORATION OF THE TRAFFIC SIGNAL WORK AREA SHALL BE INCIDENTAL TO THE RELATED PAY ITEM SUCH AS FOUNDATION, CONDUIT, HANDHOLE, TRENCH AND BACKFILL, ETC., AND NO EXTRA COMPENSATION SHALL BE ALLOWED. ALL ROADWAY SURFACES SUCH AS SHOULDERS, MEDIANS, SIDEWALKS, PAVEMENT, ETC. SHALL BE REPLACED IN KIND. ALL DAMAGE TO MOWED LAWNS SHALL BE REPLACED WITH AN APPROVED SOD, AND ALL DAMAGE TO UNMOWED FIELDS SHALL BE SEEDED IN ACCORDANCE WITH STANDARD SPECIFICATIONS 252 AND 250 RESPECTIVELY.

	PROPOSED	EXISTING
CONTROLLER		
HANDHOLE		
DOUBLE HANDHOLE		
HEAVY-DUTY HANDHOLE		
G.S. CONDUIT IN TRENCH (T) OR PUSHED (P)		
DETECTOR LOOP		
UNIT DUCT	UD	
SYSTEM	S	
INTERSECTION	IP	I
MAST ARM ASSEMBLY AND POLE, STEEL		
WIRELESS ANTENNA		
VIDEO DETECTION ZONE		

FILE NAME =	USER NAME = .USER.
...\\f:\in_dwg\690_5_sjgint01.dgn	

DESIGNED -	REVISIONS
DRAWN BAH	REVISIONS
CHECKED APS	REVISIONS
DATE -	REVISIONS

DESIGNED -	REVISIONS
DRAWN BAH	REVISIONS
CHECKED APS	REVISIONS
DATE -	REVISIONS

DESIGNED -	REVISIONS
DRAWN BAH	REVISIONS
CHECKED APS	REVISIONS
DATE -	REVISIONS

**STATE OF ILLINOIS
DEPARTMENT OF TRANSPORTATION**

INTERCONNECT PLAN (SHEET 1 OF 3)			
SCALE:	SHEET NO.	OF SHEETS	STA. TO STA.

F.A. RTE.	SECTION	COUNTY	TOTAL SHEETS	SHEET NO.
	08-00270-00-TL	KANE	44	33
CONTRACT NO. 63300				
FED. ROAD DIST. NO. ILLINOIS FED. AID PROJECT				