

SECTION 2, TOWNSHIP 37, RANGE 12
SECTION 11, TOWNSHIP 37, RANGE 12

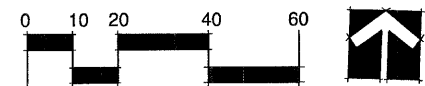
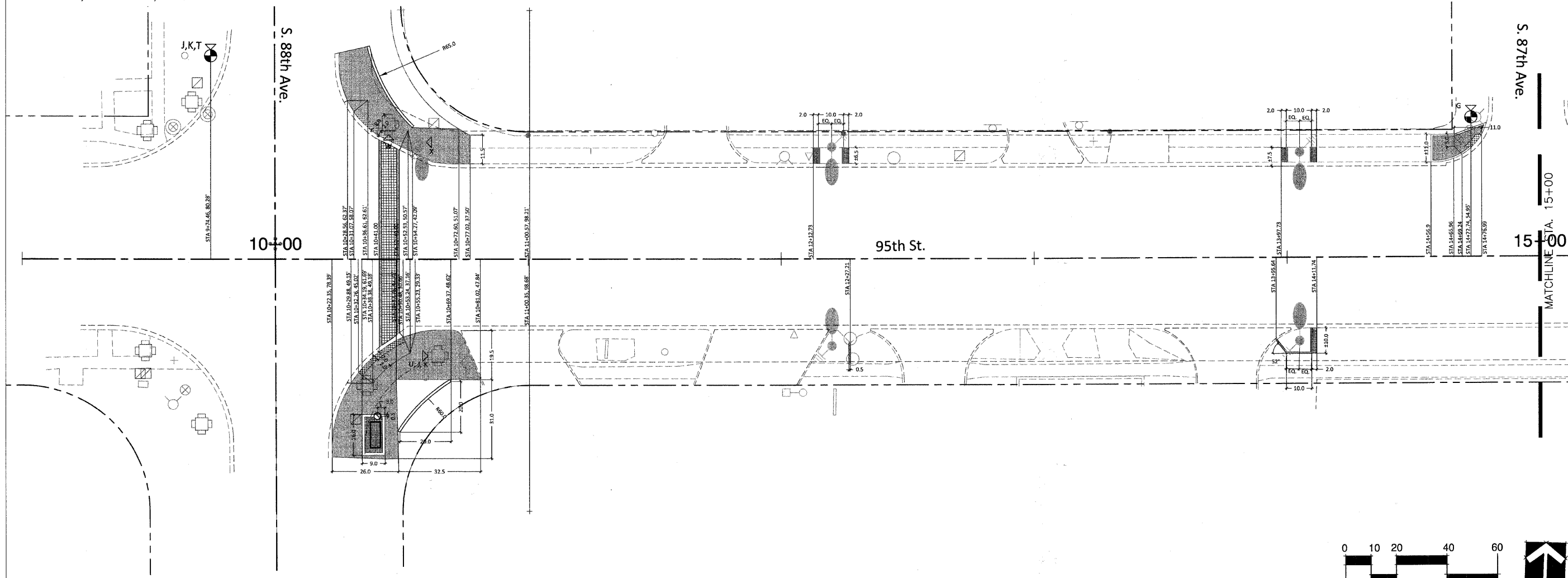

LAYOUT AND DIMENSION PLAN NOTES:

1. ALL DIMENSION LINES SHALL EXTEND PERPENDICULAR (90 DEGREES) UNLESS OTHERWISE NOTED.
2. ALL PLAN FEATURES SHALL BE LAID OUT AND PAINTED OR OTHERWISE MARKED IN THE FIELD BY THE CONTRACTOR AND REVIEWED BY THE LANDSCAPE ARCHITECT PRIOR TO CONSTRUCTION.
3. UNLESS OTHERWISE NOTED, ALL ANGLES ARE 90 DEGREES OR 45 DEGREES.
4. ALL CURB DIMENSIONS ARE GIVEN TO THE BACK OF CURB.
5. ALL EXPANSION AND CONTROL JOINTS SHALL BE LOCATED AS SHOWN IN THE DRAWINGS.
6. ALL CONCRETE PLANTER CURBS AT LIGHTPOLE FOUNDATIONS TO BE ADJUSTED PER FIELD CONDITIONS. THIS IS TO ENSURE THE PLANTER BED IS CENTERED ON EXISTING LIGHTPOLE.
7. ALL DIMENSIONS TO TRANSIT SHELTERS ARE APPROXIMATE. ALL SHELTERS TO BE LOCATED IN FIELD BY THE CONTRACTOR BEFORE REMOVAL AND FOR FUTURE REFERENCE IN REINSTALLATION.

FILE NAME = pf_dimension plan - IDOT P34 	USER NAME =	DESIGNED -- BCL	REVISED -- 10/30/2009	STATE OF ILLINOIS DEPARTMENT OF TRANSPORTATION	DIMENSION PLAN			F.A.P. RTE.	SECTION	COUNTY	TOTAL SHEETS	SHEET NO.
	PLOT SCALE = 1"=20'	CHECKED -- KLG	REVISED -- 11/30/2009		29	09-00058-00-LS	COOK	62	34			
	PLOT DATE = 8/21/09	DRAWN -- BCL/RJA	REVISED -- 12/17/2009		CONTRACT NO. 63321							
		CHECKED -- KLG/LMW	REVISED -- 12/30/2009		FED. ROAD DIST. NO. 1 ILLINOIS FED. AID PROJECT ARA-9003(343)							
				SCALE: 1"=20' SHEET NO. 34 OF 62 SHEETS STA. 9+00 TO STA. 15+00								