

SECTION 2, TOWNSHIP 37, RANGE 12
SECTION 11, TOWNSHIP 37, RANGE 12

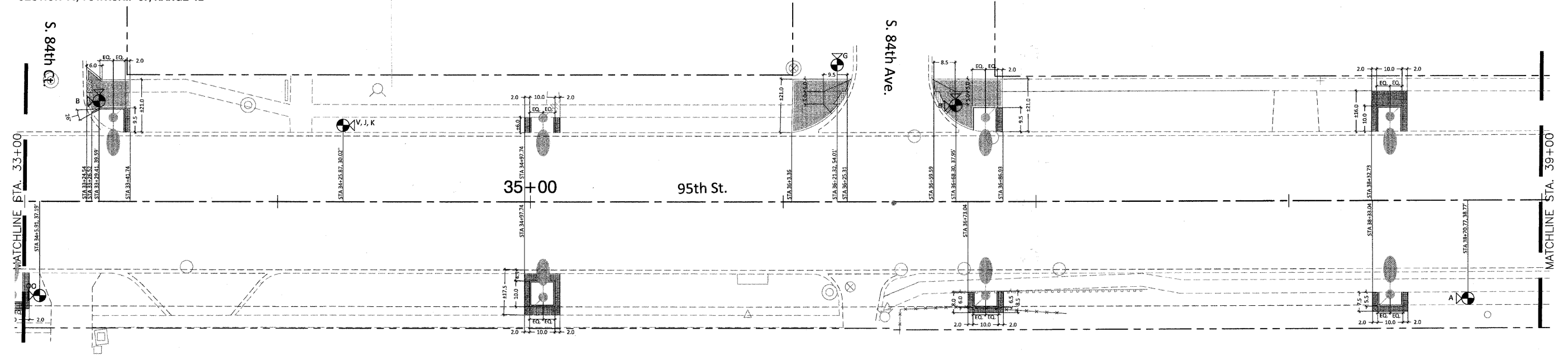

LAYOUT AND DIMENSION PLAN NOTES:

1. ALL DIMENSION LINES SHALL EXTEND PERPENDICULAR (90 DEGREES) UNLESS OTHERWISE NOTED.
2. ALL PLAN FEATURES SHALL BE LAID OUT AND PAINTED OR OTHERWISE MARKED IN THE FIELD BY THE CONTRACTOR AND REVIEWED BY THE LANDSCAPE ARCHITECT PRIOR TO CONSTRUCTION.
3. UNLESS OTHERWISE NOTED, ALL ANGLES ARE 90 DEGREES OR 45 DEGREES.
4. ALL CURB DIMENSIONS ARE GIVEN TO THE BACK OF CURB.
5. ALL EXPANSION AND CONTROL JOINTS SHALL BE LOCATED AS SHOWN IN THE DRAWINGS.
6. ALL CONCRETE PLANTER CURBS AT LIGHTPOLE FOUNDATIONS TO BE ADJUSTED PER FIELD CONDITIONS. THIS IS TO ENSURE THE PLANTER BED IS CENTERED ON EXISTING LIGHTPOLE.

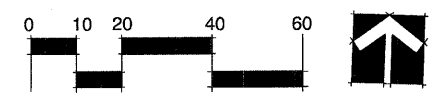

FILE NAME = pd_dimension plan - IDOT P38 	USER NAME =	DESIGNED -- BCL	REVISED -- 10/30/2009	STATE OF ILLINOIS DEPARTMENT OF TRANSPORTATION	DIMENSION PLAN		F.A.P. RTE. 29	SECTION 09-00056-00-LS	COUNTY COOK	TOTAL SHEETS 62	SHEET NO. 38	
	PLOT SCALE = 1"=20'	CHECKED -- KLG	REVISED -- 11/30/2009		SCALE: SHEET NO. 38 OF 62 SHEETS STA. 33+00 TO STA. 39+00		CONTRACT NO. 63321		FED. ROAD DIST. NO. ILLINOIS		FED. AID PROJECT ARA-9003(343)	
	PLOT DATE = 8/21/09	DRAWN -- BCL/RJA	REVISED -- 12/30/2009									
		CHECKED -- KLG/LMV	REVISED --									